



**COLDWELL  
BANKER  
COMMERCIAL**  
CAINE

**FOR LEASE**

## INDUSTRIAL FLEX BUILDING

3195 J. VERNE SMITH PARKWAY  
GREER, SC 29651

AVAILABLE SPACE  
+/-12,000 SF

LEASE RATE  
\$7.50 SF/yr (NNN)

CBCCAINE.COM



### CONTACT:

**Matt Vanvick**  
864.250.6806  
mvanvick@cbccaine.com

**David Sigmon, CCIM, SIOR**  
864.250.6838  
dsigmon@cbccaine.com

**Pete Brett, CCIM**  
864.250.6815  
pbrett@cbccaine.com

©2019 Coldwell Banker Real Estate LLC, dba Coldwell Banker Commercial Caine. All rights reserved. Coldwell Banker Commercial® and the Coldwell Banker Commercial logo are registered service marks owned by Coldwell Banker Real Estate LLC. Coldwell Banker Real Estate LLC, dba Coldwell Banker Commercial Affiliates fully supports the principles of the Fair Housing Act and the Equal Opportunity Act. Each office is independently owned and operated. The information provided is deemed reliable, but it is not guaranteed to be accurate or complete, and it should not be relied upon as such. This information should be independently verified before any person enters into a transaction based upon it.

**COLDWELL BANKER COMMERCIAL  
CAINE**  
117 Williams Street, Greenville, SC 29601  
864.250.2800



# 3195 J. VERNE SMITH PARKWAY

Greer, SC 29651

LEASE



## OFFERING SUMMARY

Available SF: +/-12,000 SF

Lease Rate: \$7.50 SF/YR NNN

Lot Size: +/-1.3 Acres

Building Size: +/-12,000 SF

Zoning: S-1 Greenville County

## PROPERTY HIGHLIGHTS

- +/-3,208 SF OFFICE:
  - (4) Private offices, (2) are "double" and have (2) desks each, (12) cubicles, Kitchen/break area, conference room, Men's/Women's Restrooms
  - Recently renovated
  - LED Lighting
  - Fiber data available
  - Security System in place
  - New roof (TPO membrane) 2018
- +8,792 SF WAREHOUSE
  - (1) ADA restroom in warehouse, Mop sink in warehouse
  - (4) Gas heaters, Fans (No HVAC in warehouse, but could be added/amortized into rent)
  - 15'10" ceiling height at eaves, 19'10" at center
  - Racks stay
  - (1) loading dock with leveler, (1) roll up door with ramp for deliveries, (1) set of double doors from warehouse to exterior
  - 3-phase power, (2) 250 amp panels
  - LED lighting
  - Fenced in parking
  - Concrete block construction
  - Accommodates 53' truck trailers

CBCCAINE.COM

Matt Vanvick | 864.250.6806 | mvanvick@cbccaine.com  
 David Sigmon, CCIM, SIOR | 864.250.6838 | dsigmon@cbccaine.com  
 Pete Brett, CCIM | 864.250.6815 | pbrett@cbccaine.com





# 3195 J. VERNE SMITH PARKWAY

Greer, SC 29651

LEASE



[CBCCAINE.COM](http://CBCCAINE.COM)

Matt Vanvick | 864.250.6806 | [mvanvick@cbccaine.com](mailto:mvanvick@cbccaine.com)  
David Sigmon, CCIM, SIOR | 864.250.6838 | [dsigmon@cbccaine.com](mailto:dsigmon@cbccaine.com)  
Pete Brett, CCIM | 864.250.6815 | [pbrett@cbccaine.com](mailto:pbrett@cbccaine.com)



**COLDWELL  
BANKER  
COMMERCIAL  
CAINE**



# 3195 J. VERNE SMITH PARKWAY

Greer, SC 29651

LEASE



CBCCAINE.COM

Matt Vanvick	864.250.6806	mvanvick@cbccaine.com
David Sigmon, CCIM, SIOR	864.250.6838	dsigmon@cbccaine.com
Pete Brett, CCIM	864.250.6815	pbrett@cbccaine.com





# 3195 J. VERNE SMITH PARKWAY

Greer, SC 29651

LEASE

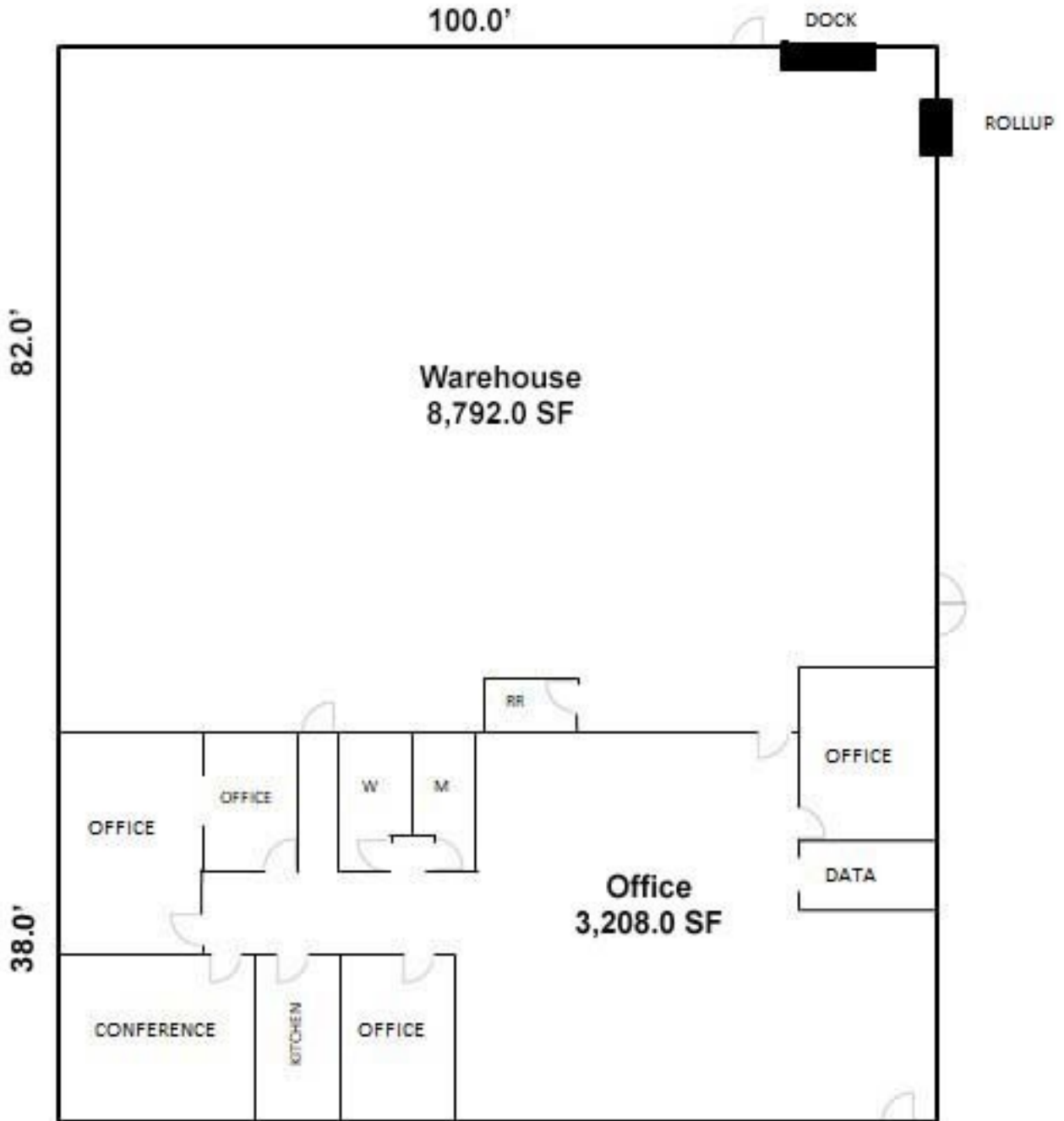

Not to Scale

CBCCAINE.COM

Matt Vanvick | 864.250.6806 | mvanvick@cbccaine.com  
David Sigmon, CCIM, SIOR | 864.250.6838 | dsigmon@cbccaine.com  
Pete Brett, CCIM | 864.250.6815 | pbrett@cbccaine.com



**COLDWELL  
BANKER  
COMMERCIAL**

CAINE



# 3195 J. VERNE SMITH PARKWAY

Greer, SC 29651

LEASE



Google

Map data ©2019 Imagery ©2019, City of Greenville GIS, Landsat / Copernicus, Maxar Technologies, U.S. Geological Survey, USDA Farm Service Agency

CBCCAINE.COM

Matt Vanvick	864.250.6806	mvanvick@cbccaine.com
David Sigmon, CCIM, SIOR	864.250.6838	dsigmon@cbccaine.com
Pete Brett, CCIM	864.250.6815	pbrett@cbccaine.com



**COLDWELL  
BANKER  
COMMERCIAL**

CAINE



# 3195 J. VERNE SMITH PARKWAY

Greer, SC 29651

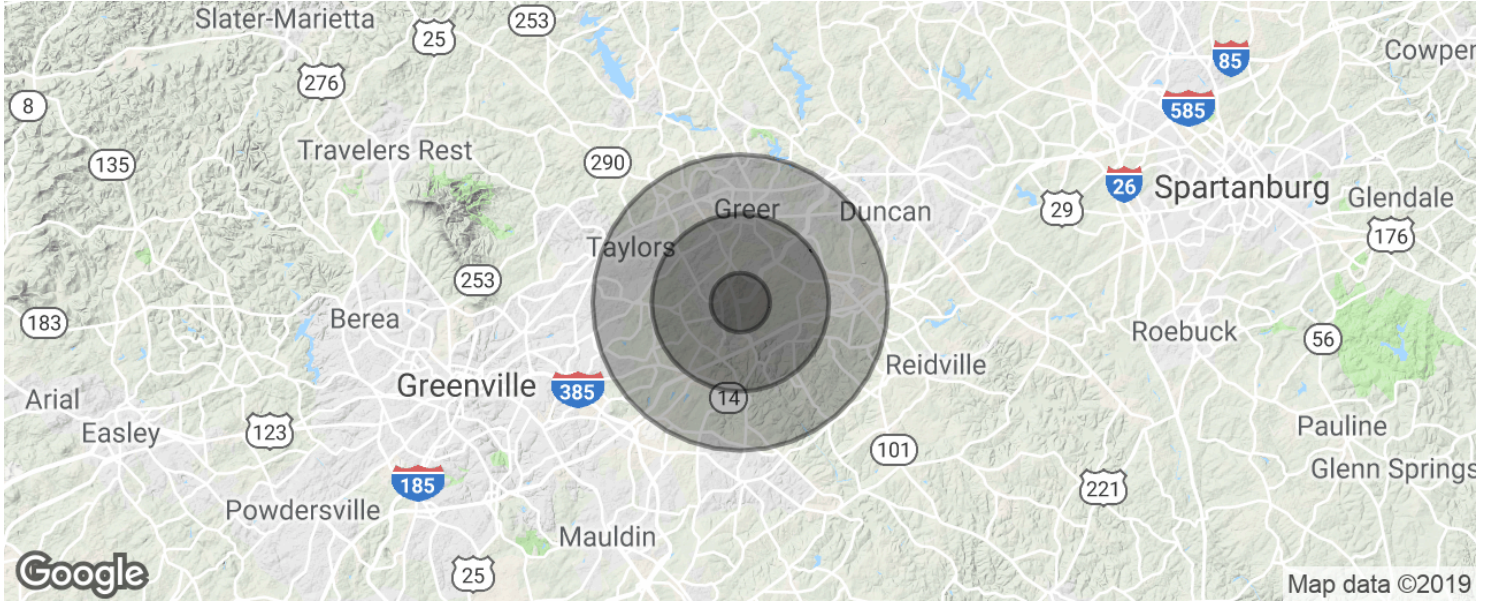

POPULATION	1 MILE	3 MILES	5 MILES
Total population	2,739	30,183	83,147
Median age	38.0	38.5	38.5
Median age (Male)	37.1	37.2	37.2
Median age (Female)	38.3	39.0	39.3
HOUSEHOLDS & INCOME	1 MILE	3 MILES	5 MILES
Total households	1,052	12,020	33,238
# of persons per HH	2.6	2.5	2.5
Average HH income	\$63,874	\$73,662	\$75,346
Average house value	\$110,451	\$215,380	\$236,121

\* Demographic data derived from 2010 US Census

CBCCAINE.COM

Matt Vanvick | 864.250.6806 | mvanvick@cbccaine.com  
 David Sigmon, CCIM, SIOR | 864.250.6838 | dsigmon@cbccaine.com  
 Pete Brett, CCIM | 864.250.6815 | pbrett@cbccaine.com

