

1380 BEVERAGE DRIVE

STONE MOUNTAIN, GA 30083 | STONE MOUNTAIN INDUSTRIAL PARK

UNDER NEW OWNERSHIP

INDUSTRIAL WAREHOUSE SPACE FOR LEASE

SPACE AVAILABLE 38,467 SF
LEASE RATE *Call for details*

HIGHLIGHTS

- Suite R-W Available
- 22' ceiling height
- 20% office space
- (10) DHD & (1) DID
- 3 miles from I-285
- Within Community Improvement District
- 100% Freeport Tax Exemption



BRETT BUCKNER, CCIM, SIOR
770.913.3923 | 770.827.0041
bbuckner@ackermanco.net

JIMMY STEVENS
770.913.3983
jstevens@ackermanco.net

Leased by
Ackerman & Co.

Owned by
LINK

1380 BEVERAGE DRIVE

STONE MOUNTAIN, GA 30083 | STONE MOUNTAIN INDUSTRIAL PARK

SPACE AVAILABLE:

38,467 SF

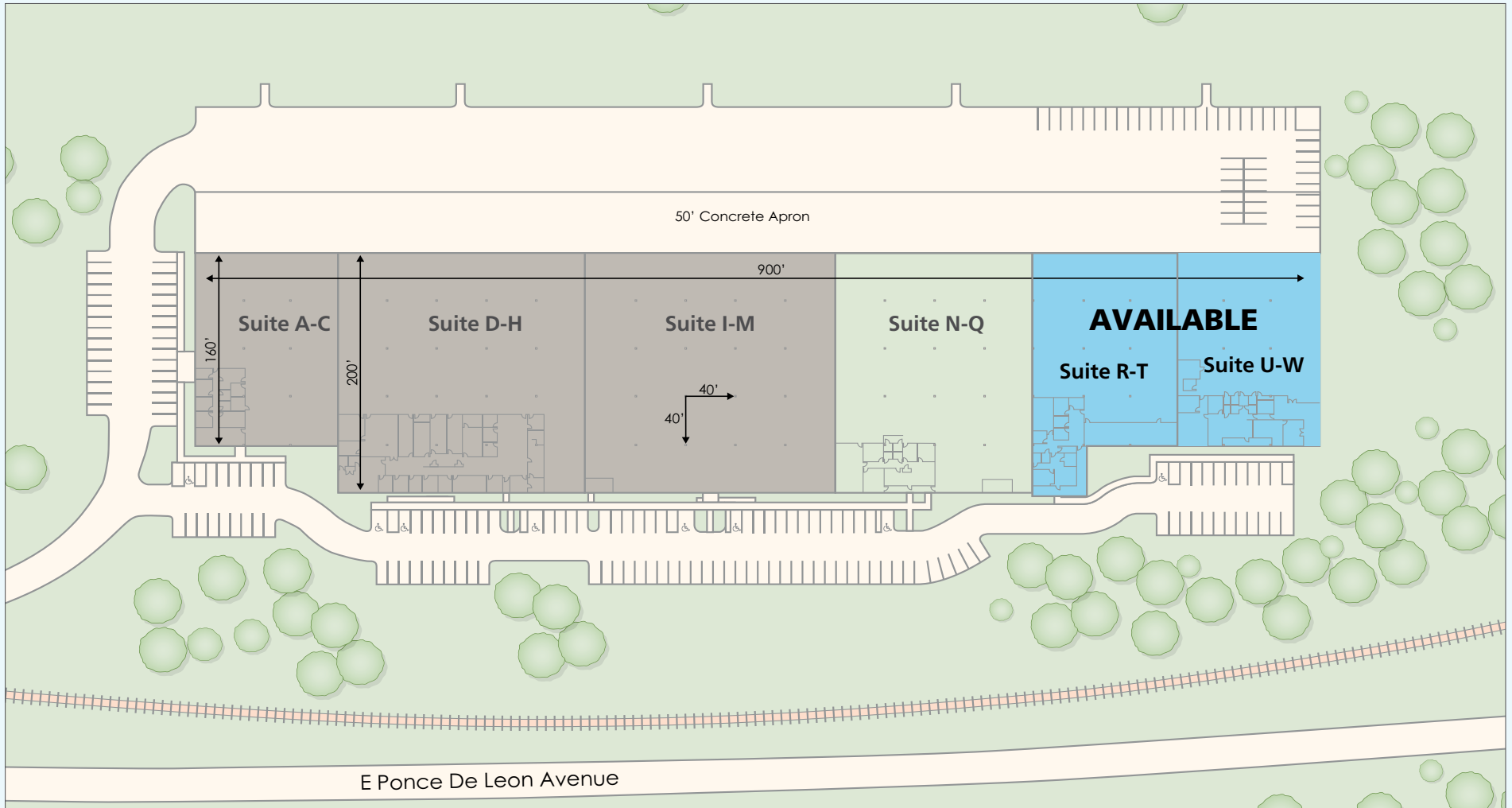

BRETT BUCKNER, CCIM, SIOR
770.913.3923 | 770.827.0041
bbuckner@ackermanco.net

JIMMY STEVENS
770.913.3983
jstevens@ackermanco.net

Leased by
Ackerman & Co.

Owned by
LINK

1380 BEVERAGE DRIVE

STONE MOUNTAIN, GA 30083 | STONE MOUNTAIN INDUSTRIAL PARK

SPACE AVAILABLE:

38,467 SF

STONE MOUNTAIN INDUSTRIAL PARK

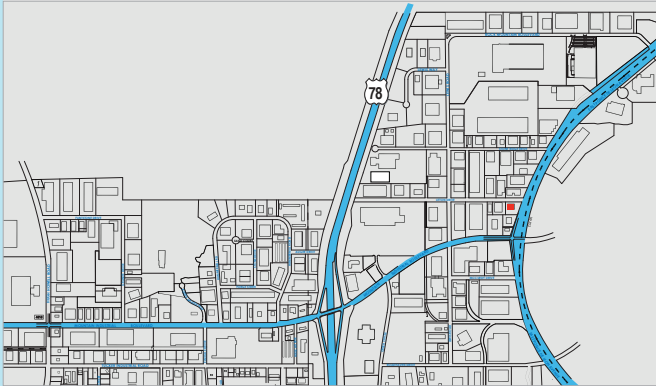

MAJOR INTERSTATES

I-285	4 MILES
I-85	8 MILES
I-20	9 MILES



MAJOR RAIL YARDS

CSX HULSEY YARD	14 MILES
CSX TILFORD YARD	18 MILES
CSX INMAN YARD	20 MILES



MAJOR AIRPORT

HARTSFIELD-JACKSON	21 MILES
--------------------	----------



MAJOR PORTS

SAVANNAH	252 MILES
BRUNSWICK	286 MILES
CHARLESTON	305 MILES

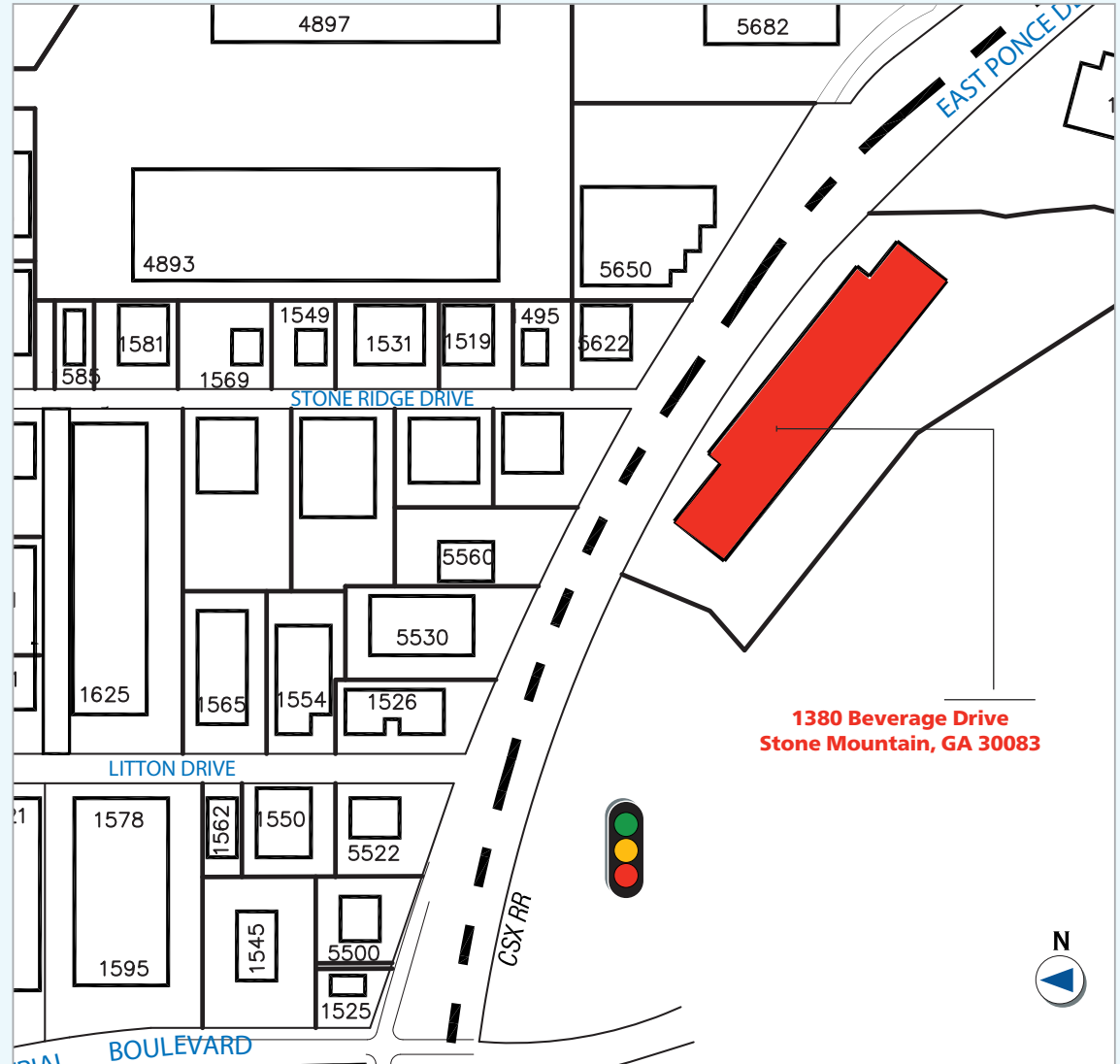

1380 Beverage Drive
Stone Mountain, GA 30083

BRETT BUCKNER, CCIM, SIOR
770.913.3923 | 770.827.0041
bbuckner@ackermanco.net

JIMMY STEVENS
770.913.3983
jstevens@ackermanco.net

Leased by
Ackerman & Co.

Owned by
LINK