



3611 | VALLEY CENTRE DR
SAN DIEGO

5TH FLOOR AVAILABLE FOR SUBLEASE

CBRE

Features



Entire 5th Floor
Available for Sublease



High-end, Class A Contemporary
Finishes Throughout



26,455 SF



FF&E can be made Available



Available with 60 Days' Notice



Gorgeous top floor views
to the West & North



Sublease Rate = Negotiable



Sublease Term
through 8/31/28



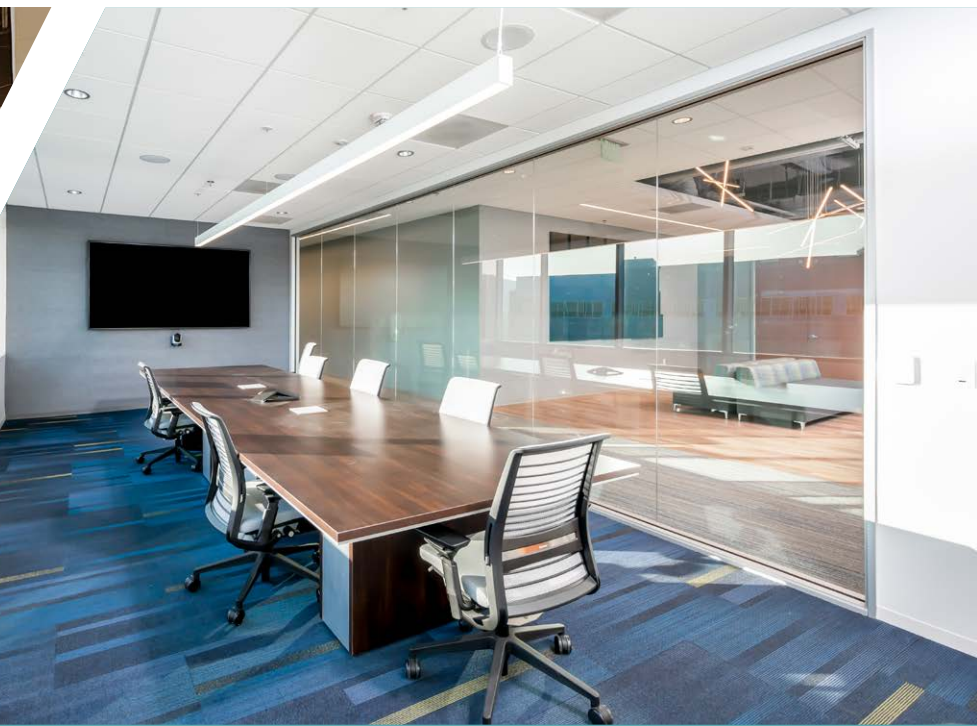

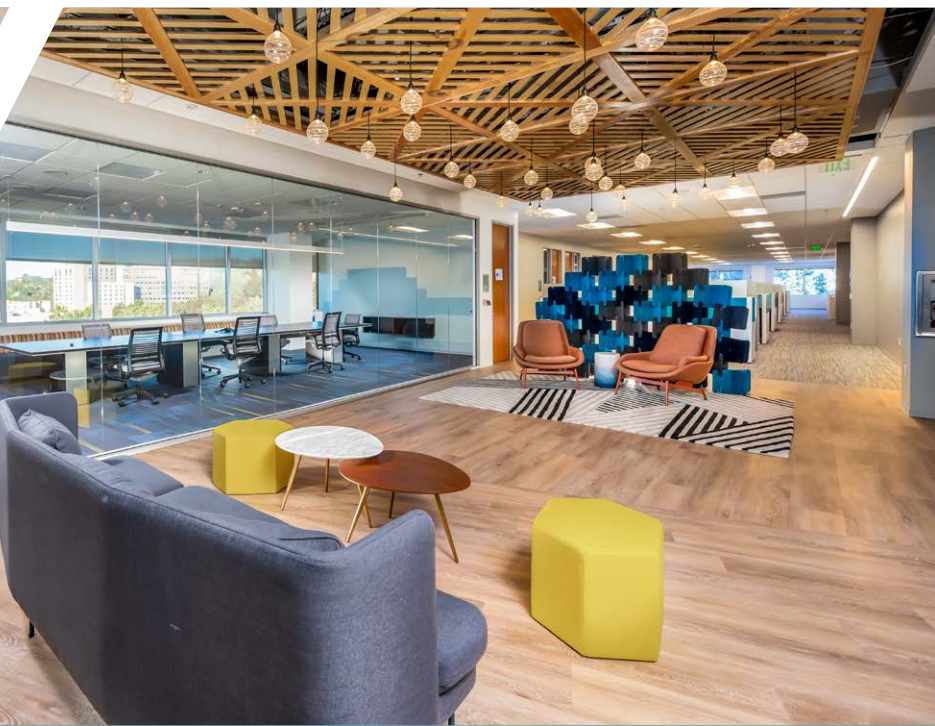

Floorplan

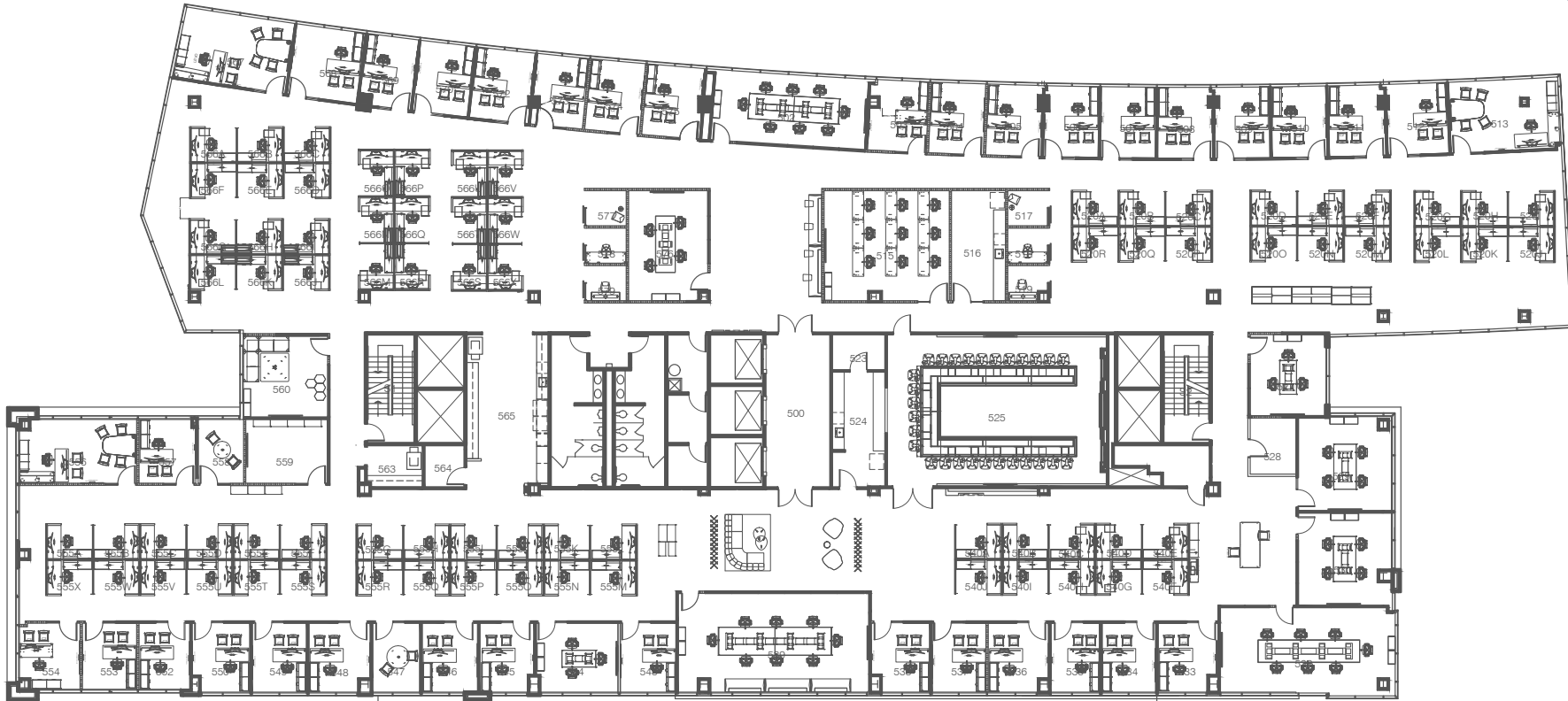

Approximately 36 private offices, multiple size conference rooms, break out & phone booth rooms, approximately 76 workstations and multiple kitchen areas throughout.

Location Map



3611 | VALLEY CENTRE DR
SAN DIEGO



3611 | VALLEY CENTRE DR
SAN DIEGO

5TH FLOOR AVAILABLE FOR SUBLEASE

CONTACTS

Michael Mahoney

Senior Vice President

+1 760 685 2915

michael.mahoney3@cbre.com

Lic. 01392972

CBRE

© 2024 CBRE, Inc. All rights reserved. This information has been obtained from sources believed reliable but has not been verified for accuracy or completeness. CBRE, Inc. makes no guarantee, representation or warranty and accepts no responsibility or liability as to the accuracy, completeness, or reliability of the information contained herein. You should conduct a careful, independent investigation of the property and verify all information. Any reliance on this information is solely at your own risk. CBRE and the CBRE logo are service marks of CBRE, Inc. All other marks displayed on this document are the property of their respective owners, and the use of such marks does not imply any affiliation with or endorsement of CBRE. Photos herein are the property of their respective owners. Use of these images without the express written consent of the owner is prohibited.