

For Sale

# East Boise Office Building

1491 Tyrell Lane, Boise, ID 83706

# NAISelect



## AVAILABLE PROPERTY

<b>Location</b>	Parkcenter Blvd, W on Tyrell Lane
<b>Building Size</b>	4,689 SF
<b>Lot Size</b>	±0.13 acres
<b>Zoning</b>	L-OD
<b>Year Built</b>	1981
<b>Sale Price</b>	\$740,000

## SITE INFORMATION

- Fully Leased East Boise Office Building
- ± 4,590 Leaseable SF
- Easy access to Downtown Boise
- Common bathrooms and break area
- Ample parking
- Contact agent for showing

DEMOGRAPHICS	1 Mile	3 Miles	5 Miles
Total Households	7,072	31,718	57,600
Total Population	13,686	70,169	128,630
Average HH Income	\$67,427	\$68,367	\$66,052



## NAISelect

5531 N. Glenwood St.,  
Boise, ID 83714  
208-229-2020

**Dennis Kelley**

dennis@naiselect.com  
C: 208-890-7700  
D: 208-229-6021

**Steve Yates**

steve@naiselect.com  
C: 208-830-3173  
D: 208-229-6020

For Sale

# East Boise Office Building

1491 Tyrell Lane, Boise, ID 83706 | \$740,000

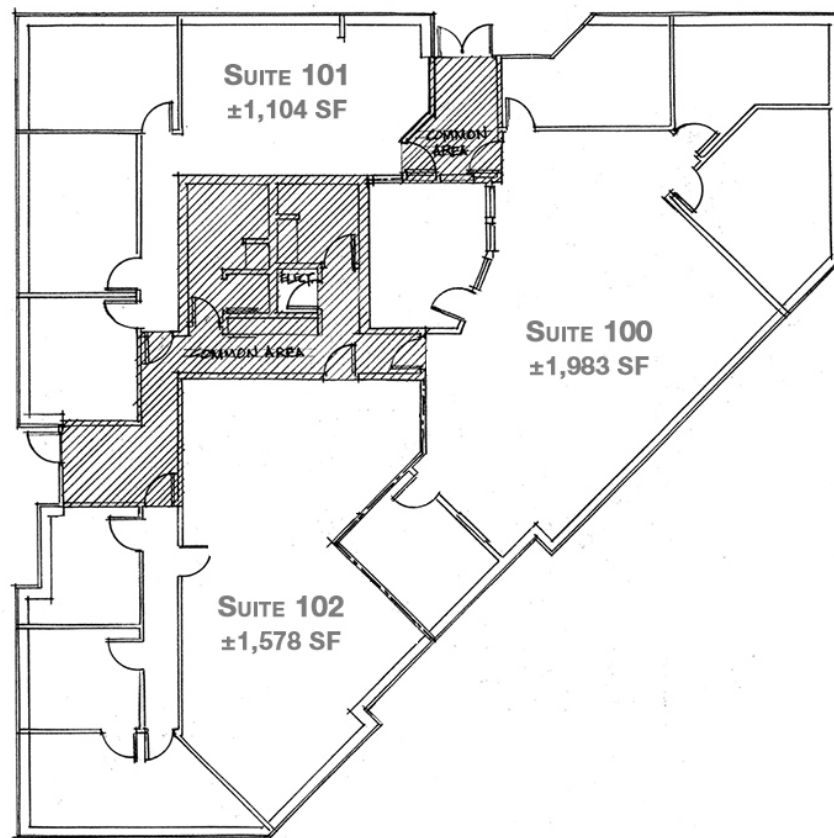

**NAISelect**

5531 N. Glenwood St.,  
Boise, ID 83714  
208-229-2020

**Dennis Kelley**

dennis@naiselect.com  
C: 208-890-7700  
D: 208-229-6021

**Steve Yates**

steve@naiselect.com  
C: 208-830-3173  
D: 208-229-6020