

# 280-290 CRAMER CREEK COURT DUBLIN, OHIO 43017



OFFICE FOR LEASE  
7,142 SF Available

## CRAMER CREEK



### PROPERTY FEATURES

- 19,381 SF multi-tenant, single story, stucco and glass office building
- Ideally situated on Frantz Road between Tuttle Mall and Rt. 161. Less than one mile from Rt. 33 / 161 and I-270 exit to the north and the Tuttle Mall interchange to the south.

OVERVIEW	
AVAILABLE	7,142 SF
ASKING RATE	\$9.00/SF Net
OPERATING EXPENSES	\$4.08/SF (plus utilities, janitorial & trash) estimated for 2014
PARKING	4 spaces/1,000 SF of occupied space
SIGNAGE	Building-mounted

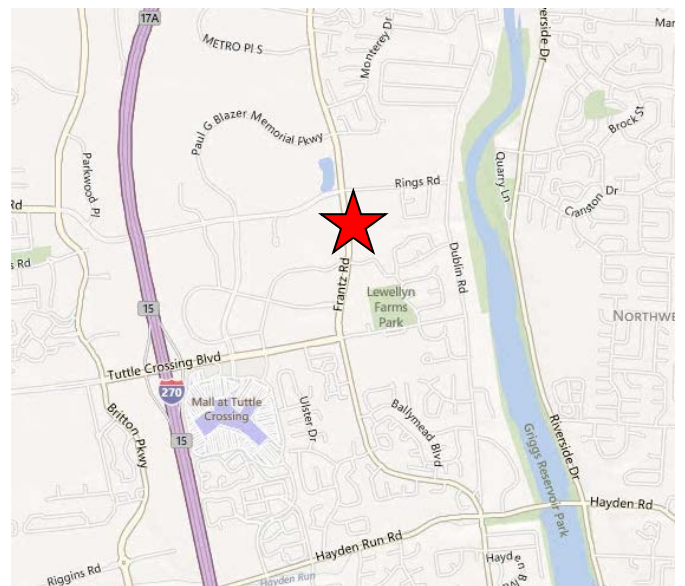

For more information, please contact:

**BRENT STAMM, CCIM**  
Senior Vice President  
(614) 883 1141  
bstamm@continental-realty.com

**TOM SUGAR**  
Executive Vice President  
(614) 883 1066  
tsugar@continental-realty.com

**CONTINENTAL REALTY /  
CUSHMAN & WAKEFIELD ALLIANCE**  
150 E. Broad Street, Suite 500  
Columbus, OH 43215  
www.continental-realty.com

The depiction in the included photograph of any person, entity, sign, logo or property, other than Continental Realty's (CR) client and the property offered by CR, is incidental only, and is not intended to connote any affiliation, connection, association, sponsorship or approval by or between that which is incidentally depicted and CR or its client. This listing shall not be deemed an offer to lease, sublease or sell such property; and, in the event of any transaction for such property, no commission shall be earned by or payable to any cooperating broker except if otherwise provided pursuant to the express terms, rates and conditions of CR's agreement with its principal, if, as and when such commission (if any) is actually received from such principal. (A copy of the rates and conditions referred to above with respect to this property is available upon request.)

# 280-290 CRAMER CREEK COURT

Office for Lease

7,142 SF  
AVAILABLE

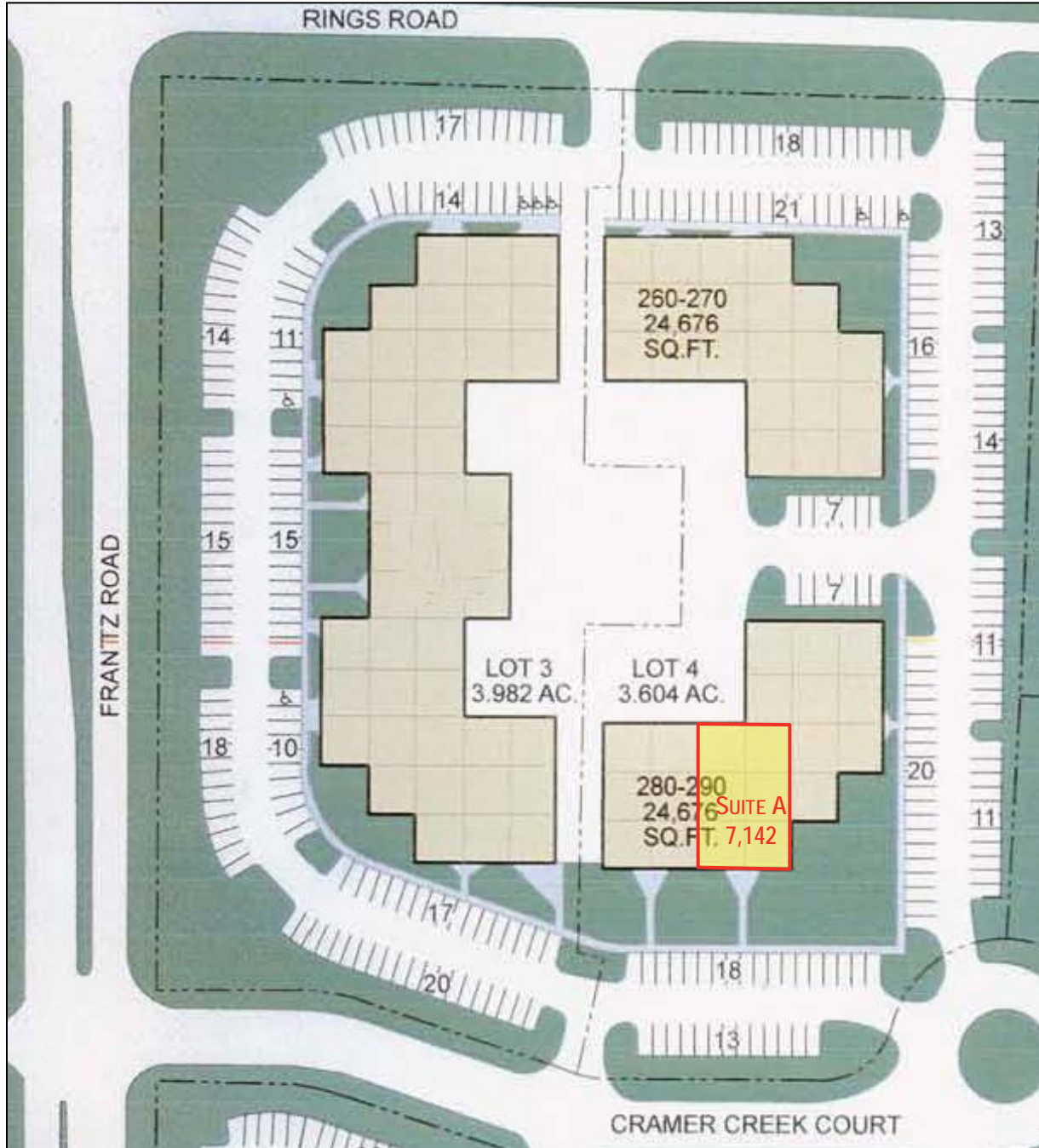

For more information, please contact:

**BRENT STAMM, CCIM**  
Senior Vice President  
(614) 883 1141  
bstamm@continental-realty.com

**TOM SUGAR**  
Executive Vice President  
(614) 883 1066  
tsugar@continental-realty.com

**CONTINENTAL REALTY /  
CUSHMAN & WAKEFIELD ALLIANCE**  
150 E. Broad Street, Suite 500  
Columbus, OH 43215  
www.continental-realty.com

The depiction in the included photograph of any person, entity, sign, logo or property, other than Continental Realty's (CR) client and the property offered by CR, is incidental only, and is not intended to connote any affiliation, connection, association, sponsorship or approval by or between that which is incidentally depicted and CR or its client. This listing shall not be deemed an offer to lease, sublease or sell such property; and, in the event of any transaction for such property, no commission shall be earned by or payable to any cooperating broker except if otherwise provided pursuant to the express terms, rates and conditions of CR's agreement with its principal, if, as and when such commission (if any) is actually received from such principal. (A copy of the rates and conditions referred to above with respect to this property is available upon request.)

# 280-290 CRAMER CREEK COURT

Office for Lease

7,142 SF  
AVAILABLE

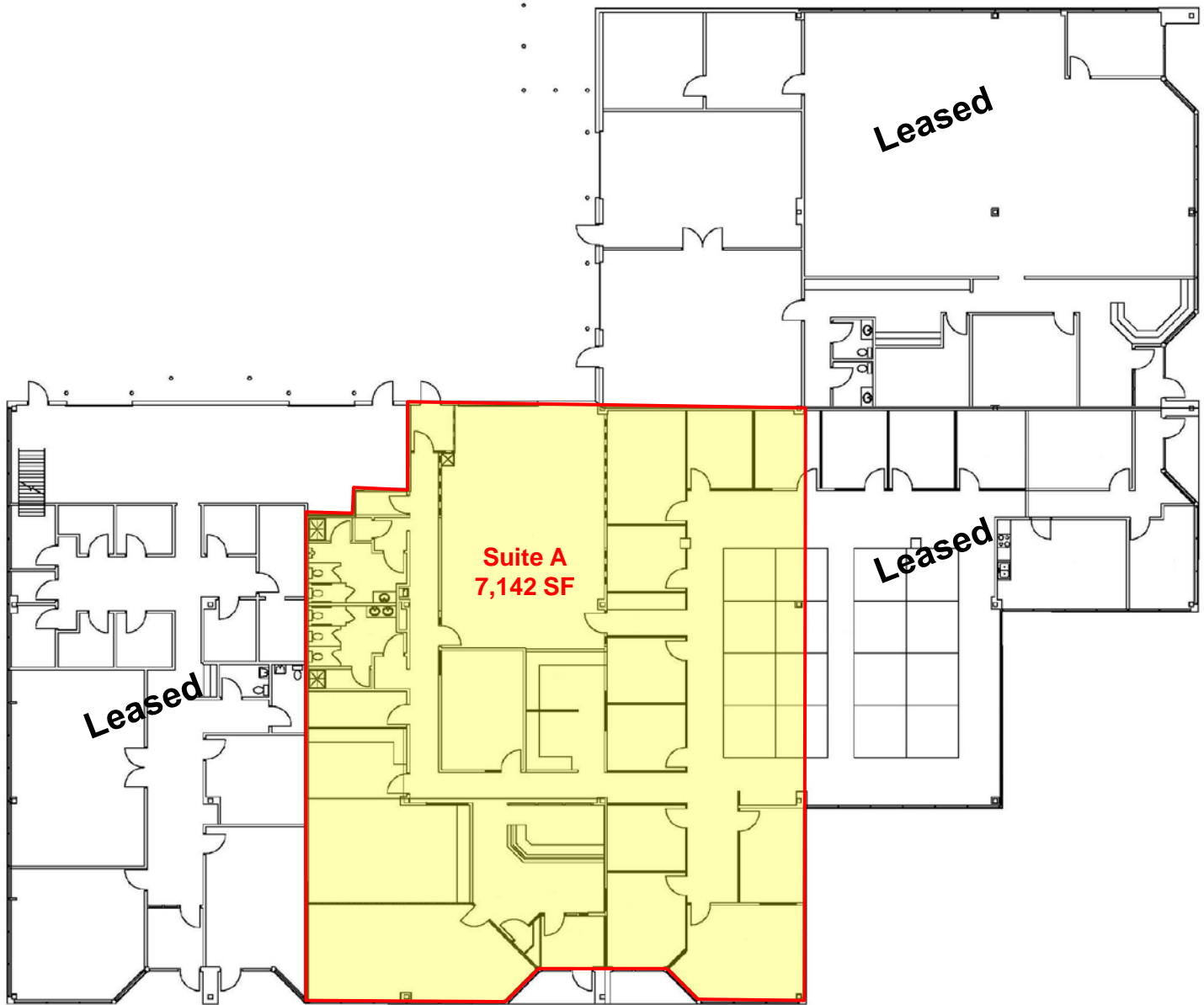

For more information, please contact:

**BRENT STAMM, CCIM**

Senior Vice President

(614) 883 1141

[bstamm@continental-realty.com](mailto:bstamm@continental-realty.com)

**TOM SUGAR**

Executive Vice President

(614) 883 1066

[tsugar@continental-realty.com](mailto:tsugar@continental-realty.com)

**CONTINENTAL REALTY /  
CUSHMAN & WAKEFIELD ALLIANCE**

150 E. Broad Street, Suite 500

Columbus, OH 43215

[www.continental-realty.com](http://www.continental-realty.com)

The depiction in the included photograph of any person, entity, sign, logo or property, other than Continental Realty's (CR) client and the property offered by CR, is incidental only, and is not intended to connote any affiliation, connection, association, sponsorship or approval by or between that which is incidentally depicted and CR or its client. This listing shall not be deemed an offer to lease, sublease or sell such property; and, in the event of any transaction for such property, no commission shall be earned by or payable to any cooperating broker except if otherwise provided pursuant to the express terms, rates and conditions of CR's agreement with its principal, if, as and when such commission (if any) is actually received from such principal. (A copy of the rates and conditions referred to above with respect to this property is available upon request.)