

NEWLY BUILT RETAIL



Up to 3,200± SF Retail Space

Property Highlights

- High profile location in the new Dunkin Donuts Plaza
- Can be subdivided to two tenant spaces
- Located on the corner of John Glenn Blvd and Farrell Road
- Great signage available on 35' pylon and building
- Easy ingress/egress at traffic light
- Excellent access to I-690 east/west as well as the New York State Thruway (I-90)
- Unimproved space can be finished to tenant specifications
- Neighbors include CocaCola, Metro Mattress, Old Dominion, Americold Logistics and Clarion Inn & Suites

Demographic	1 Mile	3 Miles	5 Miles
Population	912	30,323	98,373
Households	370	12,852	41,233
Average Income	\$72,474	\$82,729	\$80,932
Daytime Employees	2,152	8,293	37,999
Source: ESRI Business Analyst 2018			

Traffic Counts	
John Glenn Blvd	23,919 AADT
Farrell Road	2,425 AADT
Long Branch Road	2,443 AADT
Source: NYS DOT 2015	

For more information, please contact:

Christopher Savage
Real Estate Salesperson
 +1 315.445.8519
 csavage@pyramidbrokerage.com

5786 Widewaters Pkwy, P.O. Box 3
 Syracuse, New York 13214
 phone: +1 315 445 1030
 pyramidbrokerage.com

FOR LEASE
299 Farrell Road
 Syracuse, New York 13209

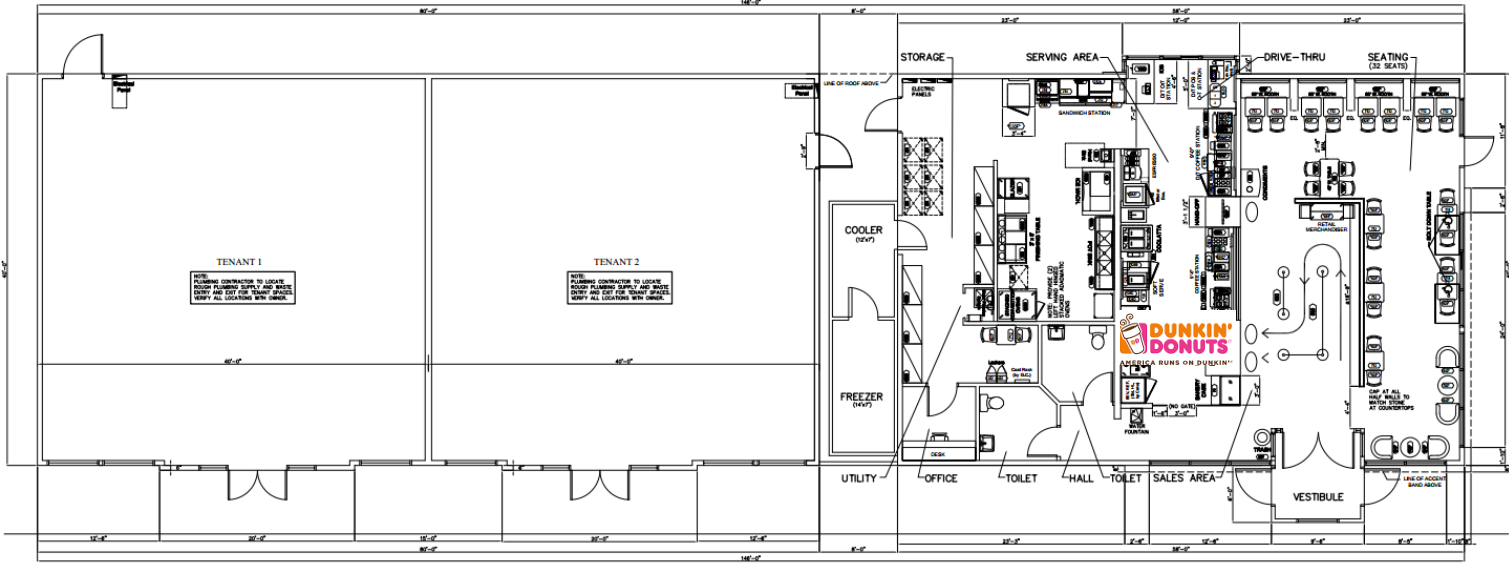

FLOOR PLAN
 SCALE: 3/16" = 1'-0"

FOR LEASE

299 Farrell Road

Syracuse, New York 13209

