

# 120 Kisco Avenue

A 26,000 SqFt Flex-Space Office Building



- Easy Access to Saw Mill River Pkwy & I-684
- 5 Minute walk to Downtown, Metro North Train Station and Major Retail Corridor
- AAA Business Location with 435 Feet of Frontage on the Best Street in Mt. Kisco
- In the Heart of the Commercial Business District in Northern Westchester

# Arial View



- 435 Feet of Frontage on Kisco Avenue
- 60+ Parking Spaces
- 9 Zones of High-efficiency HVAC
- State-of-the-art Security Camera Monitoring
- Uniquely Flexible Interior Configurations
- On-site Management and Maintenance

# Available 572 SQFT of Prime Office Space

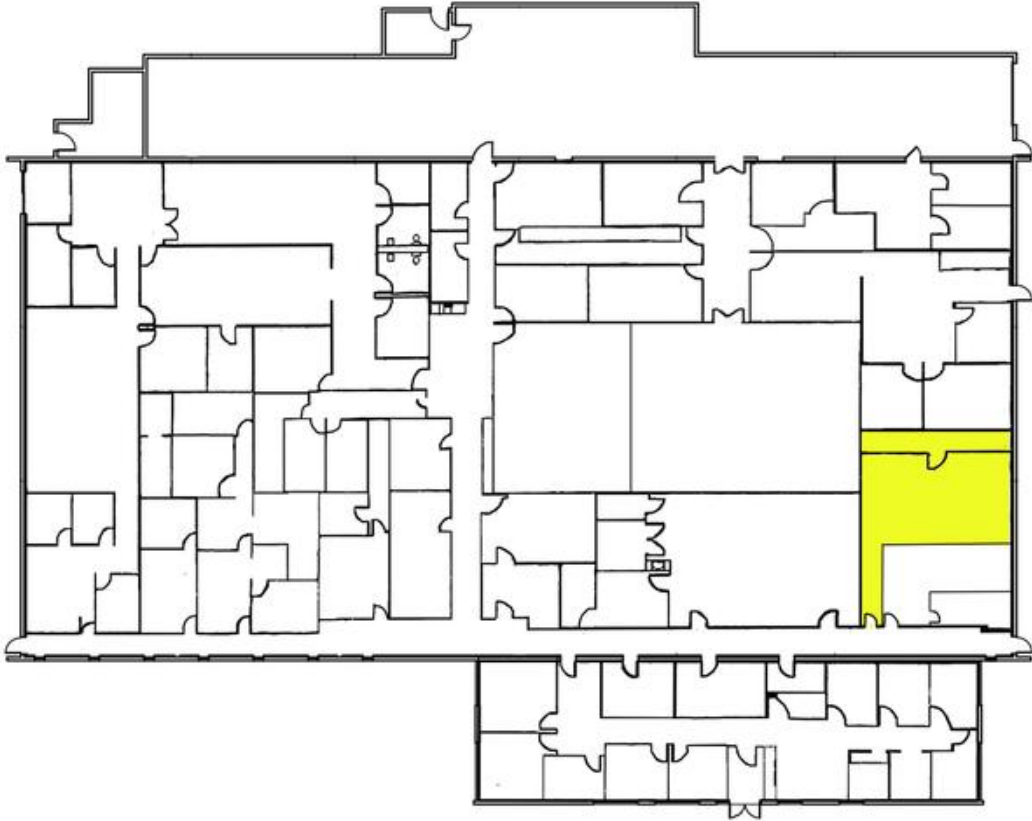

---

## Space Features:

- Prime location
  - Bright Windows
  - Newly Renovated
  - Monument Signage
  - Can be combined with  
1430 sqft of warehouse space
-



