



FOR SUBLEASE
VICTORIA TOWER
1908 N. Laurent, Victoria, Texas



VICTORIA, TX

Class A Office Sublease
13,649 RSF Available on portion of the 3rd Floor

Property Highlights

- Fitness Center
- Building deli

Space Details	
Premises	Portion of the 3 rd Floor – 13,649 RSF
Sublease Expiration	December 31, 2019
Parking	50 unreserved parking spaces
Gross Rental Rate	\$15.00/RSF with \$0.50 annual increases
Base Year	2014
Furniture	Available
Delivery Condition	“As-Is”

For more information, please contact:

Morgan Relyea Colt
Senior Director
+1 713 331 1787
morgan.relyea@cushwake.com

CUSHMAN & WAKEFIELD, INC.
Licensed Real Estate Brokers
1330 Post Oak Boulevard, Suite 2700
Houston, TX 77056
cushmanwakefield.com

Cushman & wakefield copyright 2015. No warranty or representation, express or implied, is made to the accuracy or completeness of the information contained herein, and same is submitted subject to errors, omissions, change of price, rental or other conditions, withdrawal without notice, and to any special listing conditions imposed by the property owner(s). As applicable, we make no representation as to the condition of the property (or properties) in question.



FOR SUBLEASE
VICTORIA TOWER
1908 N. Laurent, Victoria, Texas



CONFERENCE ROOM



OPEN CONCEPT



PERIMETER OFFICE



BREAKROOM

For more information, please contact:

Morgan Relyea Colt
Senior Director
+1 713 331 1787
morgan.relyea@cushwake.com

CUSHMAN & WAKEFIELD, INC.
Licensed Real Estate Brokers
1330 Post Oak Boulevard, Suite 2700
Houston, TX 77056
cushmanwakefield.com



FOR SUBLEASE
VICTORIA TOWER
1908 N. Laurent, Victoria, Texas

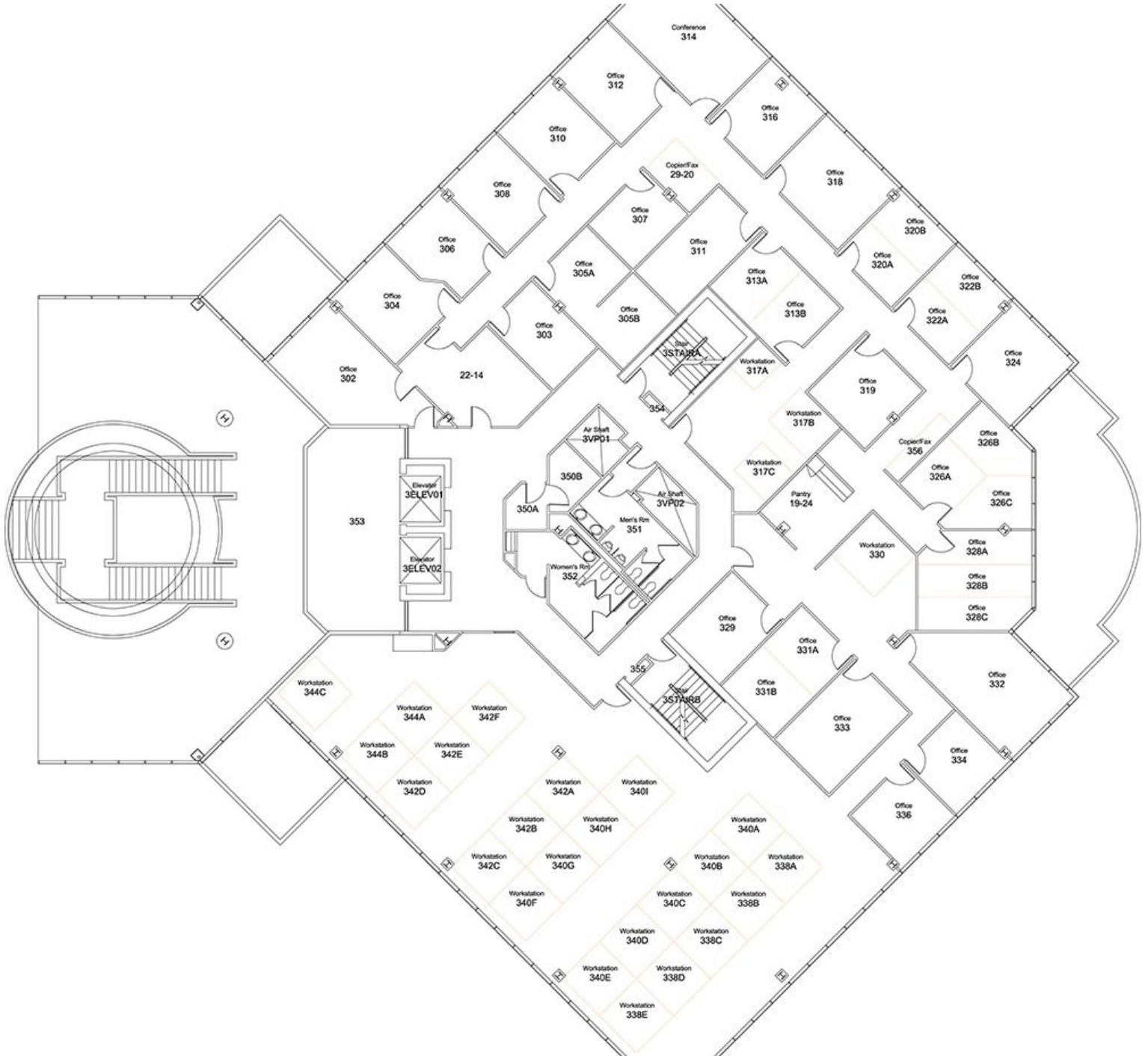

13,649 RSF

For more information, please contact:

Morgan Relyea Colt
Senior Director
+1 713 331 1787
morgan.relyea@cushwake.com

CUSHMAN & WAKEFIELD, INC.
Licensed Real Estate Brokers
1330 Post Oak Boulevard, Suite 2700
Houston, TX 77056
cushmanwakefield.com