

10965-10967 VIA FRONTERA

SAN DIEGO, CA

± 39,764 SF FLEX/MANUFACTURING BUILDING AVAILABLE

10967



10965-10967 VIA FRONTERA

San Diego, CA 92127

± 39,764 SF FLEX/MANUFACTURING SPACE

- ◆ Free-standing, Single-story Flex/Manufacturing Building
- ◆ Lease Rate from \$1.15/SF NNN
- ◆ 100% Climate Controlled
- ◆ Space from ±10,000 to 39,764 SF
- ◆ Potential uses include: R&D, Tech Manufacturing, Assembly, Warehouse and Office
- ◆ Heavy Power: 2,400 Amps, 3-Phase, 4-Wire
- ◆ Gas to Building
- ◆ Potential Secure Storage/Yard Area
- ◆ 14' to 16' Clear Height
- ◆ ± 2.9/1,000 SF parking ratio
- ◆ Grade-Level Loading
- ◆ Monument Signage
- ◆ Extensive Glassline
- ◆ Excellent Truck Access



10965-10967 Via Frontera Siteplan

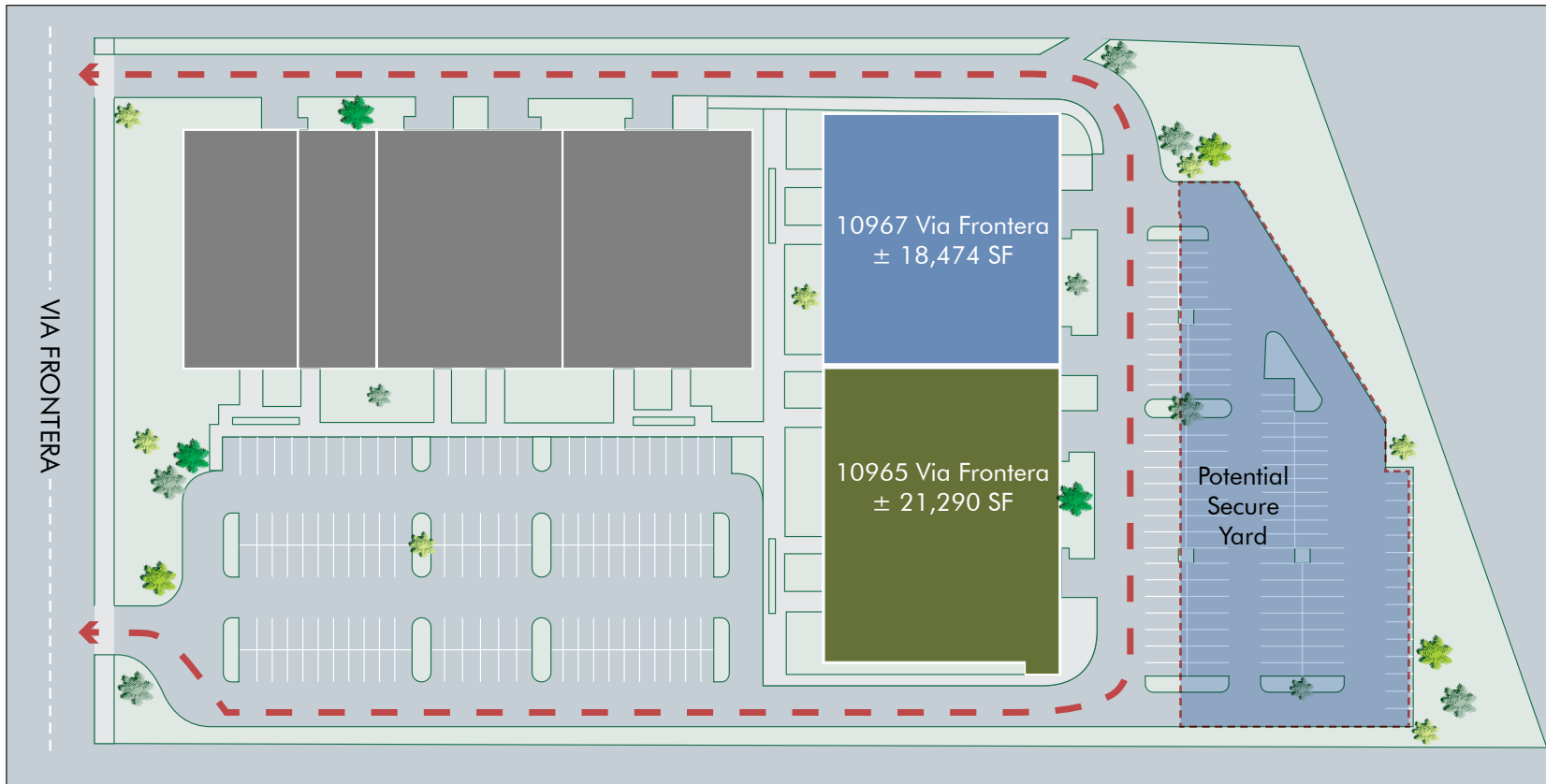

TRUCK ACCESS





10967 Via Frontera

- ± 18,474 SF OFFICE/FLEX SPACE
- TWELVE (12) OFFICES
- TWO (2) CONFERENCE ROOMS
- TWO (2) BREAK ROOMS
- LARGE RECEPTION AREA
- POTENTIAL GRADE-LEVEL LOADING
- RESTROOMS WITH SHOWERS
- WAREHOUSE/STAGING AREA



10967

10965-10967 Via Frontera Existing Floorplan

10967 Via Frontera | ± 18,474 SF

10965 Via Frontera | ± 21,290 SF

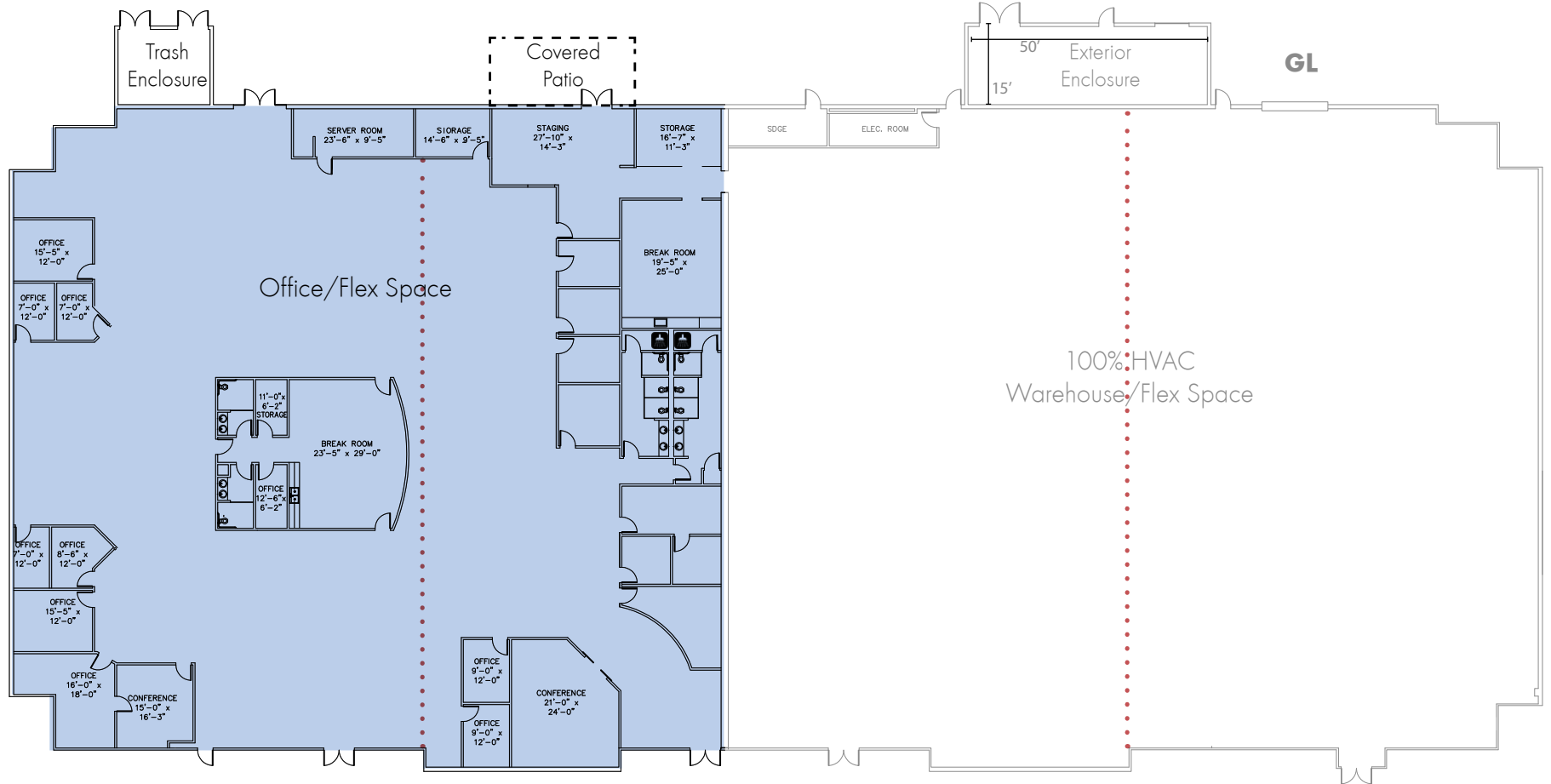

..... POTENTIAL DEMISING





10965 Via Frontera

- ± 21,290 SF
- 100% HVAC
- WAREHOUSE/FLEX SPACE
- ONE (1) GRADE-LEVEL DOOR
(Potential to add additional)
- EXTERIOR STORAGE ENCLOSURE
- READY FOR TI'S



10965

10965-10967 Via Frontera Existing Floorplan

10967 Via Frontera | ± 18,474 SF

10965 Via Frontera | ± 21,290 SF

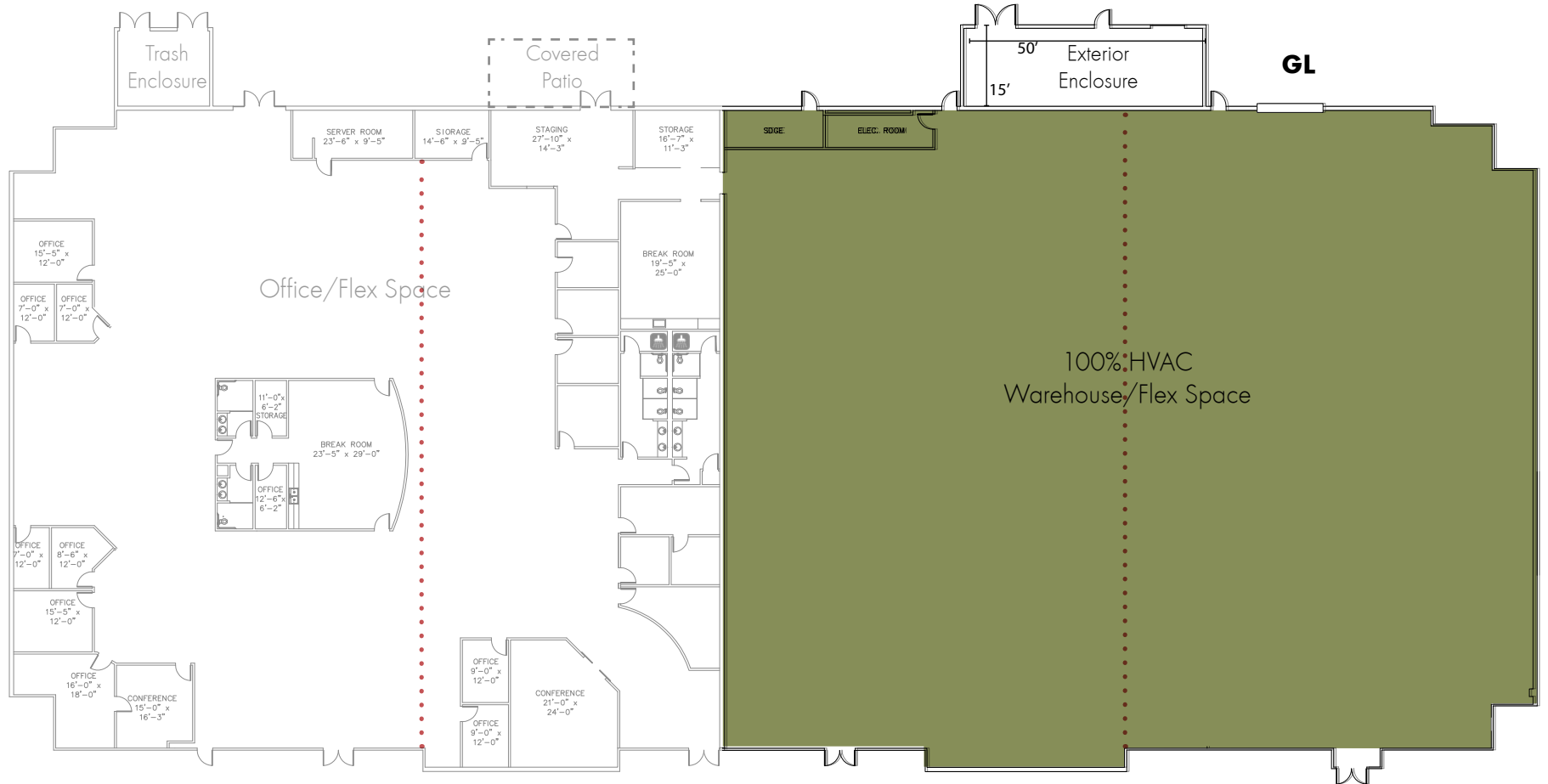

..... POTENTIAL DEMISING



10965-10967 Via Frontera Full Building Conceptual Floorplan

10967 Via Frontera | ± 18,474 SF

10965 Via Frontera | ± 21,290 SF

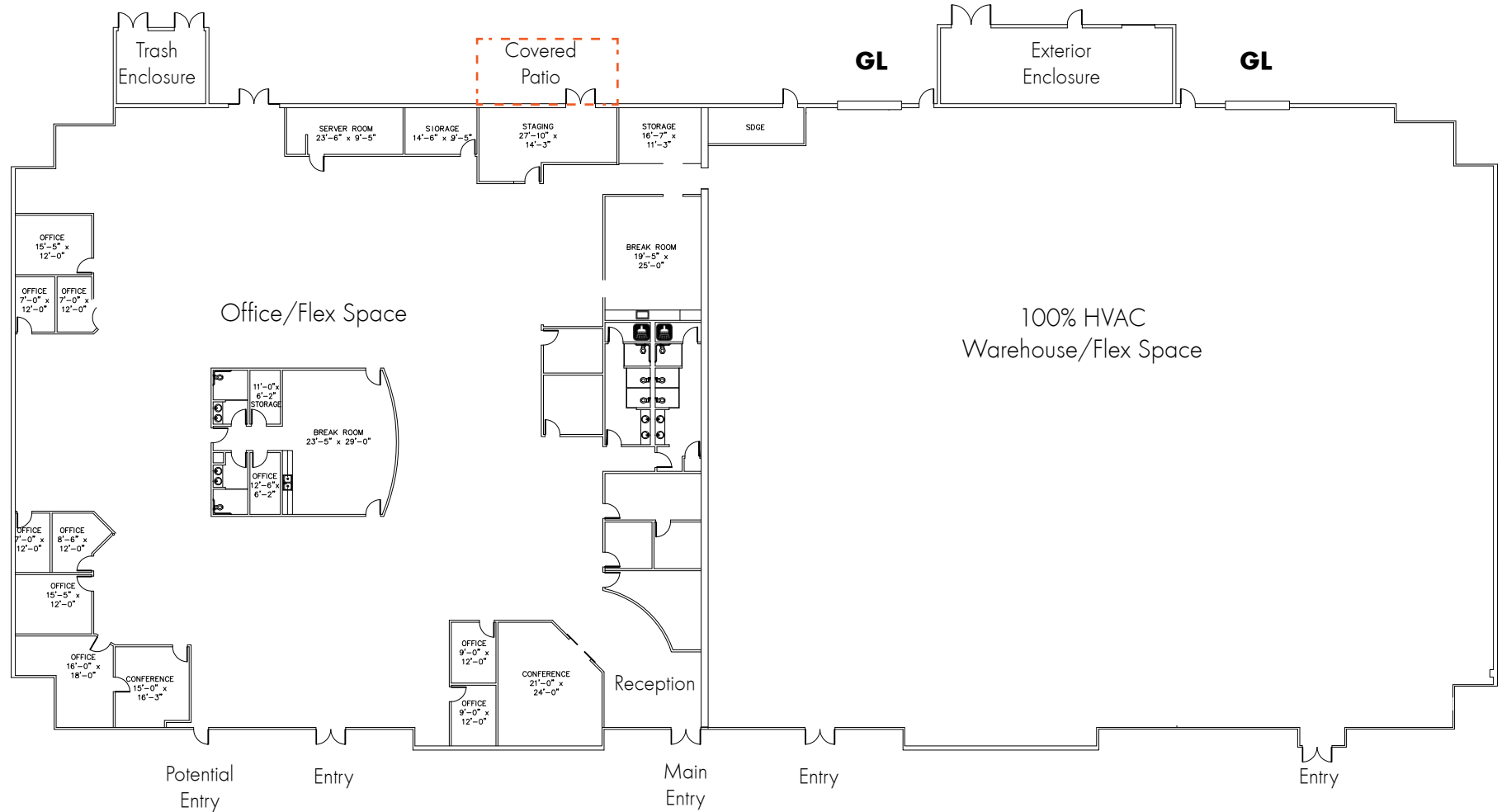

10965-10967 Via Frontera Multi-Tenant Conceptual Floorplan

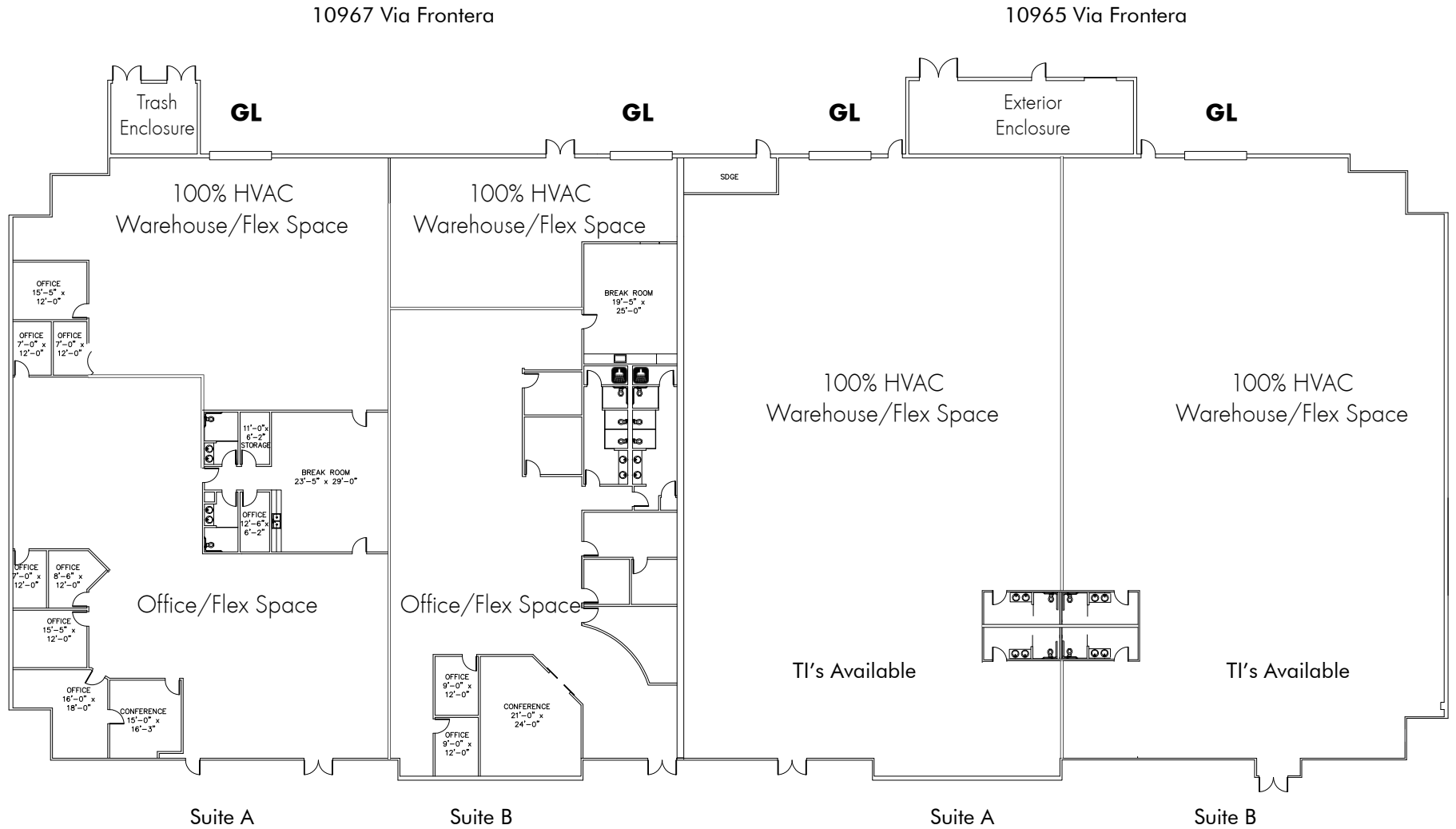

VIA FRONTERA

10965 Via Frontera
± 21,290 SF

10967 Via Frontera
± 18,474 SF

Potential
Secure
Yard



10965-10967 Via Frontera Location

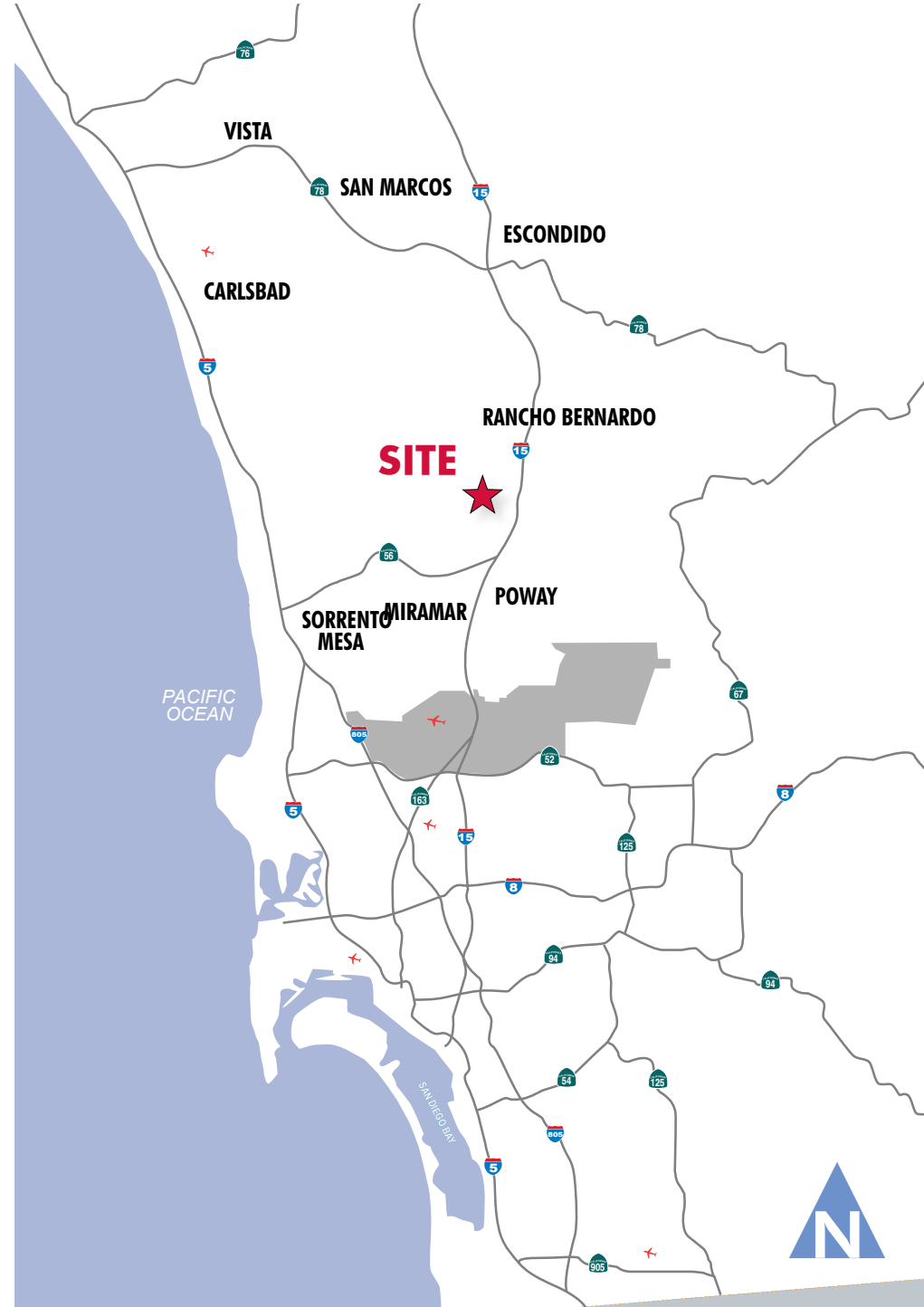
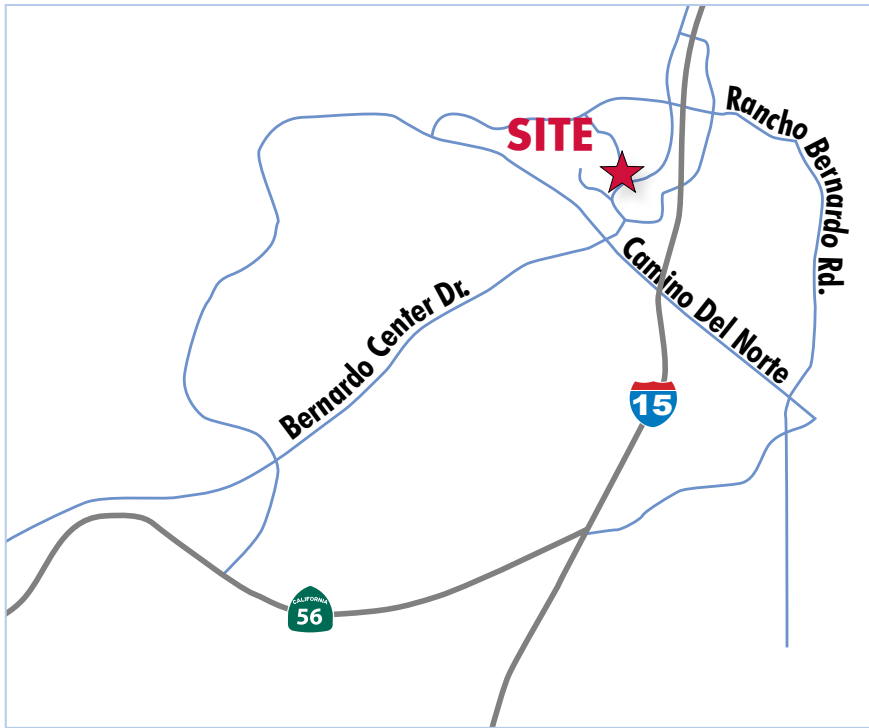

10965-10967 VIA FRONTERA

SAN DIEGO, CA

± 39,764 SF FLEX/MANUFACTURING BUILDING AVAILABLE



PLEASE CONTACT:

JUSTIN MAIOLO

Associate
858.875.3615
justin.maiolo@ngkf.com
CA RE License #01910958

PAUL BRITVAR

Associate
858.875.3609
pbritvar@ngkf.com
CA RE License #01949354

BRENT BOHLKEN

Senior Managing Director
858.875.3616
bbohlken@ngkf.com
CA RE License #01022607

4655 Executive Drive, Suite 800, La Jolla, CA 92037 T 858.875.3600 Corporate CA RE LIC #01355491 www.ngkf.com



Procuring broker shall only be entitled to a commission, calculated in accordance with the rates approved by our principal only if such procuring broker executes a brokerage agreement acceptable to us and our principal and the conditions as set forth in the brokerage agreement are fully and unconditionally satisfied. Although all information furnished regarding property for sale, rental, or financing is from sources deemed reliable, such information has not been verified and no express representation is made nor is any to be implied as to the accuracy thereof and it is submitted subject to errors, omissions, change of price, rental or other conditions, prior sale, lease or financing, or withdrawal without notice and to any special conditions imposed by our principal.