



**504 Second Street
Macon, Bibb County, Georgia 31201**

LEASE



- Centrally located in Downtown Macon corner of Second & Poplar, within blocks of Atrium Health Navicent; one mile from Mercer University.
- 680± SF Street Level Retail Space
- Renovations underway
- Zoned CBD-1
- Tenant pays all utilities.
- Neighbors: Kudzu Seafood, Famous Mikes, Your Pie, Oliver's Corner Bistro, Decadent (Coffee & Dessert Bar), Barefoot Tavern, Ocmulgee Brew Pub, Ambitious Graphics, Kin Jo

LEASE RATE: \$1,000 PER MONTH

CBCMACON.COM

DEIDRA STEWART
478.746.8171 Office • 478.508.2652 Cell
deidra@cbcworldwide.com



CBCWORLDWIDE.COM

COLDWELL BANKER COMMERCIAL EBERHARDT & BARRY 990 Riverside Drive Macon, GA 31201 (478) 746-8171

Revised 9/21/21



FLOOR PLAN

504 Second Street
Macon, Bibb County, Georgia 31201

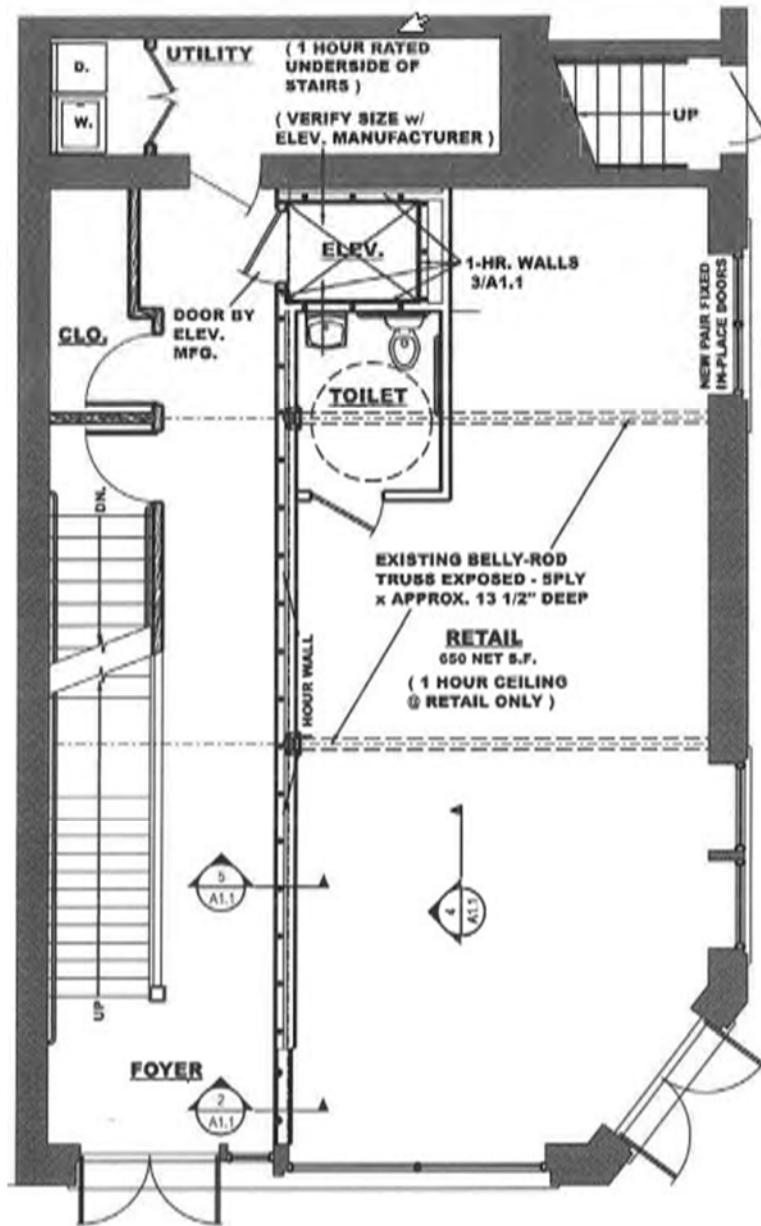



PHOTOS

504 Second Street
Macon, Bibb County, Georgia 31201

“RENOVATIONS UNDERWAY”





MAPS

504 Second Street
Macon, Bibb County, Georgia 31201

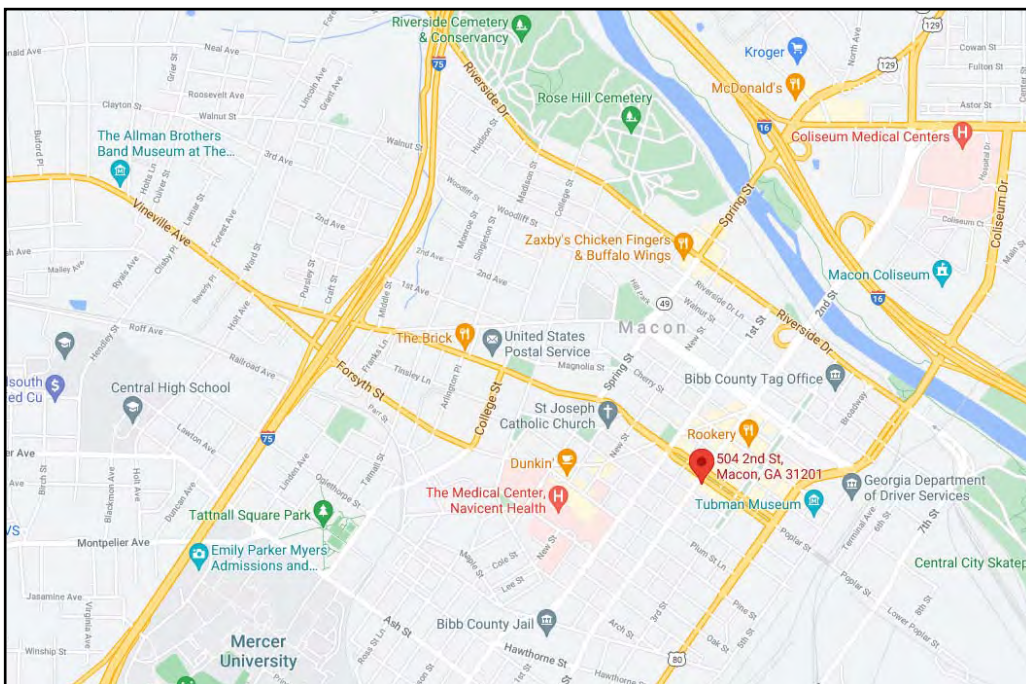

DEIDRA STEWART
 478.746.8171 Office • 478.508.2652 Cell
 deidra@cbcworldwide.com

CBCMACON.COM



DEMOGRAPHICS - BIBB COUNTY

504 Second Street
Macon, Bibb County, Georgia 31201

KEY FACTS

156,171

Population



Average Household Size

37.2

Median Age

\$40,970

Median Household Income

EDUCATION

13%

No High School Diploma



31%
High School Graduate



28%
Some College



28%
Bachelor's/Grad/Prof Degree

BUSINESS



6,494

Total Businesses



87,592

Total Employees

EMPLOYMENT



65%

White Collar



18%

Blue Collar



16%

Services



Unemployment Rate

INCOME



\$40,970

Median Household Income



\$24,379

Per Capita Income



\$24,540

Median Net Worth

Households By Income

The largest group: <\$15,000 (19.3%)

The smallest group: \$150,000 - \$199,999 (3.3%)

Indicator ▲	Value	Difference	
<\$15,000	19.3%	+8.5%	
\$15,000 - \$24,999	12.8%	+3.6%	
\$25,000 - \$34,999	11.7%	+2.4%	
\$35,000 - \$49,999	13.0%	+0.3%	
\$50,000 - \$74,999	14.8%	-2.9%	
\$75,000 - \$99,999	12.2%	-0.3%	
\$100,000 - \$149,999	9.1%	-5.5%	
\$150,000 - \$199,999	3.3%	-2.9%	
\$200,000+	3.8%	-3.3%	