

EXISTING BUILDING
PARKING SPACES
3241 SQ. FT. / 200 ± 10 SPACES
PLUS ONE ACCESSIBLE SPACE

PROPOSED PARKING
31 SPACES ± 3 ACCESSIBLE
SPACES

PROPOSED BUILDING
PARKING SPACES
1840 SQ. FT. / 200 ± 10 SPACES
PLUS ONE ACCESSIBLE SPACE

1 SITE PLAN
SCALE: 1" = 20'-0"

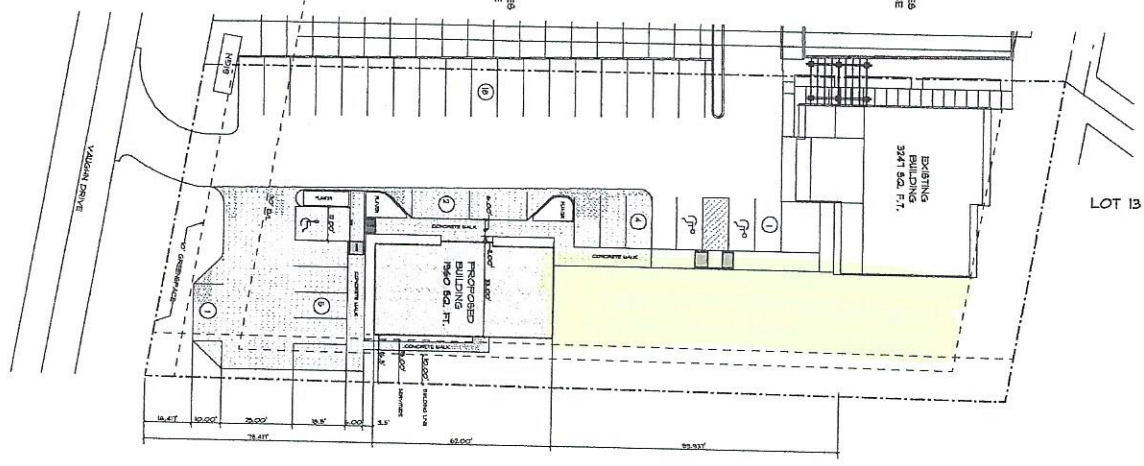

2 ACCESSIBLE PARKING DETAIL
DO NOT SCALE

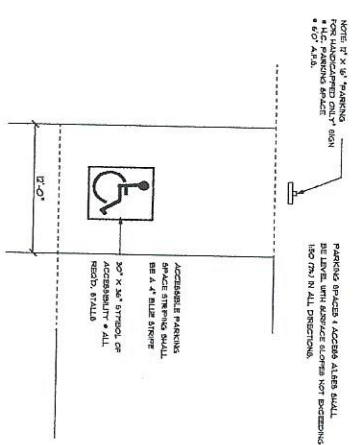

3 TYPICAL PAVEMENT SECTION
DO NOT SCALE

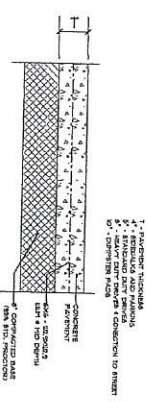

4 EXPANSION JOINT (E.J.)
DO NOT SCALE

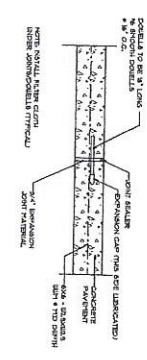

5 LONGITUDINAL JOINT (KEYWAY) (L.J.)
DO NOT SCALE

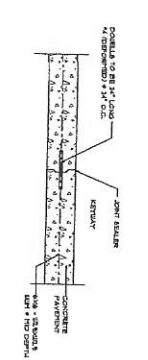

6 CONTRACTION JOINT (C.J.)
DO NOT SCALE

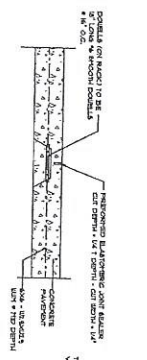

PAVING NOTES

1. ALL PAVEMENT AND DRIVE SHALL BE CONCRETE (C40) IN PLACE 3000 PSI.
2. 2" MIN. THICKNESS SHALL BE 4" MIN. THICKNESS OF 4" SLABS UNLESS OTHERWISE NOTED.
3. 2" MIN. THICKNESS SHALL BE 4" MIN. THICKNESS OF 4" SLABS UNLESS OTHERWISE NOTED.
4. ALL PAVEMENT SHALL BE 4" MIN. THICKNESS OF 4" SLABS UNLESS OTHERWISE NOTED.
5. ALL PAVEMENT SHALL BE 4" MIN. THICKNESS OF 4" SLABS UNLESS OTHERWISE NOTED.
6. ALL PAVEMENT SHALL BE 4" MIN. THICKNESS OF 4" SLABS UNLESS OTHERWISE NOTED.
7. ALL PAVEMENT SHALL BE 4" MIN. THICKNESS OF 4" SLABS UNLESS OTHERWISE NOTED.
8. ALL PAVEMENT SHALL BE 4" MIN. THICKNESS OF 4" SLABS UNLESS OTHERWISE NOTED.
9. ALL PAVEMENT SHALL BE 4" MIN. THICKNESS OF 4" SLABS UNLESS OTHERWISE NOTED.
10. ALL PAVEMENT SHALL BE 4" MIN. THICKNESS OF 4" SLABS UNLESS OTHERWISE NOTED.

PERMIT
SET - 10/21/21

| | | | |
|--|--|---|---|
| | LANGLOIS ENGINEERING, INC. GERARD W. LANGLOIS, P.E. 11528 FENYWOOD AVENUE BATON ROUGE, LOUISIANA 70804 PH 225-293-8730 PAGER 225-577-1453 | BUILDING PLANS FOR: SAJA PROPERTIES BUILDING L - ANTONIA PROFESSIONAL OFFICE PLAZA HWY 1 SOUTH, PORT ALLEN, W.B.R.P., LA. | • SITE PLAN • ACCESSIBLE PARKING DETAIL • PAVING DETAILS |
| | OCT. 21, 2021 NGS GILL | PERMIT SET - 10/21/21 5-1 of 2 C3493-10 | NOTE: THIS SHALL BE NOT RECORDED AND RETURNED TO THE ORIGINAL SUBMITTER UPON COMPLETION OF THE PROJECT. |

SAVA PROPERTIES
 BUILDING L - ANTONIA PROFESSIONAL OFFICE PLAZA
 HWY 1 SOUTH, FORT ALLEN, W.B.R.P., LA.

LANGLOIS ENGINEERING, INC.
 GERARD W. LANGLOIS, P.E.
 1128 PENNWOOD AVENUE
 BATON ROUGE, LOUISIANA 70809
 PH 225-293-8730 FAXER 225-377-1453



NOTE: THIS PLAN IS NOT
 TO BE USED FOR CONSTRUCTION
 UNLESS THE OWNER HAS
 OBTAINED ALL NECESSARY
 PERMITS AND APPROVALS
 FROM THE APPROPRIATE
 AGENCIES.

DATE: JAN. 28, 2022
 PROJECT: NCIB
 DRAWN BY: GUIL

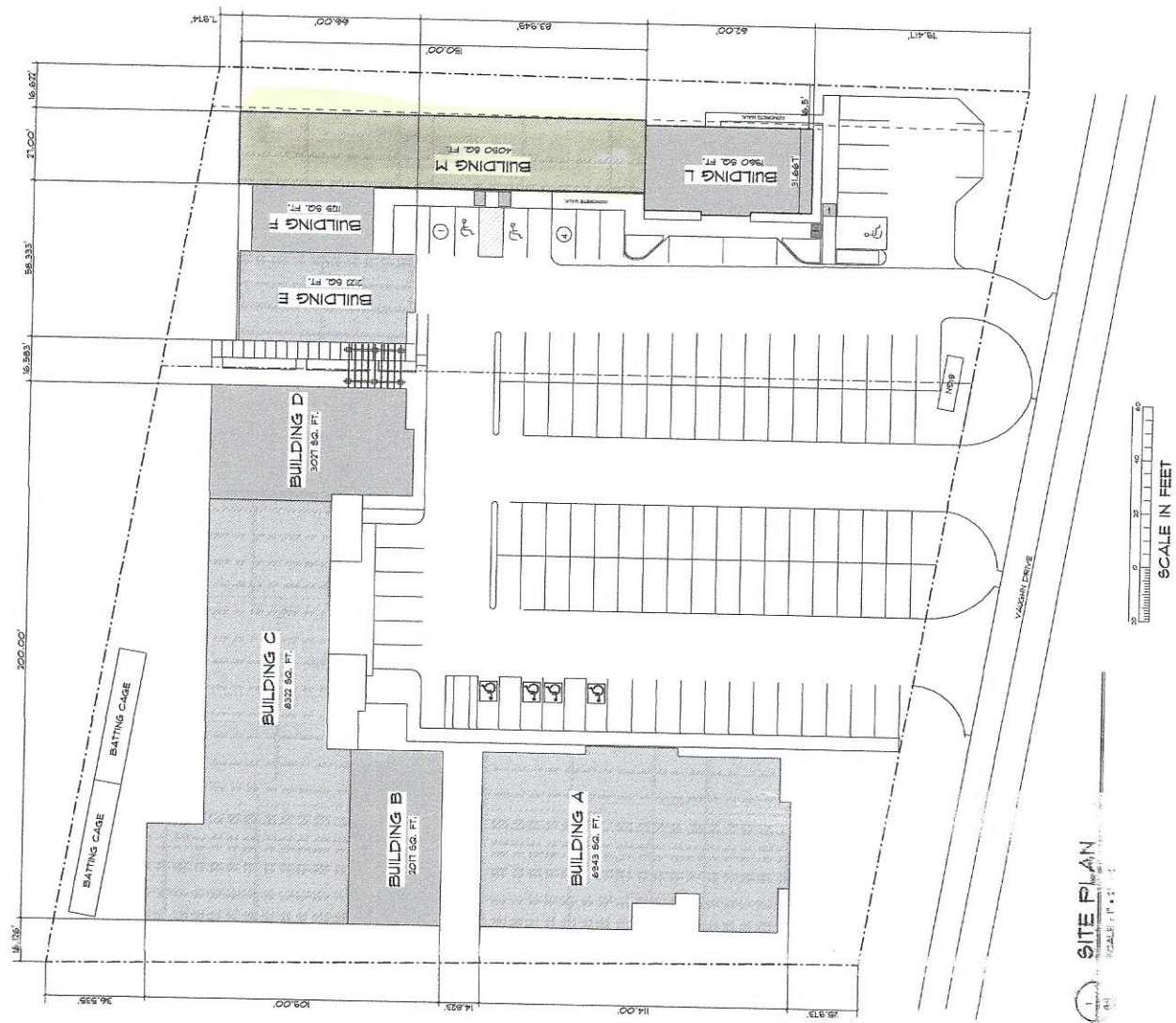

1 SITE PLAN
 SCALE: 1" = 100'