

515 Main Street

Presque Isle, Maine



Office 764-4600

Fax 207-517-6860

PRIME MULTI PURPOSE COMMERCIAL BUILDING

260 Missile St. Presque Isle, Maine

24,000 square feet, \$1,350,000



Prime commercial space available in the Presque Isle industrial park. With 24,000 square feet of space, this steel frame building offers the flexibility to accommodate a wide range of businesses. The newest section, built in 1989 is a 120-foot by 60-foot clear span structure with a wide-open floor plan, with office space added in 2008, and employee bathrooms. The ceilings are 24 foot high at the center with T5 lighting and 3, 100 amp bus ways. The middle section is also 120 foot by 60 foot with the same power and lighting. The 400-amp diesel back up generator is in this section. A railroad spur provides access to rail for drop off or shipping. The main office portion of the building measures 120 foot by 80 foot and this houses all of the offices and space for production, as well as bathrooms and break rooms. A new Smith boiler furnace was installed in 2008. There is an in ground 2000 gallon fuel oil tank for the furnace.

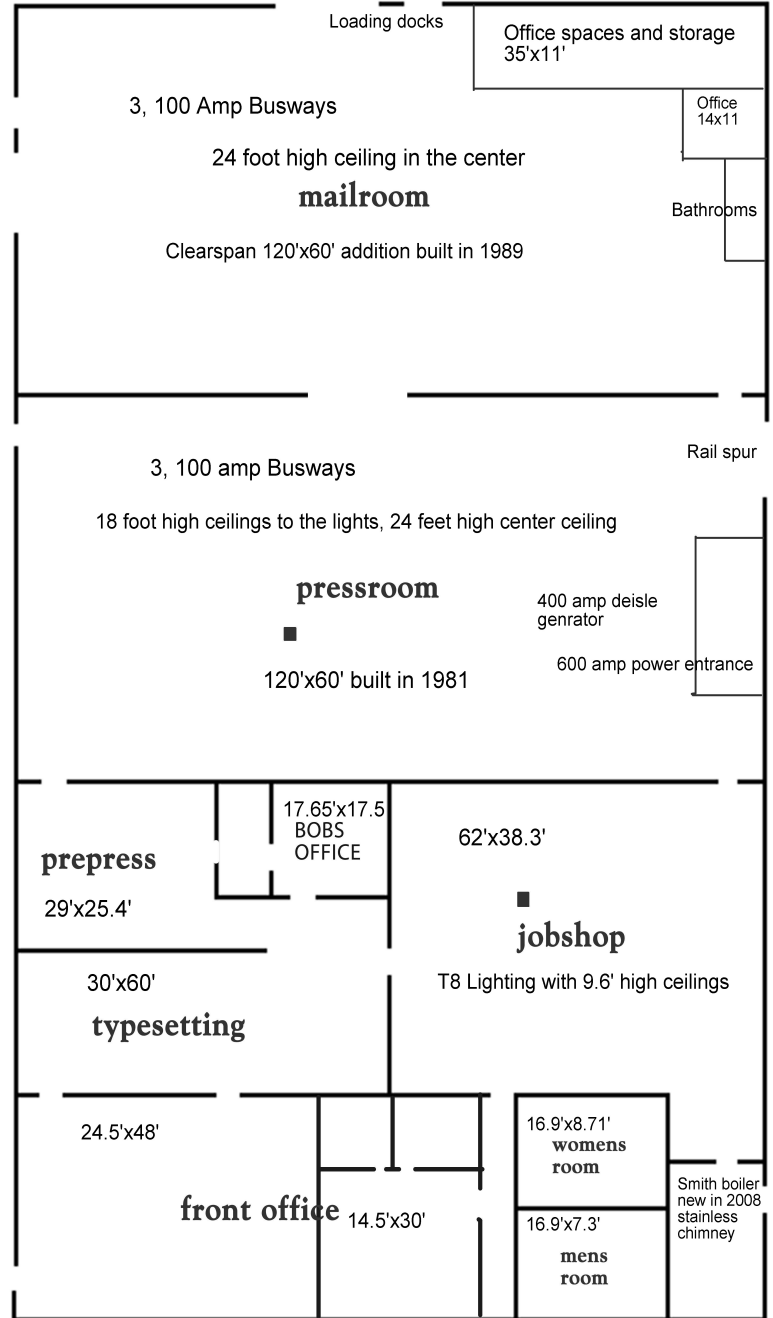

Call Mike Willette for more detailed info, 207-227-5989

Scan QR-Code to view the listing.

