



SOUTHLAKE OAKS PLAZA FOR LEASE

8235 Douglas Ave
Suite 720
Dallas, Texas 75225
T 214.378.1212
venturedfw.com

W. SOUTHLAKE BLVD & SHADY OAKS DR
SOUTHLAKE, TX



TIM HENSON THENSON@VENTUREDFW.COM | BENJAMIN HINES BHINES@VENTUREDFW.COM

LOCATION

W. SOUTHLAKE BLVD & SHADY OAKS DR
SOUTHLAKE, TX

SIZE

WEST BUILDING **EAST BUILDING**
20,582 SF 16,865 SF

AVAILABLE SPACES

SUITE 1 **SUITE 9**
5,357 SF 975 SF

SUITE 4 **SUITE 12**
1,625 SF 1,050 SF

SUITE 7
1,250 SF

TRAFFIC COUNTS

W. SOUTHLAKE BLVD **SHADY OAKS DR**
41,054 VPD 3,393 VPD

AREA ATTRACTIONS



BICENTENNIAL PARK
& PLAYGROUND

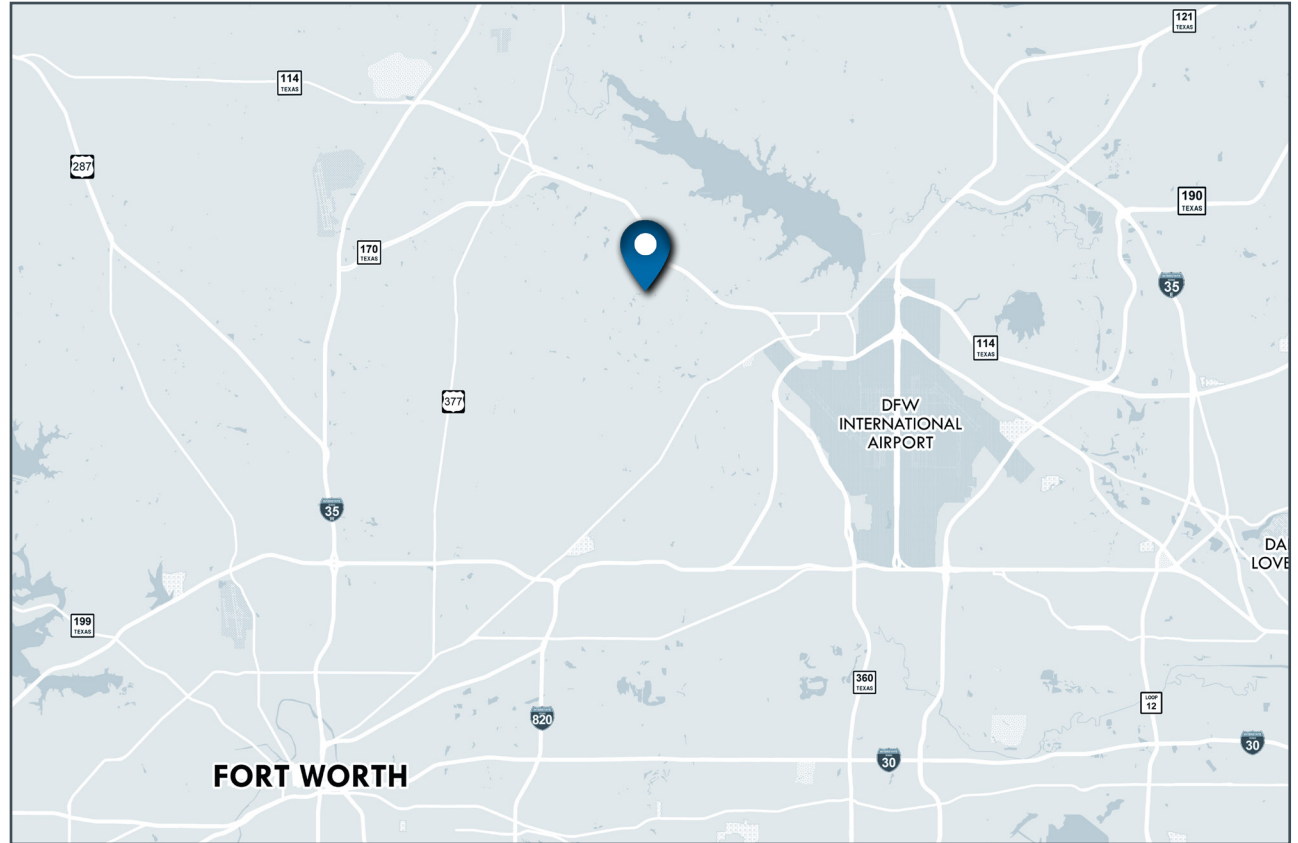

2018 DEMOGRAPHIC SUMMARY

	1 MILE	3 MILES	5 MILES
EST. POPULATION	7,684	48,526	150,325
EST. DAYTIME POPULATION	2,403	30,058	69,594
EST. AVG. HH INCOME	\$303,534	\$272,713	\$194,563

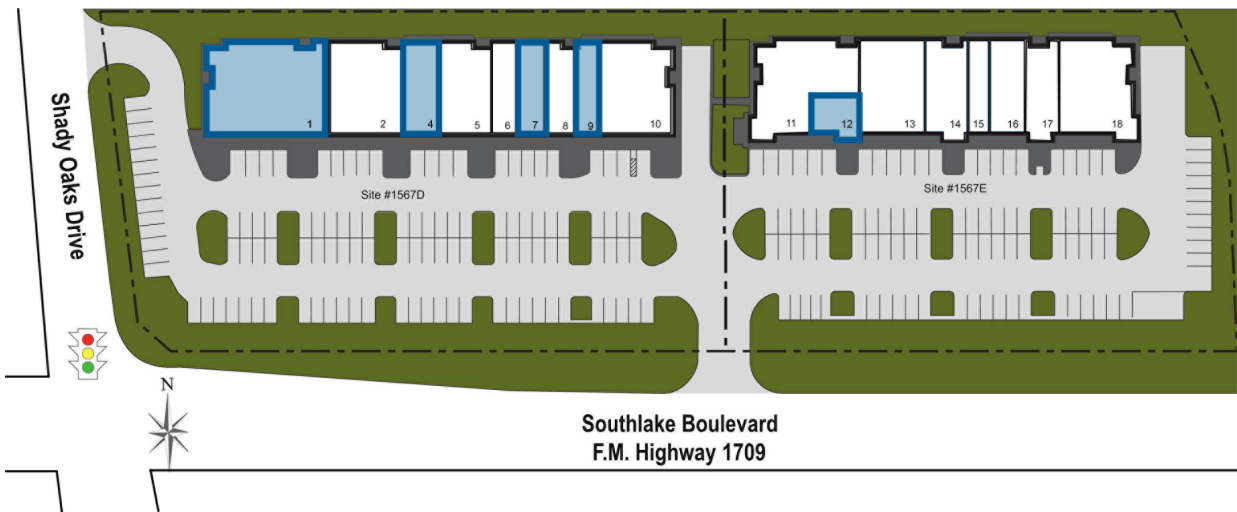

UNIT TENANTS

SF

1 AVAILABLE	5,357
2 Massage Luxe	3,170
4 AVAILABLE	1,625
5 Allegiance Title Company	2,365
6 Ida Nail of Southlake	1,105
7 AVAILABLE	1,250
8 Enclave Dental	1,675
9 AVAILABLE	975
10 Sushi Sam	3,060
11 Fuzzy's Taco Shop	3,496
12 AVAILABLE	1,050
13 Gracie Barra	2,925
14 Huntington Learning Center	1,975
15 Southlake Driving School	975
16 Club Pilates	1,625
17 Rohini Bajaj, DDS	1,500
18 Cook Children's Physician	3,319







8235 Douglas Ave
Suite 720
Dallas, TX 75225
T 214.378.1212
venturedfw.com

TIM HENSON
Partner
214.378.1212
thenson@venturedfw.com

BENJAMIN HINES
Assistant Vice President
214.378.1212
bhines@venturedfw.com