

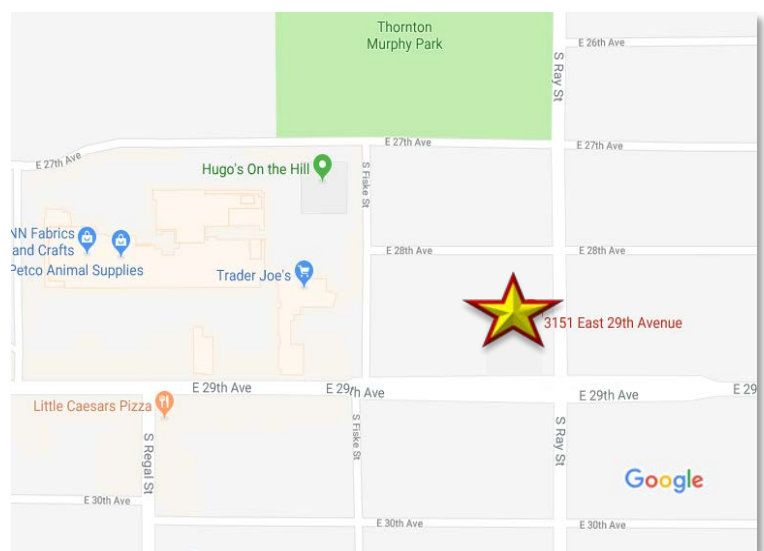

3151 E. 29th Ave., Spokane, WA 99223

Two Suites Available: 1,750 RSF+/- Each:

- Built-Out as Medical.
 - Spacious Lobby.
 - Reception w/built-in Counter & Desk.
 - Kitchenette (sink, counter, built-in cupboards).
 - Built-in Work Counter, Utility & Exam Sinks, Cabinets, and Cupboards throughout.
- Each Suite provides Office, Treatment, Exam and, Storage Rooms. (See floor plans for details)
- Visibility: Corner Location.
 - Two Monumental Signs (2-sided).
 - Along Ray: 19,700 ADT.
 - Along 29th: 17,900 ADT.
- Parking: 34 Paved & Stripped.
- Co-Tenants: Inland Endodontics, and Larry Ham Physical Therapy.
- Parcel #: 35273.0306



For more information, contact:

Mark C. McLees

+1 509 622 3554 • mmclees@naiblack.com

Tom Hix

+1 509 622 3502 • thix@naiblack.com

Lease Rate: \$13.50/SF NNN



North Exterior-1st Floor Entry



1st Floor Entry & Hall

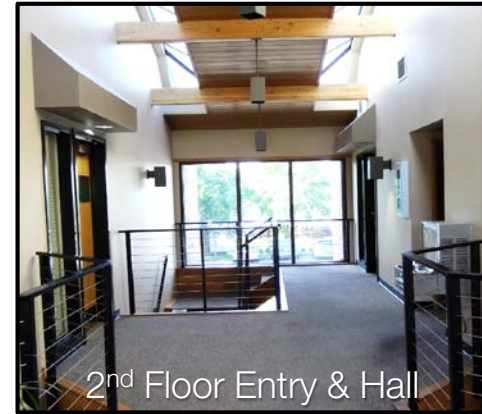

2nd Floor Entry & Hall



For More Information, Contact:

Mark C. McLees
+1 509 622 3554
mmclees@naiblack.com

Tom Hix
+1 509 622 3502
thix@naiblack.com

3151 E. 29th Ave.



Lobby Reception Counter



Dental Treatment Area



Exec. or Admin. Office



Kitchenette



Treatment Room Dividers



Typical Exam Room



Washer/Dryer - 2nd Entry Office



Work Counter, Sink & Cupboard



X-Ray Room

For More Information, Contact:

Mark C. McLees

+1 509 622 3554

mmclees@naiblack.com

Tom Hix

+1 509 622 3502

thix@naiblack.com



Black Commercial, Inc.
801 W. Riverside Ave, Suite 300
Spokane, WA 99201
+1 509 623 1000
naiblack.com

Draft Sketch Floor Plan

Suite 101

3151 E. 29th Ave.

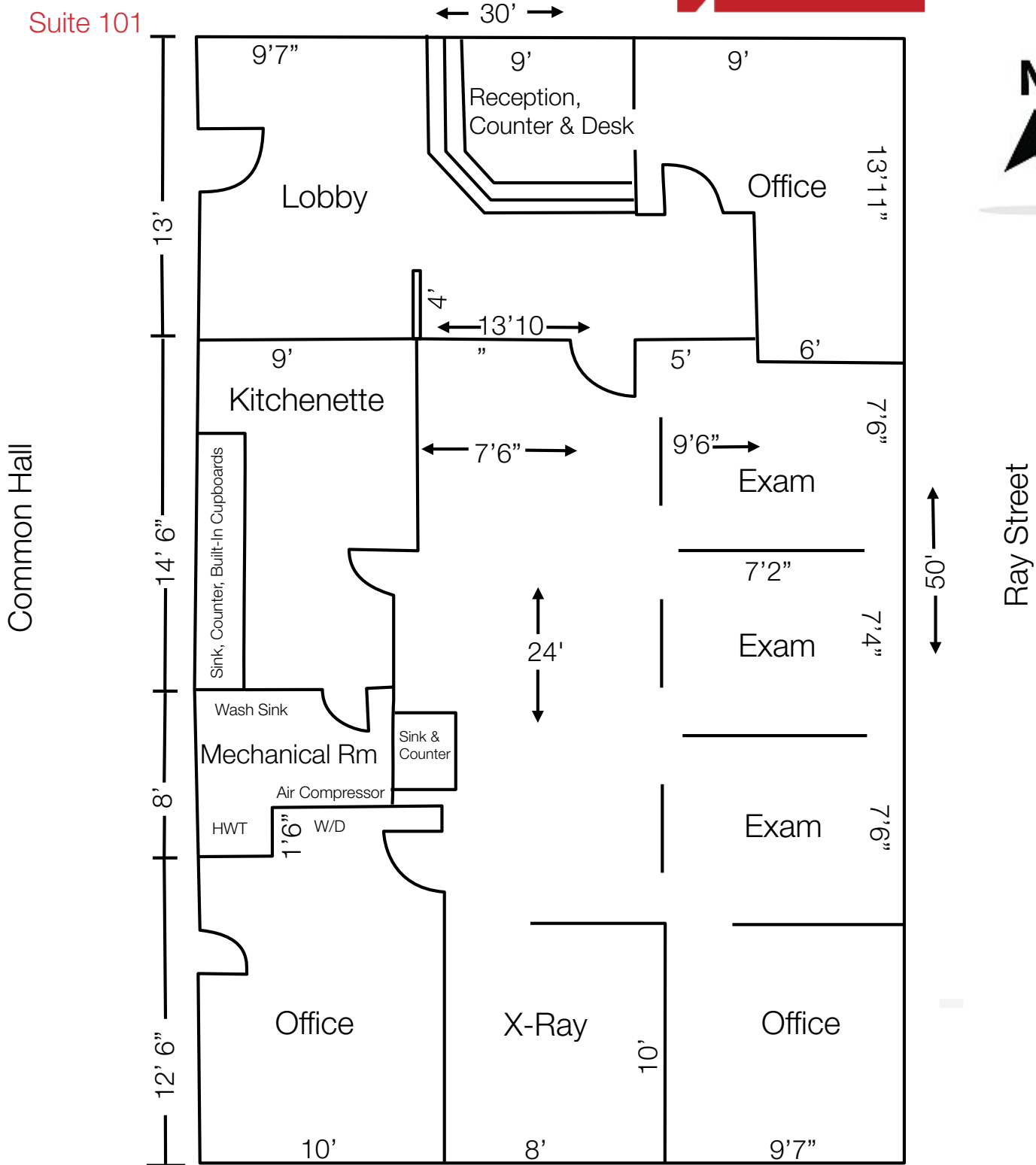

For More Information, Contact:

Mark C. McLees

+1 509 622 3554 • mmclees@naiblack.com

DISCLOSURE:

Building measurements are estimates and to be verified by Tenant.

Tom Hix

+1 509 622 3502 • thix@naiblack.com



NO WARRANTY OR REPRESENTATION, EXPRESS OR IMPLIED, IS MADE AS TO THE ACCURACY OF THE INFORMATION CONTAINED HEREIN, AND THE SAME IS SUBMITTED SUBJECT TO ERRORS, OMISSIONS, CHANGE OF PRICE, RENTAL OR OTHER CONDITIONS, PRIOR SALE, LEASE OR FINANCING, OR WITHDRAWAL WITHOUT NOTICE, AND OF ANY SPECIAL LISTING CONDITIONS IMPOSED BY OUR PRINCIPALS. NO WARRANTIES OR REPRESENTATIONS ARE MADE AS TO THE CONDITION OF THE PROPERTY OR ANY HAZARDS CONTAINED THEREIN OR ANY TO BE IMPLIED.

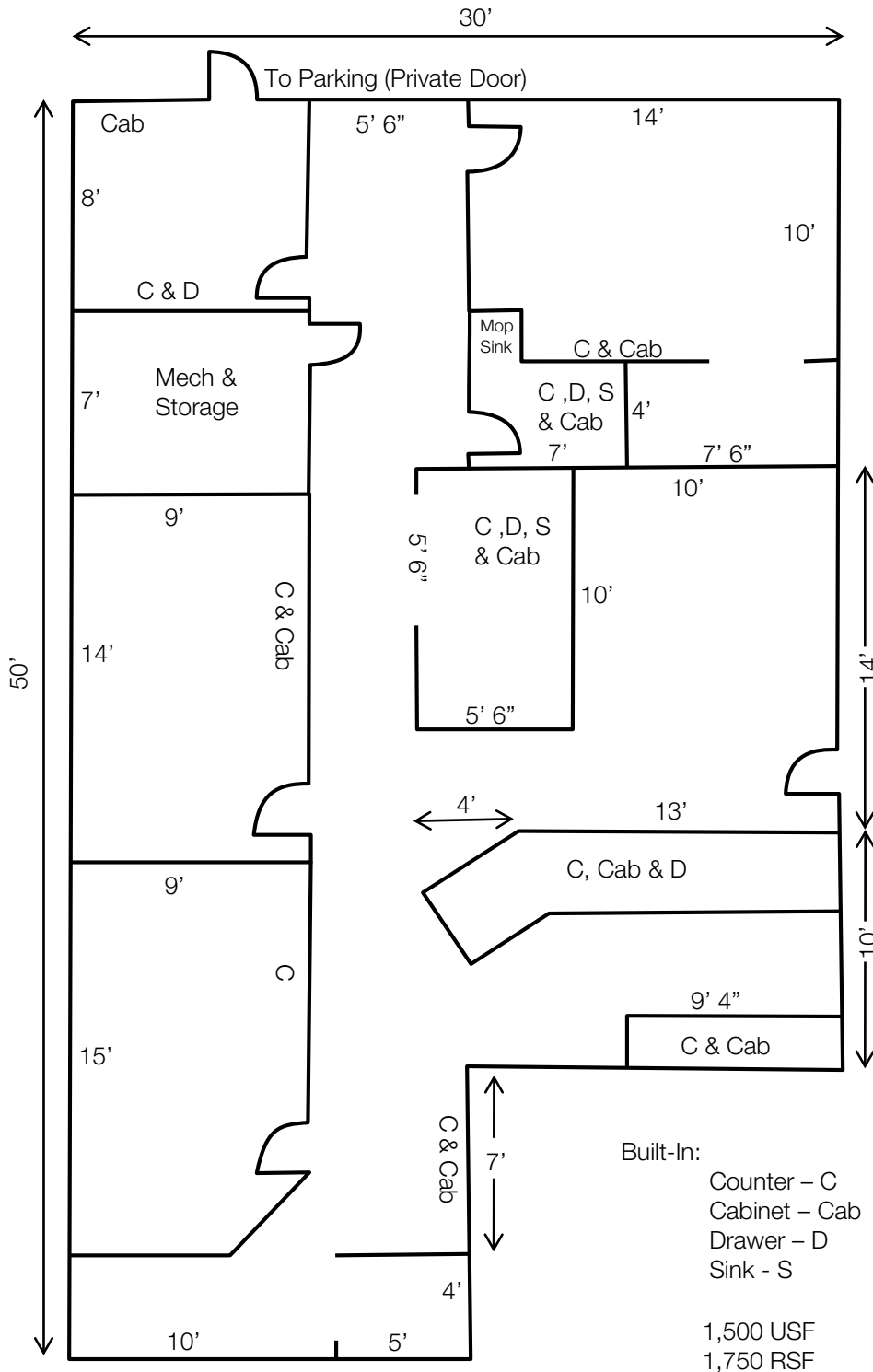

Common Entry & Hall

Common Restrooms

Built-In:
Counter – C
Cabinet – Cab
Drawer – D
Sink – S

1,500 USF
1,750 RSF

DISCLOSURE:
Building measurements are estimates and to be verified by Tenant.

For More Information, Contact:
Mark C. McLees
+1 509 622 3554 • mmclees@naiblack.com

Tom Hix
+1 509 622 3502 • thix@naiblack.com



NO WARRANTY OR REPRESENTATION, EXPRESS OR IMPLIED, IS MADE AS TO THE ACCURACY OF THE INFORMATION CONTAINED HEREIN, AND THE SAME IS SUBMITTED SUBJECT TO ERRORS, OMISSIONS, CHANGE OF PRICE, RENTAL OR OTHER CONDITIONS, PRIOR SALE, LEASE OR FINANCING, OR WITHDRAWAL WITHOUT NOTICE, AND OF ANY SPECIAL LISTING CONDITIONS IMPOSED BY OUR PRINCIPALS. NO WARRANTIES OR REPRESENTATIONS ARE MADE AS TO THE CONDITION OF THE PROPERTY OR ANY HAZARDS CONTAINED THEREIN OR ANY TO BE IMPLIED.