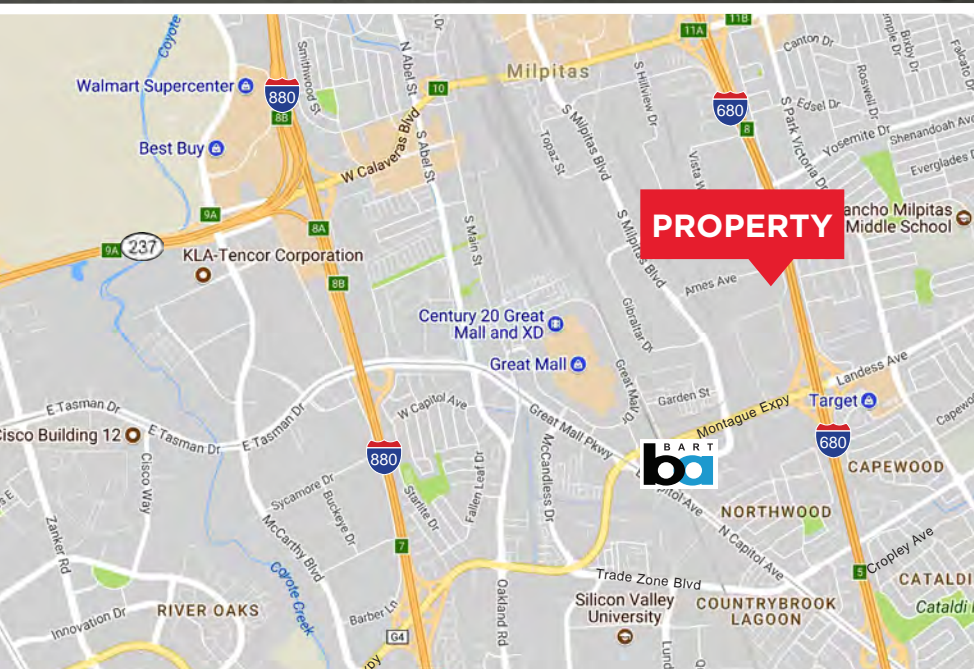

**1053 SINCLAIR FRONTAGE ROAD**

Milpitas, CA

**±30,200 SF OF MANUFACTURING/WAREHOUSE SPACE FOR LEASE****PROPERTY HIGHLIGHTS**

- ±30,200 SF Manufacturing/Warehouse Space with ±1,450 SF of HVAC Office
- 2 Grade Level Doors on Sinclair Frontage Road
- Fenced Enclosed Dock Loading Area with 2 Overhead Doors
- Heavy Power
- Energy Efficient Lighting
- Skylights Throughout
- Foam Insulated Roof
- Sprinklered
- Additional ±10,000 SF of Available Manufacturing/Warehouse Space
- Easy Access to Montague Expressway,  ,  and Highway 
- Do Not Disturb Tenant
- Tour By Appointment Only

**CONTACT****FRED EDER**

P +1 408 436 3656

fred.eder@cushwake.com

LIC #00949342

Cushman & Wakefield Copyright 2020 No warranty or representation, express or implied, is made to the accuracy or completeness of the information contained herein, and same is submitted subject to errors, omissions, change of price, rental or other conditions, withdrawal without notice, and to any special listing conditions imposed by the property owner(s). As applicable, we make no representation as to the condition of the property (or properties) in question.



## CONTACT

**FRED EDER**  
P +1 408 436 3656  
fred.eder@cushwake.com  
LIC #00949342

Cushman & Wakefield Copyright 2020. No warranty or representation, express or implied, is made to the accuracy or completeness of the information contained herein, and same is submitted subject to errors, omissions, change of price, rental or other conditions, withdrawal without notice, and to any special listing conditions imposed by the property owner(s). As applicable, we make no representation as to the condition of the property (or properties) in question.





MANUFACTURING/WAREHOUSE SPACE FOR LEASE

# 1053 SINCLAIR FRONTAGE ROAD

Milpitas, CA

## FLOOR PLAN

1053 SINCLAIR FRONTAGE ROAD: ±30,200 SF

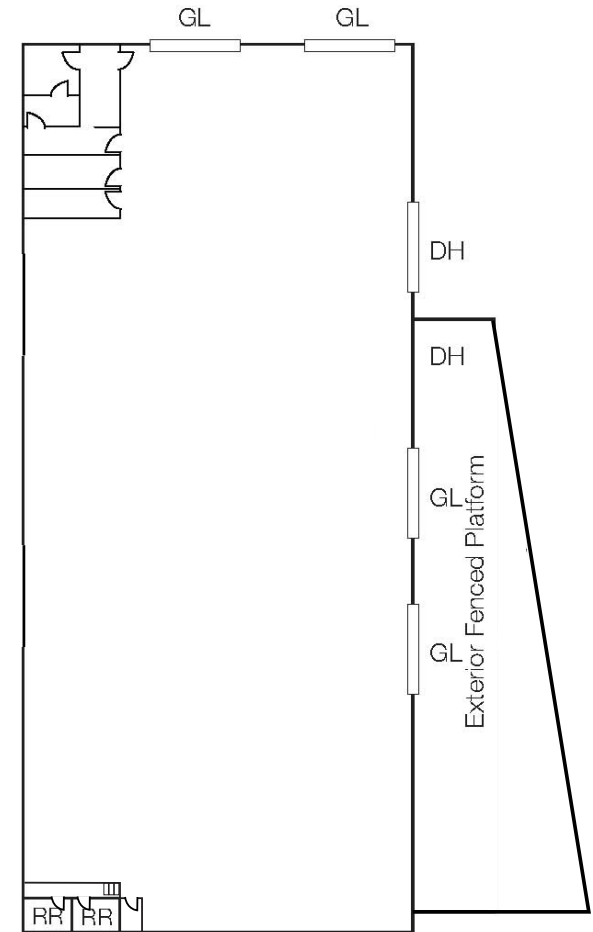

## CONTACT

**FRED EDER**  
P +1 408 436 3656  
fred.eder@cushwake.com  
LIC #00949342

Cushman & Wakefield Copyright 2020. No warranty or representation, express or implied, is made to the accuracy or completeness of the information contained herein, and same is submitted subject to errors, omissions, change of price, rental or other conditions, withdrawal without notice, and to any special listing conditions imposed by the property owner(s). As applicable, we make no representation as to the condition of the property (or properties) in question.

## MILPITAS BART STATION & TRANSPORTATION

- Projected 20,000 daily passengers in 2030
- Less than 60-minute trip to San Francisco
- Trains arrive every 7.5 minutes (Milpitas Station will be served by two BART lines that operate every 15 minutes)
- Ground level concourse, below-ground boarding platforms
- Seamless connection to VTA's Montague Light Rail Station
- Multi-story parking garage next to station
- Convenient private shuttle and "Kiss-and-Ride" loading areas
- VTA bus transit center, providing a connection with local, limited-stop and express bus services throughout Silicon Valley
- On-site bicycle storage room

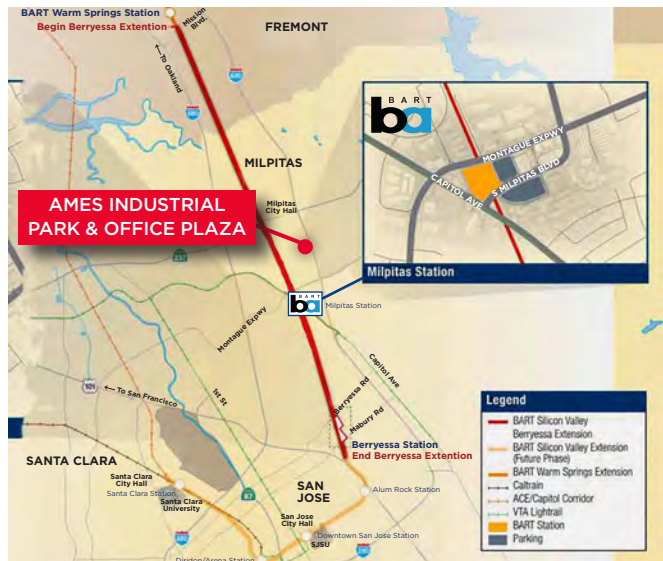

Located at the intersection of Montague Expressway and Capitol Avenue near the Great Mall in Milpitas, the Milpitas BART station is currently under construction and is tentatively scheduled to open in 2020. The Milpitas BART Station is the center of the City's Transit Area Specific Plan, and will be the BART system's gateway to Silicon Valley, serving as a key local and regional connection for the high-tech, job-rich northwestern areas of Santa Clara County via adjacent Light Rail Station and VTA Transit Bus Center.

Source: VTA and BART Websites

## CONTACT

**FRED EDER**  
P +1 408 436 3656  
fred.eder@cushwake.com  
LIC #00949342

Cushman & Wakefield Copyright 2020. No warranty or representation, express or implied, is made to the accuracy or completeness of the information contained herein, and same is submitted subject to errors, omissions, change of price, rental or other conditions, withdrawal without notice, and to any special listing conditions imposed by the property owner(s). As applicable, we make no representation as to the condition of the property (or properties) in question.

## MANUFACTURING/WAREHOUSE SPACE FOR LEASE

# 1053 SINCLAIR FRONTAGE ROAD

Milpitas, CA

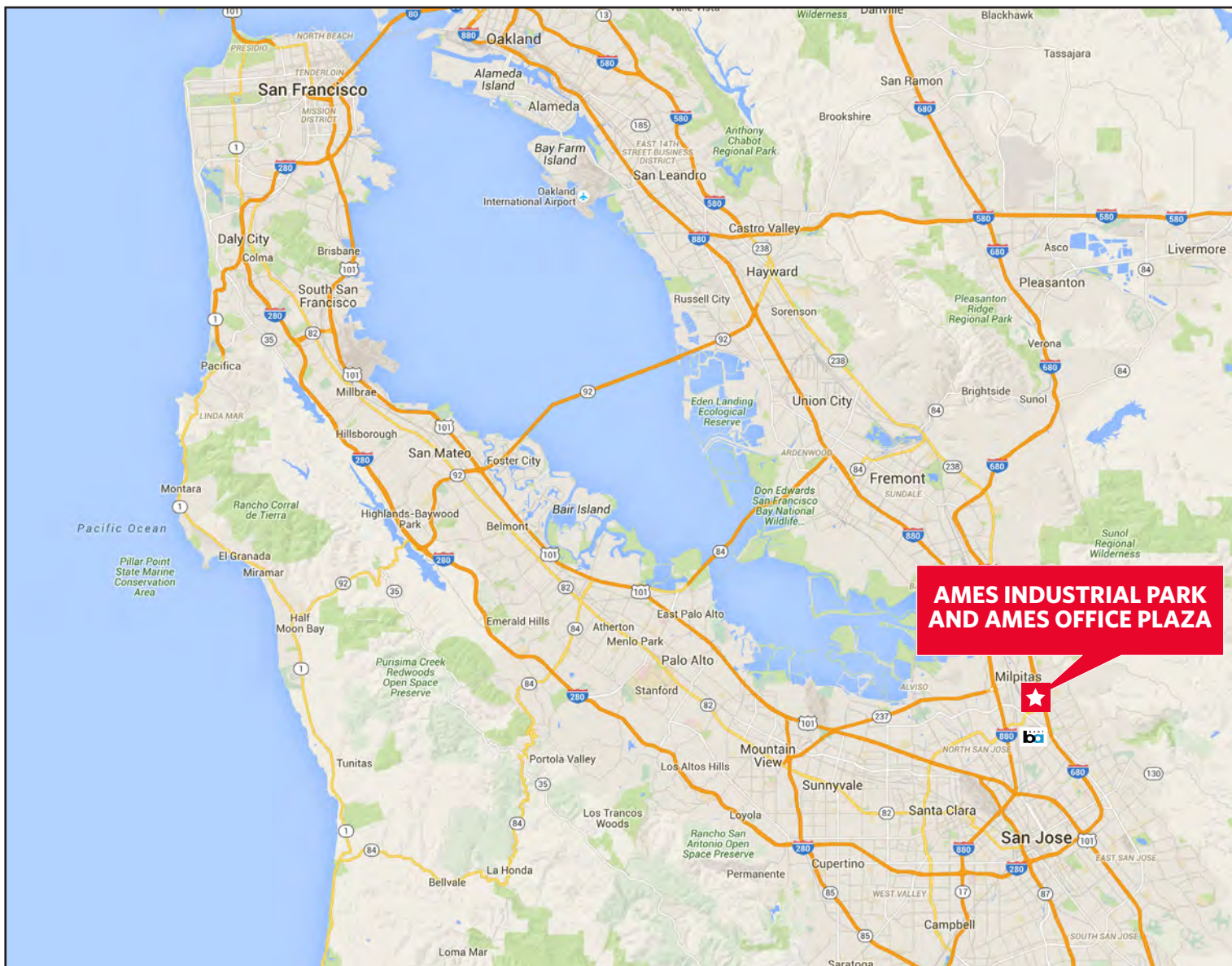



MANUFACTURING/WAREHOUSE SPACE FOR LEASE

# 1053 SINCLAIR FRONTAGE ROAD

Milpitas, CA

