

FOR LEASE | 2,400 SF

# SHOWROOM/OFFICE/RETAIL WAREHOUSE

4231

**S. NATCHES COURT, UNIT B**

OXFORD-SANTA FE BUSINESS PARK | ENGLEWOOD, CO 80110



## PROPERTY FEATURES

- + 3' x 8' backlit identification sign
- + Drive-in loading doors (10'x10')
- + On-site management
- + Close to Riverpoint Shopping Center, banks, restaurants, Target and Costco
- + Free tenant and customer parking
- + 200 yards to Oxford Light Rail Station
- + Individual meter in each unit for gas and electricity

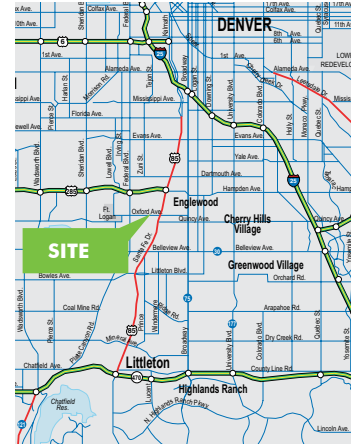

[www.cbre.us/colorado](http://www.cbre.us/colorado)

**CBRE**

# FOR LEASE UNIT B

4231  
S. NATCHES COURT  
OXFORD-SANTA FE BUSINESS PARK



## SITE PLAN

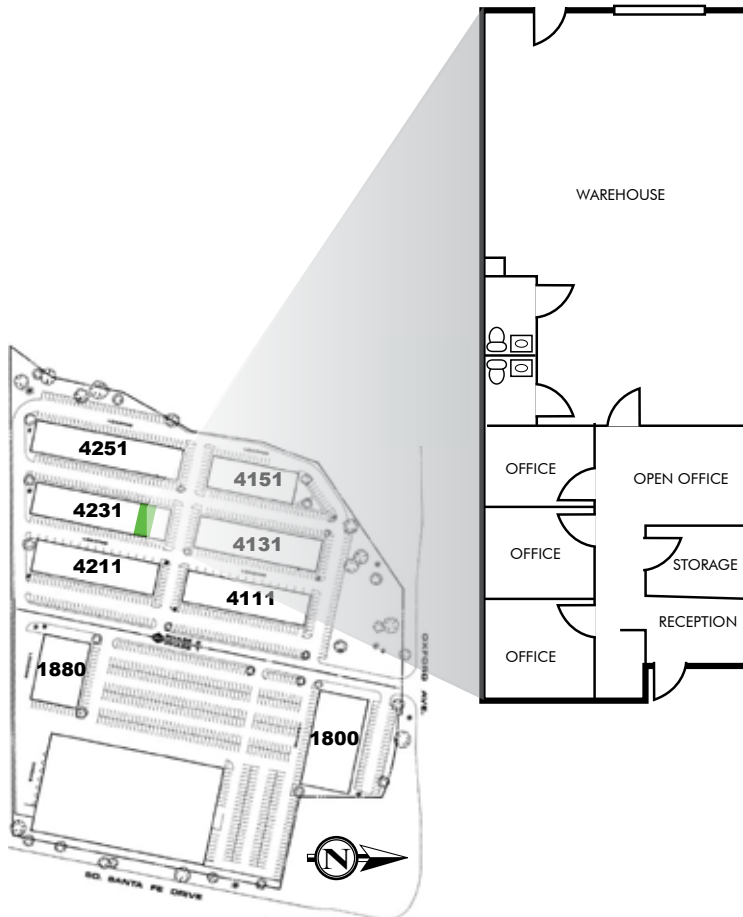

## BUILDING DETAILS

AVAILABLE:	2,400 SF
OFFICE AREA:	1,200 SF
LOADING:	1 drive-in door
ELECTRICAL:	100 amps, 3 phase
CLEARANCE:	12'
YEAR BUILT:	1983-1984
LEASE RATE:	\$8.50/SF NNN
NNN EXPENSES:	\$3.88/SF (2019)



## CONTACT US

### MURRAY PLATT, SIOR

First Vice President  
+1 720 528 6413  
murray.platt@cbre.com

### PAUL KLUCK, SIOR

First Vice President  
+1 720 528 6405  
paul.kluck@cbre.com

© 2019 CBRE, Inc. All rights reserved. This information has been obtained from sources believed reliable, but has not been verified for accuracy or completeness. You should conduct a careful, independent investigation of the property and verify all information. Any reliance on this information is solely at your own risk. CBRE and the CBRE logo are service marks of CBRE, Inc. All other marks displayed on this document are the property of their respective owners. Photos herein are the property of their respective owners. Use of these images without the express written consent of the owner is prohibited.