

1008
FOWLER WAY
PLACERVILLE

Medical/Professional Office Building for SALE

- ±5,000 SF Stand-Alone Professional Medical/Office Building
- New Offering Price: **\$629,000 (\$125.80 PSF)**
- Suite C is occupied and can remain or vacate after the close of escrow
- Concrete tile roof
- All suites are separately metered (PG&E)
- Great for owner-user or investor
- Walking distance to Marshall Medical Center
- APN# 004-051-41 - Zoned BP (Business Professional)
- Built ±1983



TOM CONWELL 916.569.2380 tconwell@ngkf.com CA RE License #01394155

980 Ninth Street, Suite 2500, Sacramento, Ca. 95814

The distributor of this communication is performing acts for which a real estate license is required. The information contained herein has been obtained from sources deemed reliable but has not been verified and no guarantee, warranty or representation, either express or implied, is made with respect to such information. Terms of sale or lease and availability are subject to change or withdrawal without notice. 18-0723-1/20

1008
FOWLER WAY
PLACERVILLE

FLOORPLAN

Suite A ±2,000 SF
Available for Lease

Suite B ±1,500 SF
Available for Lease

Suite c ±1,500 SF
Occupied and tenant can
remain or vacate after close of
escrow

±5,000 SF Stand-Alone
Building on ±0.49 acres

5/1,000 parking (26 stalls)

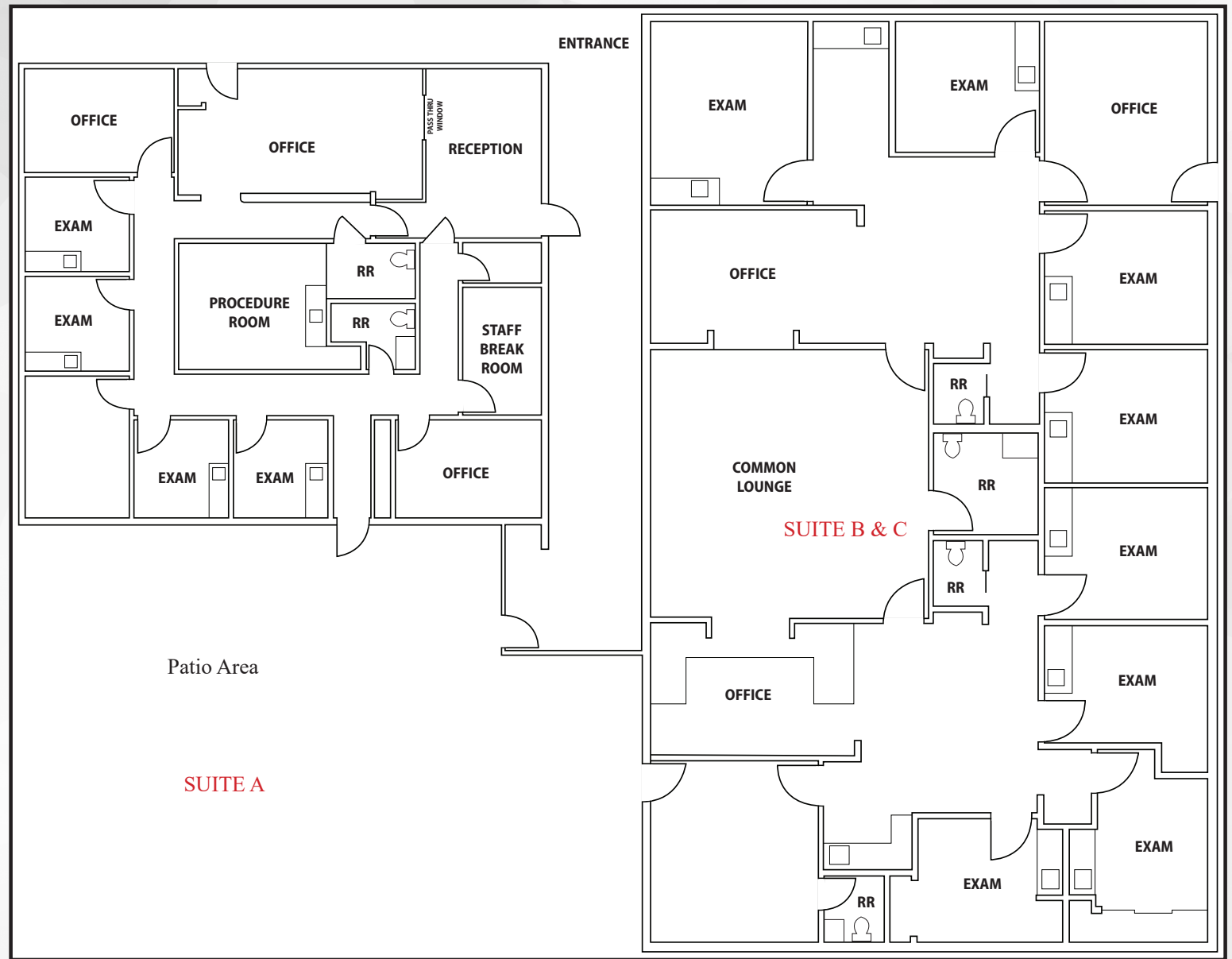

1008
FOWLER WAY
PLACERVILLE

LOCATION/AMENITIES MAP



1008 FOWLER WAY PLACERVILLE

LOCATION/AMENITIES MAP



1008
FOWLER WAY
PLACERVILLE

GALLERY

