

THE CORNERS

WALNUT CREEK

SHOPPING AS IT SHOULD BE

Downtown Walnut Creek is
among the most important urban
retail markets in Northern California

Located at Main Street and Mt. Diablo Blvd., The Corners
is positioned of the front door of Broadway Plaza. Surrounded
by the highly successful retailers including Neiman Marcus,
Tiffany, Nordstrom, Apple, Anthropologie, Sephora, Crate &
Barrel, and Restoration Hardware. Downtown Walnut Creek
is one of the most distinguished retail destinations
in California.

THE CORNERS







town center
CORTE MADERA
THE VILLAGE
at Corte Madera

THE
CORNERS

CORTE MADERA

BAY STREET
EMERYVILLE

WALNUT
CREEK

Westfield
SAN FRANCISCO CENTRE

OAKLAND

SAN
FRANCISCO

STONERIDGE
SHOPPING CENTER

SAN
FRANCISCO
BAY

STANFORD
SHOPPING CENTER

FREMONT

PALO ALTO

Westfield
VALLEY FAIR
SANTANA ROW

SAN JOSE

PACIFIC
OCEAN



2015 REPORT

10 - MILE RADIUS

	WALNUT CREEK	EMERYVILLE	CORTE MADERA	SAN JOSE	PALO ALTO
Average Household Income	\$128,035	\$102,628	\$127,173	\$125,803	\$143,570
Total Daytime Population	515,274	1,681,955	319,075	1,678,227	843,616
Total Population	496,968	1,360,672	294,273	1,602,502	725,241
Total Household Expenditure	\$34,462	\$31,066	\$33,763	\$33,871	\$35,015
Total 2015 Households	178,173	554,129	108,779	509,860	257,395



THE CORNERS



THE CORNERS IS A +/- 31,000 SF PREMIER SHOPPING CENTER ANCHORED BY TIFFANY & CO. AND APPLE LOCATED AT THE CORNER OF MAIN STREET AND MT. DIABLO BOULEVARD.

The project is directly across the street from the 1.1 Million square foot Broadway Plaza, one of the highest sales per square foot malls in California. The mall is currently undergoing a multi-million dollar renovation that will add 300,000 square feet of premium retail space.

SITE PLAN

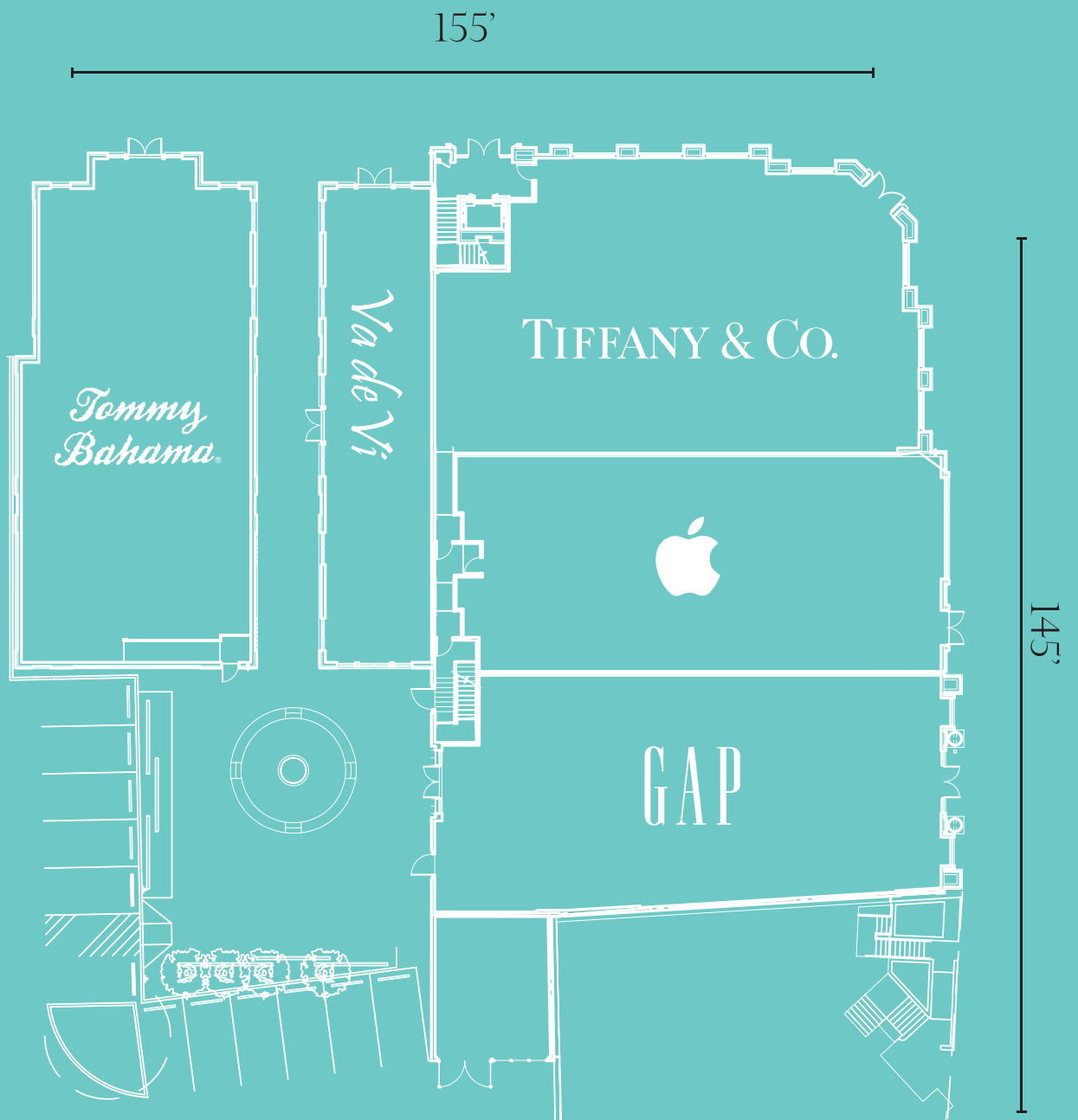



1521 MT. DIABLO
Currently occupied by Tommy Bahamas

Available August, 2016

+/-4,275 SF



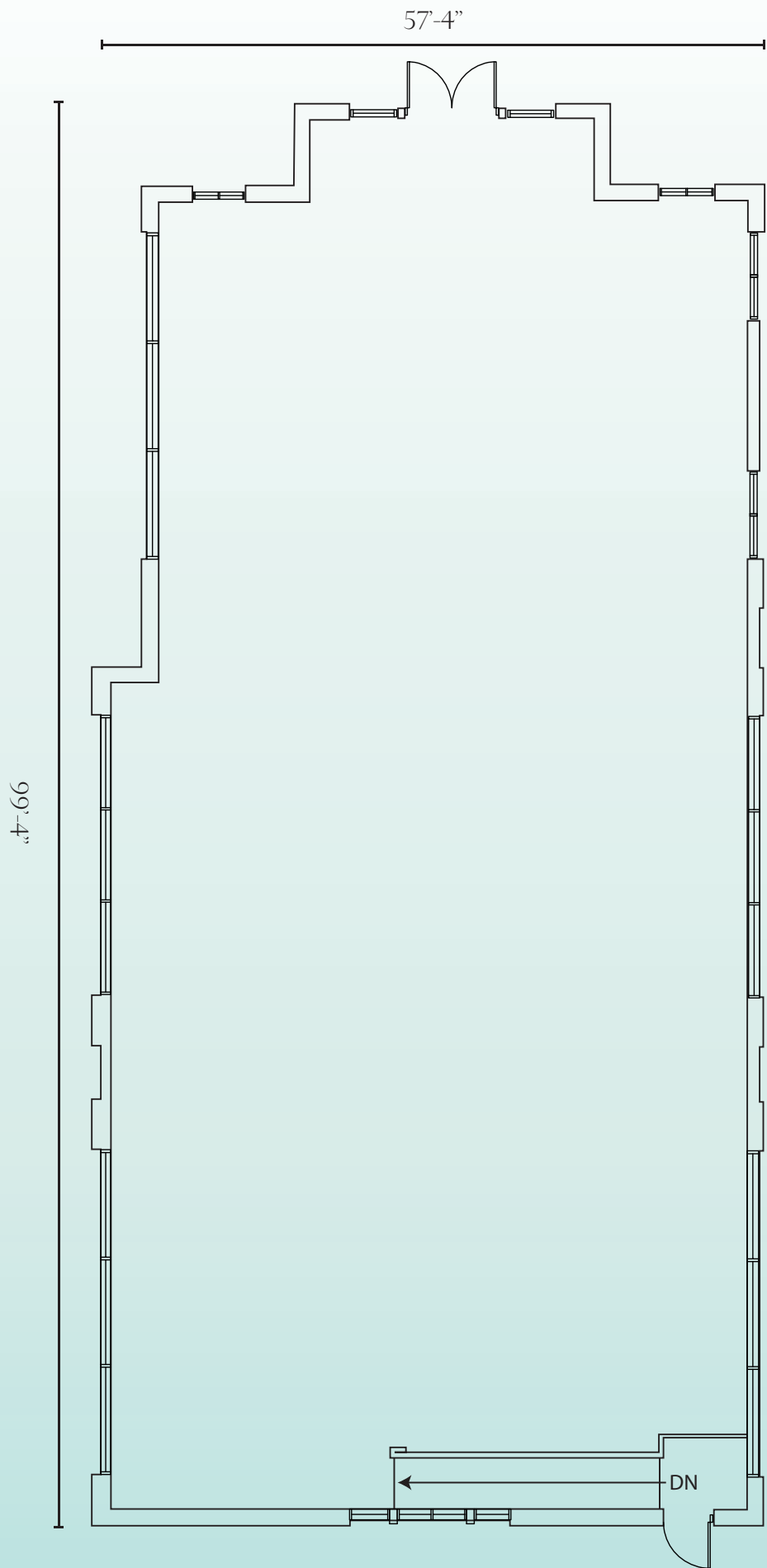



POTTERY
BARN

THE
CORNERS
WALNUT CREEK



Brandy  Melville

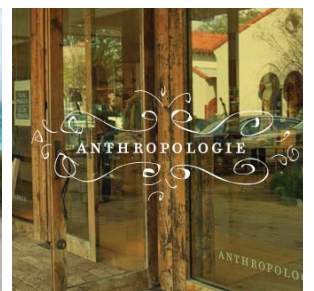

THE CORNERS

WALNUT CREEK

THE CORNERS

WALNUT CREEK

For leasing information, contact:

Julie Taylor
1 415 293 6293
Lic #00998395

Stephen Rusher
1 415 293 6297
Lic #01439740

Colliers
INTERNATIONAL