

FOR SUBLEASE > INDUSTRIAL SPACE

3351 Southwest Blvd.

GROVE CITY, OHIO 43123

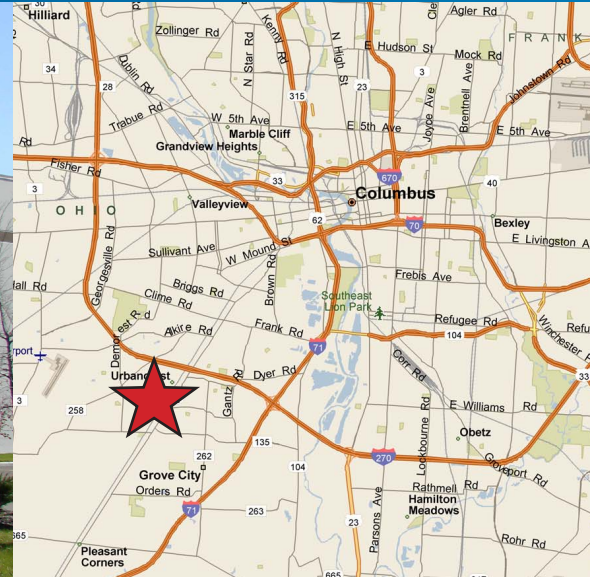

3351 Southwest Blvd. > Industrial Space

This 212,400 SF warehouse building is located in Grove City, just off of I-71. The available space consists of 4 docks and a clear height of 29'-32'. Ideal for dead storage with 48'x48' column spacing.

Building Type:	212,400 SF Warehouse Building
Available Space:	28,320 SF
Lease Rate:	\$3.00 SF/Full Service Gross
Sublease expires 11/30/2015	

Contact Us

SHANE E. WOLOSHAN, SIOR
614.410.5624
shane.woloshan@colliers.com

MICHAEL R. LINDER, SIOR
614.410.5628
michael.linder@colliers.com

JOEL R. YAKOVAC, SIOR
614.410.5654
joel.yakovac@colliers.com

The information contained herein was obtained from sources believed reliable; however, Colliers International makes no guarantees, warranties, or representations as to the completeness or accuracy thereof. The presentation of this property is submitted subject to errors, omissions, change of price or conditions prior to sale or lease, or withdrawal without notice.

COLLIERS INTERNATIONAL
GREATER COLUMBUS REGION
Two Miranova Place, Suite 900
Columbus, OH 43215
www.colliers.com

Building Amenities

- › Dead warehouse space
- › 29'-32' clear
- › 48' x 48' column spacing
- › 4 docks:
 - › 3 with levelers and locks
 - › All 4 have lights and seals
- › High efficiency fluorescent lighting

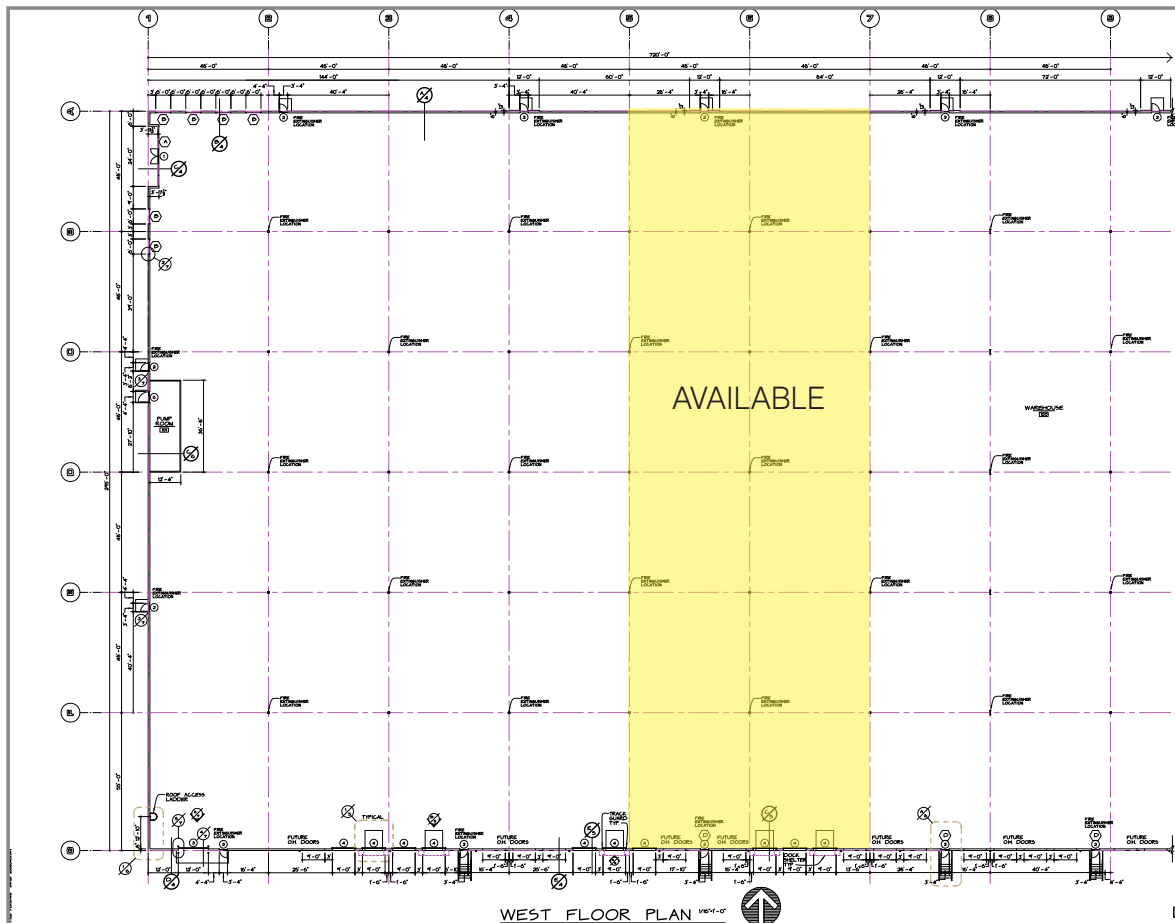

SHANE E. WOLOSHAN, SIOR
614.410.5624
COLUMBUS, OH
shane.woloshan@colliers.com

MICHAEL R. LINDER, SIOR
614.410.5628
COLUMBUS, OH
michael.linder@colliers.com

JOEL R. YAKOVAC, SIOR
614.410.5654
COLUMBUS, OH
joel.yakovac@colliers.com

