

FOR LEASE FLEX / R & D SUITES

2795 2nd Street & 607 Peña Drive
Davis, CA 95618



2795 2nd Street, Suite 200 and 607 Pena, Suites 300 and 450 in the Mace Ranch neighborhood in East Davis provide a great opportunity to lease various size suites of flex/tech/office/lab space in Davis. Suites ranging in size from $\pm 8,625$, $\pm 10,800$ and $\pm 21,600$ SF. These buildings are very flexible and allow for various configurations and uses, including office, lab, light manufacturing/assembly, R&D, logistics, athletic etc.

The properties are on the well-traveled thoroughfare of 2nd Street and Pena Drive with visibility to Interstate-80, they are less than five minutes from the Mace Boulevard Exit on I-80, in close proximity to UC Davis and the Davis central core area, and a short 15 minute drive to Downtown Sacramento. Lease duration and tenant improvements negotiable.

Other tenants in the buildings include R&D/lab/scientific UC Davis and athletic users.

PROPERTY HIGHLIGHTS

- Suites ranging in size from $\pm 8,625$, $\pm 10,800$, and $\pm 21,600$ SF of flex/tech/office/lab/athletic space – see site plan
- Ready for your business. We have a team in place to help with custom improvements, planning and budgeting.
- Zoned Light Industrial / Business Park
- Close proximity to Downtown Davis, UC Davis, numerous commercial & retail facilities and Interstate 80

FOR LEASE

\$0.75-1.25 /SF, Triple Net. Current NNN charges \$0.21, depending on tenant improvements, credit quality and lease duration.

*** Tenant to pay separately metered utilities (gas & electric), & internal janitorial service to the suite**

Jim Gray, CCIM
Senior Director, LEED AP
+1 916 617 4255
jim.gray@cushwake.com
Lic.#00775072

Nahz Anvary, CCIM
Senior Director
+1 916 617 4257
nahz.anvary@cushwake.com
Lic.#01468557

David Nicholson
Director
+1 916 288 4422
david.nicholson@cushwake.com
Lic.#01845338



400 Capitol Mall Suite 1800
Sacramento, CA 95814
cushmanwakefield.com

The depiction in the included photograph of any person, entity, sign, logo or property, other than Cushman & Wakefield's (C&W) client and the property offered by C&W, is incidental only, and is not intended to connote any affiliation, connection, association, sponsorship or approval by or between that which is incidentally depicted and C&W or its client. This listing shall not be deemed an offer to lease, sublease or sell such property; and, in the event of any transaction for such property, no commission shall be earned by or payable to any cooperating broker except if otherwise provided pursuant to the express terms, rates and conditions of C&W's agreement with its principal, if, as and when such commission (if any) is actually received from such principal. (A copy of the rates and conditions referred to above with respect to this property is available upon request.)

FOR LEASE FLEX / R & D SUITES

2795 2nd Street & 607 Peña Drive
Davis, CA 95618



PROPERTY PHOTOS - 2795 2nd Street



Front entry of suite full of glass



View from the back of the suite including large bathroom core



View from the front of the suite

Jim Gray, CCIM
Senior Director, LEED AP
+1 916 617 4255
jim.gray@cushwake.com
Lic.#00775072

Nahz Anvary, CCIM
Senior Director
+1 916 617 4257
nahz.anvary@cushwake.com
Lic.#01468557

David Nicholson
Director
+1 916 288 4422
david.nicholson@cushwake.com
Lic.#01845338



400 Capitol Mall Suite 1800
Sacramento, CA 95814
cushmanwakefield.com

The depiction in the included photograph of any person, entity, sign, logo or property, other than Cushman & Wakefield's (C&W) client and the property offered by C&W, is incidental only, and is not intended to connote any affiliation, connection, association, sponsorship or approval by or between that which is incidentally depicted and C&W or its client. This listing shall not be deemed an offer to lease, sublease or sell such property; and, in the event of any transaction for such property, no commission shall be earned by or payable to any cooperating broker except if otherwise provided pursuant to the express terms, rates and conditions of C&W's agreement with its principal, if, as and when such commission (if any) is actually received from such principal. (A copy of the rates and conditions referred to above with respect to this property is available upon request.)

FOR LEASE FLEX / R & D SUITES

2795 2nd Street & 607 Peña Drive

Davis, CA 95618



PROPERTY PHOTOS - 607 Pena Drive



Suite 300 - Kitchenette & bathroom core



Suite 300 - View to the North



Suite 300 - View to the South

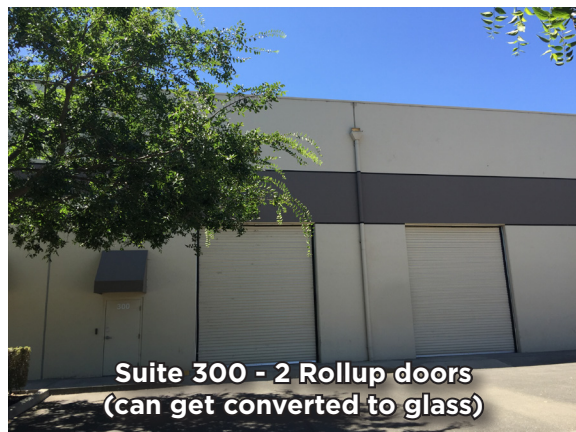

**Suite 300 - 2 Rollup doors
(can get converted to glass)**



**Suite 450 - View from the
front of the suite**



**Suite 450 - View from the
back of the suite**

Jim Gray, CCIM
Senior Director, LEED AP
+1 916 617 4255
jim.gray@cushwake.com
Lic.#00775072

Nahz Anvary, CCIM
Senior Director
+1 916 617 4257
nahz.anvary@cushwake.com
Lic.#01468557

David Nicholson
Director
+1 916 288 4422
david.nicholson@cushwake.com
Lic.#01845338



400 Capitol Mall Suite 1800
Sacramento, CA 95814
cushmanwakefield.com

The depiction in the included photograph of any person, entity, sign, logo or property, other than Cushman & Wakefield's (C&W) client and the property offered by C&W, is incidental only, and is not intended to connote any affiliation, connection, association, sponsorship or approval by or between that which is incidentally depicted and C&W or its client. This listing shall not be deemed an offer to lease, sublease or sell such property; and, in the event of any transaction for such property, no commission shall be earned by or payable to any cooperating broker except if otherwise provided pursuant to the express terms, rates and conditions of C&W's agreement with its principal, if, as and when such commission (if any) is actually received from such principal. (A copy of the rates and conditions referred to above with respect to this property is available upon request.)

Site Plan & Floor Plans

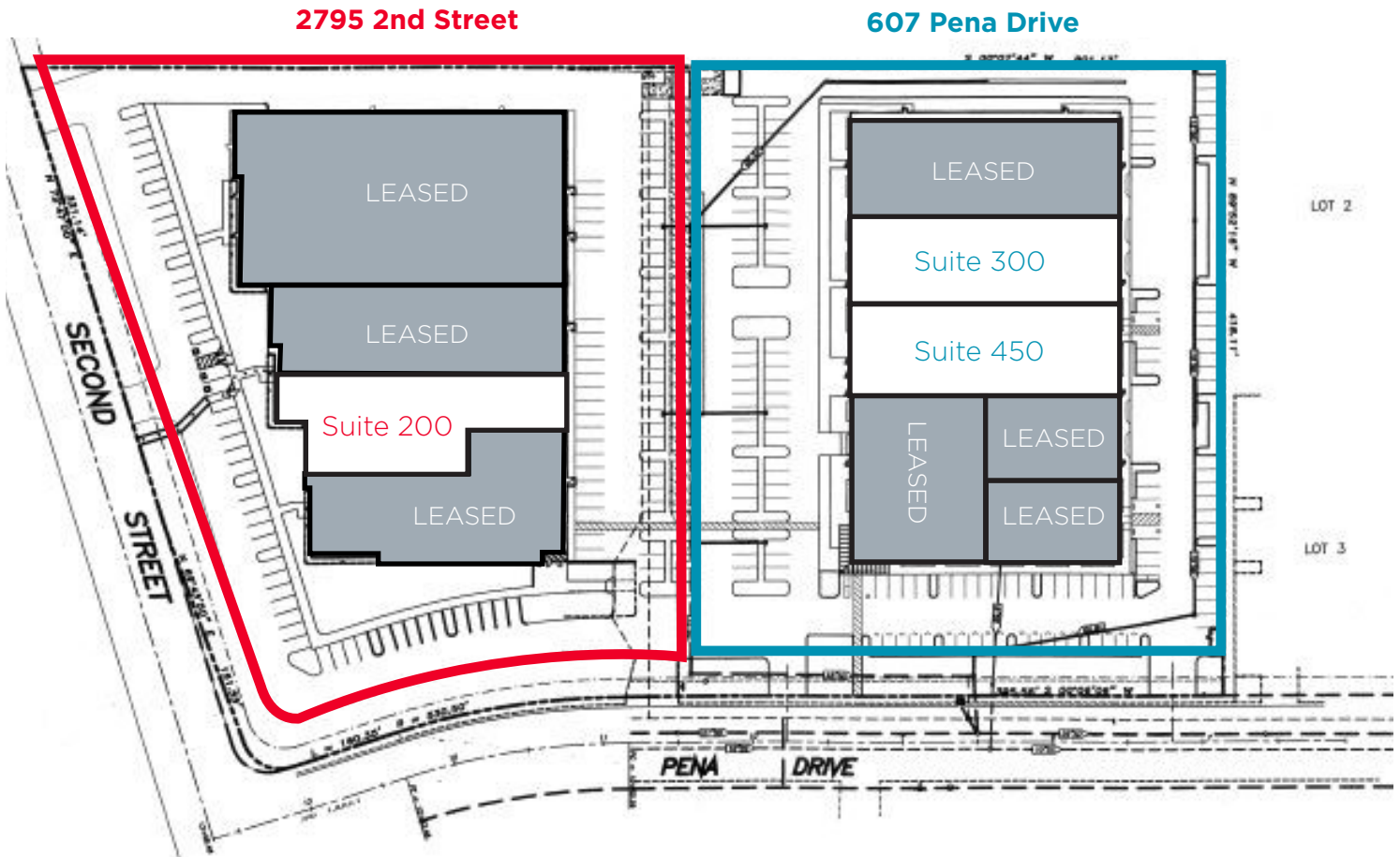

2795 2nd Street

SUITE 200	±8,625 SF
-----------	-----------

607 Peña Drive

SUITE 300	±10,800 SF
SUITE 450	±10,800 SF
Combined	±21,600 SF

Jim Gray, CCIM
 Senior Director, LEED AP
 +1 916 617 4255
 jim.gray@cushwake.com
 Lic.#00775072

Nahz Anvary, CCIM
 Senior Director
 +1 916 617 4257
 nahz.anvary@cushwake.com
 Lic.#01468557

David Nicholson
 Director
 +1 916 288 4422
 david.nicholson@cushwake.com
 Lic.#01845338



**CUSHMAN &
 WAKEFIELD**
 400 Capitol Mall Suite 1800
 Sacramento, CA 95814
 cushmanwakefield.com

The depiction in the included photograph of any person, entity, sign, logo or property, other than Cushman & Wakefield's (C&W) client and the property offered by C&W, is incidental only, and is not intended to connote any affiliation, connection, association, sponsorship or approval by or between that which is incidentally depicted and C&W or its client. This listing shall not be deemed an offer to lease, sublease or sell such property; and, in the event of any transaction for such property, no commission shall be earned by or payable to any cooperating broker except if otherwise provided pursuant to the express terms, rates and conditions of C&W's agreement with its principal, if, as and when such commission (if any) is actually received from such principal. (A copy of the rates and conditions referred to above with respect to this property is available upon request.)

2795 2nd Street & 607 Peña Drive
Davis, CA 95618



AREA AERIAL



Jim Gray, CCIM
Senior Director, LEED AP
+1 916 617 4255
jim.gray@cushwake.com
Lic.#00775072

Nahz Anvary, CCIM
Senior Director
+1 916 617 4257
nahz.anvary@cushwake.com
Lic.#01468557

David Nicholson
Director
+1 916 288 4422
david.nicholson@cushwake.com
Lic.#01845338



400 Capitol Mall Suite 1800
Sacramento, CA 95814
cushmanwakefield.com

The depiction in the included photograph of any person, entity, sign, logo or property, other than Cushman & Wakefield's (C&W) client and the property offered by C&W, is incidental only, and is not intended to connote any affiliation, connection, association, sponsorship or approval by or between that which is incidentally depicted and C&W or its client. This listing shall not be deemed an offer to lease, sublease or sell such property; and, in the event of any transaction for such property, no commission shall be earned by or payable to any cooperating broker except if otherwise provided pursuant to the express terms, rates and conditions of C&W's agreement with its principal, if, as and when such commission (if any) is actually received from such principal. (A copy of the rates and conditions referred to above with respect to this property is available upon request.)