

11972 N. SAGINAW STREET  
MT. MORRIS, MICHIGAN

RETAIL FOR SALE  
24,050 Square Feet Available



**SIGNATURE  
ASSOCIATES**  
KNOW SIGNATURE | KNOW RESULTS

**RETAIL STRIP**



## PROPERTY FEATURES

- 24,050 available square feet
- Save A Lot – 18,050 square feet
- Pet Supplies Plus – 6,000 square feet
- Zoned Commercial
- 224 parking spaces
- Sale Price: \$1,202,500 (\$50.00/sq.ft.)

**Comments:** Excellent 24,050 sq. ft. retail real estate opportunity for sale. 2.27 acres on N. Saginaw St. Great visibility and ample parking.

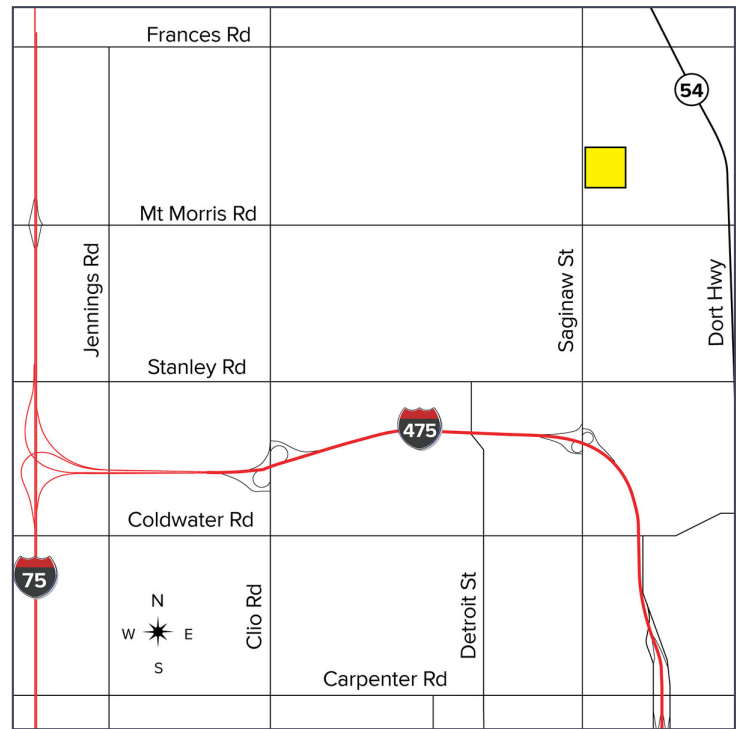

For more information, please contact:

**MARVIN PETROUS**

(248) 359 0647

mpetrous@signatureassociates.com

**GARY STEPHENS**

(248) 948 0104

gstephens@signatureassociates.com

**SIGNATURE ASSOCIATES**

One Towne Square, Suite 1200

Southfield, MI 48076

www.signatureassociates.com

# 11972 N. Saginaw Street – Mt. Morris, Michigan

## Retail For Sale

24,050  
Square Feet  
AVAILABLE



### DEMOGRAPHICS

	POPULATION	MED. HH INCOME
1 MILE	5,523	\$33,447
3 MILE	21,216	\$33,510
5 MILE	63,874	\$37,476

### TRAFFIC COUNTS (TWO-WAY)

19,653	N. Saginaw Rd. N. of Mt. Morris St.
18,423	N. Saginaw Rd. S. of Mt. Morris St.
8,216	Mt. Morris St. W. of N. Saginaw Rd.
13,860	Mt. Morris St. E. of N. Saginaw Rd.



For more information, please contact:

**MARVIN PETROUS**

(248) 359 0647

mpetrous@signatureassociates.com

**GARY STEPHENS**

(248) 948 0104

gstephens@signatureassociates.com

**SIGNATURE ASSOCIATES**

One Towne Square, Suite 1200

Southfield, MI 48076

www.signatureassociates.com