

Property Line

Fire Separation Distance Setback

Fire Separation Distance Setback

Property Line

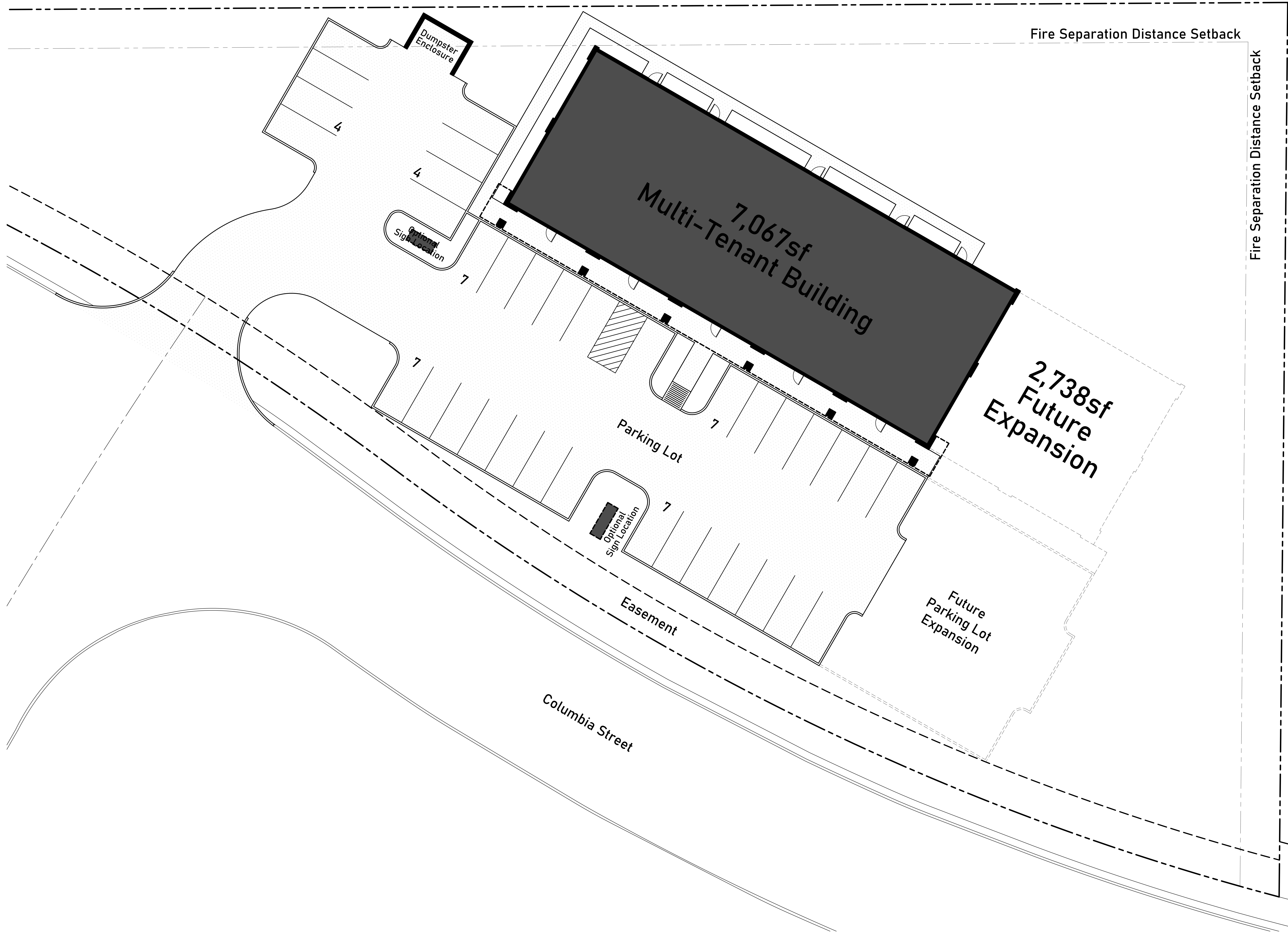

Proposed Site Plan

Scale: 1" = 10.0'

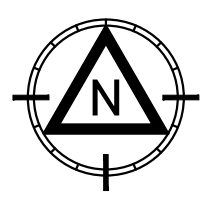

Project Information

HEM Properties

Columbia Plaza Prospective Multi-Tenant Building

7300 Columbia Street
Evansville, Indiana 47715

Client

HEM Properties
Newburgh, Indiana 47630

Architect



4325 Lankford Drive Evansville, IN 47712 (812) 479-7000
3201 Interstate Drive Evansville, IN 47713 (812) 479-7000
103 East 2nd Street Owensboro, KY 40301 (502) 491-1050

Associated Engineers

Civil Engineer

Structural Engineer

HVAC & Plumbing Engineer

Professional Certification Design Ownership Statement

All design work remains the property of the architect and may not be utilized or reproduced without prior written authorization after remittance of compensation.

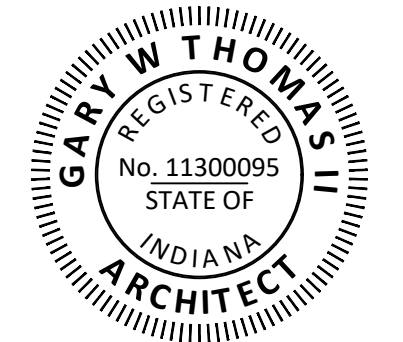

Copyright Protection

All drawings, specifications, and other documents ("documents" hereinafter) are protected under 17 U.S.C. § 102. The design professional responsible for the preparation of the documents retains all statutory rights, common law rights, and intellectual property rights. The documents shall not be released, duplicated, copied or used by any person or entity without the express written consent of the design professional. Authorized use of electronic documents does not guarantee the information contained in the electronic document is current, complete or accurate. It is the responsibility of all document users to verify with the design professional the documents (print or electronic) in question are the most current, complete and accurate documents available. All documents are for exclusive use on the referenced project only.

Applicability Disclaimer

This is a comprehensive set of working drawings and specifications. Some drawings and/or specifications may not be applicable to the specific project. It is the responsibility of every Contractor, Sub-Contractor, Vendor, and Supplier to review all drawings and/or specifications to determine their applicability to the specific project. Present the Architect with all applicability questions prior to bidding. Failure to comply with this requirement will be the basis for rejecting associated change order requests. If a specified product is no longer available it shall be the Contractor's, Sub-Contractor, Vendor or Supplier's responsibility to provide an equal substitution. The Architect reserves the sole right to determine the suitability of proposed substitutions.

Sheet Content

Civil
Site Plan

Sheet Revisions

No.	Brief Description Of Revision	Date

Drawing Information

Architect's Project No.	Drawing Sheet No.
ARCH2117	C1.1
Original Print Date	
2022 1-17	
Date of This Print	

Construction Documents