

## ±24,900 SF Industrial Shell Space

18430 Sutter Boulevard  
Morgan Hill, CA

Short Walk to Restaurants  
and Retail

Easy Access to Highway 101 &  
Monterey Highway

Ideal for Manufacturing

19' Clear Height

(1) 10'x10' Dock High Door

1000 Amps 277/480 Volts  
(To Be Confirmed)

Call to Tour

Tenant Improvement Allowance  
(To Be Determined)

**\$1.25 PSF, NNN**



### Great Morgan Hill Location



### Contact

**Rodney Moreschini**  
Kidder Mathews  
408.970.9400  
rodneym@kiddermathews.com  
LIC #01257858

**Tom Sweeney**  
Newmark Cornish & Carey  
408.982.8493  
tsweeney@newmarkccarey.com  
LIC #00989779

CO-BROKERED BY

**Newmark  
Cornish & Carey**

## ±24,900 SF Industrial Shell Space

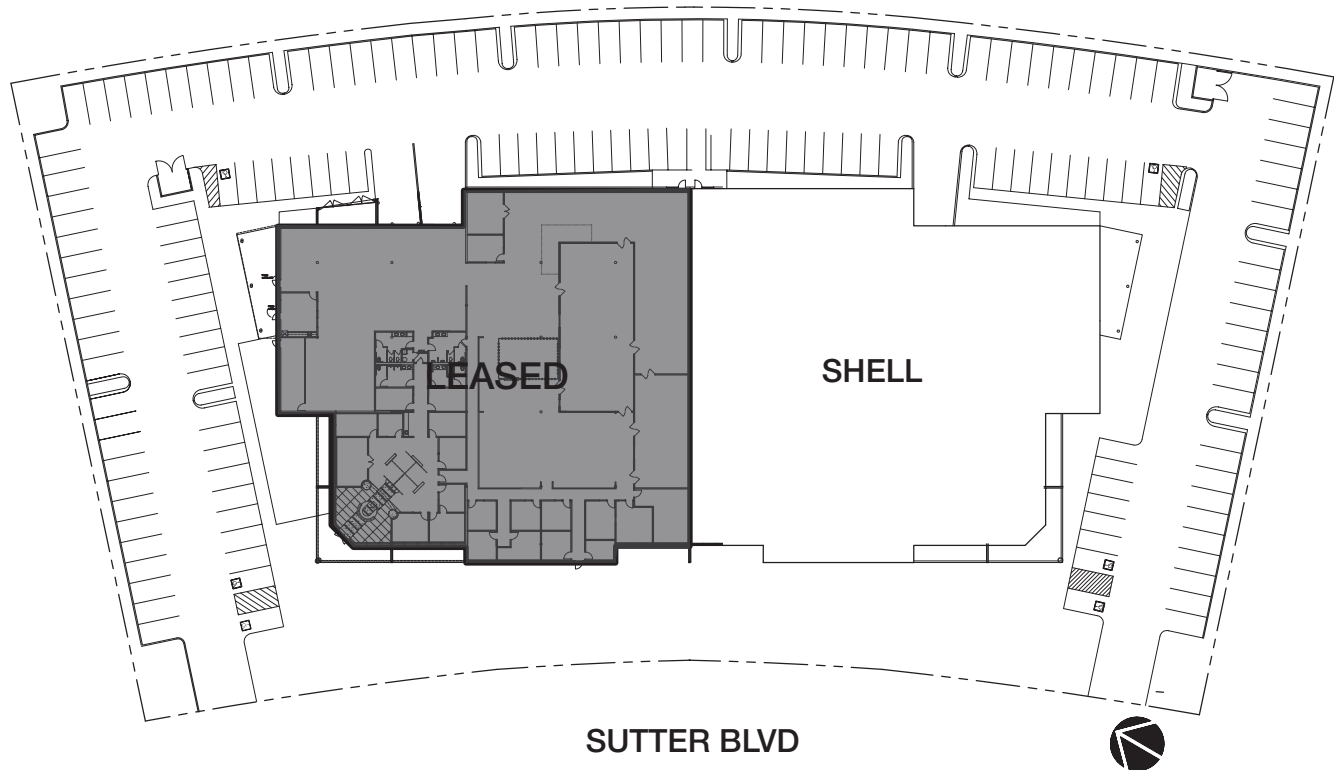

### Contact

**Rodney Moreschini**  
Kidder Mathews  
408.970.9400  
rodneym@kiddermathews.com  
LIC #01257858

**Tom Sweeney**  
Newmark Cornish & Carey  
408.982.8493  
tsweeney@newmarkccarey.com  
LIC #009897

CO-BROKERED BY  
**Newmark  
Cornish & Carey**



## ±24,900 SF Industrial Shell Space



### Contact

**Rodney Moreschini**  
Kidder Mathews  
408.970.9400  
rodneym@kiddermathews.com  
LIC #01257858

**Tom Sweeney**  
Newmark Cornish & Carey  
408.982.8493  
tsweeney@newmarkccarey.com  
LIC #009897

CO-BROKERED BY  
**Newmark  
Cornish & Carey**