

CHOPHOUSE ROW



BUILDING HIGHLIGHTS



Chophouse Row was built in 2015, and has received multiple Design and Development awards including NAIOP's Best Mixed-Use Development Project of the Year for the Pacific Northwest in 2015, and finalist for the Urban Land Institute's Global Award for Excellence in 2016.

Food and beverage establishments in the project include Osteria La Spiga, Plum Bistro, Marmite, By Tae, Wide Eyed Wines, Good Weather and Sweet Alchemy.

Project offers operable windows, a direct fresh air system to every suite and radiant heat - no shared central HVAC.



BIKE STORAGE



SHOWER ROOMS

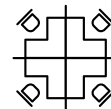

COWORKING FACILITY

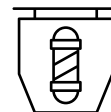

BARBERSHOP



SKINCARE SALON



DOGGIE DAYCARE

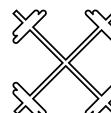

CROSSFIT GYM

AVAILABILITY

- Unique low-rise boutique building with operable windows and stairway to every floor
- Flexible, open floor plans completely built out for tech/creative users
- A choice of high-speed internet providers
- Exposed concrete floors and exposed steel structure
- Floor to ceiling high-performance glazing; operable windows, radiant heat, high efficiency ventilation
- Office floors and spaces individually secured via programmable fob system
- Office tenants receive discounted membership to The Cloud Room coworking facilities, which include meeting rooms, workstations, bar/lounge/event space, catering and podcast recording facilities

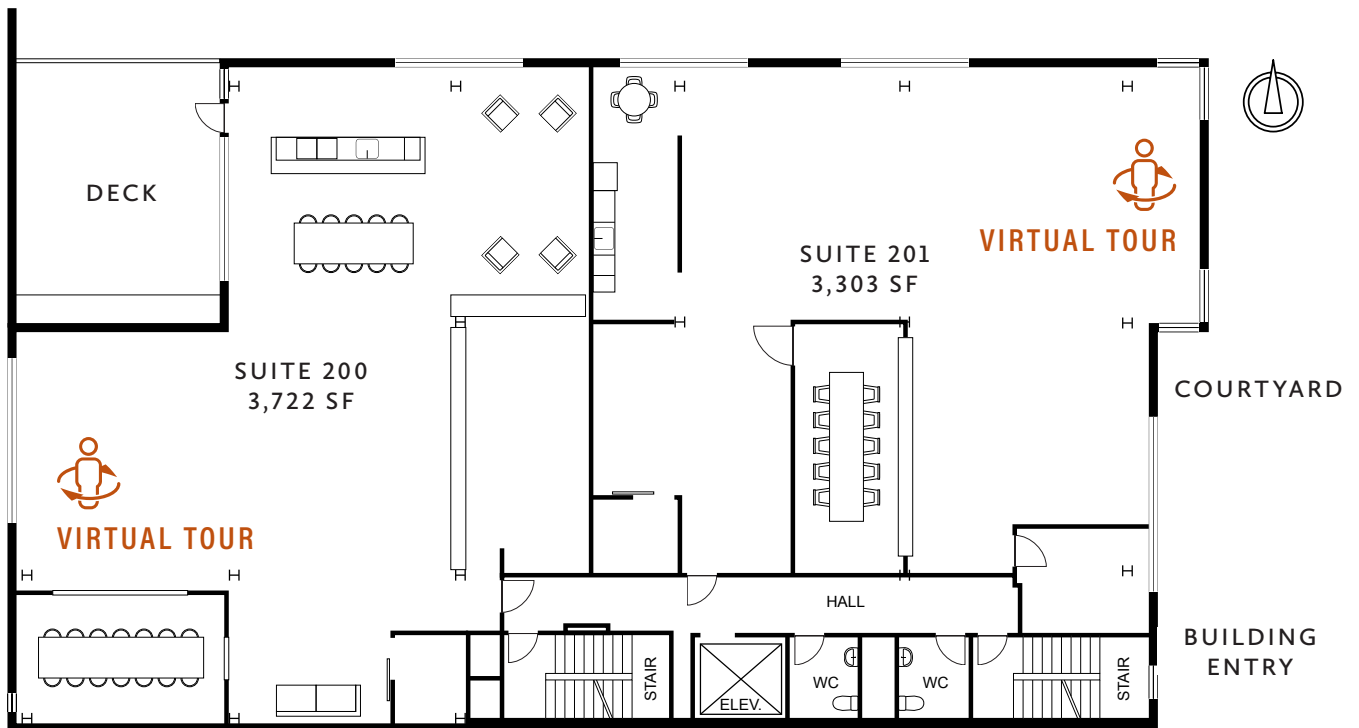

SUITE 200 | 3,722 RSF

Private west-facing deck with barbecue
Kitchenette/bar and conference rooms
Great natural light and operable windows
Furniture can be made available

SUITE 201 | 3,303 RSF

Kitchenette and conference rooms
Great natural light and operable windows
Furniture can be made available

The second floor suites could be combined to create 7,025 RSF



COWORKING SERVICES

The Cloud Room coworking space is located on the top floor of the project. This space inspires collaboration and creativity, and can be offered to office tenants as a meeting place or alternate workspace to their office suite.

Tenants may also negotiate a package of wraparound coworking services for their own suite in order to make their move-in and daily operations completely turnkey. These include high-speed internet, printers, janitorial, furnishings, plants, artwork, and coworking staff support.

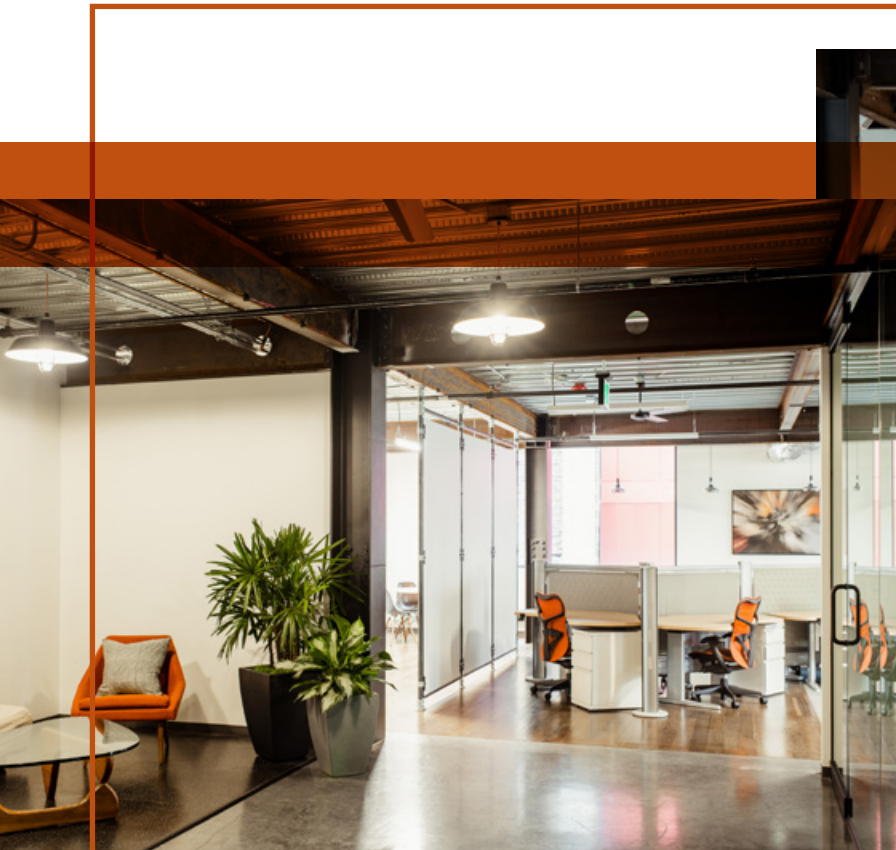





Chophouse Row is located in the heart of the Pike | Pine corridor in Seattle's Capitol Hill neighborhood surrounded by an abundance of walkable amenities & transportation options.

The Pike | Pine corridor is one of Seattle's designated "urban villages" and its most vibrant pedestrian neighborhood, with a combination of historic buildings and new developments full of local restaurants, retailers, galleries and cafes.

[HTTPS://WWW.CHOPUSEROW.COM](https://www.chopouserow.com)



LEAH MASSON
leah.masson@cbre.com
206-292-6080



© 2020 CBRE, Inc. All rights reserved. This information has been obtained from sources believed reliable, but has not been verified for accuracy or completeness. You should conduct a careful, independent investigation of the property and verify all information. Any reliance on this information is solely at your own risk. CBRE and the CBRE logo are service marks of CBRE, Inc. All other marks displayed on this document are the property of their respective owners, and the use of such logos does not imply any affiliation with or endorsement of CBRE. Photos herein are the property of their respective owners. Use of these images without the express written consent of the owner is prohibited. PMStudio_November2020