

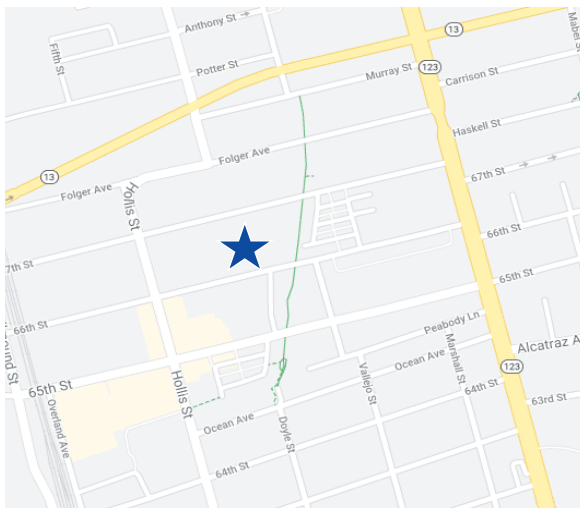

## For Lease: Rare “Brick and Timber”

**1266 66TH STREET  
EMERYVILLE, CA**



### Area

Suite 1: ±2,769 SF

Suite 2: ±2,932 SF

Suite 3: ±3,630 SF

Suite 4: ±3,824 SF

### Rental Rate

Call broker for Quote

### Property Highlights

- Fabulous Office Conversion with Glass Storefront and Modern Lighting
- Classic Brick and Timber Architecture
- Open Truss Ceiling
- Generous Free Surface Parking
- Individual Suite HVAC
- 16' High Vaulted Solid Redwood Ceiling
- Excellent Tenant Identity
- Walking Distance to Restaurants and Emery-Go Round Shuttle

*For information, please contact:*

**Jonathan Tomasco**

Managing Director

t 510-923-6262

jtomasco@ngkf.com

CA RE Lic# 01224562

[nmrk.com](http://nmrk.com)

**NEWMARK**

The distributor of this communication is performing acts for which a real estate license is required. The information contained herein has been obtained from sources deemed reliable but has not been verified and no guarantee, warranty or representation, either expressed or implied, is made with respect to such information. Terms of sale or lease and availability are subject to change or withdrawal without notice.

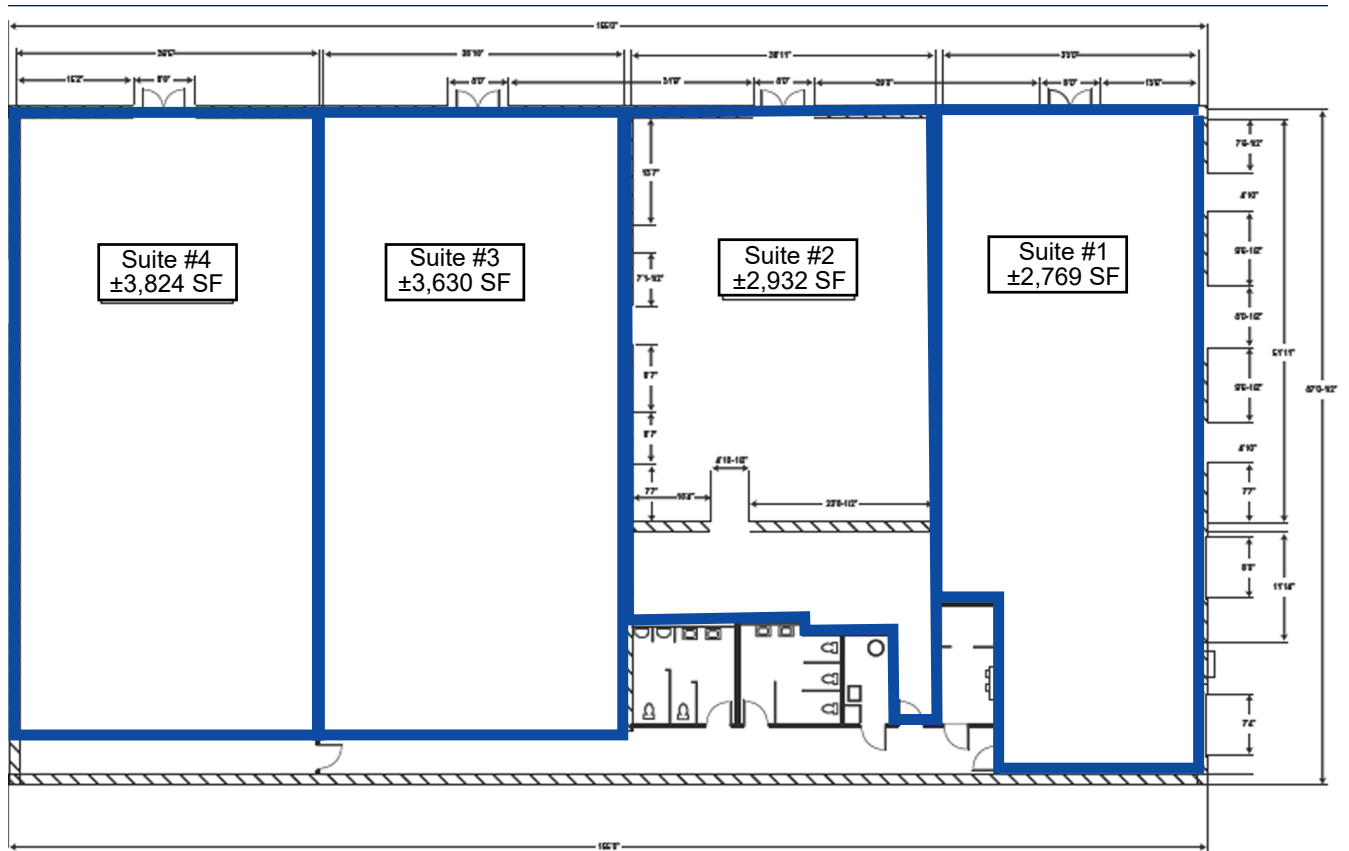

*For information, please contact:*

**Jonathan Tomasco**  
Managing Director  
t 510-923-6262  
jtomasco@ngkf.com  
CA RE Lic# 01224562

[nrmk.com](http://nrmk.com)

**NEWMARK**

The distributor of this communication is performing acts for which a real estate license is required. The information contained herein has been obtained from sources deemed reliable but has not been verified and no guarantee, warranty or representation, either expressed or implied, is made with respect to such information. Terms of sale or lease and availability are subject to change or withdrawal without notice.