

Office | For Lease

CBRE

295 Jimmy Doolittle Road

Salt Lake City, UT

www.cbre.us/slc



295 Jimmy Doolittle Road
Salt Lake City, UT

Property Information

- + Available: 1,000-3,240 RSF
- + Parking Ratio: 5/1000
- + Located within the Salt Lake International Center
- + Easy access to I-80 and Salt Lake International Airport
- + Great access to amenities
- + Recently upgraded with new paint and parking lot
- + Recently renovated interiors
- + Lease Rate: \$20.00/RSF, Full Service



Floor Plan

Available Space:
3,240 RSF

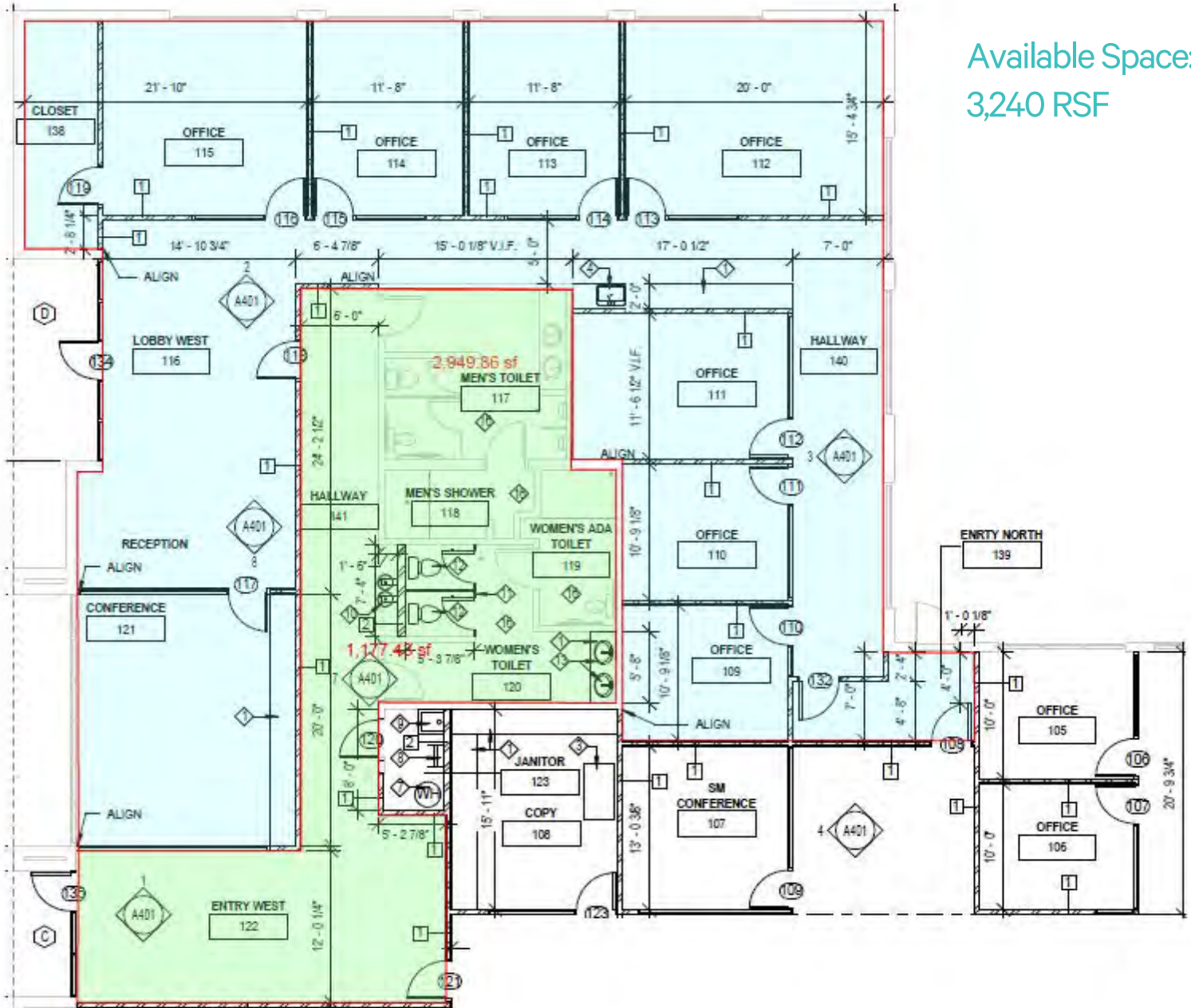

Common Space



Contact Us

James Mecham
First Vice President
+1 801 869 8028
james.mecham@cbre.com

© 2022 CBRE, Inc. All rights reserved. This information has been obtained from sources believed reliable, but has not been verified for accuracy or completeness. You should conduct a careful, independent investigation of the property and verify all information. Any reliance on this information is solely at your own risk. CBRE and the CBRE logo are service marks of CBRE, Inc. All other marks displayed on this document are the property of their respective owners, and the use of such logos does not imply any affiliation with or endorsement of CBRE. Photos herein are the property of their respective owners. Use of these images without the express written consent of the owner is prohibited.