



FOR LEASE

High Profile Retail Showroom Building

925 Ogden Ave. Downers Grove, IL
(NEAR OGDEN & MAIN)

PROPERTY SPECIFICATIONS

Building Size: 13,450 SF
Available Space: 12,000 SF
Lot Size: 1 Ac.
Zoning: B-3
Overhead Door: 1
Traffic Count: 39,000 VPD
Parking 48 Car



TRADE AREA DEMOGRAPHICS

Total Population:

1 Mile 13,600
3 Mile 84,000
5 Mile 265,000

Average Household Income:

1 Mile: \$116,000
3 Mile: \$92,000
5 Mile: \$93,000



PLEASE CONTACT:

Mark Butler
Butler Partners
Office: 630-789-5000
Cell: 630-707-3774
markbutler1@sbcglobal.net
www.butlerpartners.net



100 E. Ogden Avenue, #200
Westmont, IL 60559
Phone: 630-789-5000 Fax: 630-789-5001

Please note: Information is subject to change or withdrawal without further notice. Information is from a source we deem reliable, however no liability is assumed for its accuracy.

FOR LEASE

High Profile Retail Showroom Building

925 Ogden Ave. Downers Grove, IL
(NEAR OGDEN & MAIN)

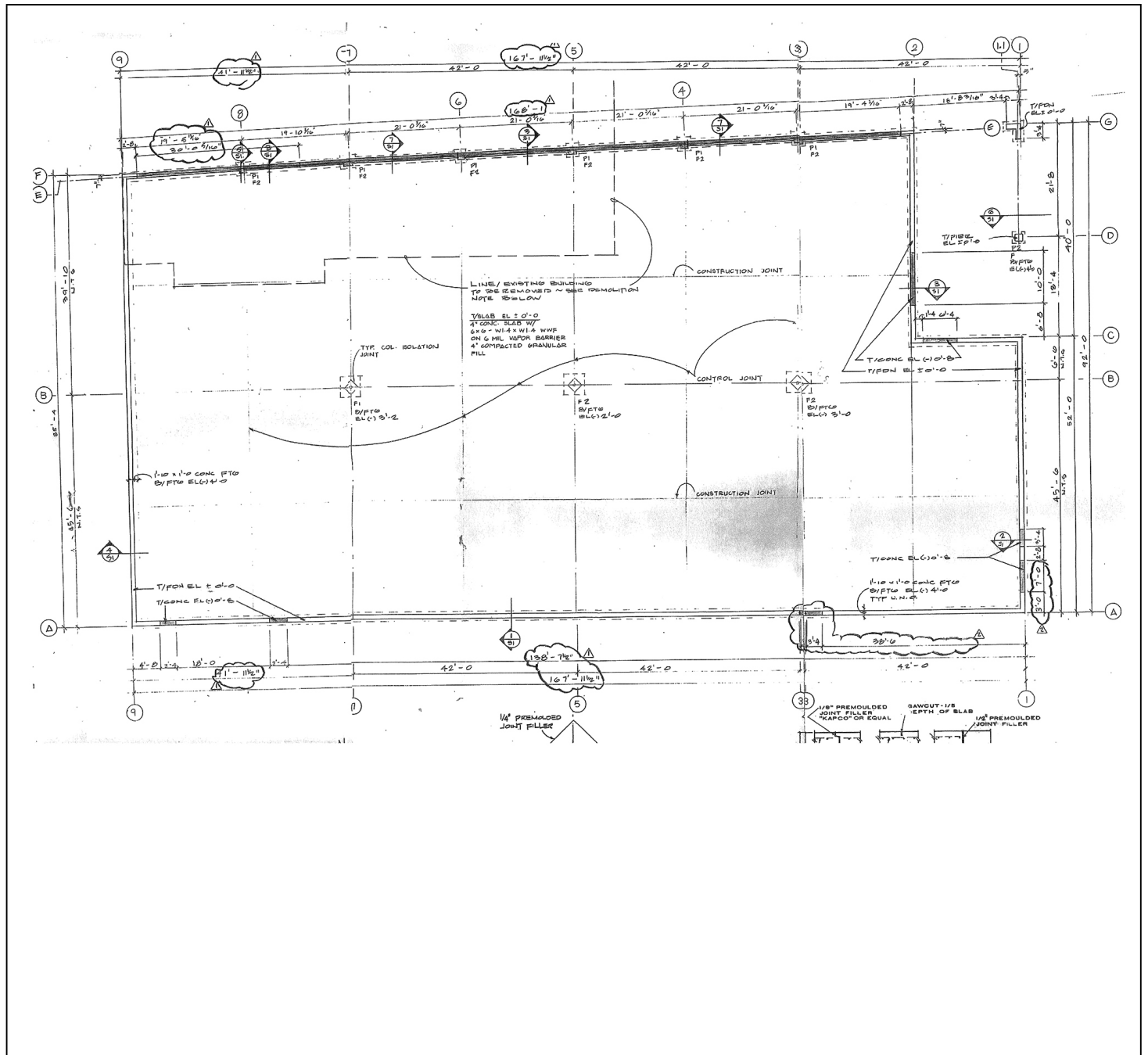

PLEASE CONTACT:

Mark Butler
Butler Partners
Office: 630-789-5000
Cell: 630-707-3774
markbutler1@sbcglobal.net
www.butlerpartners.net