

CLASS A LIFE SCIENCE FACILITY

Designed for Premier Life Science Research

FLOOR 2 | Test Fit

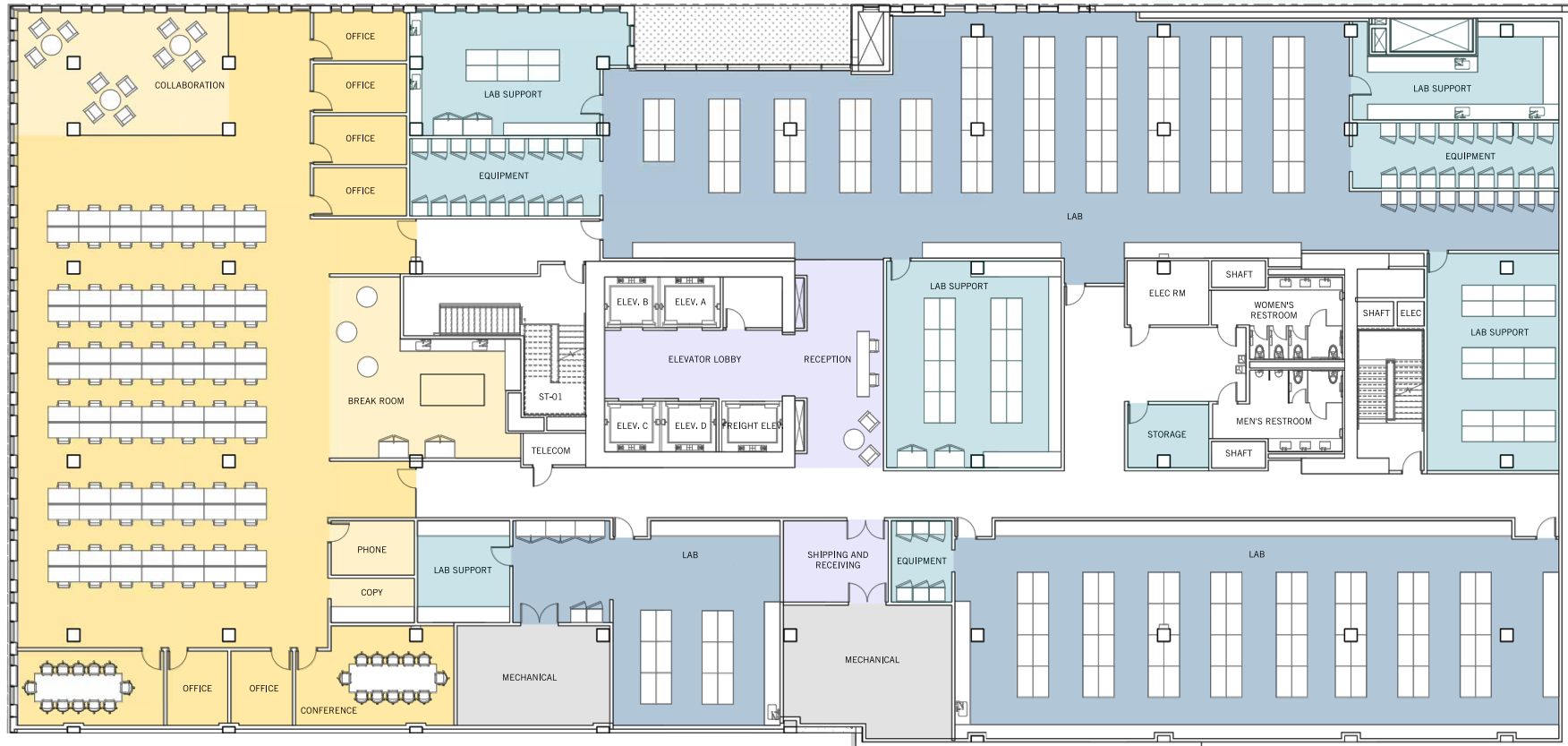

- Lab
- Lab Support/Equipment
- Office
- Office Support
- Mechanical

For More
Information,
Contact:

PAUL CARR | Senior Vice President | (206) 292 6005 | paul.carr@cbre.com
STEVEN PEROVICH | Senior Vice President | (206) 292 6059 | steven.perovich@cbre.com

CLASS A LIFE SCIENCE FACILITY

Designed for Premier Life Science Research

FLOOR 3 | Test Fit

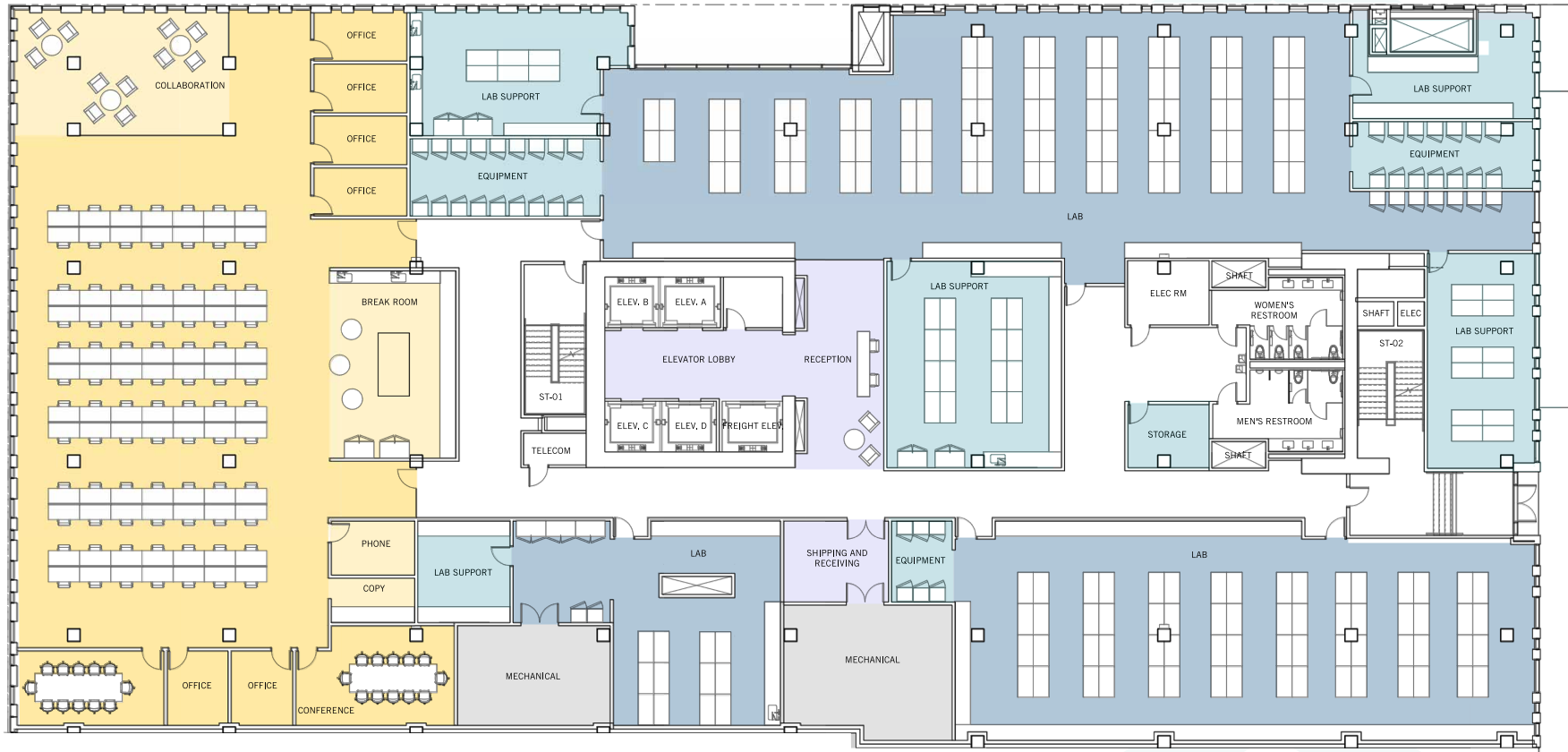

■ Lab ■ Lab Support/Equipment ■ Office ■ Office Support ■ Mechanical

For More
Information,
Contact:

PAUL CARR | Senior Vice President | (206) 292 6005 | paul.carr@cbre.com
STEVEN PEROVICH | Senior Vice President | (206) 292 6059 | steven.perovich@cbre.com

CLASS A LIFE SCIENCE FACILITY

Designed for Premier Life Science Research

FLOOR 4 | Test Fit

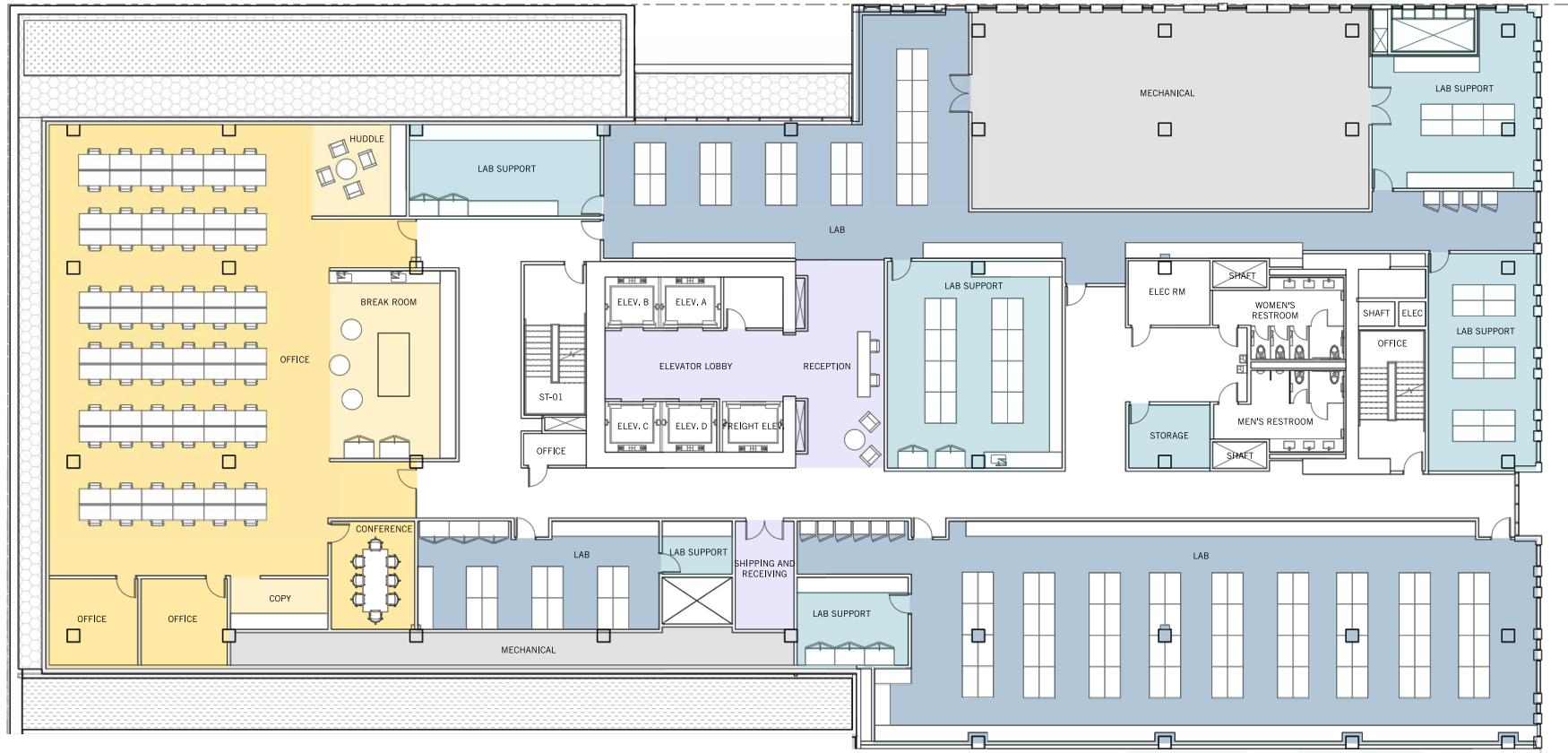

■ Lab ■ Lab Support/Equipment ■ Office ■ Office Support ■ Mechanical

For More
Information,
Contact:

PAUL CARR | Senior Vice President | (206) 292 6005 | paul.carr@cbre.com

STEVEN PEROVICH | Senior Vice President | (206) 292 6059 | steven.perovich@cbre.com

CLASS A LIFE SCIENCE FACILITY

Designed for Premier Life Science Research

FLOORS 5-8 | Test Fit

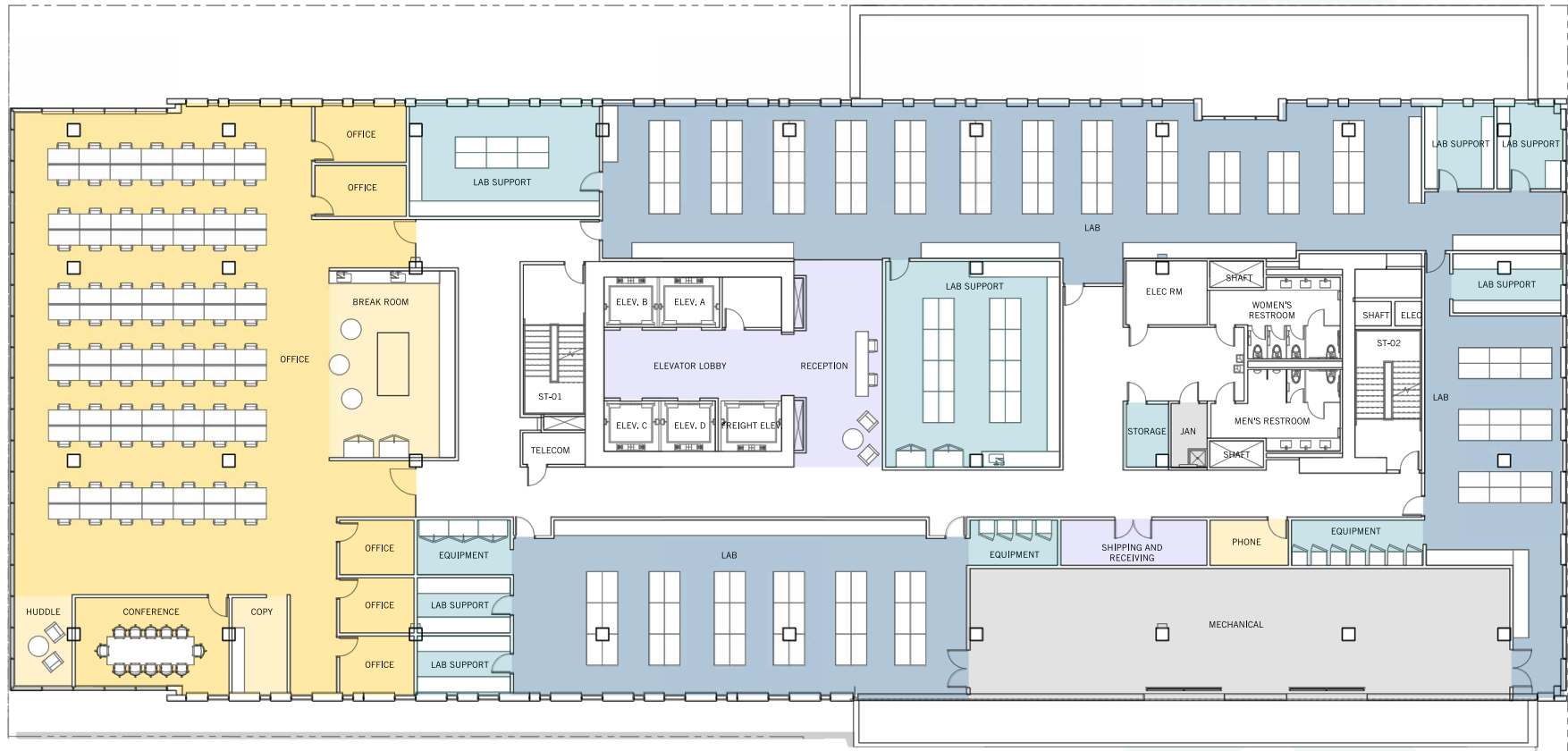

■ Lab ■ Lab Support/Equipment ■ Office ■ Office Support ■ Mechanical

For More
Information,
Contact:

PAUL CARR | Senior Vice President | (206) 292 6005 | paul.carr@cbre.com

STEVEN PEROVICH | Senior Vice President | (206) 292 6059 | steven.perovich@cbre.com

CLASS A LIFE SCIENCE FACILITY

Designed for Premier Life Science Research

FLOOR 9 | Test Fit



■ Lab ■ Lab Support/Equipment ■ Office ■ Office Support ■ Mechanical

For More
Information,
Contact:

PAUL CARR | Senior Vice President | (206) 292 6005 | paul.carr@cbre.com

STEVEN PEROVICH | Senior Vice President | (206) 292 6059 | steven.perovich@cbre.com