



  
**FLEXIBLE TERMS  
(MTM OR LONGER)**

  
**WELL-MAINTAINED  
BUILDING**

**±5,000 - 30,000 SF OVERFLOW STORAGE SPACE**

# AVAILABLE FOR SUBLEASE

**1020 FRONTENAC ROAD | NAPERVILLE, IL 60563**



  
**SECONDS OFF  
OF I-88**

**JOE KARMIN**  
*Executive Vice President*  
847.588.5670  
joe.karmin@transwestern.com

**JUSTIN LERNER, SIOR**  
*Executive Vice President*  
847.588.5665  
justin.lerner@transwestern.com

 This is an interactive PDF. Click to visit various websites or email the brokers.

±5,000 - 30,000 SF OVERFLOW STORAGE SPACE



# AVAILABLE FOR SUBLEASE

1020 FRONTENAC ROAD | NAPERVILLE, IL 60563

## PROPERTY SPECIFICATIONS

- Building Size: ±99,773 SF
- Available Size: ±5,000 - 30,000 SF Overflow Space
- Clear Height: 23'
- Loading: 1 Interior Dock
- Construction: Masonry
- Year Built: 1980
- Heating: Gas
- Sprinklers: Wet
- Sublease Rate: \$5.99 PSF Gross

## PROPERTY HIGHLIGHTS

- Overflow storage space for sublease
- Flexible terms; month-to-month or longer
- Extremely clean warehouse
- Well-maintained building
- Seconds off of I-88

## SITE PLAN

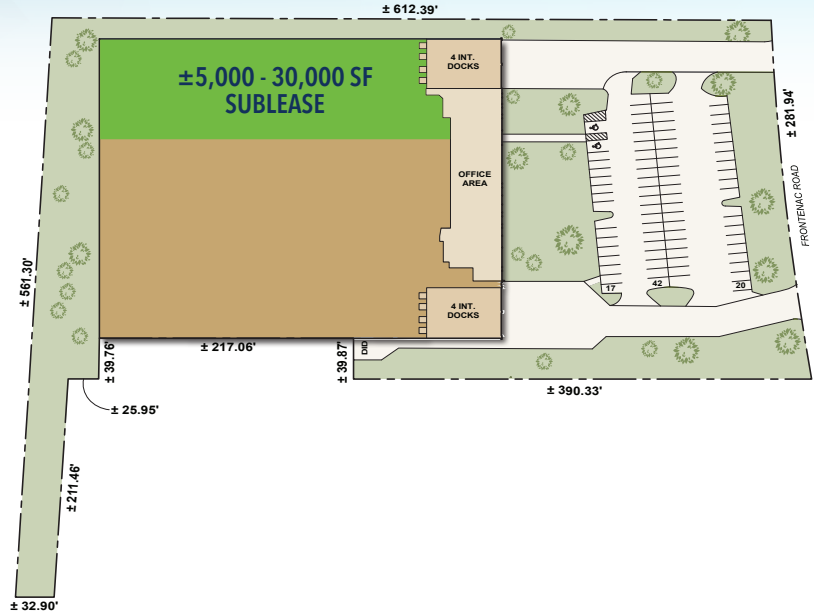

## AERIAL VIEW



JOE KARMIN

847-588-5670

JOE.KARMIN@TRANSWESTERN.COM

JUSTIN LERNER, SIOR

847-588-5665

JUSTIN.LERNER@TRANSWESTERN.COM