

## RECREATIONAL USE BUILDING FOR LEASE

# 2 CHIMNEY ROCK ROAD

BRIDGEWATER, NJ (GPS ADDRESS: BOUND BROOK, NJ)



### AVAILABLE SPACE

22,000 SF TOTAL | 18,500 SF Clear span space  
3,500 SF Office (Can be made smaller  
to 2,500 SF)

### POWER

1200 AMP - 120/208 VOLT  
3 PHASE 4 WIRE

### BUILDING SIZE

22,000 SF

### SPRINKLER

100% wet

### ZONING

Recreational use permitted

### AVAILABILITY

Immediate

### BAY SIZE

Clear Span (100' X 185')

### RENT

Call for pricing

### HEATING

Gas Hot Air

### COMMENTS

- Leasing office and property management on-site
- New LED lighting

## LEASING INFORMATION

### JEFFREY FUREY

973.947.9242

jeffrey.furey@transwestern.com

### LORI ZUCK

973.947.9214

lori.zuck@transwestern.com

### MATT MCHALE

973.947.9249

matthew.mchale@transwestern.com

The information provided herein was obtained from sources believed reliable; however, Transwestern makes no guarantees, warranties or representations as to the completeness or accuracy thereof. The presentation of this property is submitted subject to errors, omissions, change of price or conditions, prior sale or lease, or withdrawal without notice. Copyright ©2020 Transwestern.

## RECREATIONAL USE BUILDING FOR LEASE

# 2 CHIMNEY ROCK ROAD

BRIDGEWATER, NJ (GPS ADDRESS: BOUND BROOK, NJ)

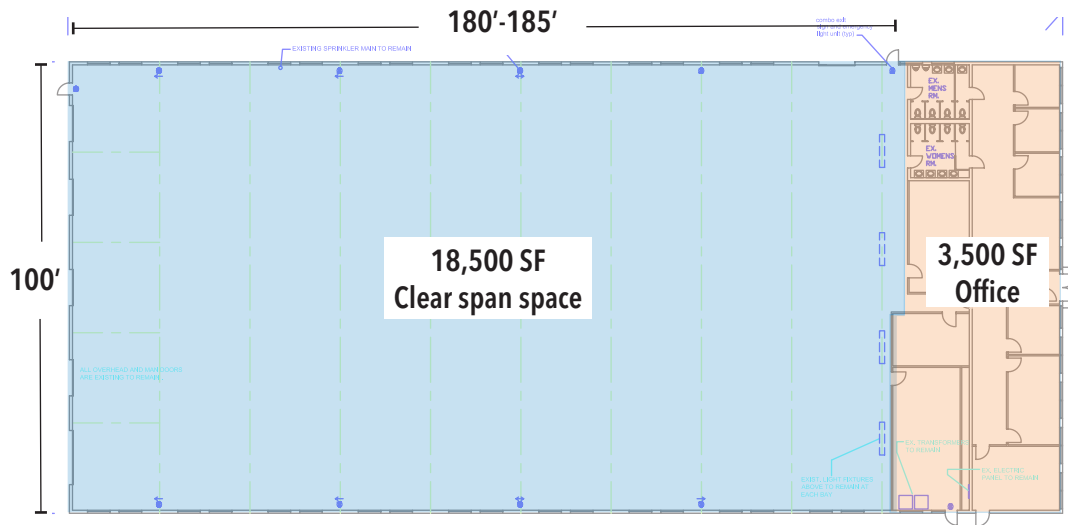

FLOOR PLAN  
1/8" = 1'-0"

## LOCATION FEATURES

- Excellent location
- Part of Middlebrook Crossroads Complex
- Proximity to highways and transportation including Newark Airport
- Convenient to Chimney Rock Crossings (Whole Foods, Nordstrom Rack, Saks OFF Fifth)
- Close proximity Bridgewater Promenade (Home Depot, Target, Costco, Old Navy, Michael's, Bed Bath and Beyond, Pet Smart)
- Highly visible from I-287, Route 22 and 28 / signage possible

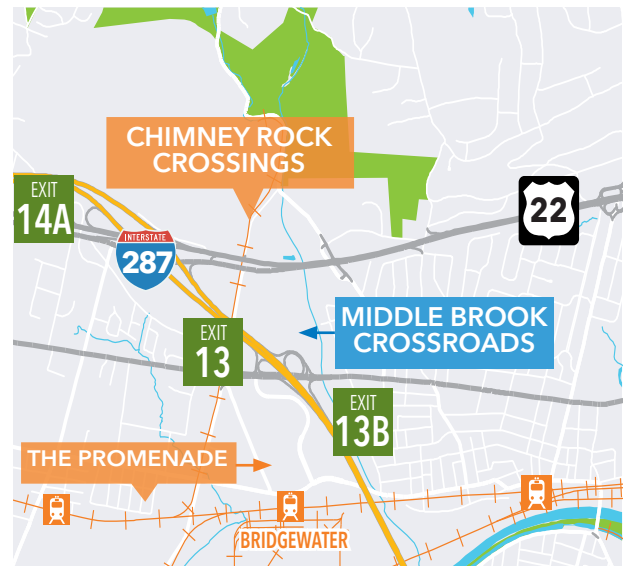

## LEASING INFORMATION

**JEFFREY FUREY**

973.947.9242

jeffrey.furey@transwestern.com

**LORI ZUCK**

973.947.9214

lori.zuck@transwestern.com

**MATT MCHALE**

973.947.9249

matthew.mchale@transwestern.com

The information provided herein was obtained from sources believed reliable; however, Transwestern makes no guarantees, warranties or representations as to the completeness or accuracy thereof. The presentation of this property is submitted subject to errors, omissions, change of price or conditions, prior sale or lease, or withdrawal without notice. Copyright ©2020 Transwestern.