

Office Space For Lease

12233 W. Olympic Blvd. - West Los Angeles



PROJECT SIZE: 151,000 rentable square feet

RENTAL RATE: \$5.50 per RSF, net of electricity

LEASE TERM: 3 - 10 years

TI ALLOWANCE: Negotiable

PARKING: 3 / 1,000 USF leased
\$110 per unreserved space
\$175 per reserved space
\$90 per tandem space

PROJECT FEATURES

Newly renovated, 151,000 square foot, 3-story Class A Office complex

Tenant controlled HVAC and operable windows

Signage opportunities

Great West Los Angeles location close to 405 & 10 Freeways

Telecom/Internet service provider on-site

Landscaped outdoor courtyard areas

Within walking distance to numerous restaurants

Across the street from the Westside Media Center, next door to Element LA and close to Sony, MTV, Yahoo! And HBO

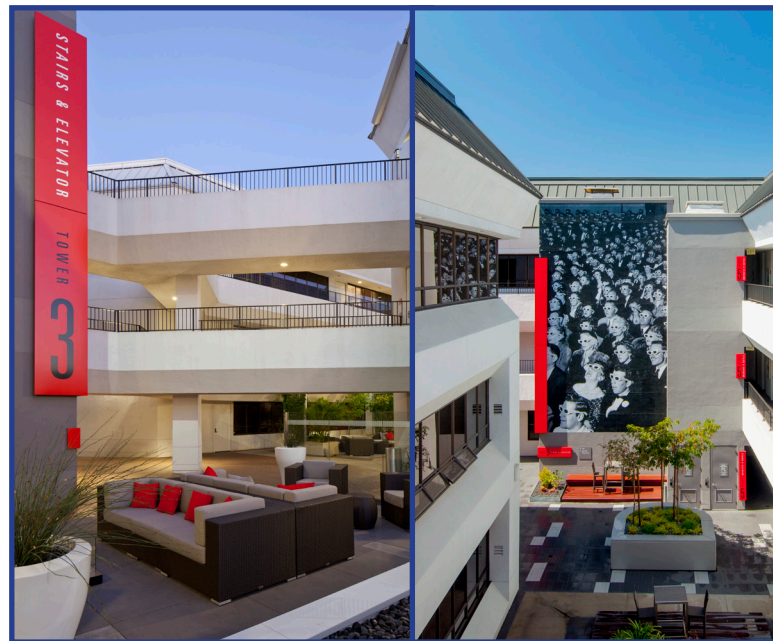

FOR LEASING INQUIRIES CONTACT:

JOE KING

310.442.3375

DRE Lic. No.: 01195833

jking@madisonpartners.net

MAGGI KELLEY

424.442.2400

operations@tribecawestla.com

Tribeca West

TRIBECA WEST

OWNED AND OPERATED BY:

**KILROY
REALTY
CORPORATION**

12233 W. Olympic Boulevard

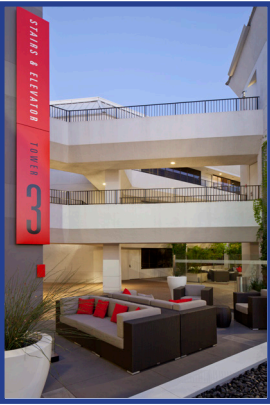

AVAILABLE SUITES

Suite	RSF	Notes
100	500-10,000	30 days notice

AREA AMENITIES

Restaurants

- t.west cafe (on-site)
- Coffee Bean & Tea Leaf
- Quizno's
- Il Moro
- LA Farm
- Bombay Cafe
- Chan Dara
- Valentino
- The Counter
- Vito's
- Il Forno
- El Torito

Health & Fitness

- David Barton Gym
- LA Fitness
- Velocity Training

Retail / Other

- Trader Joe's
- Ralph's
- Walgreen's
- Bed Bath & Beyond
- Sports Chalet

SITE PLAN

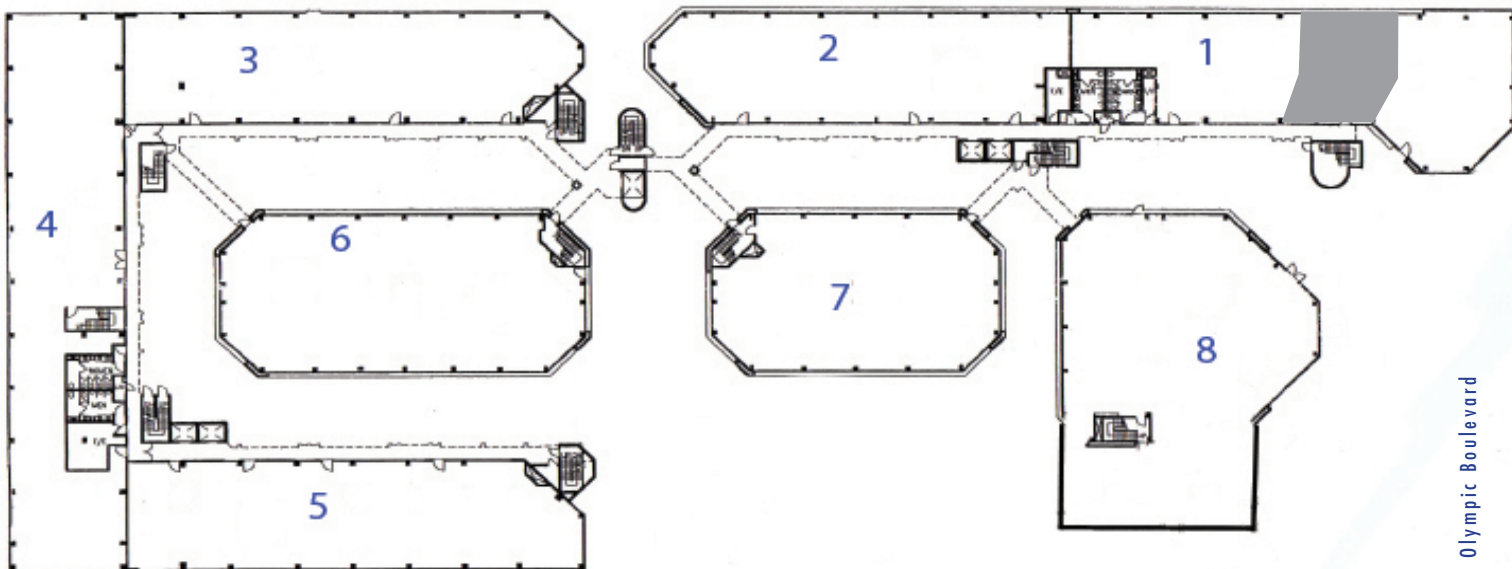

Olympic Boulevard



FOR LEASING INQUIRIES CONTACT:

JOE KING
310.442.3375
DRE Lic. No.: 01195833
jking@madisonpartners.net

MAGGI KELLEY
424.442.2400
operations@tribecawestla.com
Tribeca West



OWNED AND OPERATED BY:
KILROY
REALTY
CORPORATION