

FOR LEASE

Toikka Business Park

19504 24th Avenue West, Lynnwood, Washington



FEATURES

- 8,092 total SF
- 3,700 SF of efficiently configured office area on two floors
- Four (4) grade level loading doors
- Heavy power available
- Excellent freeway access
- Fenced, secure outside area for fleet parking/yard storage
- See reverse side for floor plans

CONTACT

Matthew P. Henn

Senior Vice President

206.890.7800 | mhenn@gvakm.com

www.gvakm.com

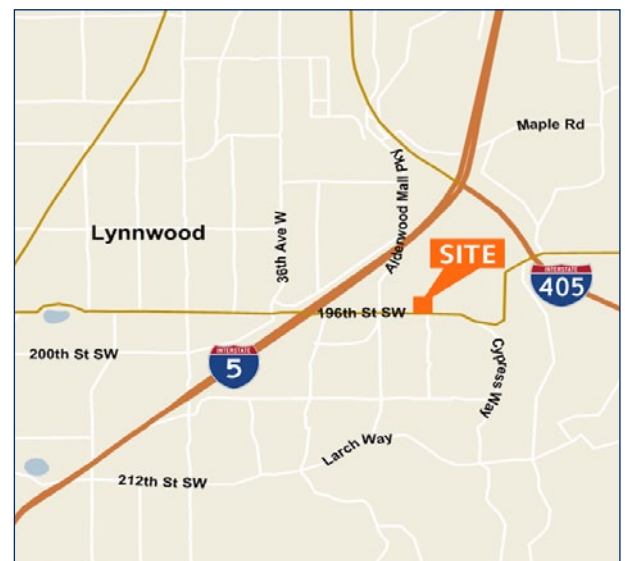

Matthew Hagen

Senior Vice President

425.283.5782 | mhagen@gvakm.com

This information supplied herein is from sources we deem reliable. It is provided without any representation, warranty or guarantee, expressed or implied as to its accuracy. Prospective Buyer or Tenant should conduct an independent investigation and verification of all matters deemed to be material, including, but not limited to, statements of income and expenses. Consult your attorney, accountant, or other professional advisor.



FOR LEASE

Toikka Business Park

19504 24th Avenue West, Lynnwood, Washington

FIRST FLOOR

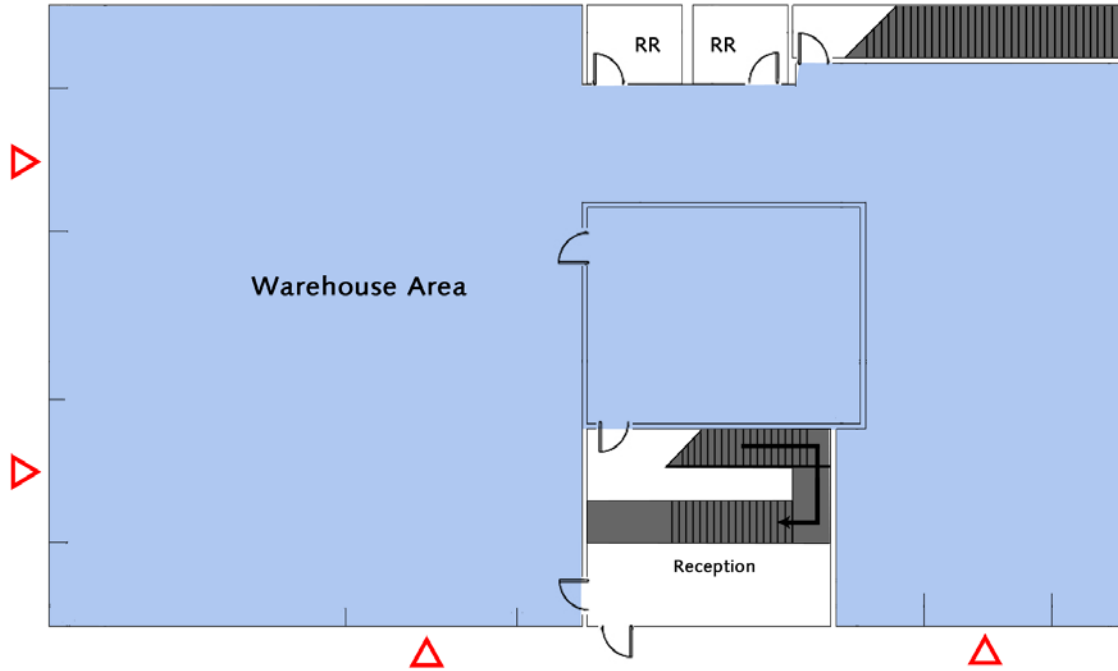

SECOND FLOOR

