

# **NORTH 1ST** **AT ORCHARD STATION** **3010 N. FIRST** **NORTH SAN JOSE**

±54,180 SF (DIVISIBLE)

CLASS A OFFICE + R&D PROJECT

[www.cbre.us/North1stAtOrchard](http://www.cbre.us/North1stAtOrchard)

COMING FALL 2018



**CBRE**



**WASHINGTON**  
**HOLDINGS**

**CHRIS SHEPHERD**  
SENIOR VICE PRESIDENT  
+1 408 453 7455  
CHRIS.SHEPHERD@CBRE.COM  
LIC. 01707888

**CHRISTIAN MARENT**  
EXECUTIVE VICE PRESIDENT  
+1 408 453 7422  
CHRISTIAN.MARENT@CBRE.COM  
LIC. 00932744

**MARK CHRISTIERSON**  
SENIOR VICE PRESIDENT  
+1 408 453 7452  
MARK.CHRISTIERSON@CBRE.COM  
LIC. 01296954

# PROPERTY OVERVIEW

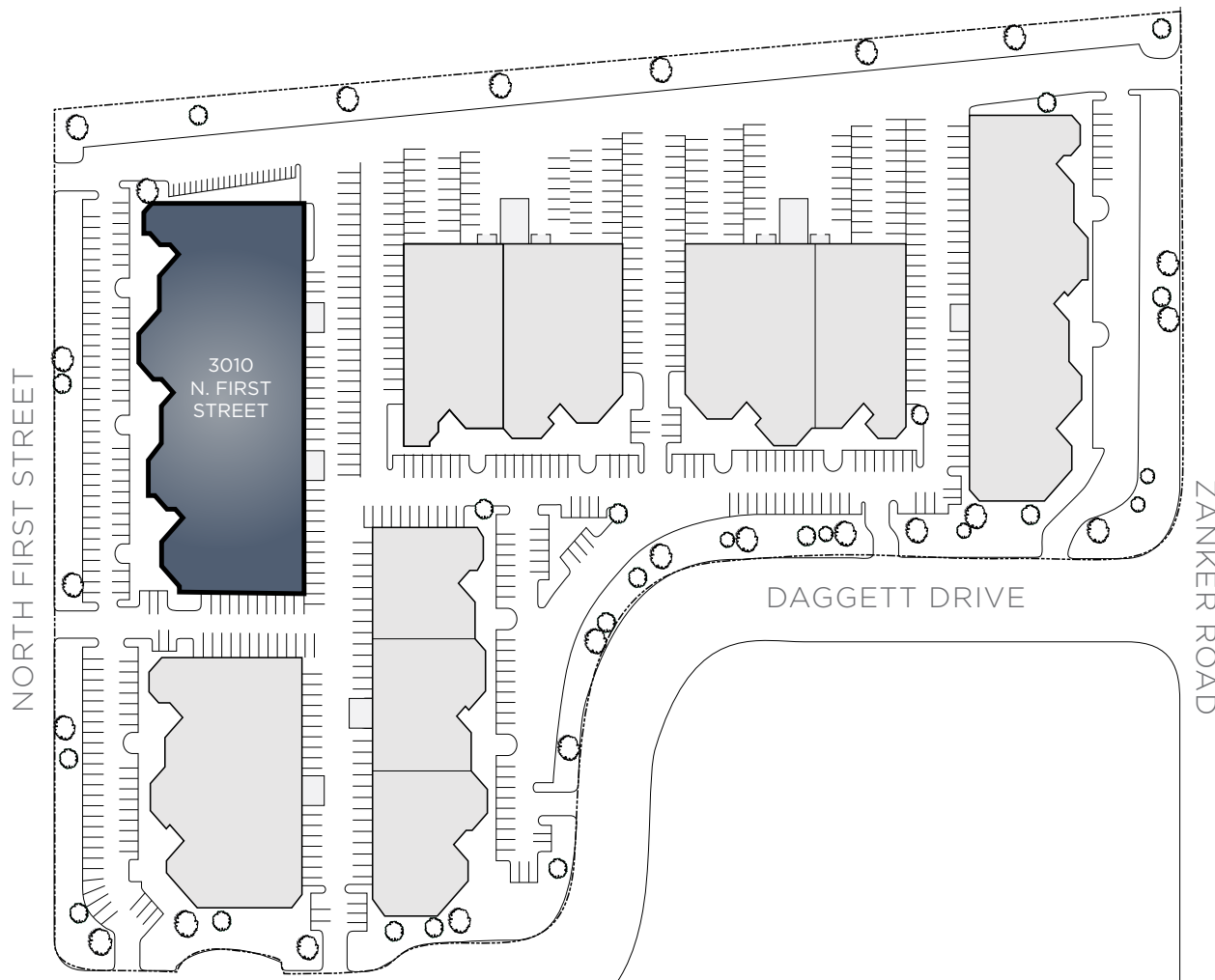

## PROPERTY AVAILABILITY

3010 N. FIRST STREET  
N. SAN JOSE

± 54,180 SF

Divisible to ±34,456 SF and ±19,724 SF

## PROPERTY FEATURES

- 6 Building Office / R&D Project
- Building & Monument Signage Available
- Expansion Opportunities
- Ample Power
- Dock and Grade Level Loading
- 3.36 / 1,000 Parking
- Walk to restaurants, retail services and lodging
- Light Rail Stop in front of Project
- Convenient access to Highway 101/237/87 and 1-880
- Large outdoor amenity area with fencing for security

# DEDICATED OUTDOOR AMENITY AREA

OUTDOOR TABLES, WORK SPACE AND LOUNGE



# MARKET READY FLOOR PLAN

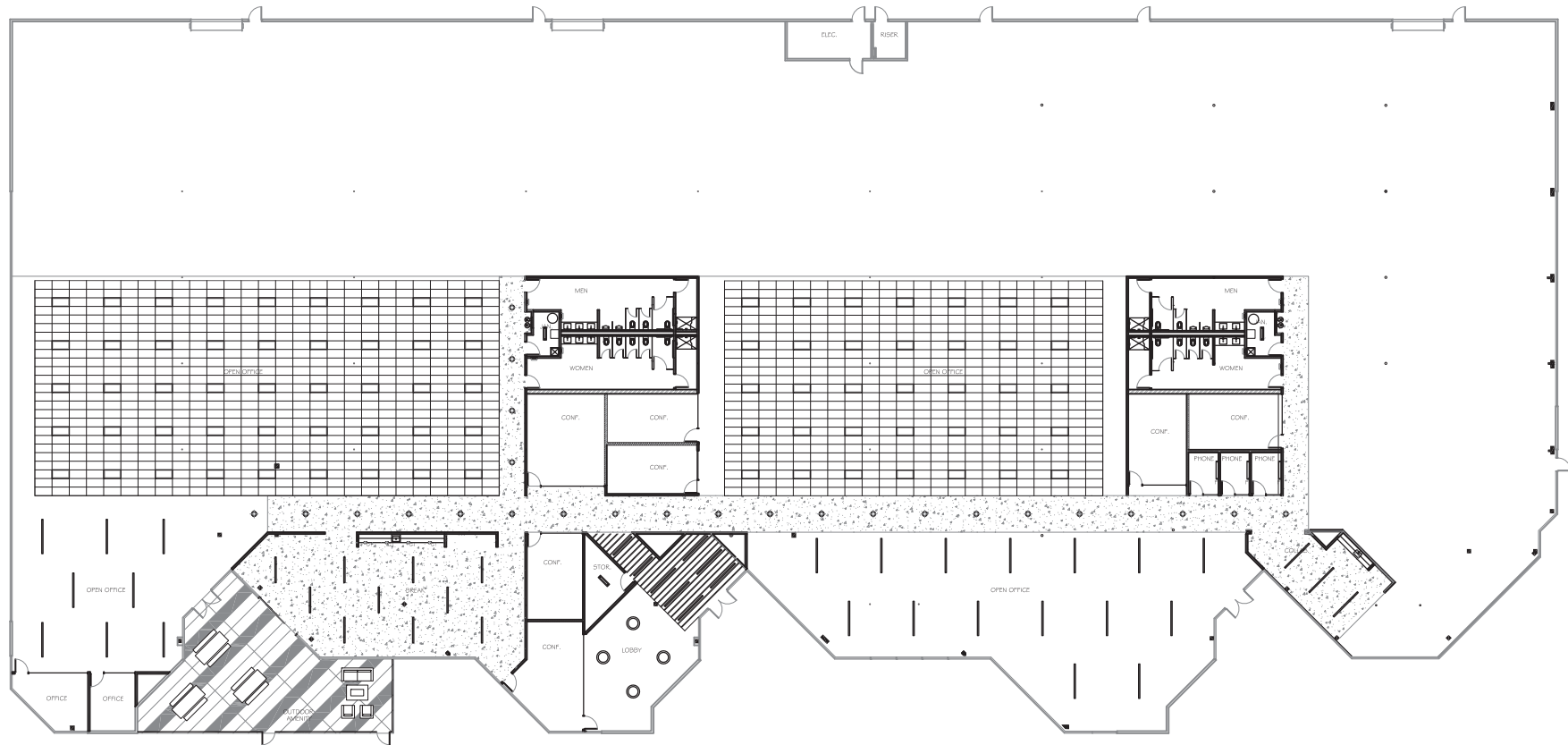

## SPACE HIGHLIGHTS

- ± 54,180 RSF
- Creative Open Ceiling Office Environment
- Designed by Studio G
- Dedicated, Enclosed Outdoor Amenity Space
- Showers with Premises
- Grade Level and Dock Level Loading
- 3,000a @ 480v

# HYPOTHETICAL FLOOR PLAN 1 - OFFICE

## PROGRAM SUMMARY

Conference	21	Training Room	1
Offices	15	Storage	7
Meeting	10	Copy & Print	3
Phone	11	Collaboration Areas	9
Workstations (30"x60")	252	Lobby	2
Fitness Gym	1	Break Room	1
Server	1	Lunch Room	1
Show Room	1	Gated Outdoor Amenity	1

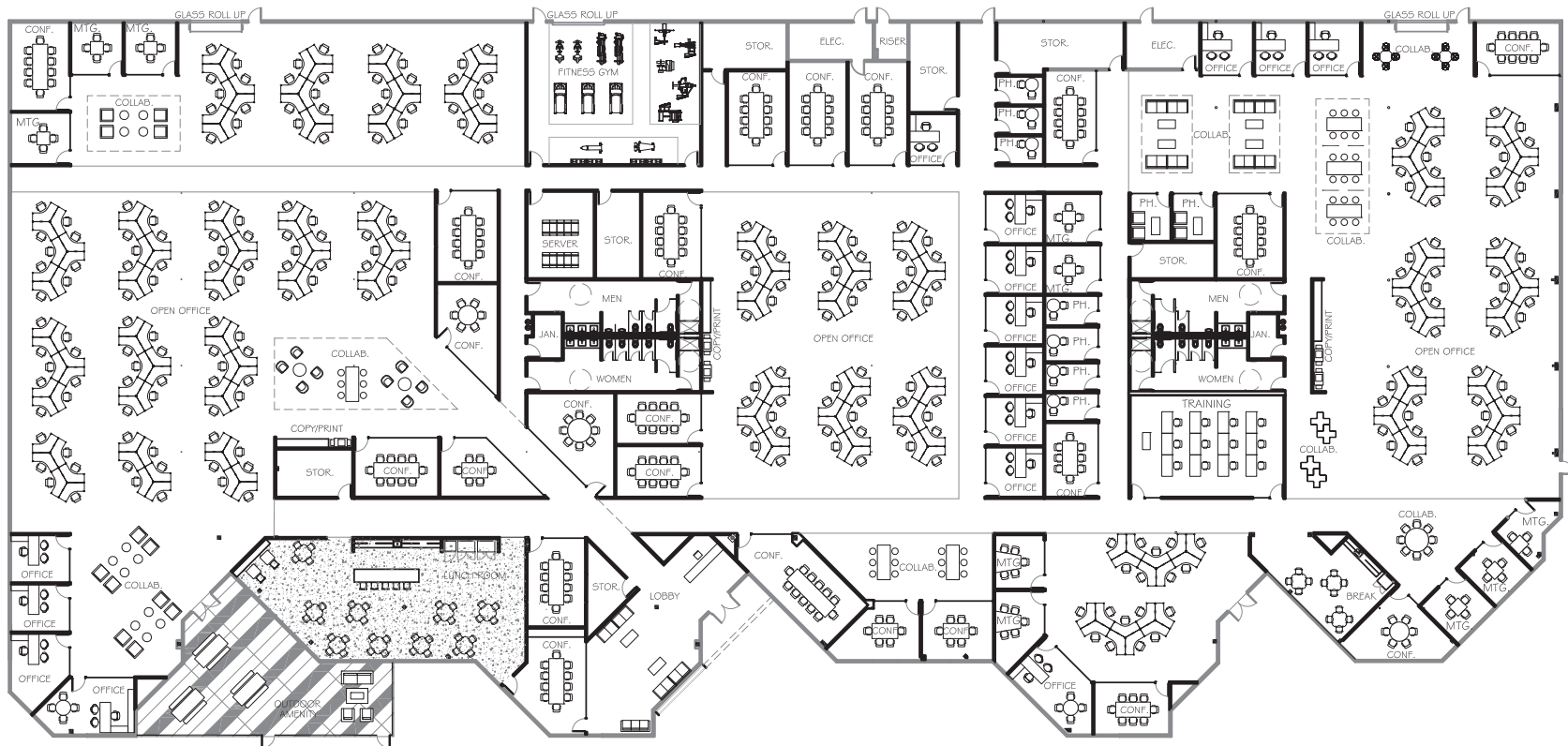

# HYPOTHETICAL FLOOR PLAN 2 - OFFICE/R&D

## PROGRAM SUMMARY

Conference	22	Storage	5
Offices	22	Copy & Print	3
Phone	6	Collaboration Areas	4
Workstations	21	Lobby	2
Cubicles	110	Break Room	1
Showroom	1	Lunch Room	1
Server	1	Game Room	1
Lab	5	Gated Outdoor Amenity	1
Shipping & Receiving	1		



# TWO TENANT FLOOR PLAN

## TENANT #1 PROGRAM SUMMARY: ± 34,456 SF

Conference	15	Server	1
Offices	12	Game Room	1
Phone	3	Storage	5
Cubicles (6'x8')	20	Copy & Print	2
Workstations (120°)	147	Collaboration Areas	1
Lab	3	Lobby	1
Warehouse	1	Lunch Room	1
Shipping & Receiving	1	Gated Outdoor Amenity	1

## TENANT #2 PROGRAM SUMMARY: ± 19,724 RSF

Conference	8	Warehouse	1
Offices	6	Copy & Print	1
Phone	3	Collaboration Areas	4
Cubicles (6'x8')	24	Lobby	1
Workstations (120°)	60	Break Room	1
Lab	2	Outdoor Amenity	1
Server	1		
Storage	2		

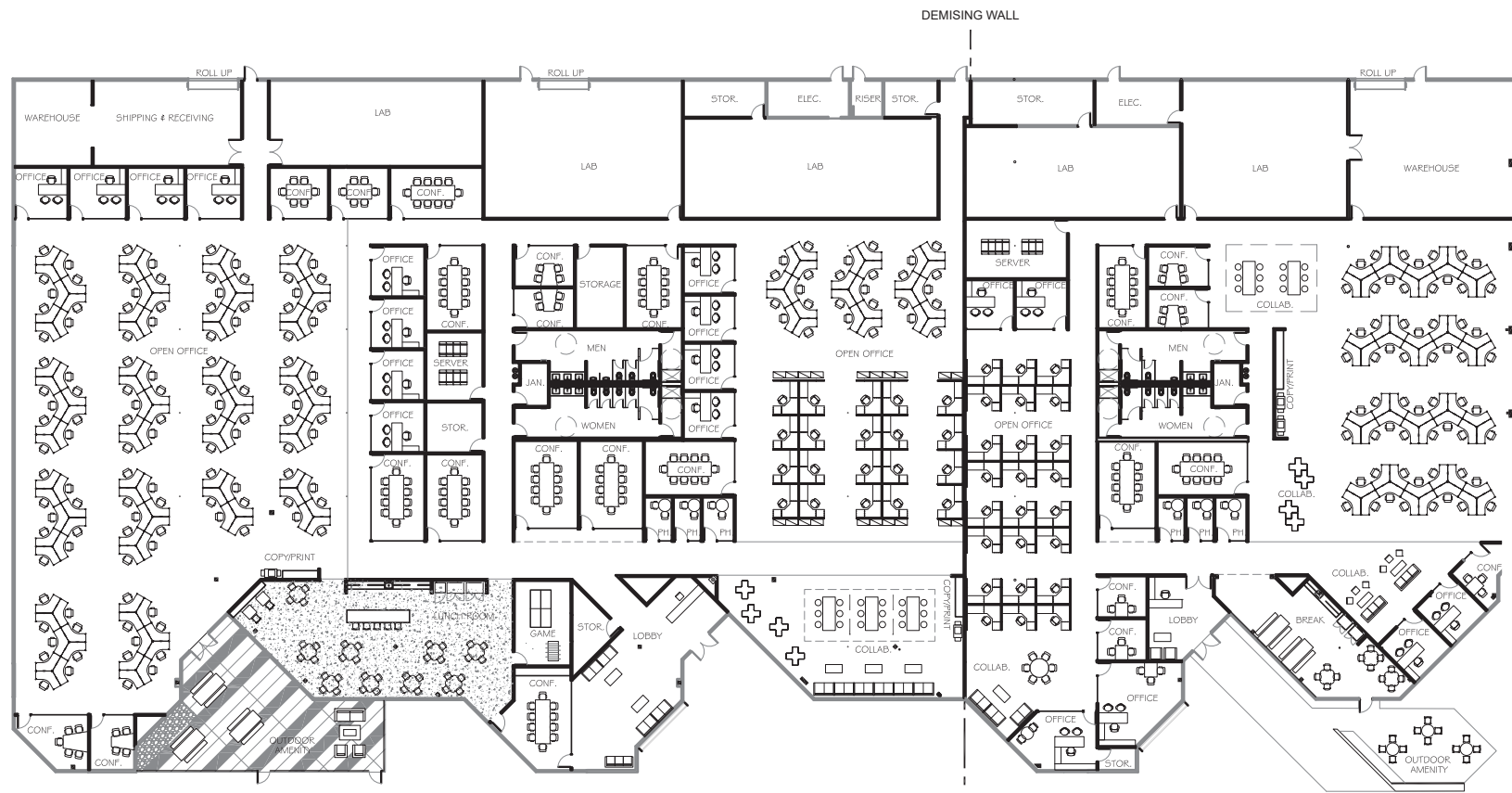

# TRANSPORTATION MAP

## ROUTE LEGEND



VTA Bus Routes



VTA Light Rail & Stations  
321 Line & Orchard Station 200 Ft.



CalTrain Line & Stations  
Santa Clara Station 3.7 Miles

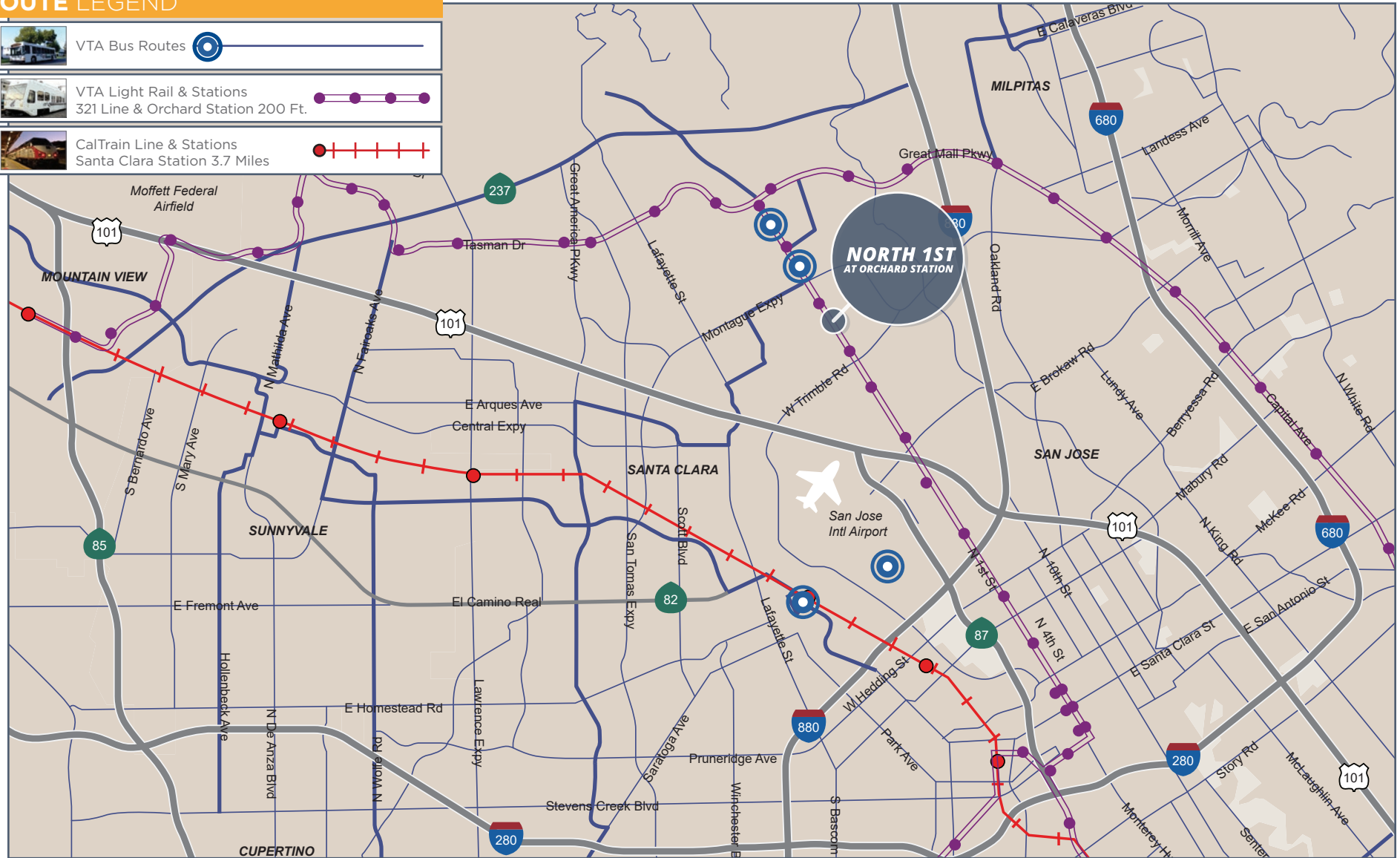

# AMENITIES MAP



# ***NORTH 1ST AT ORCHARD STATION***

## ***3010 N. FIRST***

[www.cbre.us/North1stAtOrchard](http://www.cbre.us/North1stAtOrchard)

### **CONTACT INFORMATION**

---

#### **CHRIS SHEPHERD**

SENIOR VICE PRESIDENT  
+1 408 453 7455  
CHRIS.SHEPHERD@CBRE.COM  
LIC. 01707888

#### **CHRISTIAN MARENT**

EXECUTIVE VICE PRESIDENT  
+1 408 453 7422  
CHRISTIAN.MARENT@CBRE.COM  
LIC. 00932744

#### **MARK CHRISTIERSON**

SENIOR VICE PRESIDENT  
+1 408 453 7452  
MARK.CHRISTIERSON@CBRE.COM  
LIC. 01296954

#### **CBRE, INC.**

225 WEST SANTA CLARA STREET  
12TH FLOOR  
SAN JOSE, CA 95113  
CBRE.US/SANJOSE



© 2018 CBRE, Inc. All rights reserved. This information has been obtained from sources believed reliable, but has not been verified for accuracy or completeness. You should conduct a careful, independent investigation of the property and verify all information. Any reliance on this information is solely at your own risk. CBRE and the CBRE logo are service marks of CBRE, Inc. All other marks displayed on this document are the property of their respective owners. Photos herein are the property of their respective owners. Use of these images without the express written consent of the owner is prohibited. PMStudio\_4\_2018