

1309-1313 FULTON STREET

OFF OF NOSTRAND AVENUE | BEDFORD-STUYVESANT



SPACE A

SPACE B

SPACE C

1309-1313 FULTON STREET

OFF OF NOSTRAND AVENUE | BEDFORD-STUYVESANT

SIZE	SPACE A	SPACE B	SPACE C
Ground Floor	1,350 SF	1,350 SF	1,350 SF
FRONTAGE	15'	15'	15'

CEILING HEIGHT

11'

POSSESSION

Immediate

ASKING RENT

Upon Request

COMMENTS

- Prime retail right off of Nostrand
- up to 6,000 SF (can combine)
- Motivated landlord

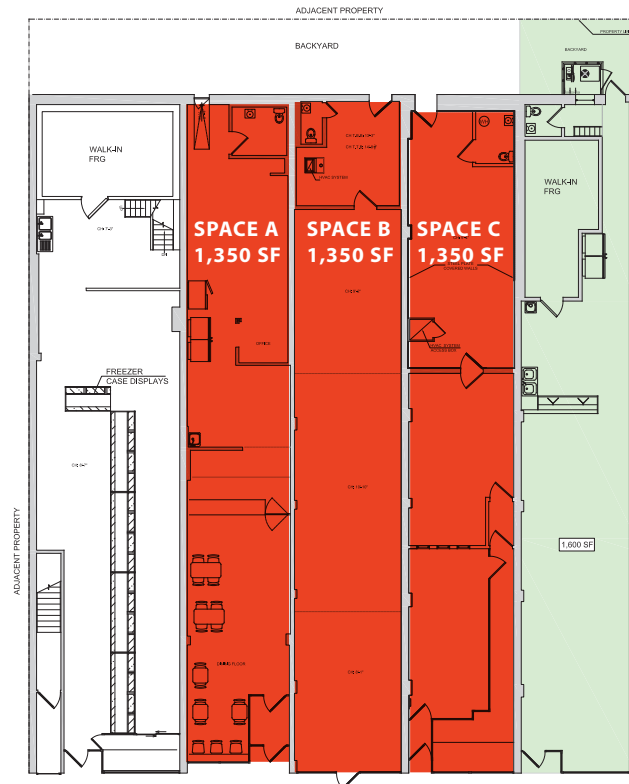

CONTACT OUR BROKER(S) FOR MORE INFORMATION



KASSIN SABBAGH REALTY
1385 Broadway 22nd floor
New York, NY 10018
(212) 417-9217
<https://www.ksrny.com/>

BRANDON EFAP

BEfap@ksrny.com

917.312.0291

SOLOMON SHARABY

SSharaby@ksrny.com

718.986.7149

All information supplied in this marketing presentation and/or flyer is from sources deemed reliable and is furnished subject to errors, omissions, modifications, removal of listings from sale/lease and to any listing conditions. Any square footage, dimensions, floor plans and/or technical data set forth are approximations and are subject to further elaboration/confirmation.