



**Highly Accessible Headquarters
& Distribution Center**

New Pricing • Now Divisible

Property Highlights

- 242,175 SF building
- 206,255 SF warehouse
- 35,920 SF office
- 51 docks
- Two (2) drive-ins
- 50 trailer spots
- 128 surface parking spaces
- Unique office space
- 30' clear height
- 6" concrete floor
- EFSR sprinkler system
- T-8 fluorescent lighting
- Low tax rate community
- Central location to multiple freeways
- **Owner may subdivide**

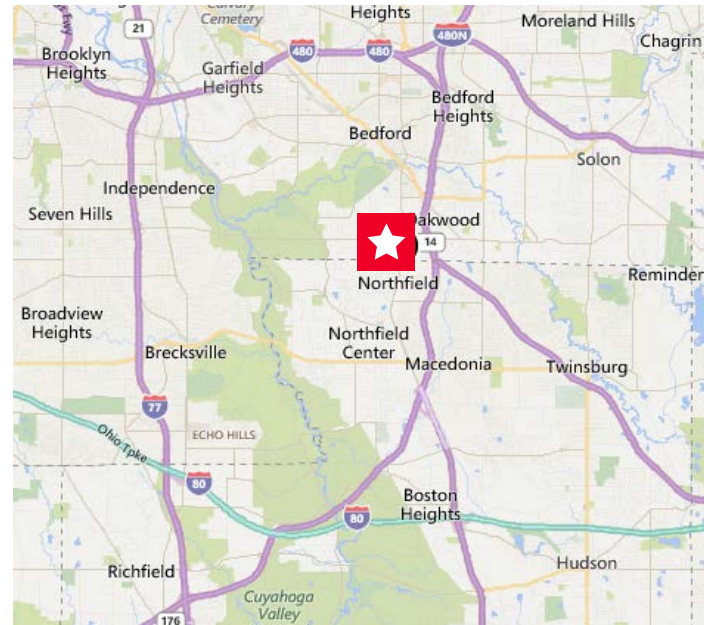

Matthew Beesley, SIOR
Principal
216.525.1466
mbeesley@crecorealestate.com

Bob Wetzel
Senior Sales Associate
216.525.1486
rwetzel@crecorealestate.com

3 Summit Park Drive,
Suite 200
Cleveland, Ohio 44131
Main 216.520.1200
Fax 216.520.1828
crecorealestate.com



AVAILABLE

7700 Northfield Road
Walton Hills, OH 44146

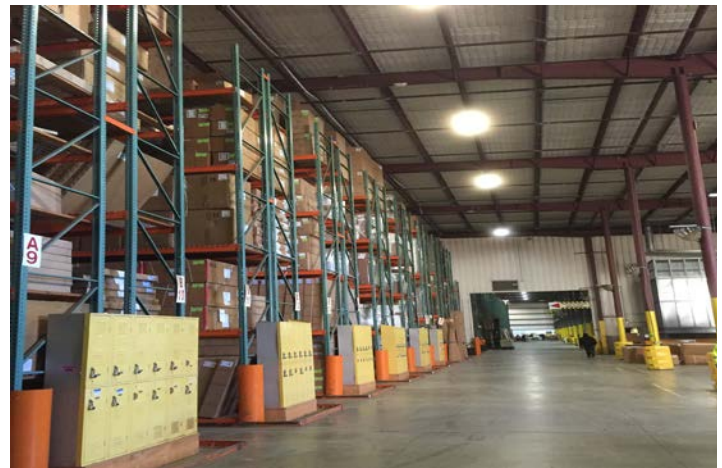

Matthew Beesley, SIOR
Principal
216.525.1466
mbeesley@crescorealestate.com

Bob Wetzel
Senior Sales Associate
216.525.1486
rwetzel@crescorealestate.com

3 Summit Park Drive,
Suite 200
Cleveland, Ohio 44131
Main 216.520.1200
Fax 216.520.1828
crescorealestate.com

Independently Owned and Operated / A Member of the Cushman & Wakefield Alliance

Cushman & Wakefield Copyright 2015. No warranty or representation, express or implied, is made to the accuracy or completeness of the information contained herein, and same is submitted subject to errors, omissions, change of price, rental or other conditions, withdrawal without notice, and to any special listing conditions imposed by the property owner(s). As applicable, we make no representation as to the condition of the property (or properties) in question.

Floor Plan - Option 1 - Current

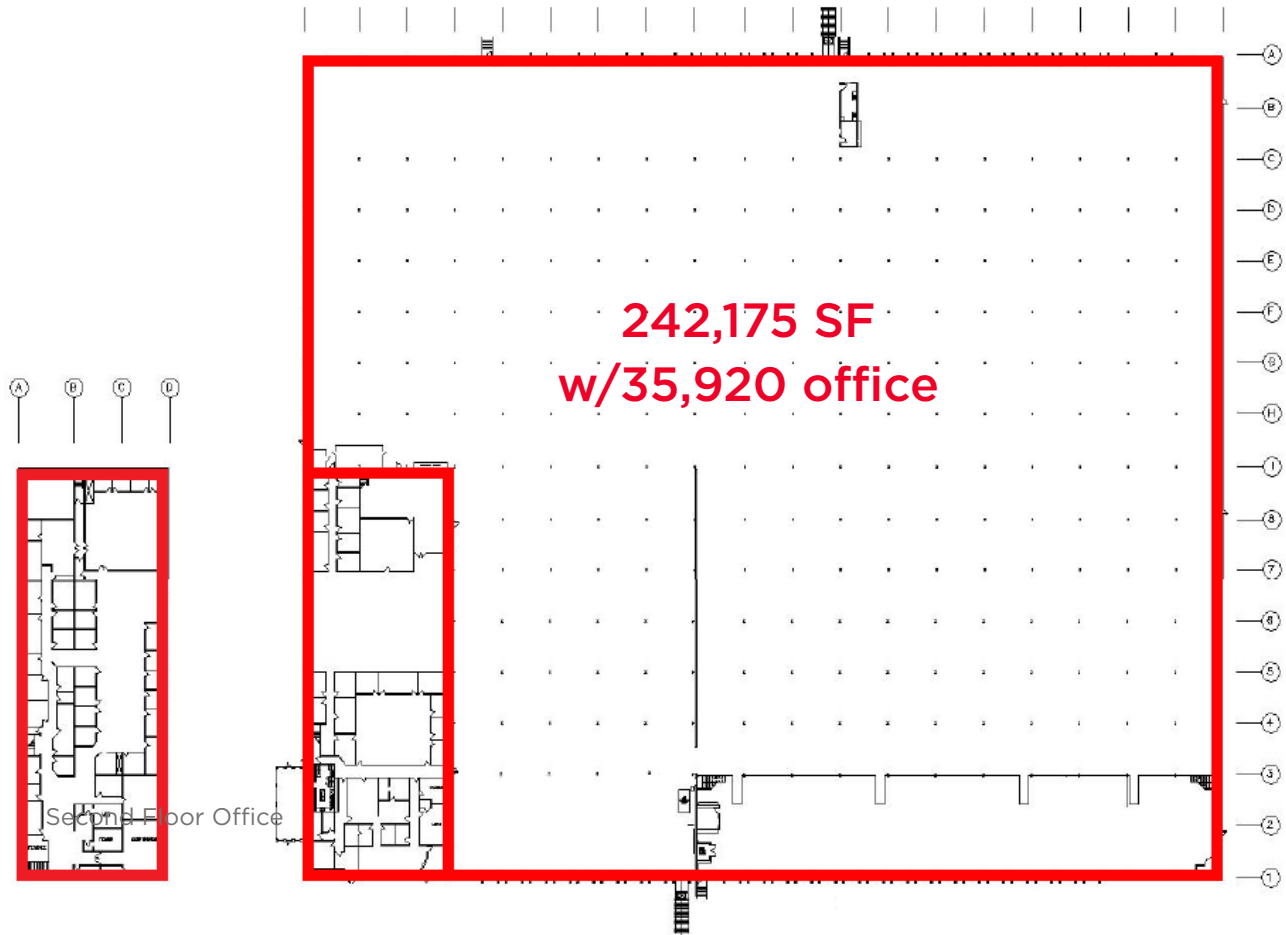

- Total: 242,175 SF
- Office: 35,920 SF
- Warehouse: 206,255 SF
- Docks: 51
- Drive-in Door: 2
- Amps: 1600

Matthew Beesley, SIOR
Principal
216.525.1466
mbeesley@creSCOREalestate.com

Bob Wetzel
Senior Sales Associate
216.525.1486
rwetzel@creSCOREalestate.com

3 Summit Park Drive,
Suite 200
Cleveland, Ohio 44131
Main 216.520.1200
Fax 216.520.1828
creSCOREalestate.com

Summary (32608)



7700 NORTHFIELD ROAD 7700 Northfield Road Walton Hills, OH 44146

County:	Cuyahoga
Market:	SE-Z1
Sub Market:	SE Cuyahoga County
Land Size (Acres)	16.65 Acres
Lot Dimensions (LxW):	760x989
Available SF:	242,175 SF
Building SF:	242,175 SF
Industrial SF:	206,255 SF
Office SF:	35,920 SF

Building

Construction Status:	Existing
Primary Use:	Light Industrial
Secondary Use:	Distribution Facility
Floors:	1
Multi-Tenant:	Single-Tenant
Year Built:	1993
Year Refurbished	2001, 2005
ConstructionType:	Metal/Pre-engineered
Roof Type:	Metal
Roof Age:	Original
Deck Type:	Metal
Floor Type:	Concrete
Floor Thickness:	6"
Lighting Type:	T-8
Sprinkler:	ESFR
Heat:	Air Rotation
AC:	HVAC-Office
Ceiling Ht:	30' (Min) 36' (Max)
Column Spacing:	25x55

General Listing/Transaction Information

Asking Rate:	\$4.85 NNN Per Year
Min Avail SF:	98,715 SF
Transaction Type:	Lease
Total Additional Rent:	\$1.51
Vacancy Type:	Sublease

Parking

# Spaces:	128
------------------	-----

Loading & Doors

# GL/DID:	2
GL/DID Dim. (H x W)	12x14
Cross-Docked:	Yes
#DH/Truck-level Doors:	51
Total Doors:	53
Loading & Doors Comments:	multiple are cross-docks

Contacts

Listing Broker(s)	Matthew Beesley, SIOR CRESCO Real Estate 216.525.1466 mbeesley@crescorealestate.com Robert Wetzel CRESCO Real Estate 216.525.1486 rwetzel@crescorealestate.com
--------------------------	---

Utilities

Gas:	Dominion
Water:	City
Sewer:	City

Site

Land SF:	725,466 SF
Parcel Number:	794-25-017
Zoning:	INDUSTRIAL
Land Condition:	Excellent
Floodplain:	none

Crane

Comments

Listing Comments: Prime High Bay Distribution Space. Built in 1993 with expansion in 2001 and 2005. Situated on 16.6544 acres. Features: EFSR sprinkler system, 6" concrete floors, multiple cross docks, T-8 fluorescent lighting, and 128 surface spaces. Excellent freeway access. Sub-lease for entire building available. SUBLEASE term through April 2020. Longer term is available. Tenant is Homeworks (Arhaus).

Floor Plan - Option 2 - Space

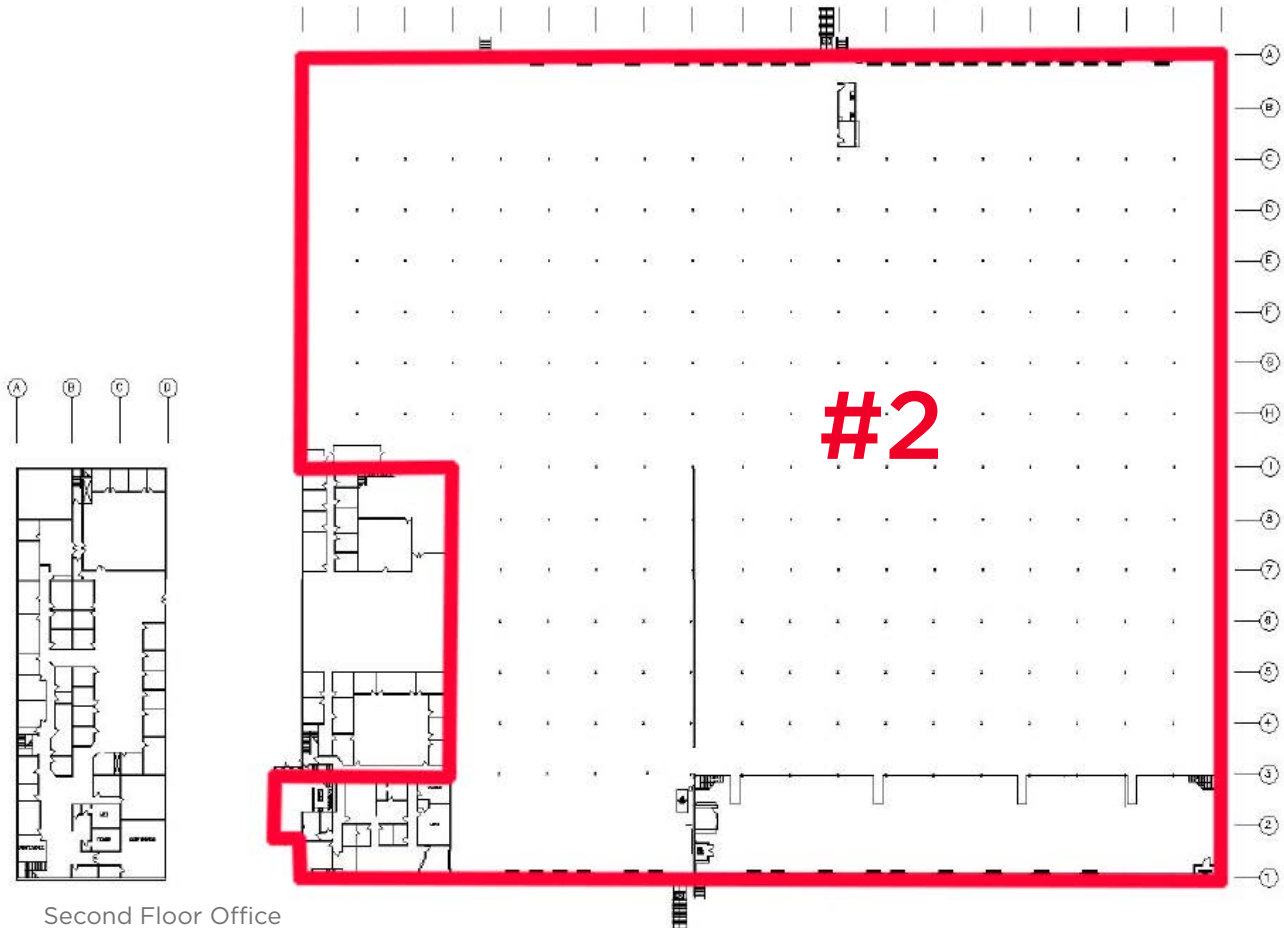

- **Total: 211,255 SF**
- **Office: 5,000 SF**
- **Warehouse: 206,255 SF**
- **Docks: 51**
- **Drive-in Doors: 2**
- **Amps: 1600**
- **Up to 35,920 SF office available**

Matthew Beesley, SIOR
Principal
216.525.1466
mbeesley@creSCOREalestate.com

Bob Wetzel
Senior Sales Associate
216.525.1486
rwetzel@creSCOREalestate.com

3 Summit Park Drive,
Suite 200
Cleveland, Ohio 44131
Main 216.520.1200
Fax 216.520.1828
creSCOREalestate.com

Summary (34270)



7700 NORTHFIELD ROAD 7700 Northfield Road, Ste Option 2 Walton Hills, OH 44146

County:	Cuyahoga
Market:	SE-Z1
Sub Market:	SE Cuyahoga County
Land Size (Acres)	16.65 Acres
Lot Dimensions (LxW):	760x989
Available SF:	211,255 SF
Building SF:	242,175 SF
Industrial SF:	206,255 SF
Office SF:	5,000 SF

Building

Construction Status:	Existing
Primary Use:	Light Industrial
Secondary Use:	Distribution Facility
Floors:	1
Multi-Tenant:	Single-Tenant
Year Built:	1993
Year Refurbished	2001, 2005
ConstructionType:	Metal/Pre-engineered
Roof Type:	Metal
Roof Age:	Original
Deck Type:	Metal
Floor Type:	Concrete
Floor Thickness:	6"
Lighting Type:	T-8
Sprinkler:	ESFR
Heat:	Air Rotation
AC:	HVAC-Office
Ceiling Ht:	30' (Min) 36' (Max)
Column Spacing:	25x55

General Listing/Transaction Information

Asking Rate:	\$4.95 NNN
Max Contig SF:	242,175 SF
Transaction Type:	Lease
Total Additional Rent:	\$1.51

Parking

# Spaces:	100
------------------	-----

Loading & Doors

# GL/DID:	2
#DH/Truck-level Doors:	51
Total Doors:	53

Contacts

Listing Broker(s)	Matthew Beesley, SIOR CRESCO Real Estate 216.525.1466 mbeesley@creSCOREalestate.com Robert Wetzl CRESCO Real Estate 216.525.1486 rwetzl@creSCOREalestate.com
--------------------------	---

Utilities

Gas:	Dominion
Water:	City
Sewer:	City

Site

Land SF:	725,466 SF
Parcel Number:	794-25-017
Zoning:	INDUSTRIAL
Floodplain:	none

Crane

Comments

Listing Comments: Prime High Bay Distribution Space. Built in 1993 with expansion in 2001 and 2005. Situated on 16.6544 acres. Features: EFSR sprinkler system, 6" concrete floors, multiple cross docks, T-8 fluorescent lighting, and 128 surface spaces. Excellent freeway access. Sub-lease for entire building available. SUBLEASE term through April 2020. Longer term is available. Tenant is Homeworks (Arhaus).

Floor Plan - Option 3 - Space

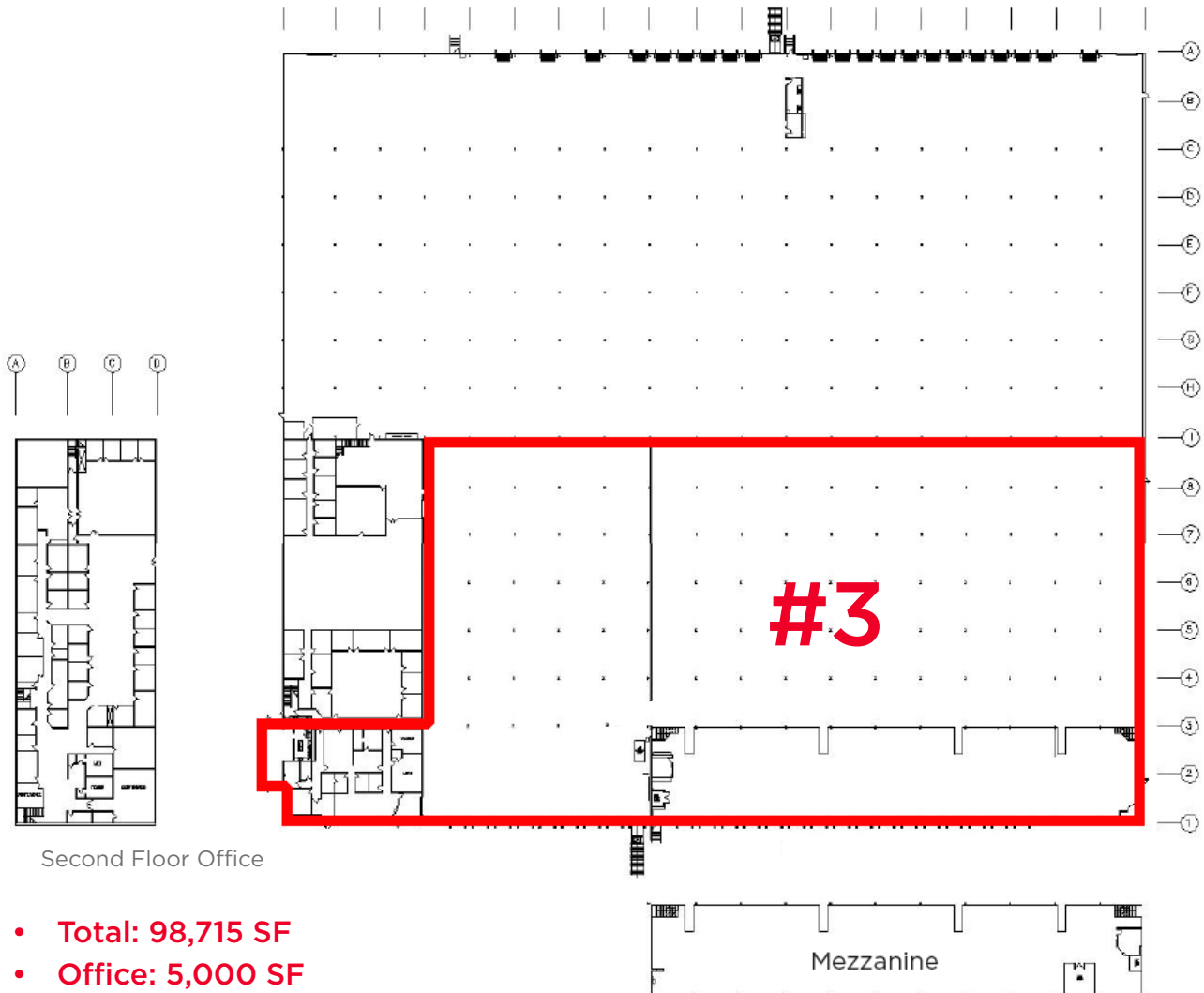

Second Floor Office

- **Total: 98,715 SF**
- **Office: 5,000 SF**
- **Warehouse: 93,715 SF**
- **Docks: 25**
- **Drive-in Doors: 1**
- **Amps: 1200**
- **Up to 35,920 SF office available**

Matthew Beesley, SIOR
Principal
216.525.1466
mbeesley@creSCORErealEstate.com

Bob Wetzel
Senior Sales Associate
216.525.1486
rwetzel@creSCORErealEstate.com

3 Summit Park Drive,
Suite 200
Cleveland, Ohio 44131
Main 216.520.1200
Fax 216.520.1828
creSCORErealEstate.com

Summary (34271)



7700 NORTHFIELD ROAD
7700 Northfield Road,
Ste Option 3
Walton Hills, OH 44146

County: Cuyahoga
Market: SE-Z1
Sub Market: SE Cuyahoga County
Land Size (Acres): 16.65 Acres
Lot Dimensions (LxW): 760x989
Available SF: 98,715 SF
Building SF: 242,175 SF
Industrial SF: 93,715 SF
Office SF: 5,000 SF

Building

Construction Status: Existing
Primary Use: Light Industrial
Secondary Use: Distribution Facility
Floors: 1
Multi-Tenant: Single-Tenant
Year Built: 1993
Year Refurbished: 2001, 2005
ConstructionType: Metal/Pre-engineered
Roof Type: Metal
Roof Age: Original
Deck Type: Metal
Floor Type: Concrete
Floor Thickness: 6"
Lighting Type: T-8
Sprinkler: ESFR
Heat: Air Rotation
AC: HVAC-Office
Ceiling Ht: 30' (Min) 36' (Max)
Column Spacing: 25x55

General Listing/Transaction Information

Asking Rate: \$4.95 NNN Per Year
Max Contig SF: 242,175 SF
Transaction Type: Lease
Total Additional Rent: \$1.51
Vacancy Type: Sublease

Parking

Spaces: 64

Loading & Doors

GL/DID: 1
#DH/Truck-level Doors: 25
Total Doors: 26

Contacts

Listing Broker(s) Matthew Beesley, SIOR
 CRESCO Real Estate
 216.525.1466
 mbeesley@crescorealestate.com
 Robert Wetzel
 CRESCO Real Estate
 216.525.1486
 rwetzel@crescorealestate.com

Utilities

Gas: Dominion
Water: City
Sewer: City

Site

Land SF: 725,466 SF
Parcel Number: 794-25-017
Zoning: INDUSTRIAL
Floodplain: none

Crane

Comments

Listing Comments: Prime High Bay Distribution Space. Built in 1993 with expansion in 2001 and 2005. Situated on 16.6544 acres. Features: EFSR sprinkler system, 6" concrete floors, multiple cross docks, T-8 fluorescent lighting, and 128 surface spaces. Excellent freeway access. Sub-lease for entire building available. SUBLEASE term through April 2020. Longer term is available. Tenant is Homeworks (Arhaus).

Floor Plan - Option 4 - Space

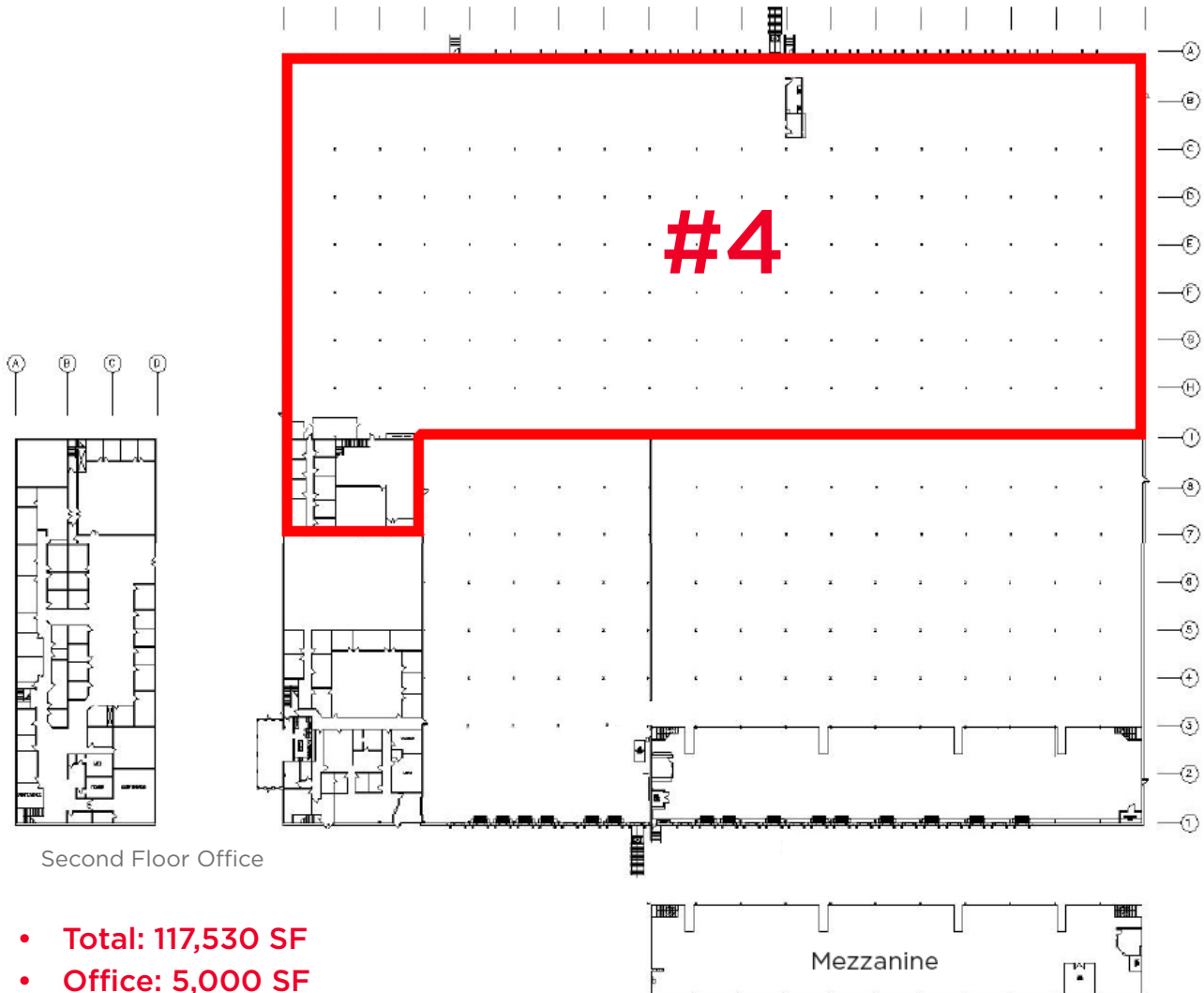

- **Total: 117,530 SF**
- **Office: 5,000 SF**
- **Warehouse: 112,530 SF**
- **Docks: 26**
- **Drive-in Doors: 1**
- **Amps: 400**
- **Up to 35,920 SF office available**

Matthew Beesley, SIOR
Principal
216.525.1466
mbeesley@creSCOREalestate.com

Bob Wetzel
Senior Sales Associate
216.525.1486
rwetzel@creSCOREalestate.com

3 Summit Park Drive,
Suite 200
Cleveland, Ohio 44131
Main 216.520.1200
Fax 216.520.1828
creSCOREalestate.com

Summary (34282)



7700 NORTHFIELD ROAD 7700 Northfield Road, Ste Option 4 Walton Hills, OH 44146

County:	Cuyahoga
Market:	SE-Z1
Sub Market:	SE Cuyahoga County
Land Size (Acres)	16.65 Acres
Lot Dimensions (LxW):	760x989
Available SF:	117,530 SF
Building SF:	242,175 SF
Industrial SF:	112,530 SF
Office SF:	5,000 SF

Building

Construction Status:	Existing
Primary Use:	Light Industrial
Secondary Use:	Distribution Facility
Floors:	1
Multi-Tenant:	Single-Tenant
Year Built:	1993
Year Refurbished	2001, 2005
ConstructionType:	Metal/Pre-engineered
Roof Type:	Metal
Roof Age:	Original
Deck Type:	Metal
Floor Type:	Concrete
Floor Thickness:	6"
Sprinkler:	ESFR
Ceiling Ht:	30' (Min) 36' (Max)
Column Spacing:	25x55

General Listing/Transaction Information

Asking Rate:	\$4.95 NNN Per Year
Max Contig SF:	242,175 SF
Transaction Type:	Lease
Total Additional Rent:	\$1.51
Vacancy Type:	Sublease

Parking

# Spaces:	64
------------------	----

Loading & Doors

# GL/DID:	1
#DH/Truck-level Doors:	26
Total Doors:	27

Contacts

Listing Broker(s)	Matthew Beesley, SIOR CRESCO Real Estate 216.525.1466 mbeesley@crescorealestate.com Robert Wetzel CRESCO Real Estate 216.525.1486 rwetzel@crescorealestate.com
--------------------------	---

Utilities

Gas:	Dominion
Water:	City
Sewer:	City

Site

Land SF:	725,466 SF
Parcel Number:	794-25-017
Zoning:	INDUSTRIAL
Floodplain:	none

Crane

Comments

Listing Comments: Listing Comments: Prime High Bay Distribution Space. Built in 1993 with expansion in 2001 and 2005. Situated on 16.6544 acres. Features: EFSR sprinkler system, 6" concrete floors, multiple cross docks, T-8 fluorescent lighting, and 128 surface spaces. Excellent freeway access. Sub-lease for entire building available. SUBLEASE term through April 2020. Longer term is available. Tenant is Homeworks (Arhaus).

Floor Plan - Option 5- Space

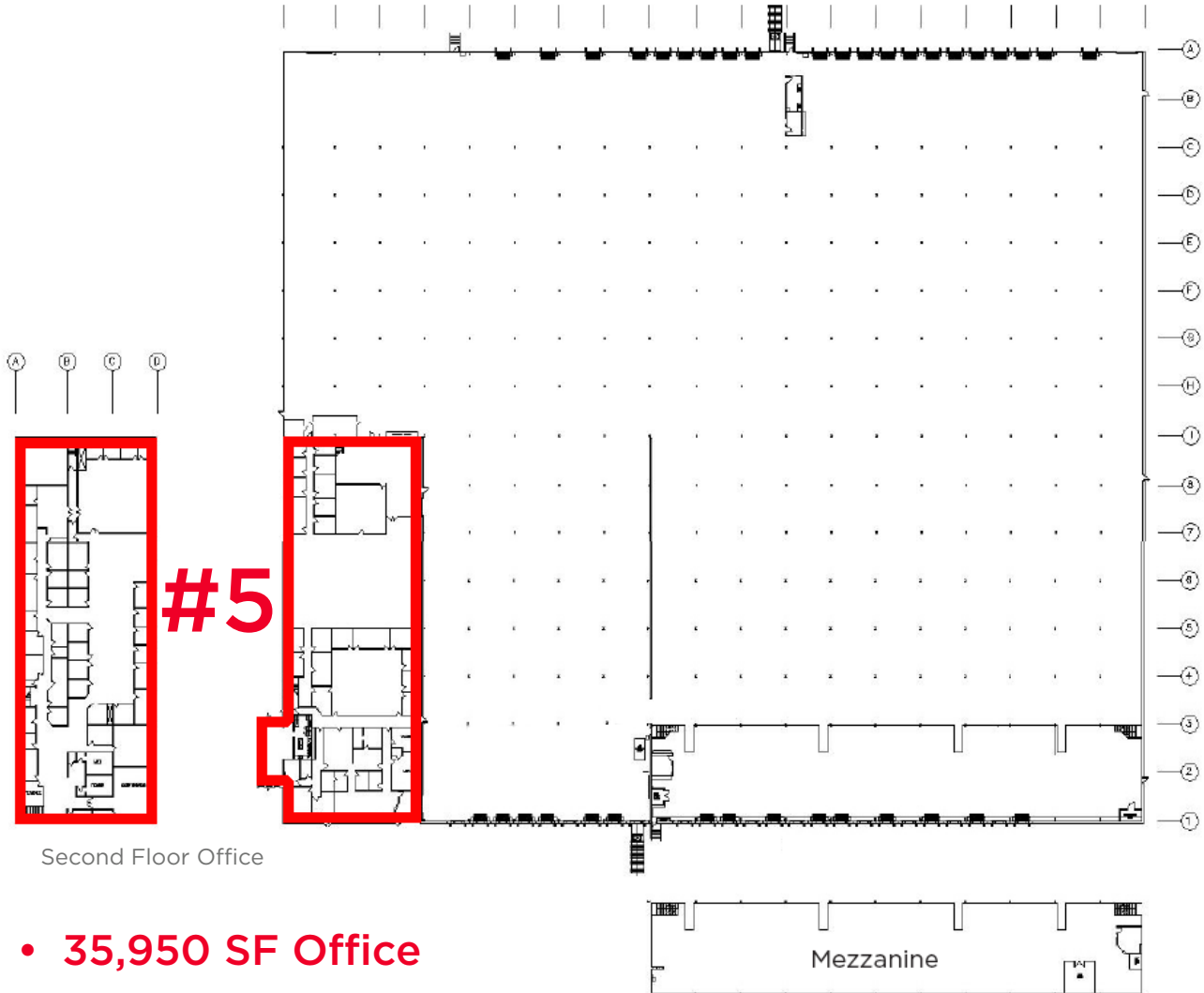

Second Floor Office

- **35,950 SF Office**
- **100 parking spaces**

Matthew Beesley, SIOR
Principal
216.525.1466
mbeesley@crecorealestate.com

Bob Wetzel
Senior Sales Associate
216.525.1486
rwetzel@crecorealestate.com

3 Summit Park Drive,
Suite 200
Cleveland, Ohio 44131
Main 216.520.1200
Fax 216.520.1828
crecorealestate.com

Summary (34272)



7700 NORTHFIELD ROAD
7700 Northfield Road,
Ste Option 5
Walton Hills, OH 44146

County: Cuyahoga
Market: SE-Z1
Sub Market: SE Cuyahoga County
Land Size (Acres): 16.65 Acres
Lot Dimensions (LxW): 760x989
Available SF: 35,920 SF
Building SF: 242,175 SF
Office SF: 35,920 SF

Building

Construction Status: Existing
Primary Use: Light Industrial
Secondary Use: Distribution Facility
Floors: 1
Multi-Tenant: Single-Tenant
Year Built: 1993
Year Refurbished: 2001, 2005
ConstructionType: Metal/Pre-engineered
Roof Type: Metal
Roof Age: Original
Deck Type: Metal
Floor Type: Concrete
Floor Thickness: 6"
Lighting Type: T-8
Sprinkler: ESFR
Heat: Air Rotation
AC: HVAC-Office
Ceiling Ht: 30' (Min) 36' (Max)
Column Spacing: 25x55

General Listing/Transaction Information

Asking Rate: \$8.50 NNN
Max Contig SF: 242,175 SF
Transaction Type: Lease
Total Additional Rent: \$1.51

Parking

Spaces: 100

Loading & Doors

Contacts

Listing Broker(s)
 Matthew Beesley, SIOR
 CRESCO Real Estate
 216.525.1466
 mbeesley@crescorealestate.com
 Robert Wetzel
 CRESCO Real Estate
 216.525.1486
 rwetzel@crescorealestate.com

Utilities

Gas: Dominion
Water: City
Sewer: City

Site

Land SF: 725,466 SF
Parcel Number: 794-25-017
Zoning: INDUSTRIAL
Floodplain: none

Crane

Comments

Listing Comments: Listing Comments: Prime High Bay Distribution Space. Built in 1993 with expansion in 2001 and 2005. Situated on 16.6544 acres. Features: EFSR sprinkler system, 6" concrete floors, multiple cross docks, T-8 fluorescent lighting, and 128 surface spaces. Excellent freeway access. Sub-lease for entire building available. SUBLEASE term through April 2020. Longer term is available. Tenant is Homeworks (Arhaus).