

MIDWAY BUILDING - BESTECH CENTER

3909 Bestech Road, Pittsfield Twp., MI 48197



FOR LEASE

248.476.3700

EXCLUSIVELY LISTED BY:
JAMES PORTH
Partner
jporth@thomasduke.com

OFFERING SUMMARY: 3909 Bestech Road | Pittsfield Twp., MI 48197



PROPERTY OVERVIEW

Midway Industrial Condominium - Unit 300

OFFERING SUMMARY

Lease Rate: \$14.50 SF/yr (Gross)
Building Size: 24,800 SF
Available SF: 2,200 SF
Year Built: 2005
Zoning: Light Industrial

PROPERTY HIGHLIGHTS

- Midway Industrial Condominium - Unit 300
- Office/Warehouse space.
- 20' Ceiling Height
- Overhead Door (12 x 14)



BUILDING/PROPERTY INFORMATION: 3909 Bestech Road | Pittsfield Twp., MI 48197

BUILDING INFORMATION

Lease Rate: \$14.50/SF, Gross
 Available Space: Unit 300 - 2,200 SF
 Building Size: 24,800 SF
 Year Built: 2005
 Number of Floors: 1
 Utilities: Municipal Sanitary & Sanitary Sewer
 Parking Spaces: 50

PROPERTY INFORMATION

Property Type: Light Industrial
 Property Subtype: Office/Warehouse
 Zoning: Light Industrial
 2022 Traffic Counts: Carpenter Road = 18,434
 Michigan Ave = 15,273
 US23 = 17,414
 APN: L-12-23-115-003

LOCATION INFORMATION

Located off Carpenter Road just North of Michigan Avenue in Bestech Center Industrial Park.

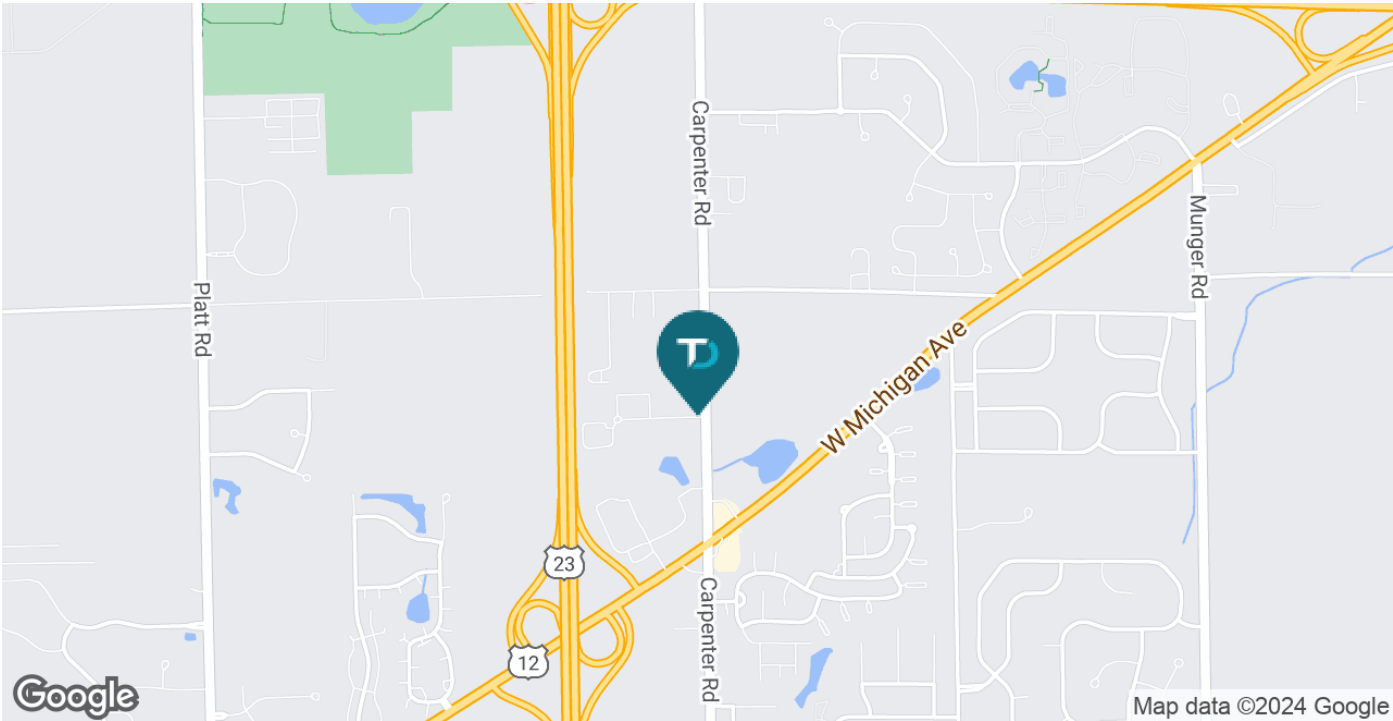

ADDITIONAL PHOTOS: 3909 Bestech Road | Pittsfield, MI 48197





ADDITIONAL PHOTOS: 3909 Bestech Road | Pittsfield, MI 48197



ADDITIONAL PHOTOS: 3909 Bestech Road | Pittsfield, MI 48197

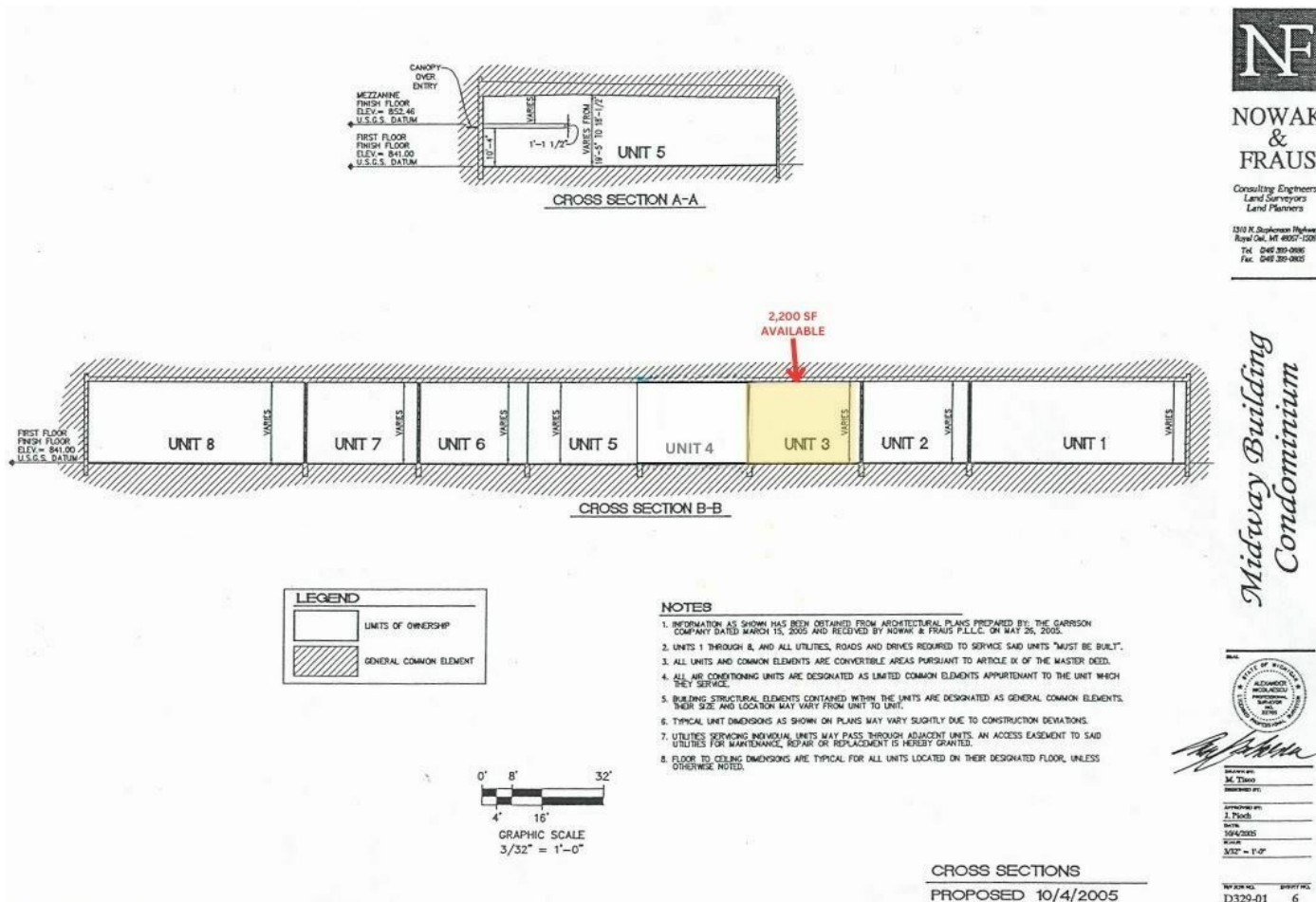

ADDITIONAL PHOTOS: 3909 Bestech Road | Pittsfield, MI 48197

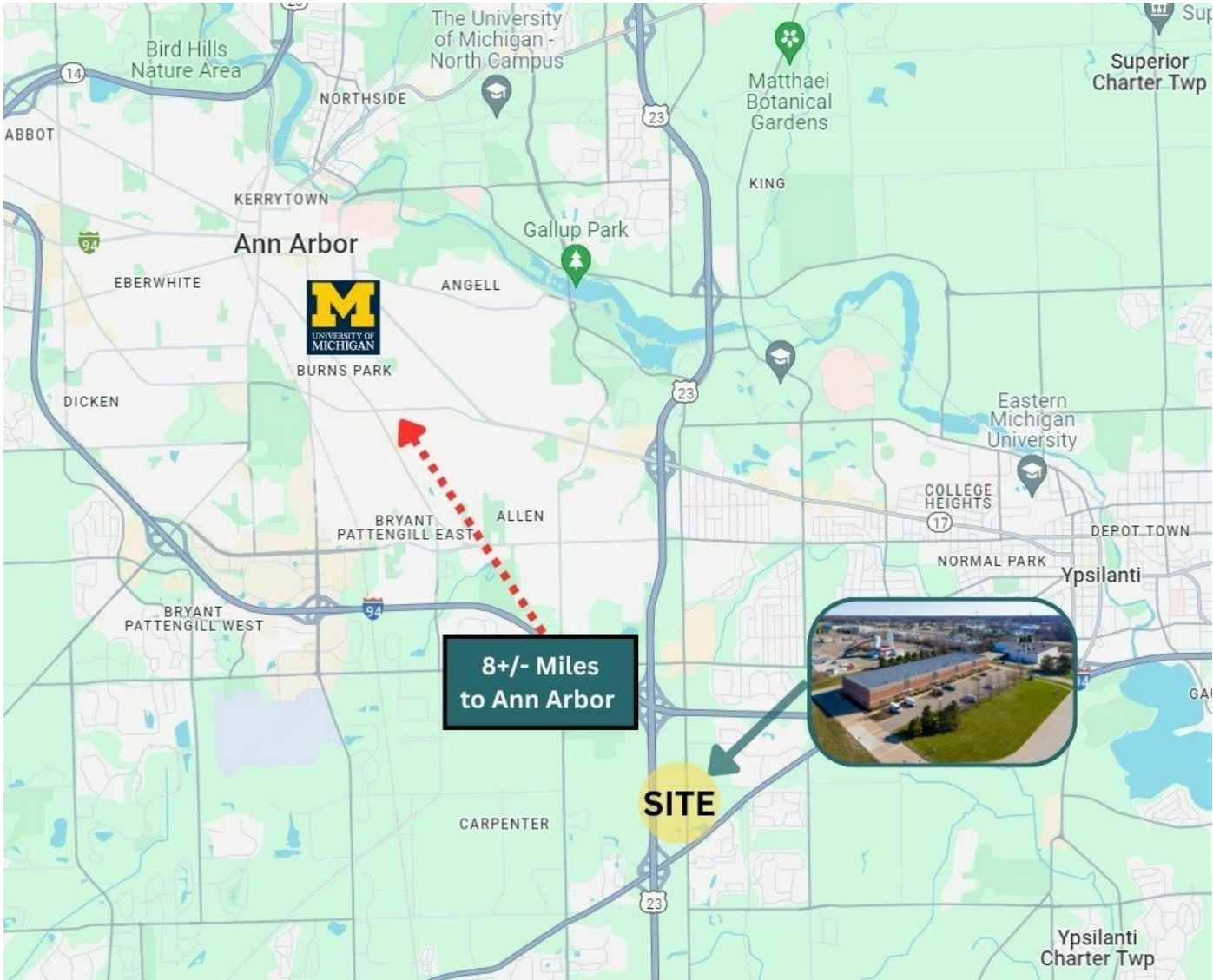

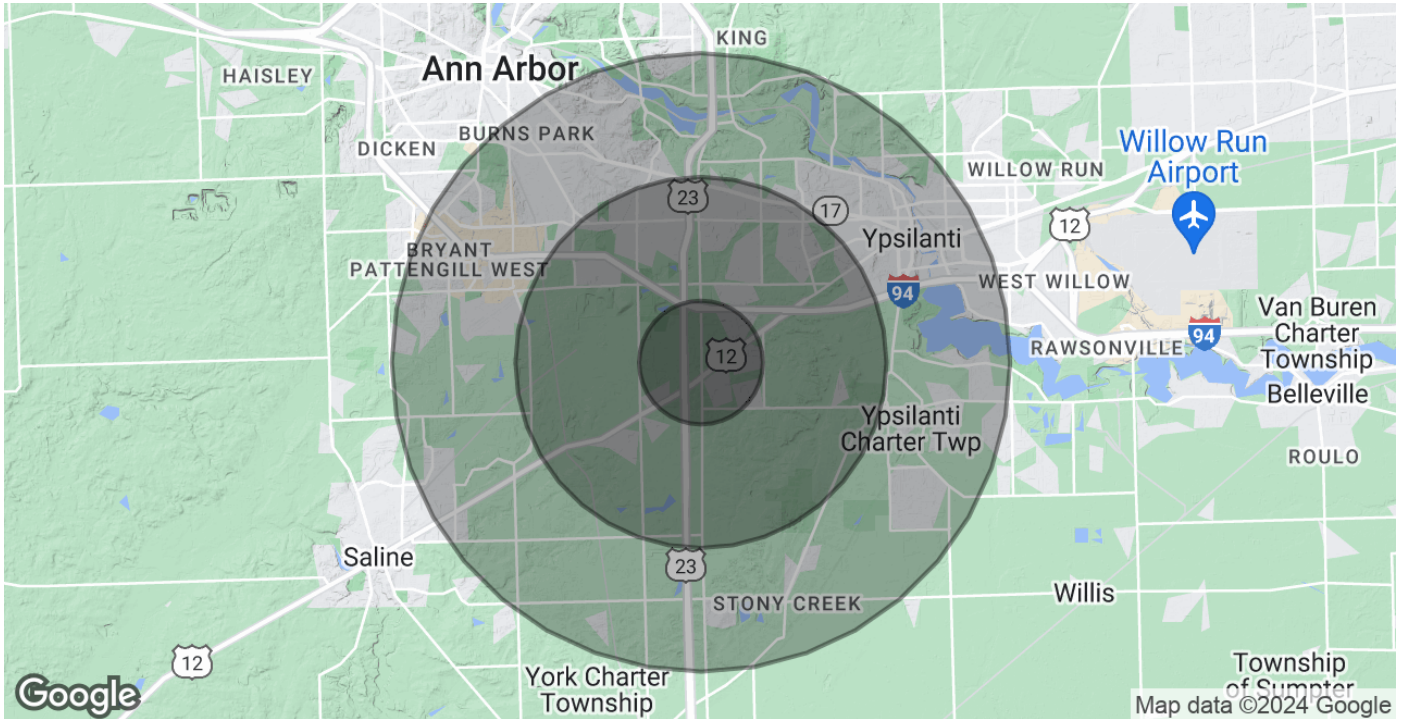
DEMOGRAPHICS MAP & REPORT: 3909 Bestech Road | Pittsfield, MI 48197

POPULATION	1 MILE	3 MILES	5 MILES
Total Population	5,721	45,105	136,936
Average Age	33.6	36.7	35.6
Average Age (Male)	32.6	34.2	34.3
Average Age (Female)	35.9	38.3	36.4
HOUSEHOLDS & INCOME	1 MILE	3 MILES	5 MILES
Total Households	2,501	19,550	57,748
# of Persons per HH	2.3	2.3	2.4
Average HH Income	\$92,123	\$77,818	\$91,531
Average House Value	\$258,900	\$189,975	\$232,407

* Demographic data derived from 2020 ACS - US Census