

BUILT SPACE + ROOFTOP OASIS

250
HUDSON

PARTIAL 7TH
6,106 RSF
JULY 2021

ENTIRE 6TH
27,761 RSF
NOVEMBER 2021

PARTIAL 3RD
8,218 RSF
MAY 2021

Bright, open space • 11'10" ceilings • Polished concrete floors
Iconic Hudson Square trophy building • Striking limestone & marble double height lobby
Expansive green roof with stunning Hudson River & city views
On-site bike storage • LEED Gold Certified • WiredScore Platinum

Located in dynamic Hudson Square – adjacent to Freeman Park Plaza
Hudson Street redevelopment underway with dedicated bike lanes • Convenient to 1, C & E trains

Adam S. Rappaport Managing Director
646.253.3111 / arappaport@resnicknyc.com

Brett S. Greenberg Executive Managing Director
646.253.3113 / bgreenberg@resnicknyc.com

250hudson.nyc



250 HUDSON



Adam S. Rappaport Managing Director
646.253.3111 / arappaport@resnicknyc.com

Brett S. Greenberg Executive Managing Director
646.253.3113 / bgreenberg@resnicknyc.com

250hudson.nyc



250 HUDSON



Adam S. Rappaport Managing Director
646.253.3111 / arappaport@resnicknyc.com

Brett S. Greenberg Executive Managing Director
646.253.3113 / bgreenberg@resnicknyc.com

250hudson.nyc





3rd Floor Test Fit | 8,218 RSF

DOMINICK STREET

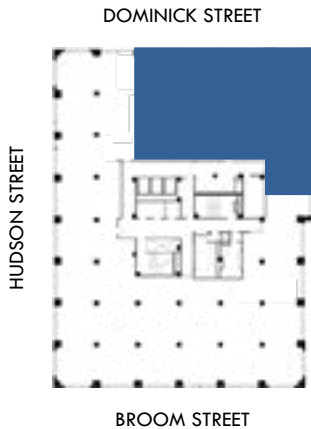
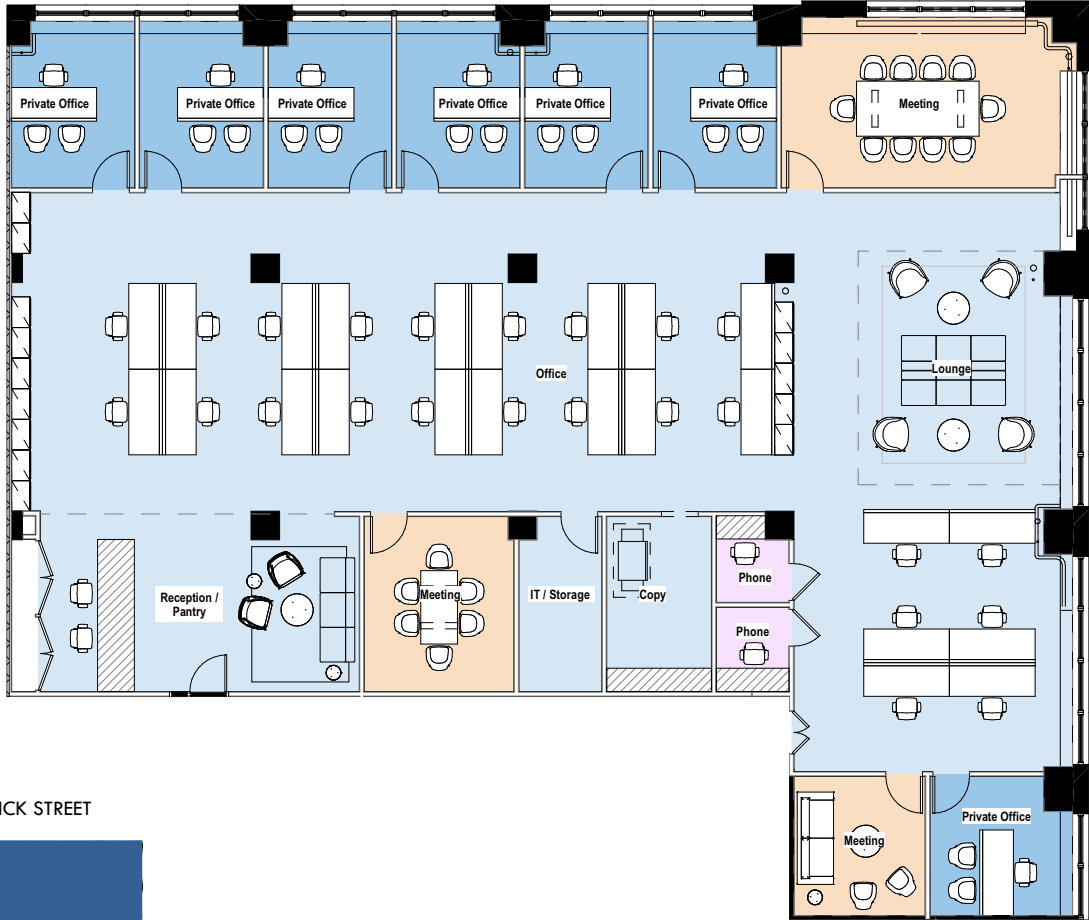

WORKSPACE

Workstations	24
Private Offices	7
Reception	1
TOTAL	32

MEET

Conference/Meeting Rooms	3
--------------------------	---

SOCIAL

Pantry	1
--------	---

Adam S. Rappaport Managing Director
646.253.3111 / arappaport@resnicknyc.com

Brett S. Greenberg Executive Managing Director
646.253.3113 / bgreenberg@resnicknyc.com

250hudson.nyc





6th Floor Test Fit | 27,761 RSF



WORKSPACE

Workstations	160
Private Offices	18
Reception	1
TOTAL	179

MEET

Conference/Meeting Rooms	4
--------------------------	---

SOCIAL

Pantry	1
Wellness Room	1
Phone Room	2

Adam S. Rappaport Managing Director
646.253.3111 / arappaport@resnicknyc.com

Brett S. Greenberg Executive Managing Director
646.253.3113 / bgreenberg@resnicknyc.com

250hudson.nyc





7th Floor Test Fit | 6,106 RSF

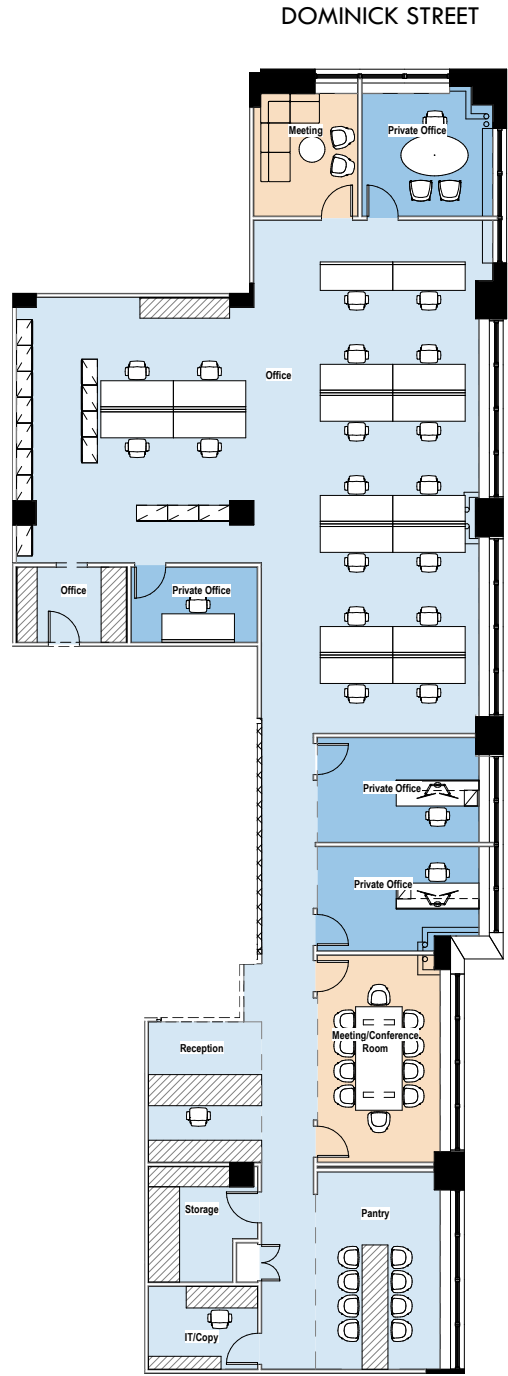
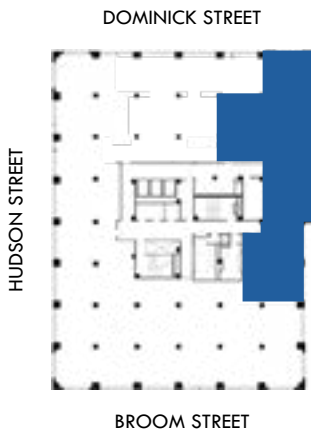

WORKSPACE

Workstations	18
Private Office	4
Reception	1
TOTAL	23

MEET

Conference/Meeting Rooms	2
--------------------------	---

SOCIAL

Pantry	1
--------	---

Adam S. Rappaport Managing Director
646.253.3111 / arappaport@resnicknyc.com

Brett S. Greenberg Executive Managing Director
646.253.3113 / bgreenberg@resnicknyc.com

250hudson.nyc

