

# QUEENS LOGISTICS CENTER

184-10/60 Jamaica Avenue, Jamaica, NY

FOR LEASE



## 75,000 SF OF GROUND FLOOR WAREHOUSE SPACE AVAILABLE

ASKING RENT: **\$19.99 MG**

**Frank Liggio** / [frank.liggio@cushwake.com](mailto:frank.liggio@cushwake.com) / 718 512 2611

**Joshua Kleinberg** / [joshua.kleinberg@cushwake.com](mailto:joshua.kleinberg@cushwake.com) / 718 512 2612



©2020 Cushman & Wakefield. All rights reserved. The information contained in this communication is strictly confidential. This information has been obtained from sources believed to be reliable but has not been verified. NO WARRANTY OR REPRESENTATION, EXPRESS OR IMPLIED, IS MADE AS TO THE CONDITION OF THE PROPERTY (OR PROPERTIES) REFERENCED HEREIN OR AS TO THE ACCURACY OR COMPLETENESS OF THE INFORMATION CONTAINED HEREIN, AND SAME IS SUBMITTED SUBJECT TO ERRORS, OMISSIONS, CHANGE OF PRICE, RENTAL OR OTHER CONDITIONS, WITHDRAWAL WITHOUT NOTICE, AND TO ANY SPECIAL LISTING CONDITIONS IMPOSED BY THE PROPERTY OWNER(S). ANY PROJECTIONS, OPINIONS OR ESTIMATES ARE SUBJECT TO UNCERTAINTY AND DO NOT SIGNIFY CURRENT OR FUTURE PROPERTY PERFORMANCE.



# QUEENS LOGISTICS CENTER

184-10/60 Jamaica Avenue, Jamaica, NY



## COMMENTS:

- 20' ceiling height
- 24' wide column spans
- Private loading dock
- Parking available
- Reinforced concrete fireproof construction
- Fully sprinklered
- Possible economic incentives... REAP, CEP, ESCP





# QUEENS LOGISTICS CENTER

184-10/60 Jamaica Avenue, Jamaica, NY



## LOCATION

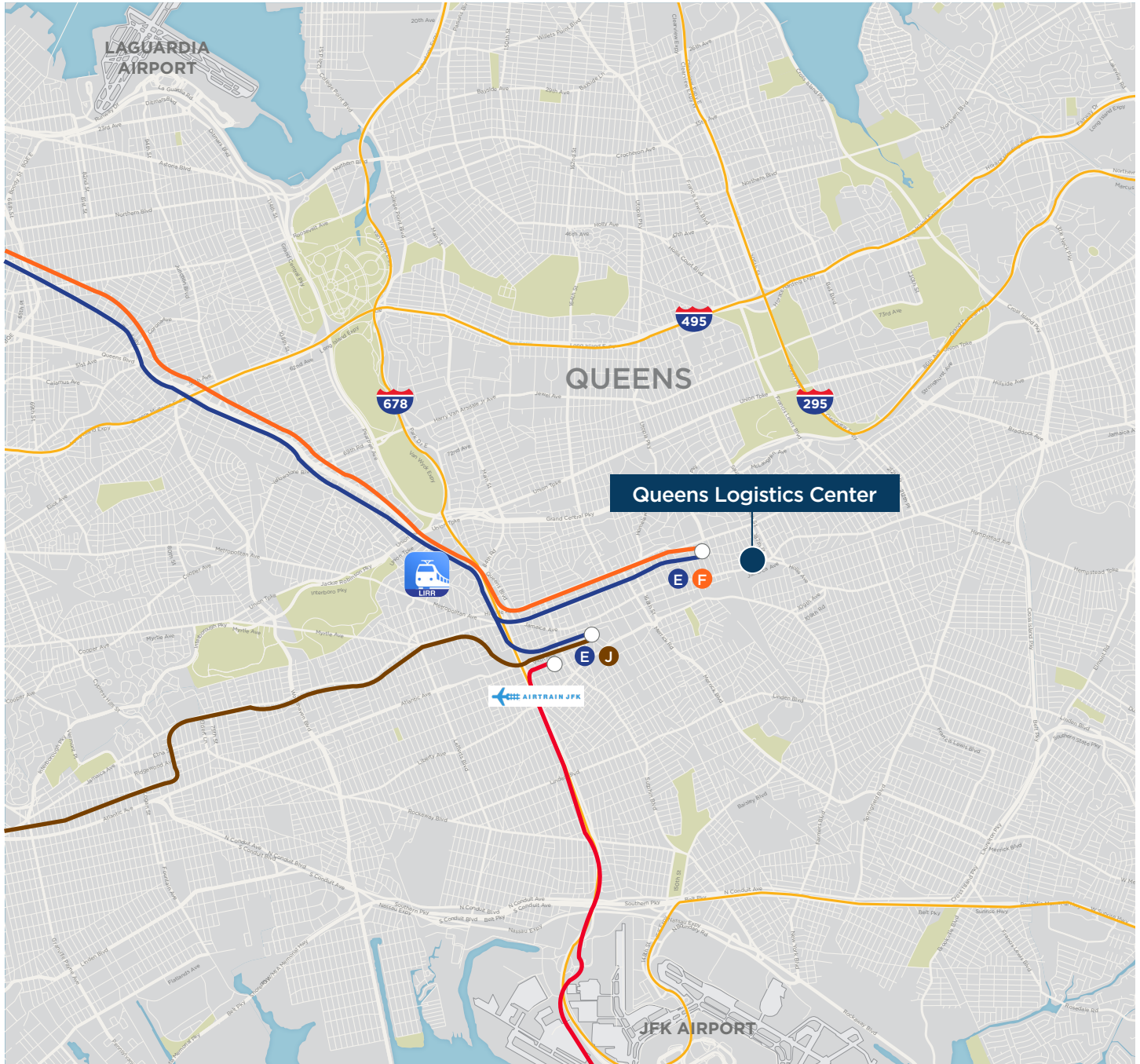

## Strategic Location...Ideal for Last-Mile Distribution

- .5 miles from LIRR
- .7 Miles from F Strain
- 1.9 Miles from Jamaica Station E, J, Z, LIRR, Air Train to JFK
- 5.4 Miles from JFK Airport
- 8.3 Miles from Lagsuardia Airport
- 14.3 Miles from Midtown Manhattan
- .5 Miles from Clearview Expressway

# QUEENS LOGISTICS CENTER

184-10/60 Jamaica Avenue, Jamaica, NY



## FLOOR PLAN

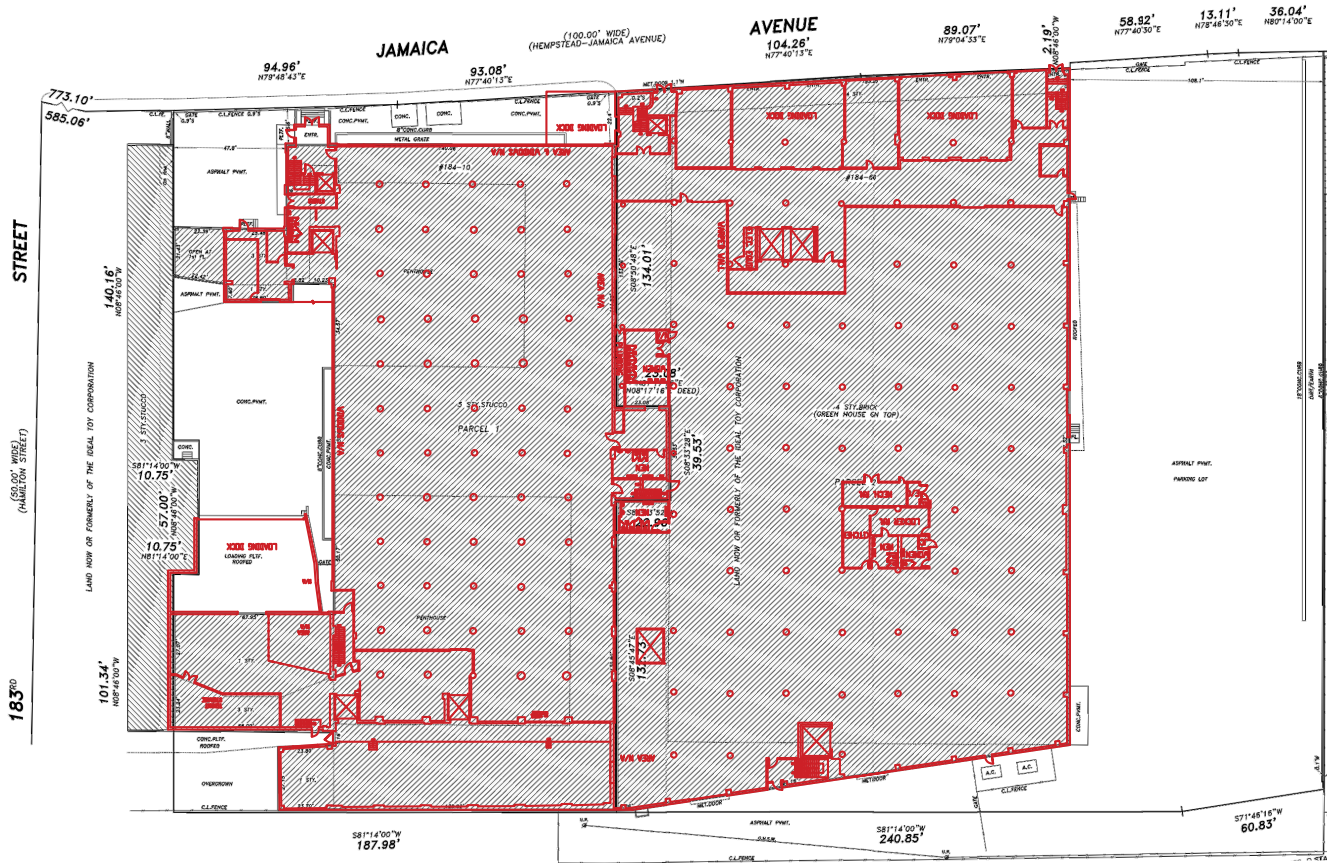

## LEASE PREMISES

