



**CUSHMAN &
WAKEFIELD**
Commerce

FOR LEASE

438 West 12300 South
Draper, Utah



Lease Rate: \$12.60 NNN

Property Highlights

- Total size: 14,733 SF (can be reduced to 11,050 SF)
 - Office: 415 SF
 - Showroom: 9,515 SF
 - Warehouse: 4,903 SF
- (4) 12' x 12' ground level overhead doors
- 16' clear ceiling height
- 3 phase power
- Very clean, wide open showroom
- HVAC throughout
- Fire sprinkled
- Excellent location right off I-15



Bob Mills
Executive Director
+1 801 303 5551
bmills@comre.com

170 South Main Street Suite 1600
Salt Lake City, UT 84101
Main +1 801 322 2000
Fax +1 801 322 2040
comre.com

Independently Owned and Operated / A Member of the Cushman & Wakefield Alliance

Cushman & Wakefield Copyright 2017. No warranty or representation, express or implied, is made to the accuracy or completeness of the information contained herein, and same is submitted subject to errors, omissions, change of price, rental or other conditions, withdrawal without notice, and to any special listing conditions imposed by the property owner(s). As applicable, we make no representation as to the condition of the property (or properties) in question.
(path: G:\1 - Projects\Mills, B\1 - Flyers\438w12300s)



**CUSHMAN &
WAKEFIELD**
Commerce

FOR LEASE

438 West 12300 South
Draper, Utah

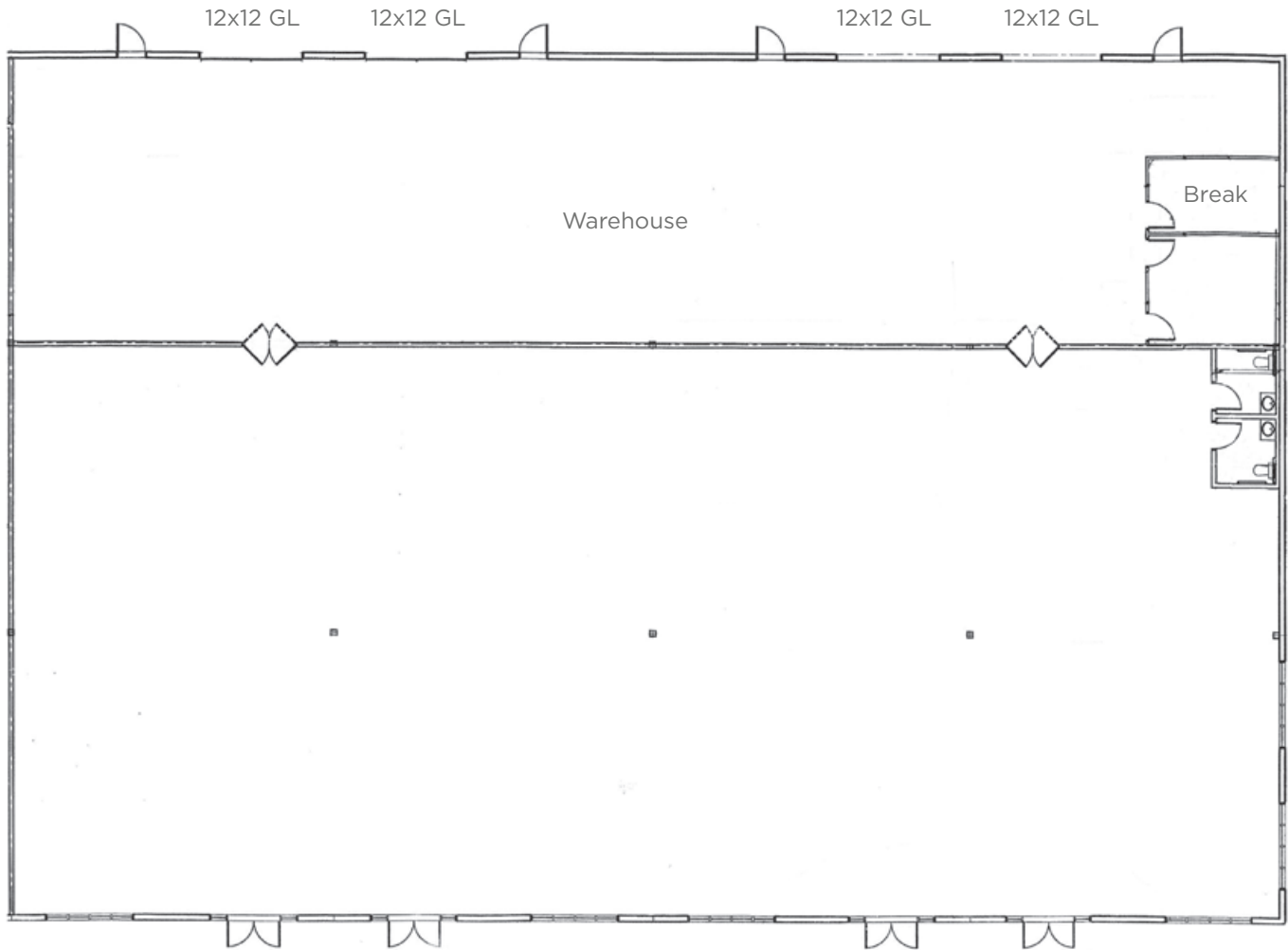

12300 South

Bob Mills
Executive Director
+1 801 303 5551
bmills@comre.com

170 South Main Street Suite 1600
Salt Lake City, UT 84101
Main +1 801 322 2000
Fax +1 801 322 2040
comre.com

Independently Owned and Operated / A Member of the Cushman & Wakefield Alliance

Cushman & Wakefield Copyright 2017. No warranty or representation, express or implied, is made to the accuracy or completeness of the information contained herein, and same is submitted subject to errors, omissions, change of price, rental or other conditions, withdrawal without notice, and to any special listing conditions imposed by the property owner(s). As applicable, we make no representation as to the condition of the property (or properties) in question.
(path: G:\1 - Projects\Mills, B\1 - Flyers\438w12300s)