

HWY 71, BASTROP, TX 78602

# BASTROP MEDICAL

## AT THE GROVE

MEDICAL / OFFICE / RETAIL | LEASE



### LEASING INFORMATION

TYLER DUTTON

512.441.1062

TYLER@KPGCOMMERCIAL.COM

# BASTROP MEDICAL

MEDICAL / OFFICE / RETAIL | LEASE

HWY 71, BASTROP, TEXAS 78602

## ✓ AVAILABILITY

+/- 2,168 SF

## 💰 LEASE TERMS

RATE: \$30/RSF + NNN

TI: \$35/RSF

TERM: 5-10 year

PROPERTY INFORMATION

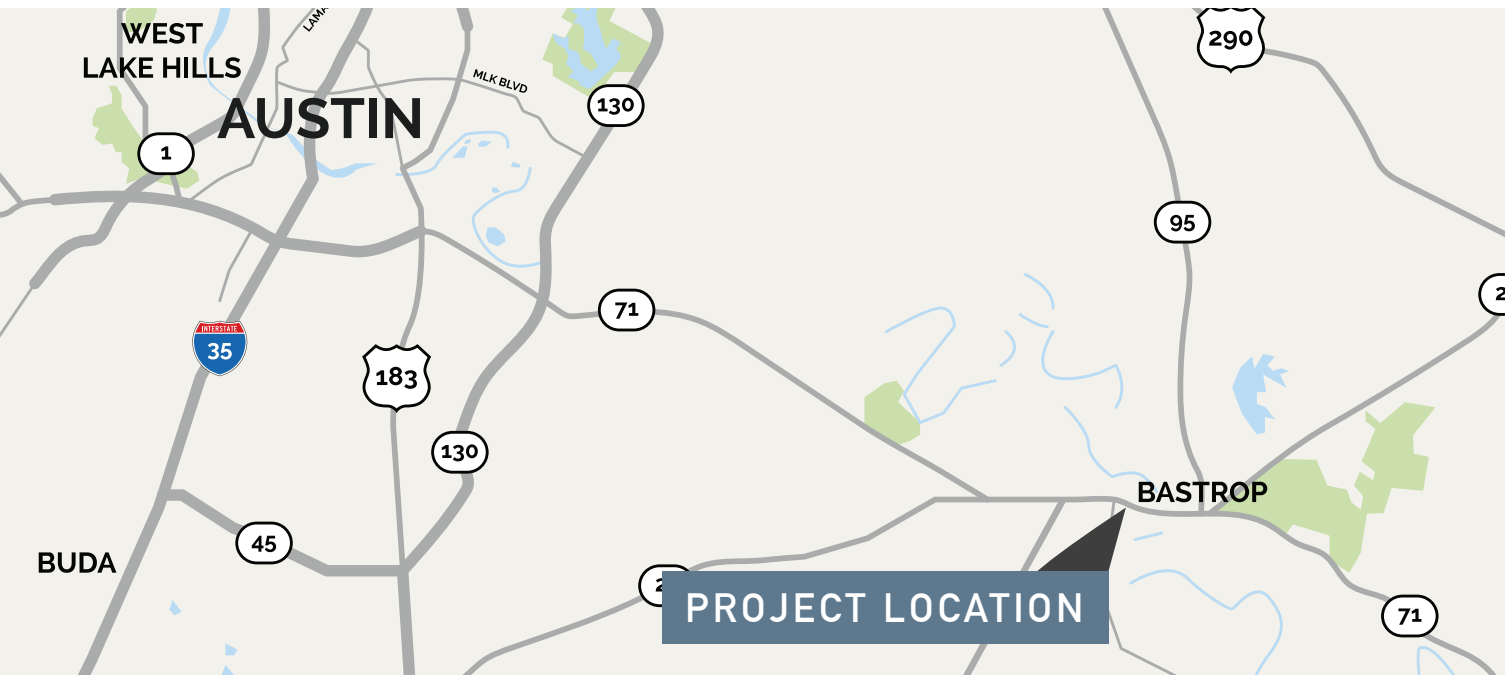

## ★ FEATURES

### LOCATION

- High Visibility on HWY 71
- In front of Ascension Seton Hospital
- Easy access from Hwy 71 frontage Road

### BUILDING

- Anchored by Austin Regional Clinic
- Deliver Date - Q3 2020
- Parking Ratio - 1:250 square feet

### DEMOGRAPHICS

(5-MILE, CoStar 2019)

- Population- 17,228
- Med Household Income - \$54,975
- Household Growth  
2019-2024 - 12.75%



### LEASING INFORMATION

TYLER DUTTON

512.441.1062

tyler@kpgcommercial.com

# BASTROP MEDICAL

MEDICAL / OFFICE / RETAIL | LEASE  
HWY 71, BASTROP, TEXAS 78602

AVAILABLE  
+/- 2,168 SF

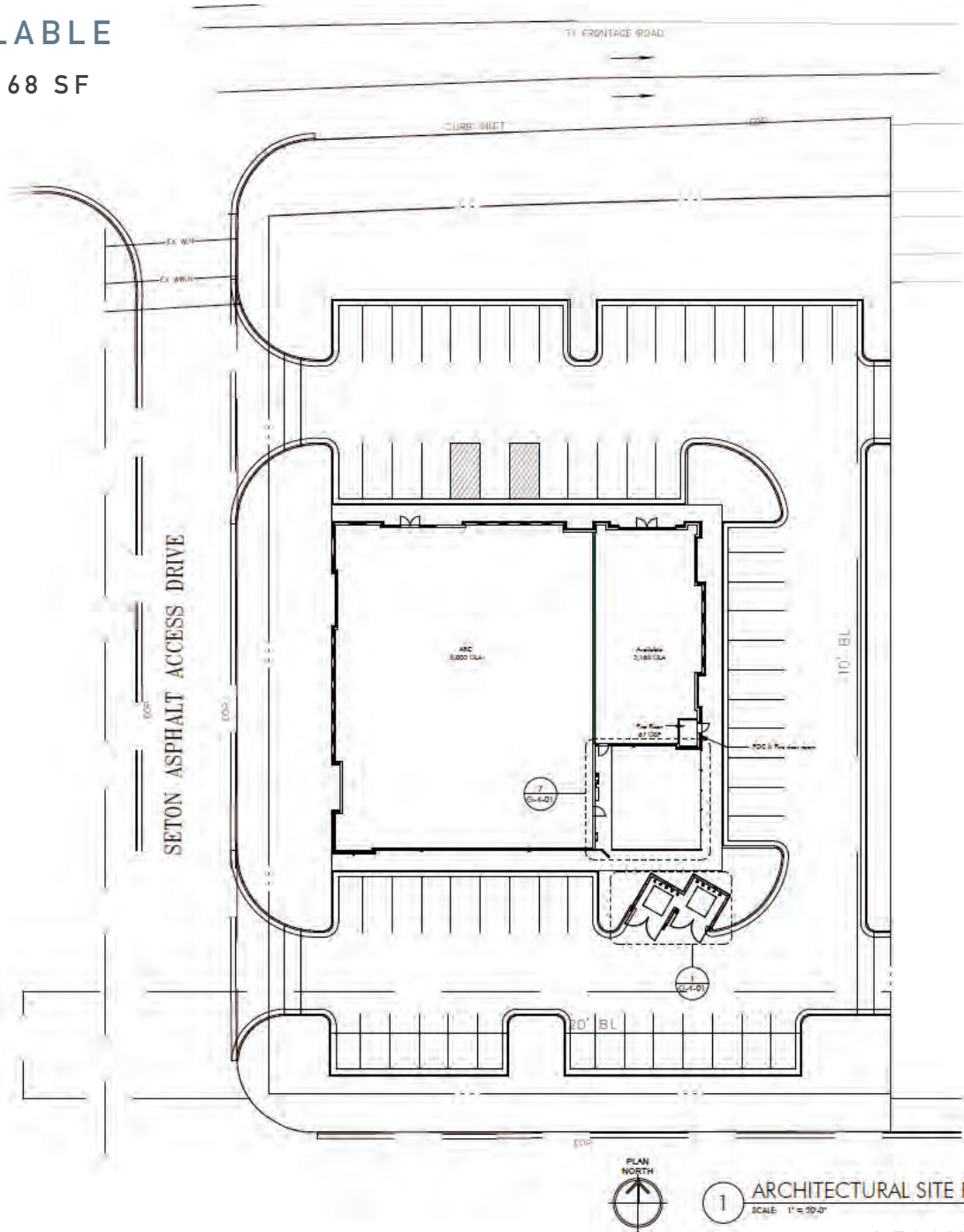

SITE PLAN



## LEASING INFORMATION

TYLER DUTTON  
512.441.1062  
tyler@kpgcommercial.com



# BASTROP MEDICAL

MEDICAL / OFFICE / RETAIL | LEASE

HWY 71, BASTROP, TEXAS 78602

AREA MAP

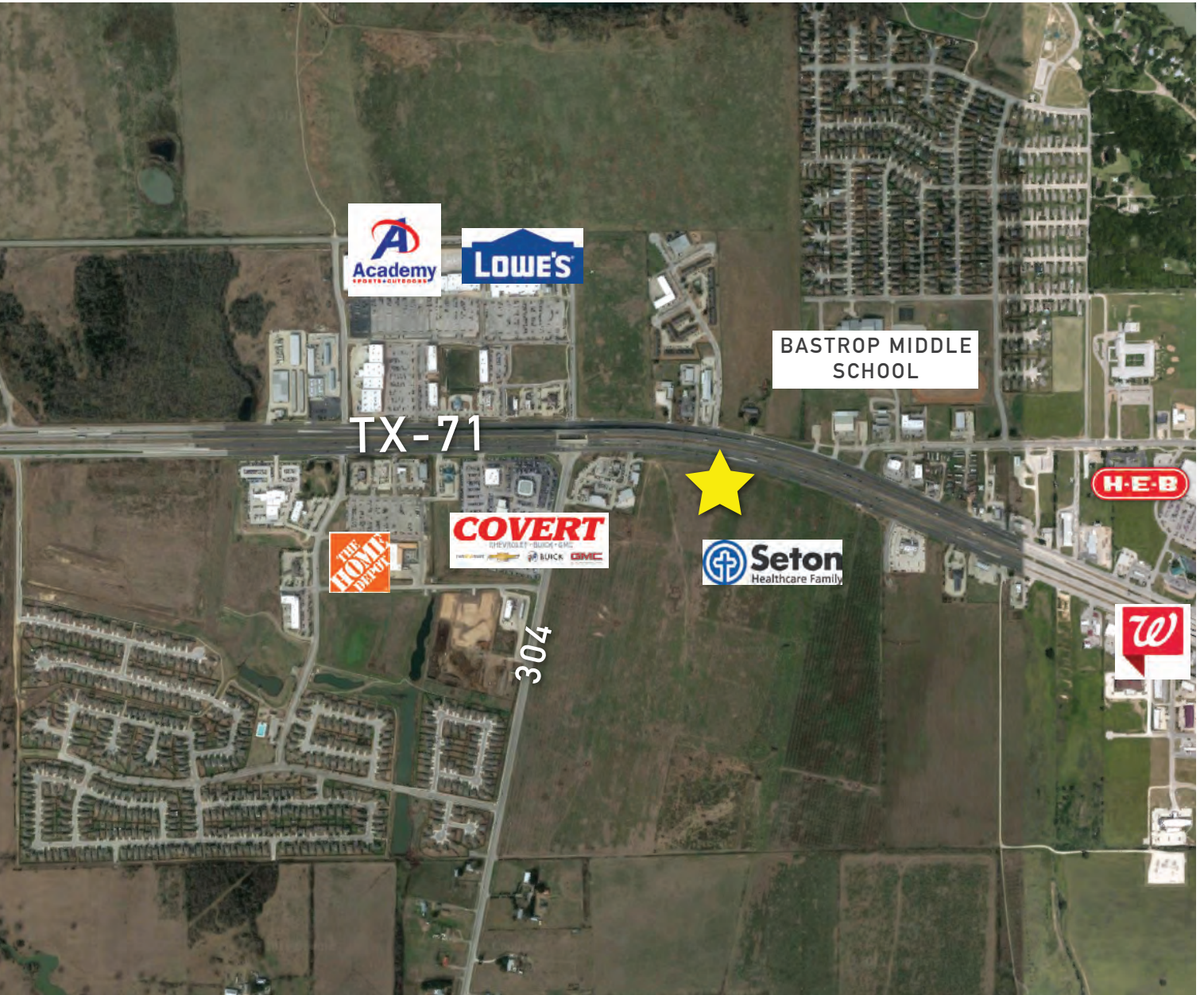

## LEASING INFORMATION

TYLER DUTTON

512.441.1062

tyler@kpgcommercial.com



# BASTROP MEDICAL

MEDICAL / OFFICE / RETAIL | LEASE

HWY 71, BASTROP, TEXAS 78602



PROJECT PHOTOS



## LEASING INFORMATION

TYLER DUTTON

512.441.1062

[tyler@kpgcommercial.com](mailto:tyler@kpgcommercial.com)

The information contained in this offering material ("Summary") is confidential, furnished solely for the purpose of the review by a prospective interested parties of the Property and is not to be used for any other purpose or made available to any other person without the express written consent of KPG Commercial. The material is based in part upon information supplied by the owner of the Property ("Owner") and in part upon information obtained by KPG Commercial from sources it deems reliable. Summaries of any documents are not intended to be comprehensive or all inclusive but rather only outlines of some of the provisions contained herein or as to engineering or environmental matters. Prospective interested parties should make their own projections and conclusions without reliance upon the material contained herein and conduct their own independent due diligence, including engineering and environmental inspections, to determine the condition of the property and the existence of any potentially hazardous material used in the construction or maintenance of the building or located on site.