



JSH | PROPERTIES, INC.

MILL CREEK PLAZA

BOTHELL-EVERETT HWY & 164TH STREET SE | MILL CREEK, WA 98012



RETAIL SPACE FOR LEASE

STEVE OLSEN | 425.455.0500 | STEVED@JSHPROPERTIES.COM





Property Highlights

- Rare opportunity in highly desirable Mill Creek market.
- Grocery and Drug Store anchored center.
- Trade area base is affluent and favorably influenced by Microsoft and tech companies.
- Center features strong line-up of tenants including Albertson's, Staples, Rite Aid, McDonalds, Mod Pizza, Wells Fargo and Key Bank.
- Excellent neighborhood center with great visibility.



BOTHELL-EVERETT HWY & 164TH STREET SE | MILL CREEK, WA 98012

**NNN= \$6.71 PSF/YR
(including water and sewer)**

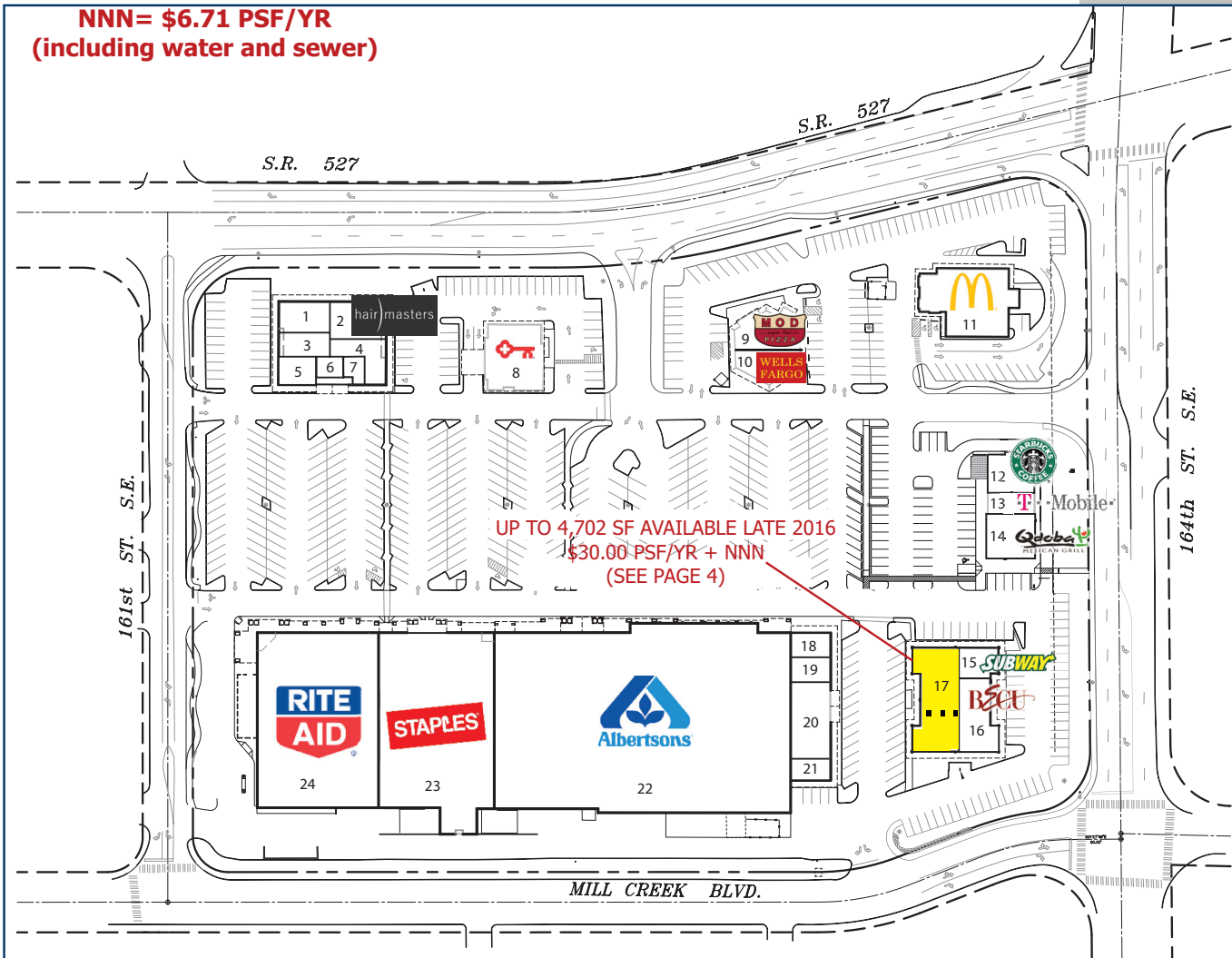

| TENANT | |
|-----------|----------------------------|
| 1 | BMG Thai |
| 2 | Hair Masters |
| 3 | Mill Creek Chiropractic |
| 4 | Skinny D's Yogurt |
| 5 | Pony Mailbox & Business |
| 6 | Toshi's |
| 7 | Greek Pita |
| 8 | Key Bank |
| 9 | Mod Pizza |
| 10 | Wells Fargo |
| 11 | McDonald's |
| 12 | Starbucks |
| 13 | T Mobile |
| 14 | Qdoba |
| 15 | Subway |
| 16 | BECU |
| 17 | Available Late 2016 |
| 18 | Mill Creek Jewelers |
| 19 | Nail Palace |
| 20 | Mill Creek Dentists |
| 21 | Tobacco Town |
| 22 | Albertson's |
| 23 | Staples |
| 24 | Rite Aid |



4,702 SF AVAILABLE APPROXIMATELY LATE 2016 AS NOTED.

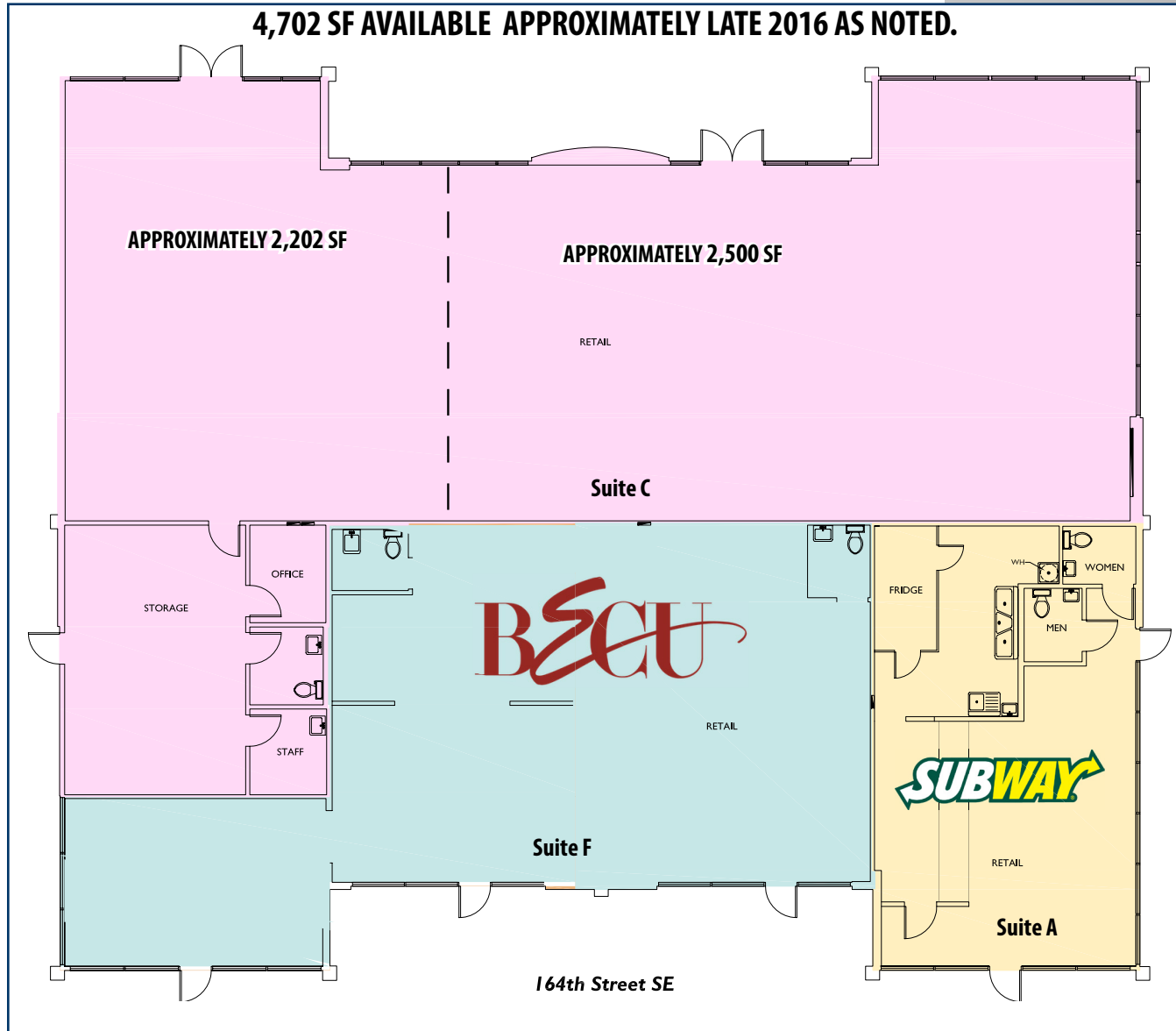

BOTHELL-EVERETT HWY & 164TH STREET SE | MILL CREEK, WA 98012



BOTHELL-EVERETT HWY & 164TH STREET SE | MILL CREEK, WA 98012

