



Retail Condos For Sale

Address 19230 Town Green Dr. Leesburg, VA

Square Feet 13,000 (divisible)

Sale Price \$525 PSF End Cap & \$490 PSF In-line

Year Built 2017

Zoning PDTC

HIGHLIGHTS

- ▶ Located within Lansdowne Town Center, a unique lifestyle shopping center featuring over 35 sensational restaurants, services, specialty stores and apartment complexes. **
- ▶ Well-established tenant mix including Panera, Starbucks, CVS, Harris Teeter, Sugar Shack Donuts, Ford's Fish Oyster Bar and Chick-fil-a will be coming soon (drive-thru).
- ▶ 8 Retail / Commercial Condos (Unit A - G)
- ▶ Delivered in cold dark shell
- ▶ Ample surface and street parking nearby
- ▶ Ready for immediate occupancy

DEMOGRAPHICS (3 Mile Radius)

- ▶ Population: 65,781
- ▶ Households: 22,240
- ▶ Median HH Income: \$140,780
- ▶ Daytime Employees: 24,342
- ▶ Walk Score: 71 (very walkable)

<http://www.shoplansdownetowncenter.com/>**



FLOOR PLAN: UNITS A-G

Erik Ulsaker
703.861.0373
eu@lnf.com

Matthew Garcia
703.873.5760
mgarcia@lnf.com

Deen Zamani
202.258.8808
dzamani@gmail.com

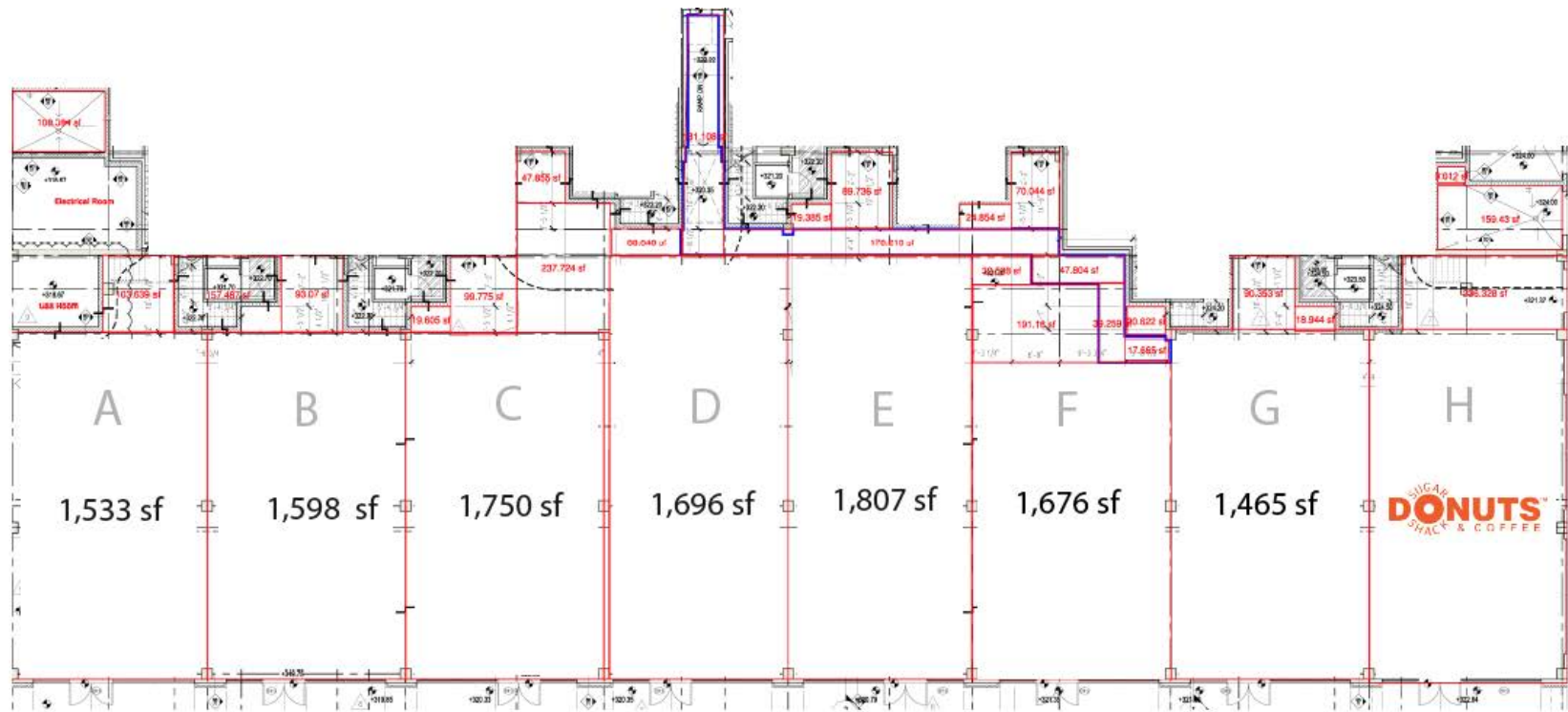

CLOSE-UP AERIAL





Lansdowne Development
5,000+ Residential Units

Belmont Ridge Rd

River Pkwy

Harry Byrd Hwy - 84,000 VPD

CVS

Harris Teeter

HARRIS CLEANERS

7

