

AVAILABLE FOR SALE  
956 DONATA COURT  
LAKE ZURICH, ILLINOIS 60047

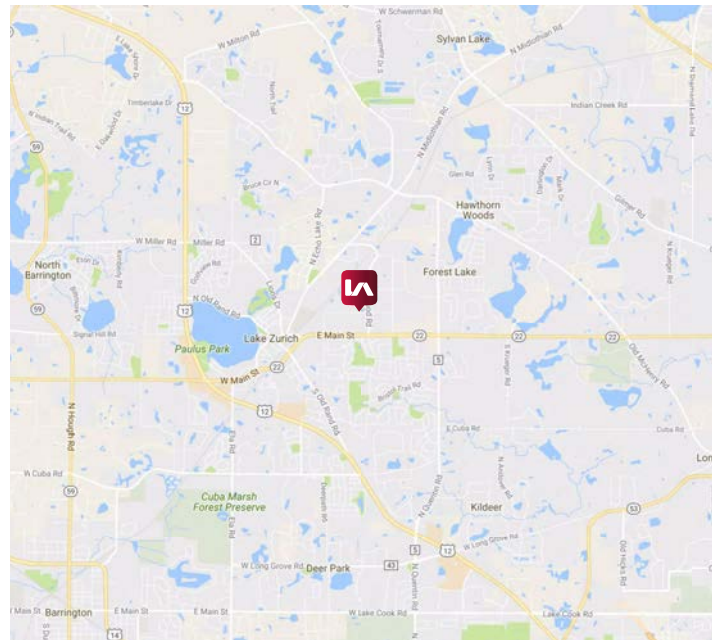

**BUILDING SPECIFICATIONS:**

<b>UNIT SIZE:</b>	6,980 SF
<b>CLEAR HEIGHT:</b>	24'
<b>LOADING:</b>	› One (1) Private Dock › One (1) Drive-in Door
<b>SPRINKLER:</b>	Fully
<b>PARKING:</b>	12 Spaces
<b>POWER:</b>	200 Amps / 480 Volts
<b>ASKING PRICE:</b>	\$599,000
<b>COMMENTS:</b>	› Newer Construction › Private Entrance › Build to Suit Office Build-out › Custom Design & Build Interiors › Lake County Real Estate Taxes › Own for Less than the Cost of Leasing › Additional Unit Next Door to Create 13,960 SF of Space



**Rick Anesi**  
Vice President  
ranesi@lee-associates.com  
D 773.355.3043

All information furnished regarding property for sale, rental or financing is from sources deemed reliable, but no warranty or representation is made to the accuracy thereof and same is submitted to errors, omissions, change of price, rental or other conditions prior to sale, lease or financing or withdrawal without notice. No liability of any kind is to be imposed on the broker herein.

AVAILABLE FOR SALE  
956 DONATA COURT  
LAKE ZURICH, ILLINOIS 60047

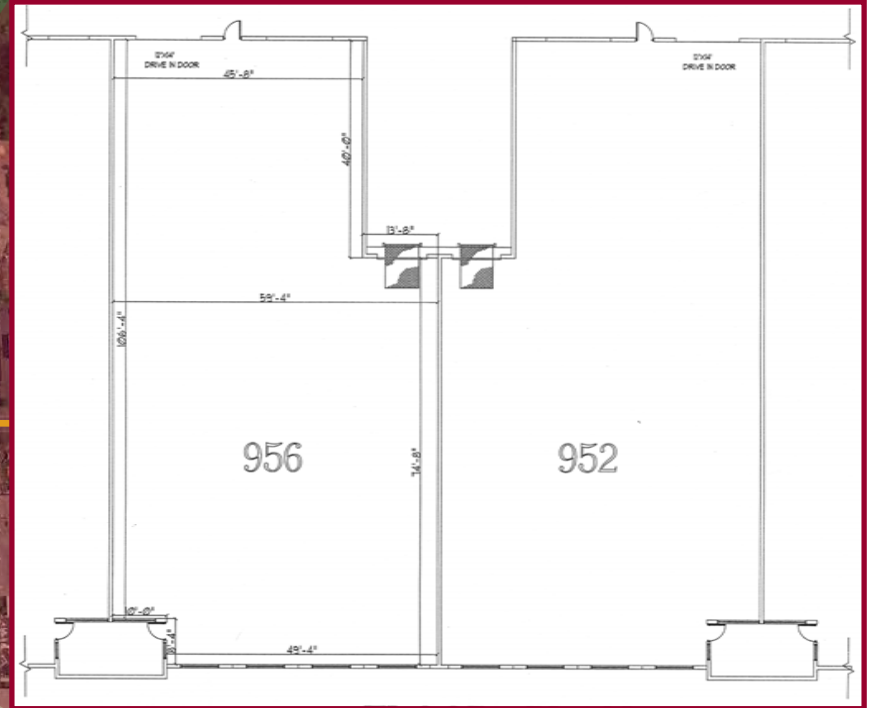

**IDEAL FOR:**

- › Light Manufacturing
- › Storage
- › Graphics Companies
- › Computer Companies
- › Lab / Tech Companies

**Rick Anesi**  
Vice President  
ranesi@lee-associates.com  
D 773.355.3043

All information furnished regarding property for sale, rental or financing is from sources deemed reliable, but no warranty or representation is made to the accuracy thereof and same is submitted to errors, omissions, change of price, rental or other conditions prior to sale, lease or financing or withdrawal without notice. No liability of any kind is to be imposed on the broker herein.