



**CUSHMAN &
WAKEFIELD**
Commerce

FOR LEASE

2987 West Parkway Blvd

West Valley City, Utah 84119

HIGH IMAGE OFFICE/WAREHOUSE



Lease Rate: \$.55, NNN

Property Highlights

- Total Size: 7,272 SF
- Office: 560 SF
- Warehouse: 6,712 SF
- Ceiling Height: 24' Clear
- Doors: (1) 8' x 9' Dock High Doors
(1) 12' x 14' Ground Level Doors
- Power: 3 Phase
- Zoning: M
- Fire Sprinklered
- Great access to 21st south freeway



Bob Mills

Executive Director
+1 801 303 5551
bmills@comre.com

170 South Main Street
Suite 1600
Salt Lake City, UT 84101
Main +1 801 322 2000
Fax +1 801 322 2040
comre.com

Independently Owned and Operated / A Member of the Cushman & Wakefield Alliance

Cushman & Wakefield Copyright 2016. No warranty or representation, express or implied, is made to the accuracy or completeness of the information contained herein, and same is submitted subject to errors, omissions, change of price, rental or other conditions, withdrawal without notice, and to any special listing conditions imposed by the property owner(s). As applicable, we make no representation as to the condition of the property (or properties) in question.
(path: G:\1 - Projects\Mills, B\1 - Flyers\2963-2987WestParkwayBlvd)



**CUSHMAN &
WAKEFIELD**
Commerce

FOR LEASE

2987 West Parkway Blvd
West Valley City, Utah 84119

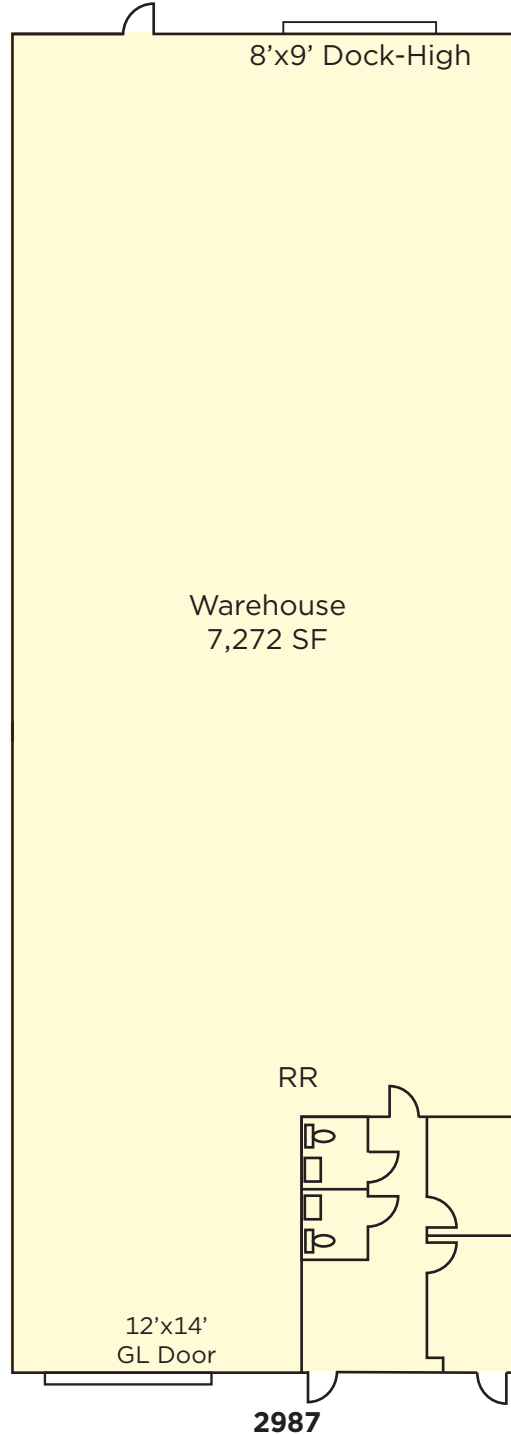

Bob Mills
Executive Director
+1 801 303 5551
bmills@comre.com

170 South Main Street
Suite 1600
Salt Lake City, UT 84101
Main +1 801 322 2000
Fax +1 801 322 2040
comre.com

Independently Owned and Operated / A Member of the Cushman & Wakefield Alliance

Cushman & Wakefield Copyright 2016. No warranty or representation, express or implied, is made to the accuracy or completeness of the information contained herein, and same is submitted subject to errors, omissions, change of price, rental or other conditions, withdrawal without notice, and to any special listing conditions imposed by the property owner(s). As applicable, we make no representation as to the condition of the property (or properties) in question.
(path: G:\1 - Projects\Mills, B\1 - Flyers\2963-2987WestParkwayBlvd)