

# BEST CORNER

## JAMAICA AVE @ 162<sup>nd</sup> STREET

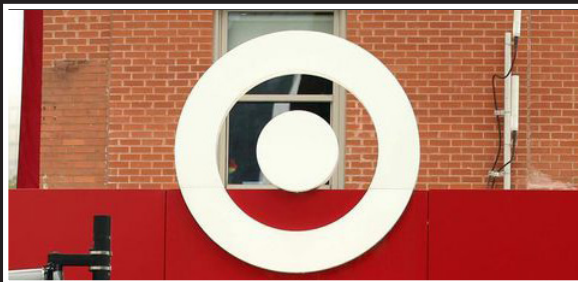

### APPROXIMATE SIZE:

4,200 sq. ft. - Ground Floor  
4,200 sq. ft. - Basement

### FRONTAGE:

Over 75' of wrap-around

### POSSESSION:

Immediate

### COMMENTS:

- Heavy foot traffic
- Situated in the heart of the Jamaica Queens development boom; Over 2,600 residential units currently under construction
- Located on the #1 retail corridor in Queens
- Highly visible corner
- Steps away from bus and subway stops and accessible to the LIRR and Airtrain

### NEIGHBORING TENANTS:



### MASS TRANSPORTATION:

Jamaica Center - Parsons/Archer (E,J,Z)  
12,622,977 annual riders



#### NEARBY BUS LINES:

Q24, Q30, Q31, Q54, Q56, Q110 - 13,500,992 combined total annual bus ridership  
Q4, Q5, Q42, Q83, Q84, n4, n4x - 11,438,777 combined total annual bus ridership





YORK COLLEGE  
The City University of New York



SOCIAL SECURITY OFFICE

Parsons Blvd

GoldenKrust SUBWAY DUNKIN' DONUTS POPCORN SHOWCASE CINEMAS OLD NAVY JAMAICA CENTER Walgreens



Jamaica Ctr | Parsons/ Archer Station (E,J,Z)  
12,622,977 annual riders

160th Street



YORK COLLEGE  
The City University of New York

Total Enrollement:  
7,821 students

CHIPOTLE PANDA EXPRESS CHINESE KITCHEN Burlington H&M TARGET Jamaica Arts Center CHASE

JAMAICA AVENUE

TACO BELL PIZZA HUT America's Favorite Pizza fabCO shoes Sprint

161st Street

S.O.S UNIQUE



KICKSUSA B&W BEAUTY 161-21 Jamaica Ave

162nd Street



PORTABELLA

SUPER M&M BEAUTY SUPPLY

LENS LAB EXPRESS



metroPCS Payless SHOESOURCE YOUNG WORLD CITYMD NEW YORK'S URGENT CARE SHOPPERS WORLD

JAMAICA AVENUE

163rd Street

fabCO shoes ZALES J&J JIMMY JAZZ Danice DR Jays

164th Street

ARCHER AVENUE



YORK COLLEGE  
The City University of New York

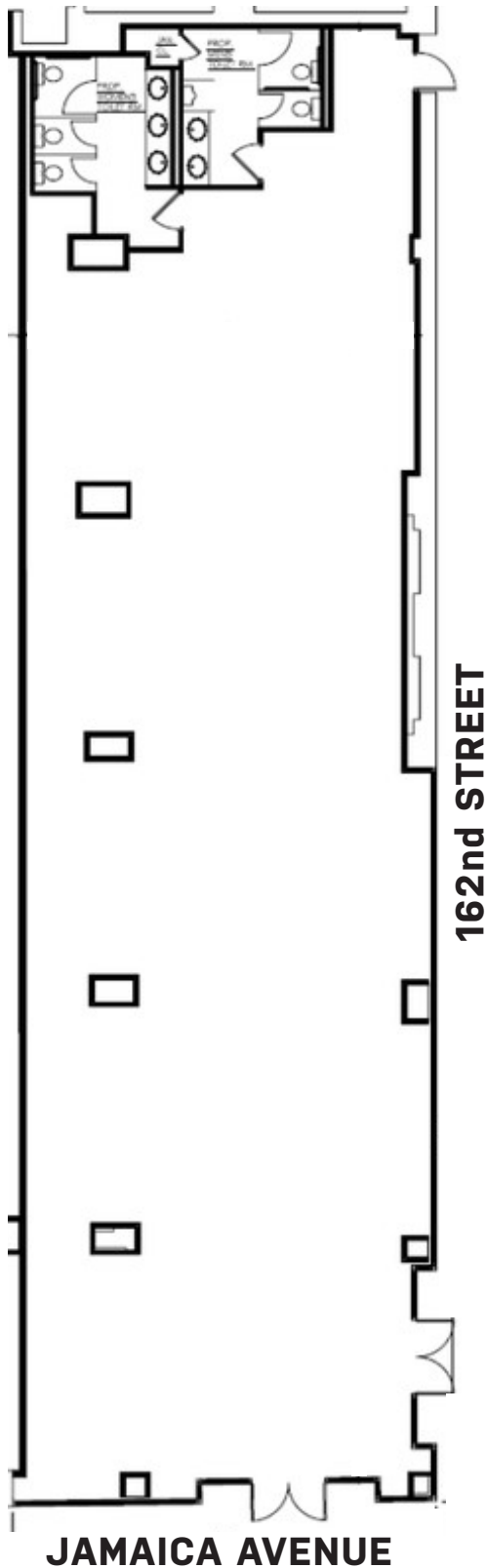

## CONTACT EXCLUSIVE AGENTS

**Cory G. Zelnik**  
cory@zelnikco.com

**Zelnik & Company LLC**  
(212) 223-2200

**Sean Philipps**  
sean@zelnikco.com