

5980

HORTON STREET
EMERYVILLE

For Lease - Ground Floor Class A Office Space

SUITE 100 | ±3,358 SQUARE FEET

- Part of the vibrant, expansive Wareham campus
- Main entrance off atrium lobby and second entry at exterior courtyard
- Convenient commute options including Emery-Go-Round shuttle to BART and around Emeryville, buses, and extensive campus parking
- Close to Amtrak and Capitol Corridor Route from Sacramento to San Jose
- Open plan creative space with high ceilings
- Onsite cafe, fitness center and shared conference center
- Highly-experienced institutional ownership with onsite property management
- Walking distances to abundant restaurants, cafes, and tenant-friendly amenities
- Operable windows, garden atrium and lush outdoor organic gardens
- Monthly campus speaker series

AVAILABLE: Now

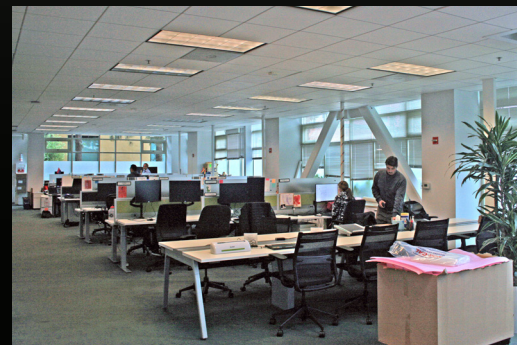

NEWMARK

Jonathan Tomasco 510.923.6262 jtomasco@ngkf.com CA RE License #01224562

1111 Broadway, Suite 100, Oakland, CA 94607

nmrk.com

The distributor of this communication is performing acts for which a real estate license is required. The information contained herein has been obtained from sources deemed reliable but has not been verified and no guarantee, warranty or representation, either express or implied, is made with respect to such information. Terms of sale or lease and availability are subject to change or withdrawal without notice.



5980

HORTON STREET
EMERYVILLE

Suite 100 | ±3,358 Square Feet

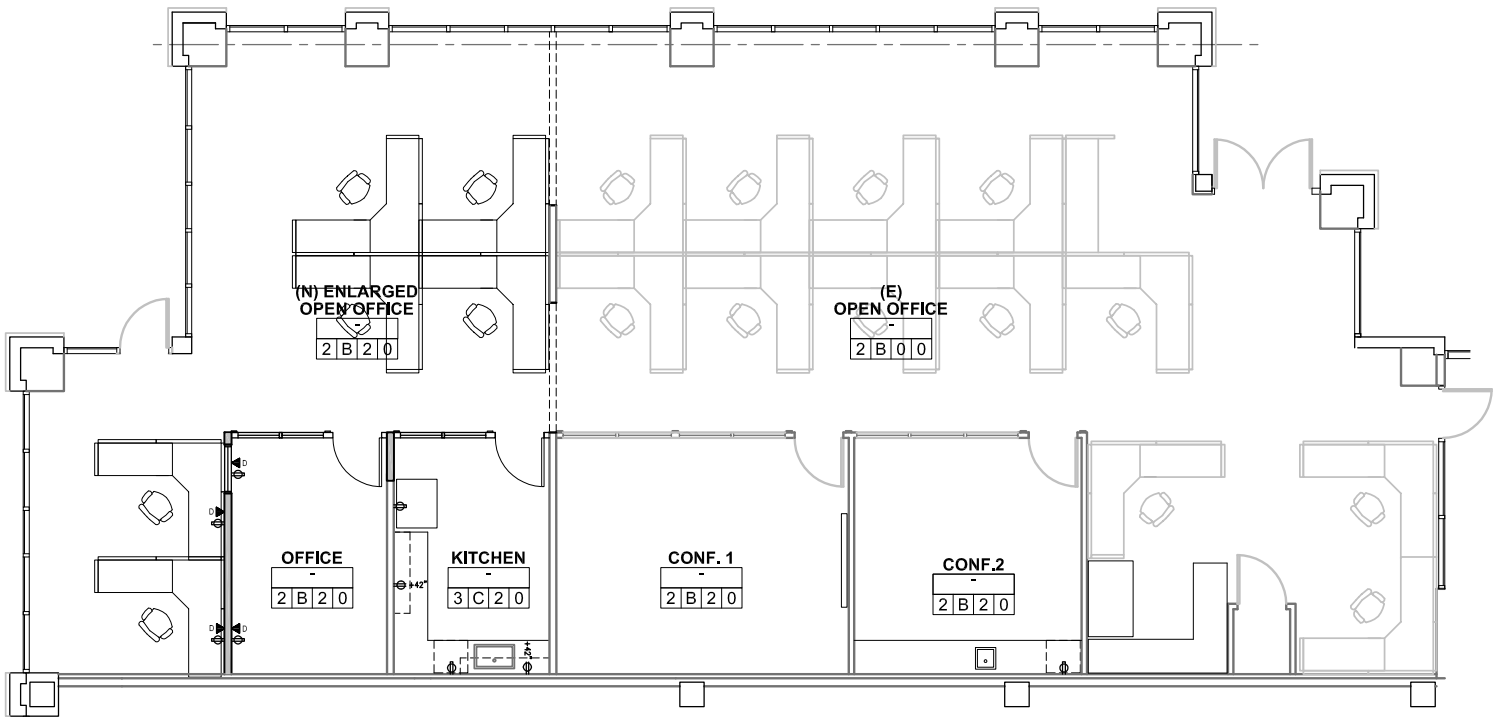

Jonathan Tomasco 510.923.6262 jtomasco@ngkf.com CA RE License #01224562

NEWMARK

1111 Broadway, Suite 100, Oakland, CA 94607

nmrk.com

The distributor of this communication is performing acts for which a real estate license is required. The information contained herein has been obtained from sources deemed reliable but has not been verified and no guarantee, warranty or representation, either express or implied, is made with respect to such information. Terms of sale or lease and availability are subject to change or withdrawal without notice.