



FOR LEASE

6611 Folsom Auburn Rd., Suite L
Folsom, CA 95630

Rare Vacancy in Well Managed Multi-Tenant Office Building



PROPERTY HIGHLIGHTS

- Conveniently located with monument signage on Folsom Auburn Road.
- Ample Parking
- Approximately +/- 1,200 Sqft
- 3 to 4 private offices
- Kitchen, reception area and storage
- Private bathroom in one office

For more information, please contact:

BOB KUHL

bob@bobkuhl.com

916.947.5060

TAMI KROHN

tkrohn@kwcommercial.com

916.300.3483

www.bobkuhl.com

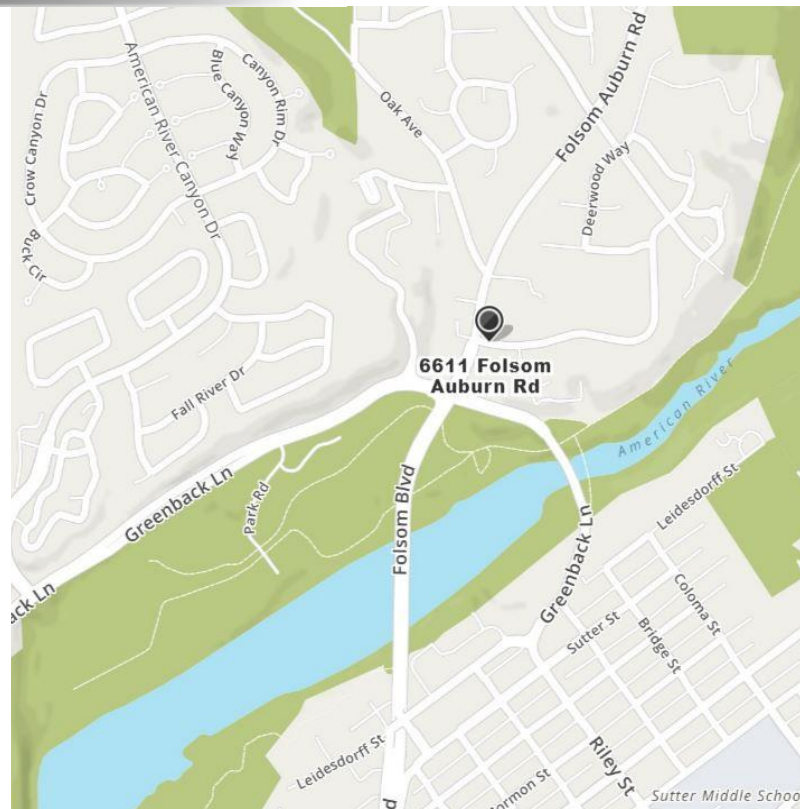

KW Commercial | 548 Gibson Drive, Ste 200 | Roseville, CA 95661 | 916.788.8800 | License #1272617

The information contained herein was obtained from third parties, and it has not been independently verified by the real estate brokers. Buyers/tenants should have the experts of their choice inspect the property and information. Real estate brokers are not qualified to act as or select experts with respect to legal, tax, environmental, building construction, soils-drainage or other such matters.

**6611 Folsom Auburn Rd., Suite L
Folsom, CA 95630**

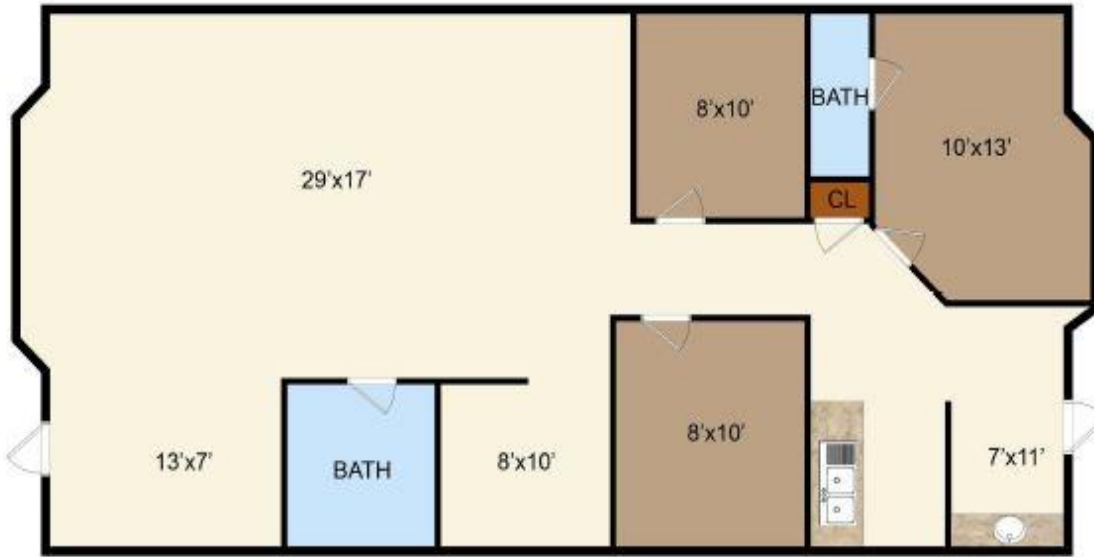

**SUITE L
1,200 sf +/-**

All dimensions are approximate



Suite L	+/- 1,200 sqft	\$1,875 per mo	Plus Janitorial, electric and water
---------	----------------	----------------	-------------------------------------

BOB KUHL
Cell: 916.947.5060
bob@bobkuhl.com
BRE Lic. #606862

TAMI KROHN
Cell 916-300-3483
tkrohn@kwcommercial.com
BRE Lic. #1896319

www.bobkuhl.com

KW Commercial | 548 Gibson Drive, Ste 200 | Roseville, CA 95661 | 916.788.8800 | License #1272617

The information contained herein was obtained from third parties, and it has not been independently verified by the real estate brokers. Buyers/tenants should have the experts of their choice inspect the property and information. Real estate brokers are not qualified to act as or select experts with respect to legal, tax, environmental, building construction, soils-drainage or other such matters.