

7,125 SF New Construction

6101 199th Street NE
 Lot 4
 Arlington, WA

Located in Airport 37
 Industrial Park

Available now

Heavy power

Dock and grade doors

Office Build-to-Suit

Floor can be customized to meet
 your needs (floor drains, power
 distribution, heavy slab)



Location



Contact

Brian Kenworthy
 Senior Vice President
 425.450.1131
 briank@kiddermathews.com

7,125 SF NEW CONSTRUCTION

6101 - 199th Street NE, Lot 4, Arlington

Space Available for Lease	7,125 SF
Office Space	BTS
Warehouse Space	7,125 SF
Total Building Size	14,250 SF
Lease Rate	Office \$1.20, NNN Warehouse \$0.60, NNN

Property Summary and Comments

New construction! Available now. Office is build to suit. The builder has left the floor un-poured, so it can be customized with floor drains, power distribution, etc.

Detail Description

Project Type		Construction Type	Brick/Metal
Loading Doors-Grade	1	Zoning	General Industrial
Loading Doors-Dock High		Year Built	2008
Parking		Land Area	1.24 acres (54,014 SF)
Sprinklers	Yes	Rail	No
Heating/A-C (Office)	Yes	Number of Floors	1
Heating (Warehouse)	Yes	Elevator	
Electrical Reported as	480v, 3-phase		

7,125 SF New Construction

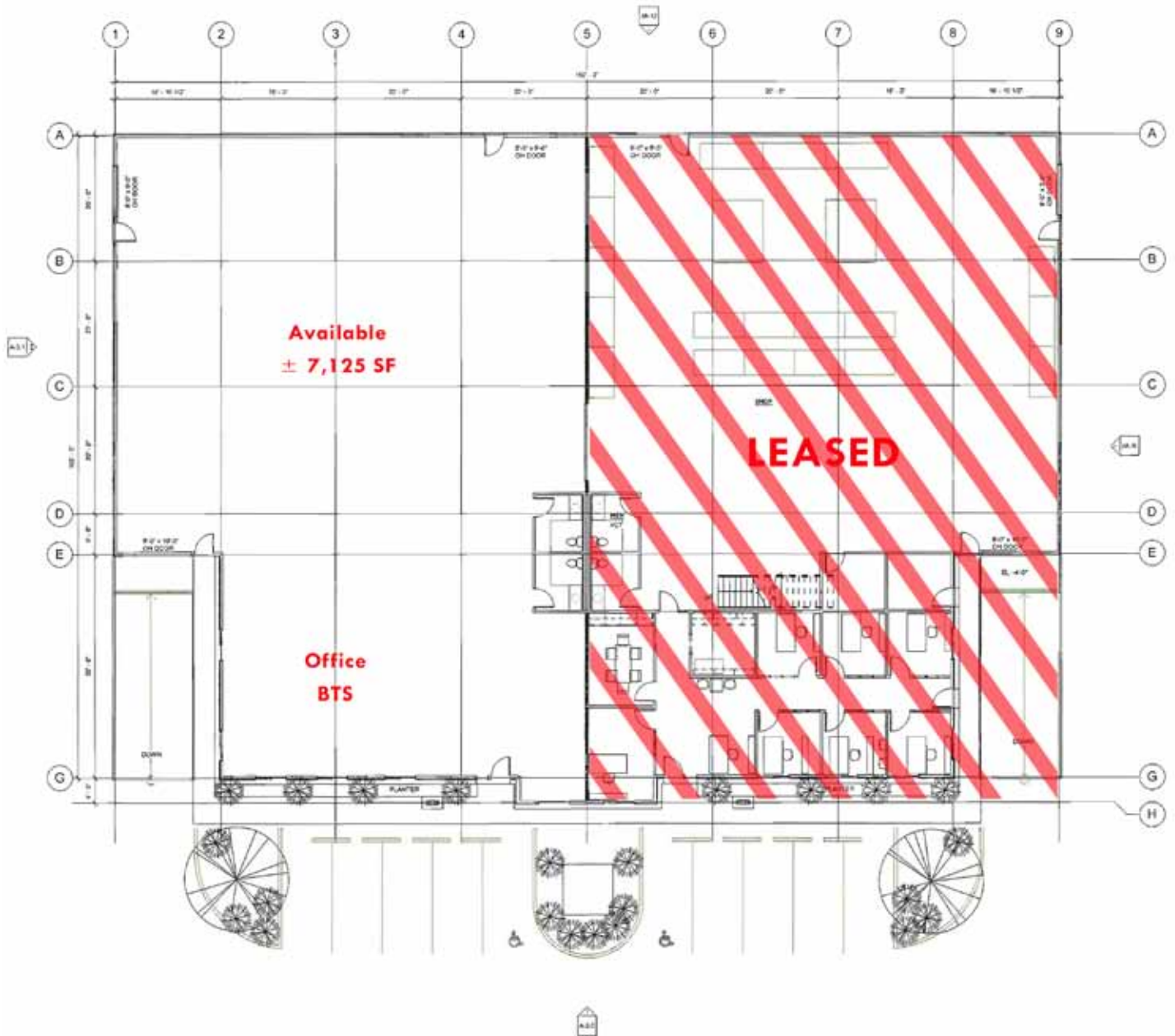

Contact

Brian Kenworthy
Senior Vice President
425.450.1131
briank@kiddermathews.com