



# 1600 Range Street

Boulder, CO



**Gregory Glass, MBA**  
greg@gibbonswhite.com  
(303) 586-5927

[www.gibbonswhite.com](http://www.gibbonswhite.com)

**Video Tours**

**View Map**

## East Boulder Office Space with Great Light & Mountain Views

Suite	Size	Lease Rate / sq. ft.
100	2,996 sq. ft.	\$13.00 NNN
101	2,966 sq. ft.	\$13.00 NNN
100 & 101	5,962 sq. ft.	\$13.00 NNN
Expenses / sq. ft.		\$6.98*

\*Not Including Utilities

- Suite 100 is a South and East Facing Corner Suite with Windows in Each of the 5 Private Offices, Huddle Room, Large Classroom / Conference Room Approx. 18 ft. x 30 ft., Reception/Bullpen & Nicely Appointed Kitchen / Break Area
- Suite 101 is a West and South Facing Corner Suite with Great Light, 7 Private Offices, Conference Room, and Open Bullpen for 6 Work Stations
- 2:1000 Parking Ratio, Plus Ample Free Street Parking
- Great East Boulder Location, Easily Accessible from Hwy 36 via Foothills
- Building Signage Available
- Approx. 1/4 Mile from the Boulder Community Health Campus
- Within Walking Distance of Black Belly Market, Ozo Coffee, Pica's Taqueria, BRU Hand-Built Ales, Snarf's & Vapor Distillery

The information included has been obtained from sources believed reliable. While we do not doubt the accuracy of the information, it has not been verified and no guarantee, warranty, or representation is being made.

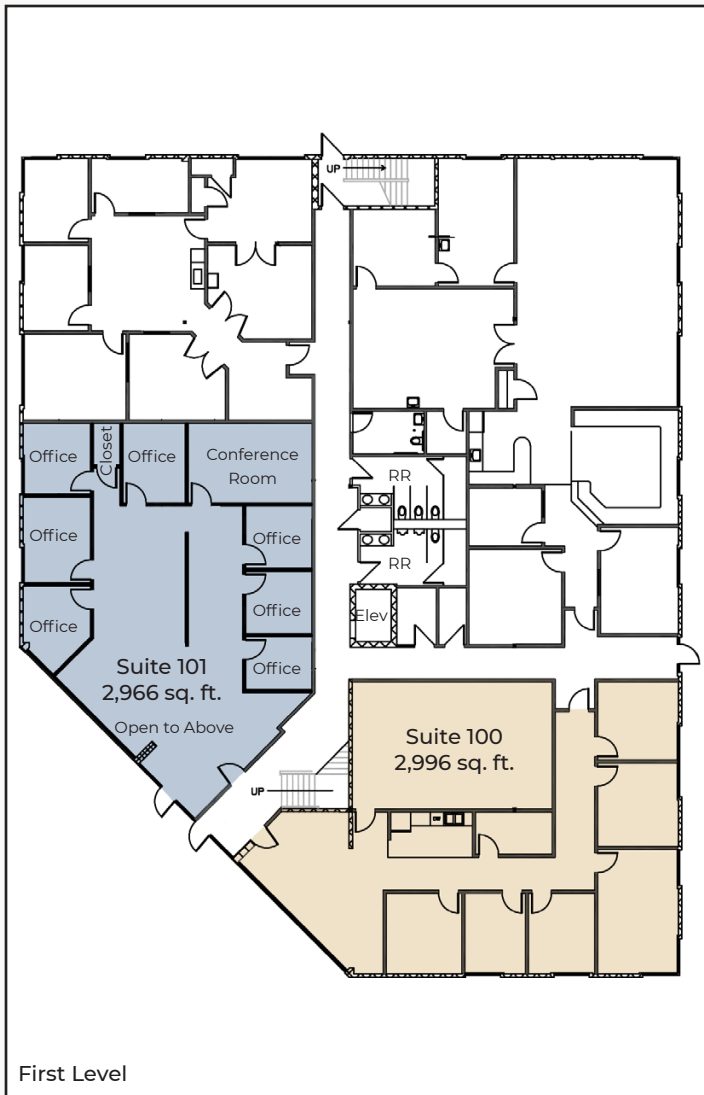

First Level

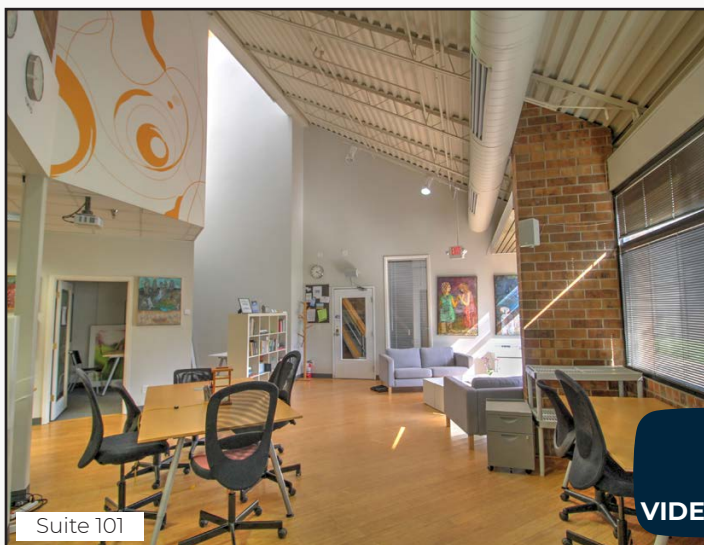

The information included has been obtained from sources believed reliable. While we do not doubt the accuracy of the information, it has not been verified and no guarantee, warranty, or representation is being made.