

# 2447 LOMBARD STREET

SAN FRANCISCO



Recently Renovated Marina District Retail/Office with Employee Parking

+/- 913 SF

**maven**  
RETAIL

# 2447 LOMBARD STREET



## FEATURES

- +/- 913 SF
- Window Lined Storefront
- High Visibility
- High Ceilings
- Recent Upgrades Include New ADA Entry and Seismic Work
- 1-2 Car Parking Possible (Extra \$350/month)
- Close to Public Transportation

## FEATURES

Recently renovated ground floor retail/office spaces on Lombard Street & Divisadero. The property is located 1 block up from Chestnut Street, on a main thoroughfare, and has good signage potential. Nearby businesses include A16, Maybeck's, Chubby Noodle, Tacolicious, and many more!

## EXCELLENT TRANSIT

2447 Lombard Street has excellent transit which means transit is convenient for most trips. Bus stops 28, 43, 91 are steps away. Also bus lines 30 and 30x are a few yards away.

# GROUND LEVEL FLOOR PLAN

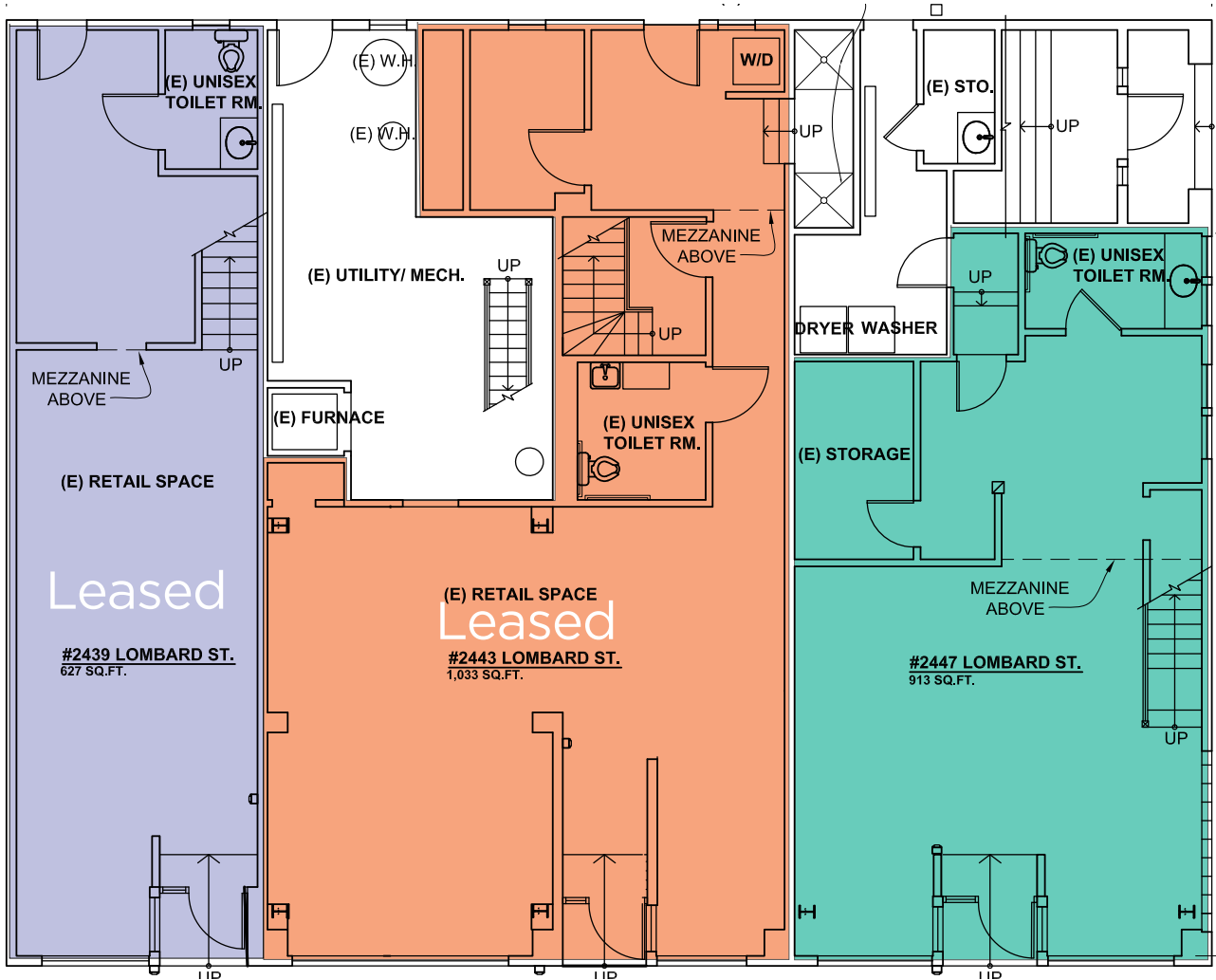

# 2447 LOMBARD NEIGHBORHOOD



Crissy Field

Yacht Harbor

Palace of Fine Arts

Presidio



Crunch Fitness

A16

Lucky Brand

Marina Supermarket

Bus: 30, 30X

Chestnut Street Coffee Roastery

Bus: 28, 43, 91

Original Buffalo Wings

C C's Cocktail Lounge

2447 LOMBARD ST.

Broderick Street

Divisadero Street

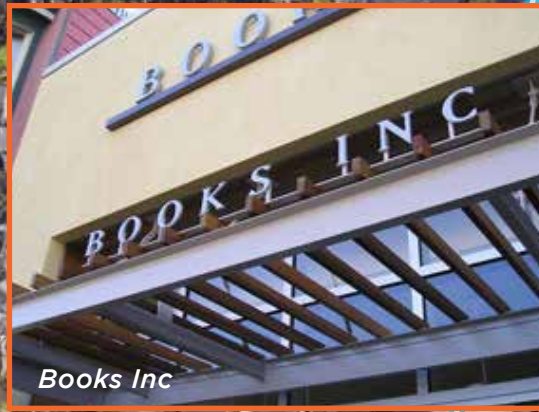

Marina Green

Fort Mason

**2447 LOMBARD** is less than two miles away from the Presidio, and a mile away from Ghirardelli Square and close proximity to the best Union & Chestnut Street blocks.

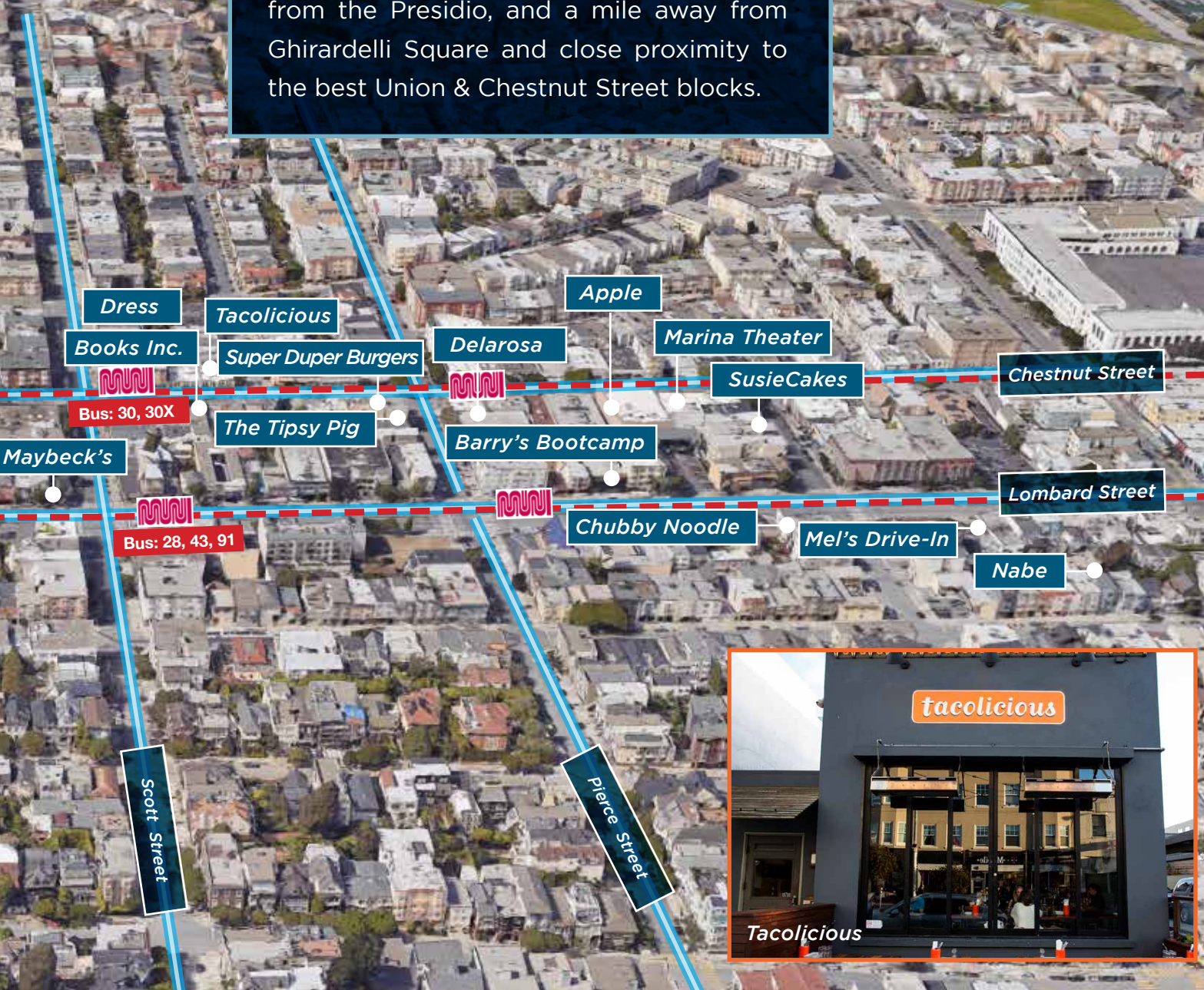

# 2447 LOMBARD STREET

**maven**  
RETAIL

**SANTINO DEROSE**  
office 415.404.7337  
sd@mavenproperties.com  
DRE #01338326

**JOAN RUYLE**  
office 415.404.7313  
joan@mavenproperties.com  
DRE #02006025

NOTICE: This information has been secured from sources we believe to be reliable but we make no representations, warranties, express or implied, as to the accuracy of the information. Listing broker has been given enough information to provide only a preliminary interest in the property. The materials are not to be considered fact. The information contained herein is not a substitute for thorough due diligence investigation. References to square footage, zoning, use, or age are approximate. Please contact the San Francisco Planning Department to verify zoning at (415) 558-6378, as neither broker or landlord represent that this space is suitable for your use. Tenant or Buyer must verify the information at their own expense and bears all the risk for any inaccuracies. By receiving these materials you are agreeing to the disclaimers set forth herein. DRE#01878802